

## Product Features:

4 channels/4k+1080P \* 3

There are no gaps or leaks between files 3.0-

inch screen

High definition wide-angle camera

Video file format: TS

Built in microphone (speaker)

Supports high-capacity TF (micro SD) memory cards

Support pulse overvoltage protection function during car startup

Built in WIFI function

One click emergency data protection function

G-sensor impact sensing lock function

Built in GPS

Support the function of pulling the camera back

## installation guide:

After checking the packaging for accuracy, please remove all accessories from the packaging and prepare for installation.

1. Turn off the car engine.
2. Align the 3M adhesive bracket with the body bracket interface, then push it in to the left until installation is successful, as shown in the following figure:

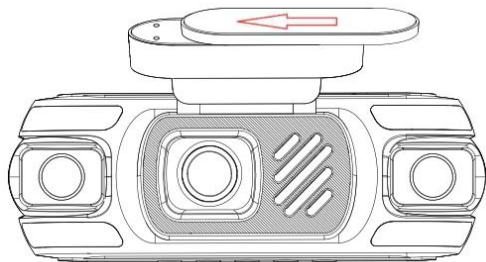

Insert the TF card into the recorder's slot. [Note] Use a high-speed TF card (U3 or higher). [Note] When using it for the first time, format the TF card on your device before starting to prevent issues such as system crashes and screen distortion during recording due to abnormal files or viruses.

4. Before installing the recorder, turn on the power and observe the screen to simulate driving conditions. Determine the optimal installation position and clean the glass with water or alcohol.
5. Next, remove the red protective film from the 3M bracket, secure the recorder to the front windshield, and adjust it to the desired tilt angle.
6. Plug the in-car charger into the car's cigarette lighter and use a charging extension cable to connect the recorder's TYPE-C port to the in-car charger. Use a wiring tool to lay the power cord along the front windshield and roof, and hide it behind the A-pillar to avoid obstructing the driver's view and posing safety risks. As shown in the following figure:

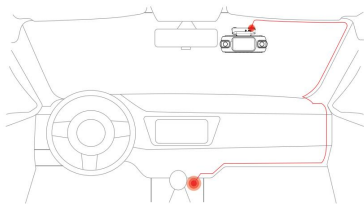

7. How to install a rearview camera in your car? Since the rearview camera is not waterproof, it is recommended to install it on the rear windshield. First, clean the rear windshield with a clean cloth and prepare the installation area. Next, remove the protective film from the static electricity sticker and attach it to the chosen spot. Then, remove the 3M tape from the rearview camera and stick it onto the static electricity sticker.

8. How to install a car rearview camera?

The first type of rearview camera is not waterproof and should be installed on the rear windshield. First, clean the rear windshield with a clean cloth to prepare the installation area. Next, remove the 3M tape from the rearview camera and attach it to the rear windshield.

The second type of rearview camera is waterproof and should be installed at the rear of the vehicle, paying attention to the direction when installing. Insert the camera cable into the cable port, pass it through the gap in the roof, connect it to the installation position of the rearview camera, and finally secure the rearview camera.

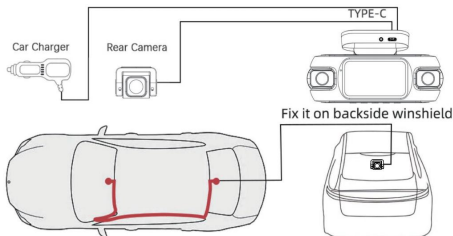

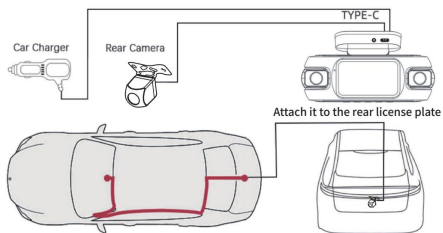

8. Adjust the lens position to ensure that the lens is level with the ground.

9. Start the engine and check whether the machine has been installed correctly. [Note] When the machine is installed correctly, the machine starts up and enters the recording state after starting. Please pay attention to check whether the picture on the display screen is normal.

## Product button and function description:

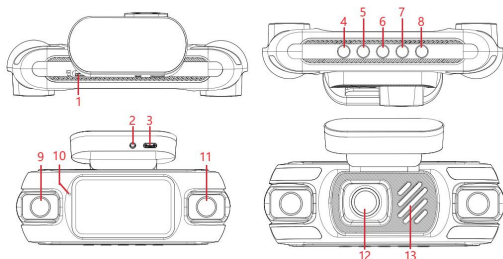

1. TF Card Slot: A storage card slot.

2. Rear Camera Interface: The rear camera's video input port.

3. Power Interface: Connects to an external power adapter or the vehicle's power source to supply power to the device.

4. Menu Key: Short press this key in standby mode to access the function settings menu; long press it to switch between file browsing and recording. During recording, short pressing this key will lock the current video file, making it non-rewindable. In normal video and photo playback, long pressing this key will prompt you to delete files. In locked video playback, long

pressing this key will unlock the file.

5. Up Key: Select functions by moving up within the menu options. Short press this key during standby or recording to take a photo. Long press the up key in standby mode to turn WiFi on/off.

6. Power Key: Short press to turn on, long press to turn off. Short press to go to sleep in standby mode.

7. Down Key: Select functions by moving down within the menu options. In recording mode, this key switches between video and audio sources.

8. OK Key: Confirm recording key. Short press in video mode to start recording; short press again to stop. In playback mode, it confirms actions.

9. Left Camera: The left viewfinder.

10. Work Indicator Light: The red indicator light turns on when the device is powered on and flashes during recording.

11. Right Camera: The right viewfinder.

12. Front Camera: The front viewfinder.

13. Speaker: The speaker for playing video or audio files, providing sound alerts.

## **Special Features:**

1. G-Sensor Function: When the machine experiences a gravitational acceleration ( $1g=9.80$  meters per second<sup>2</sup>), it will automatically lock and save the video of the incident as an unrecoverable file. The G-Sensor can be selected in the menu, with four sensitivity levels: Off, Low, Medium, and High. The default setting is Off.

2. One-Click Lock Function: During recording, short-pressing the menu button will lock and save the current video as an unrecoverable file.

3. Automatic On/Off Function: The machine automatically starts recording when the car is powered on and automatically saves and shuts down when the engine is turned off.

4. WIFI Function: In standby mode, short-pressing the menu button to enter the WIFI switch option allows you to set the WIFI to 2.4G or 5.8G. To exit the WIFI mode, simply turn this function off in the options. To turn the WIFI on/off in standby mode, long-press the up key. Connect to the device via a dedicated mobile APP for easy phone operations.

5. GPS function

(1) In standby mode, press the menu key to enter the menu options, select GPS information to plug in the GPS search value,

(2) The GPS icon on the screen turns green when it finds a GPS satellite.

6. Time-lapse recording (This option requires a voltage reduction cable to function; the car charger does not support this feature): To enable time-lapse recording, go to the settings and select: Off / 8 hours / 12 hours / 24 hours. Once this function is enabled, the system will continue to record for the selected duration even after the engine is turned off (when ACC power is lost). The system is set to be off by default. Note: This function is not available when the car battery is completely drained.

7. Parking Monitoring Function (This function requires a voltage reduction cable to be implemented; it is not supported by the on-board charger): When parking monitoring is activated, if the vehicle loses power and the dashcam enters an automatic shutdown program, the dashcam will start recording for about 20 seconds if the vehicle is subjected to external vibrations, after which it will automatically shut down. If the vehicle is detected to be vibrating again, the camera function will be reactivated. This function is not available when the vehicle battery is completely disconnected.

## **Parking monitoring (optional)**



Only the hardwire kit is required when using the parking monitoring functions to prevent the car battery from running out of power. (Not included, need to be purchased separately)

Features:

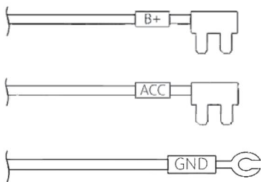

> Low battery voltage protection

> Multi-input power

> Universal compatibility

Understanding the Hardwired Kit: Warning: Incorrect connections can cause voltage protection to fail and damage your car. Please follow professional guidance when installing.

How to Install the Hardwired Kit:

Red wire> ACC> Power only when the car key is turned on.

Yellow wire> B+> Always powered.

Black wire> Ground> Any negative (ground) screw

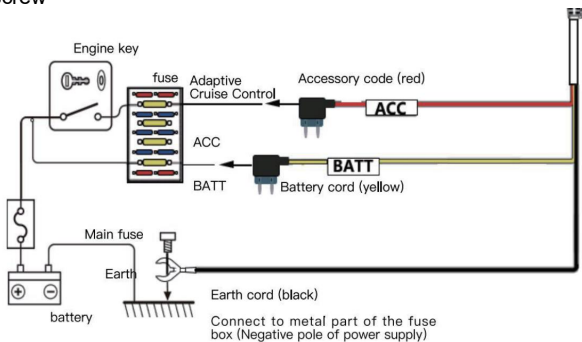

Pop-up: The fuse box panel is usually located on the driver's side dashboard. If the fuse is small, you can cut the head of the wire and connect it directly to the fuse.

## Instructions for installing the application

## and connecting to WiFi:

1. In standby mode, press the menu button to access the menu options. Select the WiFi switch option and briefly press OK to confirm, then enter WiFi mode.
2. In the menu options, select the APP download screen, where you will see the WiFi QR code, WiFi name, and WiFi password.
3. Use your phone to scan the QR code below to download and install the APP. For Android phones, select 'Safe Download.' For iOS devices, the APP Store will automatically open for download.



### 4.Add devices:

For iPhone users: Enter the system WiFi, select the recorder T58\_\*\*\*\*, and enter the WiFi password (default: 12345678) to connect. Then, open the 'Viidure' APP and complete the addition process. For Android users: Open the 'Viidure' APP, click 'Add Recorder', follow the add wizard to enter the system WiFi interface, select the recorder T58\_\*\*\*\*, and enter the WiFi password (default: 12345678) to connect. After connecting, click 'Return' to complete the addition process.

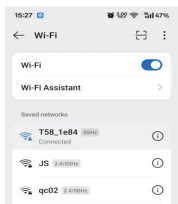

## APP Function introduction:



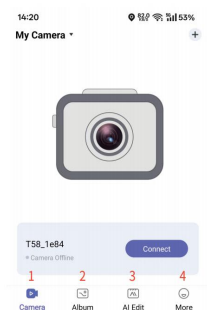

1. Recorder: This page manages the recorder, can add the recorder, view, delete the recorder, and enter the video preview interface of the recorder;
  2. Album: Manage the pictures and videos downloaded from the recorder to the phone;  
Play GPS trajectory map
    - (1) Download the video of the road ahead to the local album in the APP.
    - (2) Disconnect the recorder from the mobile phone WiFi connection and use the data network on the mobile phone.
    - (3) Enter the local album in the APP interface, click the video of the road ahead to be played, and view the GPS track details and driving speed of the car
  3. Zhijian: Edit pictures and videos.
  4. More: APP language Settings, problem feedback, about information.
- Recorder function introduction:**

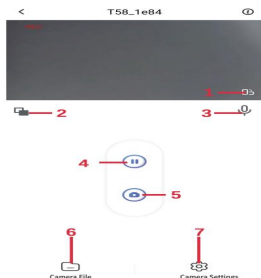

1. Full-screen display: Click to view the video in full screen;
2. Camera switch: Click to switch between camera views;
3. Microphone: Click to turn the microphone on or off;
4. Recording: Click to pause or resume recording, and the video will be saved to the recorder upon completion;
5. Photography: Click to take a photo, which will be saved to the recorder upon completion;
6. Recorder files: Enter the file list on the recorder and categorize them by looped videos, captured events, emergency events, parking monitoring, and local albums; Download recorder files: Click 'Recorder files' to enter the file list interface, click the 'Select' button to select the images or videos you want to download, then click 'Download' to start the download process. Once downloaded, the files will be saved to your phone and can be viewed through the 'Album'; Play recorder files: Click 'Recorder files' to enter the file list interface, where you can directly play videos on the recorder without downloading them, and also take photos of the current playback frame; Download: Download the video to your phone; Delete: Delete the selected file; Album: Enter the 'Album' to manage images or videos downloaded to your phone. Click 'All' to view the complete list of videos in this category, and click 'Select' to select multiple files for operation; Videos: All video files; Photos: All photo files; Emergency: Files with collision detection;
7. Record device Settings: Enter the recording device Settings interface, and set the microphone switch, recording resolution, video file duration, etc.;

## Basic operation instructions for

## **camera/camera:**

1. Turning On and Off: Short-press the power button to turn on, and the power indicator will light up; long-press the power button to turn off, and the indicator will turn off. 2. Camera Mode: Short-press the OK button to start recording. During recording, a red dot will flash on the screen, and a blue indicator will start to blink, indicating that you are in recording mode. 3. Video/Photo Playback: Short-press the menu button to enter the file browsing menu. Select the camera file you want to view from ordinary video, locked video, or photos. You can also select the video or photo to play by long-pressing the menu button while in standby mode. 4. Menu Settings: In standby mode, short-press the menu button to bring up the settings menu. Use the up or down keys to navigate through the settings. Select the setting you wish to change, and then short-press OK to make the change. 5. Exit Settings Menu: Short-press the menu button to exit the settings menu.

## **Time and date Settings:**

1. In standby mode, press the menu button briefly to access the settings. Use the up/down keys to select the time and date settings, then press OK to enter. You can switch between year, month, day, hour, minute, and second by pressing the up/down keys. Press OK again to confirm your changes and exit the time settings.

2. When the device is connected to the mobile phone's WiFi, the time will automatically update.

3. When the device is connected to GPS, the time will automatically update.

## **Download GPS track map player:**

1. To access the PC version of the website, follow these steps: <http://www.sunningsoft.com/en/pcgps.html> Download; Note: System requirements: 1. Windows 7/8/10 operating systems, 64-bit or 32-bit (Windows XP is not supported);

2. For Mac OS users, search for GXplayer in the App Store and download and install it directly. After downloading and installing, open the player to see the following interface:

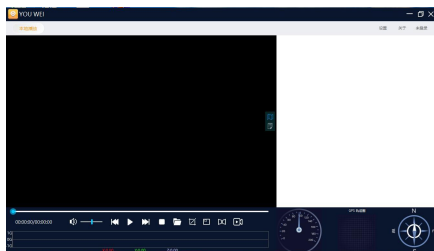

3. After installation, open the software, open the video file to be played, or drag and drop the file directly to the player bar, and the GPS track will be displayed after playing;



## Product specifications:

|                       |  |
|-----------------------|--|
| Product Features      | High Definition Camera, High Definition Video                        |
| G-sensor              | Built-in (emergency lock, will not be overwritten)                   |
| LCD Display Size      | 3.0 inch   |
| Camera lens           | wide angle lens  |
| language              | Support for Multilingualism  |
| file format           | TS stream  |
| Video Resolution      | 2160P/1080P  |
| Video encoding format | H.265  |
| On-board switch       | Supporting automatically turn on/ off when the car engine is on/ off |
| Date                  | Support  |

|                 |                              |
|-----------------|------------------------------|
| Memory card     | TF (maximum support 128GB)   |
| Photo Mode      | 8 million                    |
| Photo format    | JPEG                         |
| Microphone      | Support                      |
| WIFI function   | Supporting Mobile Connection |
| Rear camera     | Support                      |
| GPS             | Support                      |
| Power Interface | 5V/2.5A                      |

## Troubleshooting:

Under normal operating conditions, if there is a problem with the product, please refer to the following methods to solve it:

Cannot take photos or videos

Check if the TF card has enough space and if it is locked.

When recording, it will automatically stop

Due to the large amount of high-definition video data, please use a high-speed TF card compatible with SDHC, which will have the U3 logo.

When replaying images and videos, a "file error" prompt appears

An error occurred while storing data on the TF card, resulting in incomplete file capture. Please use the camera's 'format' function to reformat the TF card.

The captured image is hazy and blurry

Please check if there are any dirt or fingerprints on the lens;

Before shooting, wipe the lens with lens paper.

When shooting scenes such as the sky and water, the image is very dark

In high contrast scenes, it can affect the camera's exposure function, which can be corrected by adjusting the "Exposure" value in the machine settings menu.

Horizontal stripe interference in the image

This is caused by setting the wrong "light source frequency".

Please set it to "50Hz" or "60Hz" according to the local power supply frequency.

FCC Statement

This device complies with Part 15 of the FCC Rules. Operation is subject to the following two conditions:

(1) This device may not cause harmful interference.

(2) This device must accept any interference received, including

interference that may cause undesired operation.

Caution: Any changes or modifications not expressly approved by the party responsible for compliance could void the user's authority to operate the equipment.

Note: This equipment has been tested and found to comply with the limits for a Class B digital device under Part 15 of the FCC Rules. These limits are designed to protect reasonably against harmful interference in a residential installation. This equipment generates uses and can radiate radio frequency energy and, if not installed and used by the instructions, may cause harmful interference to radio communications. However, there is no guarantee that interference will not occur in a particular installation. Suppose this equipment does cause harmful interference to radio or television reception, which can be determined by turning the equipment off and on. In that case, the user is encouraged to try to correct the interference by one or more of the following measures:

(1) Reorient or relocate the receiving antenna.

(2) Increase the separation between the equipment and receiver.

(3) Connect the equipment to an outlet on a circuit different from the receivers.

(4) Consult the dealer or an experienced radio/TV technician for help.

## Radio Frequency Exposure Statement

The device has been evaluated to meet general RF exposure requirements. The device can be used in fixed/mobile exposure condition. The min separation distance is 20cm.