

材质：150g铜版纸 黑白正反面印刷 展开尺寸为：500x80mm,折叠尺寸为：50x80mm 。折叠方式：风琴折

Manual

Smart FindTag MT2

Product overview

Rated voltage 3V
Size:Φ32mm*8.45mm

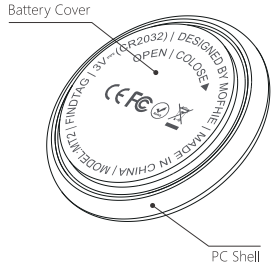

Quick Instructions

- 1、Turn on the device: install button battery, the device will beep and turn on.
- 2、Open the APP that comes with the Apple mobile phone system: Find my;
- 3、Choose: Items;
- 4、Choose: Add New Item;
- 5、Choose: Other Supported Item;
- 6、During the Searching Items process, a device with the name MT2 will appear;
- 7、Click on the device found in the APP and name it.
- 8、The connection is successful after name, you can use device functions: A. Ring the device, click and play Sound, the device will emit music. B. Findmy network helps to find: When the device leaves the bluetooth distance, it cannot be connected in the APP; you can choose Lost Mode, Enable. Enter the contact mobile phone number, etc. If there is an iPhone near the lost device, the owner's Findmy APP can receive notifications and the latest location.
- 9、Delete device: To delete the device in the APP, you can select Remove item.
- 10、After removing the device, the device will not shut down and is under the pairing state. If there is no re-pairing within 10 minutes, the device will leave the pairing state. If you need to pair the device, you need to load the battery again, the device will play a sound. At this time, the device enters the pairing mode and can be paired with the Find My APP again.

Instructions For Device Operation

1. Install the battery: Install the battery on the device at the first time, the device will enter power on mode and play one "tick" sound;
2. Power on: Install the battery to the device, and the device is powered on. The device is in pairing mode after power on, times out if no pairing after 10 minutes;
3. Device status confirmation: Place the shell with the logo upward for 5 seconds, and then place the product upside down for 5 seconds. When the device has not been paired with the Find my app, the device will play a sound; When the device and the Find my app are paired and connected, the device emits a "tick" tone once. When the device and the Find my app are paired but not connected, the device will play a longer sound;
4. Pairing mode timeout, the device enters the pairing mode again: After removing the device in the app, the device will play a sound, it will not shut down and is in the pairing mode. After turn on the device or remove the device in the app, if there is no pairing within 10 minutes, the device will leave the pairing mode (the device cannot be paired with the Find My APP at this time). If you need to pair the device, you need to load the battery again, the device will play a sound. At this time, the device enters the pairing mode and can be paired with the Find My APP again.
5. How to check the serial number: Place the side with the logo upside for 5 seconds, then place the product upside down for 5 seconds, repeat the above steps

twice, the device will emit the "tick" tone 6 times, and the device enters into a serial number read state.
6. Factory Reset: install and take out the battery 5 times continuously, the device emits a sound. At this time, factory reset is completed.

7. The device turns from the power-on state to the power-off state, and the find my network is turned off; the battery is deducted, and there is no indication.

Main Functions

1. "Find" network position

When the device and the phone exceed the bluetooth distance, the device can't be linked in the Find My app. You can choose: Lost mode, and Enable. Enter your contact number, etc. If the device is disconnected from your phone for more than a period of time, and another iPhone is nearby, you will receive a notification and the latest location in the Find app.

2. Play Sound

Phone and device are within the Bluetooth range (generally around 20 meters). Open the app and tap. Click Play Sound, and the device will beep, so you can find the item easily.

FAQ:

1. When can the device be located?

When an item is separated from its owner for a period of time, it can be found by other Apple devices that are part of the Find My network, and the owner can start to get the location of the device.

2. How to confirm whether the device has been turned on?

Turn on the device: install button battery, the device will beep and turn on.

3. How to prevent your device from being maliciously tracked?

When someone else's device sneaks into your belongings, and track over time you will be reminded in the following two ways:

1. If you have Apple devices such as iPhone, iPad, or iPod touch, you'll get alerts on your Apple device; this feature doesn't work on iOS or iPadOS. Available on Apple devices 14.5 and later.
2. If you don't have an Apple device, if someone else's Mofhie Air leaves its owner and has been following you for a while, it will play music as it moves to remind you. Of course, if by chance your friend is bringing equipment, or many people on the subway that you take have this equipment, also don't worry, because as long as the device does not leave the owner's side, it will not trigger such a reminder.

4. How is my privacy protected?

Where your device is, only you can see it. your location data and History will never be stored in Apple's and Mofhie's servers. The device of your device location data also remains anonymous at all times, and location data is encrypted every step of the way. Therefore, both Apple and Mofhie don't know where your device is and who help to find it.

5. How to replace the battery of the device?

- 1) Press the battery cover and rotate it counterclockwise to open it.
- 2) Take out the old battery and insert the new CR2032 button battery with the positive electrode facing upwards (standard battery, available at the supermarket).
- 3) Cover the battery cover, ensure that the three slots on the cover are aligned, and then rotate the cover clockwise.

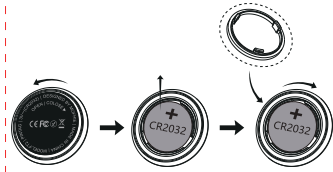

6. What is the Find My network? And how does it work?

The Apple Find My network provides a simple and secure way to locate compatible personal items on a map using

the Find My app on iPhone, iPad, iPod touch, Mac, or the Find Items app on Apple Watch. Just pair your compatible product with the Apple Find My app and you can view it with your Apple devices. If your item goes missing, you can put it in Lost Mode to show messages and contact information to anyone who might find it. The Find My network is encrypted and anonymous. Therefore, no one else, not even Apple or Mofhie, can view its location.

Regulatory Safety Information

WARNING: KEEP BATTERIES OUT OF REACH OF CHILDREN

Swallowing may lead to serious injury in as little as 2 hours or death, due to chemical burns and potential perforation of the oesophagus.
If you suspect your child has swallowed or inserted a button battery immediately call the 24-hour Poison Information Centre for fast expert advice.
KEEP BATTERIES OUT OF REACH OF CHILDREN
• Keep in original package until ready to use.
• Call a local poison control center for treatment information. Australia: 13 11 26 Canada: 1-800-268-9017 (Ontario), 1-800-567-8911 (BC), 1-800-463-5060 (Quebec) US: 800-498-8666. Verify suitable emergency call numbers for your country.
• Do not use if the compartment is not secure.
• Dispose of used button batteries promptly and safely. Flat batteries can still be dangerous.
• Risk of fire and burns.
• Do not recharge, disassemble, heat (-20°C +70°C) or incinerate.

Notice!

According to the Management Measures for Low Power Radio Wave Radiative Motors

Article 12 The low-power RF motor qualified by type certification, without permission, the company, trade or user shall not change the frequency, increase the power, or change the characteristics and functions of the original design.
Article 14 The use of any power RF motor shall not interfere with flight safety and legal communications. If an interference is found, it should be stopped immediately, and it can be continued to use when it is no longer interfering.
The foregoing legal communication refers to the wireless telecommunication operated according to telecommunications laws and regulations.
Low-power RF motors must withstand interference from legal communication or industrial, scientific, and medical electrical equipment using electromagnetic radiation.

Battery warning:

The device uses lithium batteries.
If the following guidelines are not followed, the lithium-ion battery life in the device may be Shortened or damaged.
Devices, fires, chemicals
Risk of burns, electrolyte leakage and/or injury.
Don't disassemble, punch hole, or damage the device or battery.
Don't remove or attempt to remove batteries that can't be replaced by the user.
Don't expose the battery to fire, explosion, or other hazards.
Don't use sharp objects to remove the battery.

FCC STATEMENT :

This device complies with Part 15 of the FCC Rules. Operation is subject to the following two conditions:
(1) This device may not cause harmful interference, and
(2) This device must accept any interference received, including interference that may cause undesired operation.

Warning: Changes or modifications not expressly approved by the party responsible for compliance could void the user's authority to operate the equipment.
NOTE: This equipment has been tested and found to comply with the limits for a Class B digital device, pursuant to Part 15 of the FCC Rules. These limits are designed to provide reasonable protection against harmful interference in a residential installation. This equipment generates uses and can radiate radio frequency energy and, if not installed and used in accordance with the instructions, may cause harmful interference to radio communications. However, there is no guarantee that interference will not occur in a particular installation. If this equipment does cause harmful interference to radio or television reception, which can be determined by turning the equipment off and on, the user is encouraged to try to correct the interference by one or more of the following measures:
• Reorient or relocate the receiving antenna.
• Increase the separation between the equipment and receiver.
• Connect the equipment into an outlet on a circuit different from that to which the receiver is connected.
• Consult the dealer or an experienced radio/TV technician for help.

RF warning statement:

The device has been evaluated to meet general RF exposure requirement. The device can be used in portable exposure condition without restriction.

Important Tips

When pairing a device with Findmy app, the phone will link to the Apple server. Pairing may fail because of network can't temporarily connect to the Apple server. The following actions are recommended:
1. Change the phone's network, such as switching between WiFi and mobile network;
2. Factory Reset: install and take out the battery 5 times continuously, the device emits a sound. At this time, factory reset is completed.
3. Re-pair with Findmy app.



使用说明

智能查找标签 MT2

产品概述

定标电压 3V
产品尺寸：Φ32mm*8.45mm

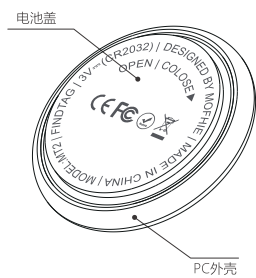

快速说明

- 1、开机：装上纽扣电池，设备发出提示音，表示设备已开机。
- 2、打开苹果手机系统自带的APP：查找；
- 3、选择：物品；
- 4、选择：添加物品；
- 5、选择：其他支持的物品；
- 6、在“正在搜索物品”过程中，会出现一个带有MT2字样的设备；
- 7、点击APP中找到的设备并命名。
- 8、命名后即可连接使用设备功能：A. 呼叫设备，点击播放声音，设备会发出音乐。B. 查找网络帮助寻找：当设备离开蓝牙距离时，在APP中无法连接。您可以选择丢失模式、启用。输入联系人手机号码等，如果丢失设备附近有iPhone，机主的查找APP可以接收通知和最新位置。
- 9、移除设备：在APP中移除设备，可以选择移除物品。
- 10、移除设备后，设备不会关机，处于配对状态。如果10分钟内没有重新配对，设备将退出配对状态。如果此时需要配对设备，则需要重新上电，设备会发出声音，此时设备进入配对状态，可以再次与APP配对。

设备操作说明

- 1、**安装电池：**第一次给设备安装电池，设备将进入开机模式，设备发出1次“嘀”的提示音。
- 2、**开机：**给设备安装电池，设备已开机。开机后设备处于配对模式，10分钟后超时。
- 3、**设备状态确认：**产品正面向上放置5秒，之后产品背面向上放置5秒，当设备未与查找APP配对时，设备发出提示音；当设备与查找APP已配对蓝牙连接时，设备发出1次“嘀”的提示音；当设备与查找APP已配对但蓝牙断开时，设备发出较长提示音。
- 4、**配对模式超时，设备再次进入配对模式：**Find My APP“移除物品”后，设备会发出提示音，设备不会关机，处于配对模式。开机或“移除设备”后，如果10分钟内没有重新配对，设备将退出配对模式（此时设备无法与查找APP配对），如果需要配对设备，重新上电，设备会发出提示音，此时设备进入配对模式，可以再次与查找APP配对。
- 5、**如何查询序列号：**产品正面向上放置5秒，之后产品背面向上放置5秒，以上步骤重复操作2次使能SN号读取，设备会发出6次“嘀”提示音，设备进入序列号读取状态。
6. 恢复出厂设置：连续安装电池5次，完成恢复出厂设置，设备发出提示音。

主要功能

1、“查找”网络定位

当设备与手机超出蓝牙距离，在查找app中链接不上设备，可以选择：丢失模式，选择：启用。输入您的联系电话等。如果设备与您的手机断开超过一段时间，同时设备附近有别的苹果手机，您的查找app中即可收到通知以及最新的位置。

2、播放声音

手机与设备在蓝牙范围内（一般是20米左右），在查找app中，点击，播放声音，设备会发出音乐，帮助您快速找到附近的物品。

常见问题

1、设备什么时候可以被别的苹果手机定位？

当设备与主人的苹果手机断开一段时间后，设备可以开始被别的苹果手机定位，主人就可以开始获得设备的位置。

2、如何确认设备是否已开机？

装上纽扣电池，设备发出提示音，表示设备已开机。

3、如何防止设备被用于恶意跟踪？

当别人的设备混入您的随身物品时，并跟踪超过一段时间，您会通过以下两种方式被提醒：

- 1、如果您有iPhone, iPad, 或者iPod touch等苹果设备，您会在苹果设备上获得提醒；此功能在iOS或iPadOS 14.5 及以后版本的苹果设备上有效。
- 2、如果您没有苹果设备，如果别人的Mofhie Air离开了自己的主人，并跟踪了您一段时间，当它移动时，它会发出音乐，以提醒您。当然，如果碰巧您身边的朋友正带着设备，或者您搭乘的地铁上很多人都有这个设备，也不必担心，因为只要设备离开主人身边，就不会触发这样的提醒。

4、如何保护我的隐私？

您的设备在哪里，只有您自己能看到，您的位置数据和历史记录绝不会存储在苹果和Mofhie的服务器中。传递您设备位置数据的设备也始终保持匿名，而且位置数据在查找的每一步都有加密保护。因此，苹果和Mofhie都不知道您的设备的位置，以及帮忙找到它的设备是何身份。

5、如何给设备更换电池？

- 1) 按下电池盖并逆时针旋转打开。
- 2) 取出旧电池，正极朝上装入新的CR2032纽扣电池(标准电池，可在超市购买)。
- 3) 盖上电池盖，确保盖上的三个插槽对齐，然后顺时针旋转盖子。

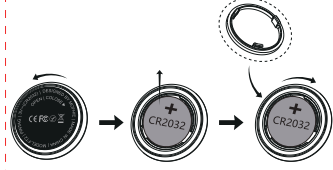

6、“查找”网络是什么？如何工作？

Apple Find My 网络提供了一种简单、安全的方式，可以使用 iPhone、iPad、iPod touch、Mac 上的 Find My 应用程序或 Apple Watch 上的 Find Items 应用程序在地图上查找兼容的个人物品。只需将您的兼容产品与 Apple Find My app 配对，即可与您的 Apple 设备一起查看。如果您的物品丢失了，您可以将其置于丢失模式以向可能找到它的任何人显示消息和联系信息。Find My 网络是加密和匿名的，因此没有其他人，甚至 Apple 或 Mofhie 都无法查看其位置。

监管安全信息

警告：将电池放在儿童接触不到的地方。由于化学灼伤和潜在食道穿孔，吞咽可能会在短短 2 小时内导致严重伤害或死亡。
如果您怀疑您的孩子吞下了或插入了纽扣电池，请立即拨打救助电话以快速的获得专家建议。
将电池放在儿童接触不到的地方
• 保存在原包装中，直到准备使用
• 请致电当地毒物控制中心获取治疗信息。澳大利亚: 13 11 26 加拿大: 1-800-268-9017 (安大略省)
1-800-567-8911 (不列颠哥伦比亚省), 1-800-463-5060 (魁北克省) 美国: 800-498-8666。验证是否合适。您所在国家/地区的紧急呼叫号码。

1-800-567-8911 (不列颠哥伦比亚省), 1-800-463-5060 (魁北克省) 美国: 800-498-8666。验证是否合适。您所在国家/地区的紧急呼叫号码。

- 如果隔间不安全，请勿使用。
- 及时、安全地处理用过的纽扣电池。没电的电池仍然是有危险的。
- 火灾和爆炸的风险。
- 请勿重新充电、拆卸、加热 (-20°C +70°C) 或焚烧。

注意！

依据 低功率电磁辐射性电机管理办法
第十二条 经型式认证合格之低功率射频电机，非经许可，公司、商号或使用者均不得擅自变更频率、加大功率或变更原设计之特性及功能
第十四条 任功率射频电机之使用不得影响飞航安全及干扰合法通信。经发现有干扰现象时，应立即停用，并改善至无干扰时方得继续使用。
前项合法通信，指依电信法规作业之无线电通信低功率射频电机须忍受合法通信或工业、科学及医疗用电波辐射性电机设备之干扰。

电池警语：

此装置使用锂电池。
若未遵照下列准则，则装置内的锂离子电池寿命可能会缩短或有损坏装置、发生火灾、化学品灼伤、电解液泄漏及/或受伤的风险。
请勿拆解、整孔或损坏装置或电池。
请勿取出或尝试取出使用者不可自行更换的电池。
请勿将电池曝露于火焰、爆炸或其他危险中。
请勿使用尖锐物品取出电池。

FCC(美国联邦通信委员会)声明：

本设备符合 FCC 规则第 15 部分的规定。操作须满足以下两个条件：
(1) 该设备不会造成有害干扰，并且
(2) 该设备必须接受任何收到的干扰，包括可能导致意外操作的干扰。
警告：未经负责方明确批准的更改或修改可能会导致用户操作设备的权限失效。
前项合法通信，指依电信法规作业之无线电通信低功率射频电机须忍受合法通信或工业、科学及医疗用电波辐射性电机设备之干扰。

注意：本设备经过测试，符合 FCC 规则第 15 部分对 B 类数字设备的限制。这些限制旨在提供合理的保护，防止住宅安装中的有害干扰。该设备会产生使用并辐射射频能量，如果不按照说明安装和使用，可能会对无线电通信造成有害干扰。但是，不能保证特定安装中不会发生干扰。如果该设备确实对无线电或电视接收造成有害干扰（可以通过关闭和打开设备来确定），我们鼓励用户尝试通过以下一项或多项措施来纠正干扰：
重新调整或摆放接收天线。
增加设备和接收器之间的距离。
将设备连接到与接收器所连接电路不同的电路插座上。
请咨询经销商或经验丰富的广播/电视技术人员寻求帮助。

射频警告声明：
该设备已经过评估，可满足一般射频暴露要求。该设备可以在便携式暴露条件下使用，不受限制。

