

Smarter Space

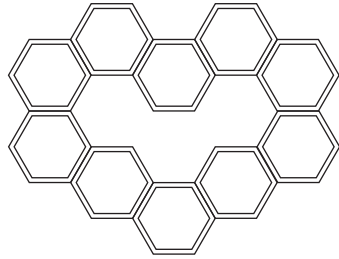

USER MANUAL

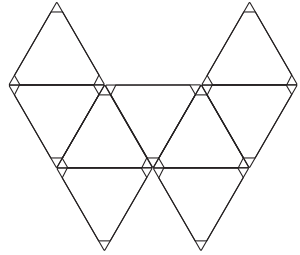

Parameters

| | |
|-------------------------|---|
| Input: | AC 100-240V |
| Power Supply Power: | 24W |
| Color: | RGBIC |
| Working Temperature: | -20 C - 40 C |
| Lifespan: | 25,000 hours |
| Dimmability: | Yes (App/Voice/Button Controller/ Remote Controller) |
| Communication Protocol: | WiFi+Bluetooth (2.4Ghz b/g/n) |
| Compatible: | Google Assistant, Amazon Alexa, Siri |

Packing

Pack of 6 : Light x 6,Linker x 5,Adapter x 1,Button Controller x 1, Manual x 1, Double-sided adhesive tape x 6, Remote controller x 1.

Pack of 9 : Light x 9, Linker x 8,Adapter x 1, Button Controller x 1, Manual x 1, Double-sided adhesive tape x 9, Remote controller x 1.

Pack of 10 : Light x 10, Linker x 9,Adapter x 1, Button Controller x 1, Manual x 1, Double-sided adhesive tape x 10, Remote controller x 1.

Instructions for controller

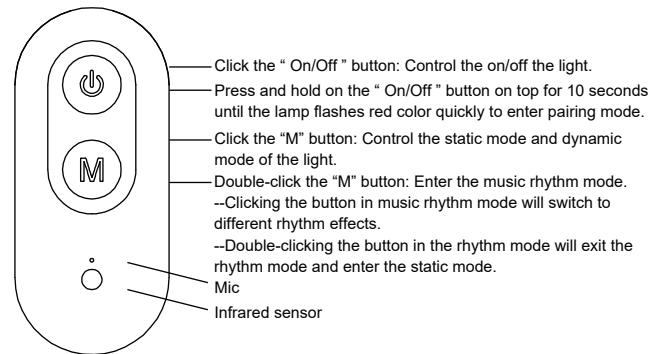

Installation Instruction

1. Connect the controller with the power adapter, Connect the controller with the first light. Plug the adapter into power.

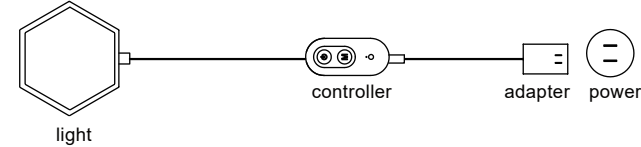

2. Please make sure that the wall or other installation surface is clean and free of dust or water.



4. Press the light to the wall for 30 seconds.

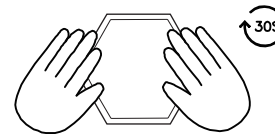

6. Continue this process until all your light are fully mounted.

3. Insert a linker into the first light, mount the first light to the wall.

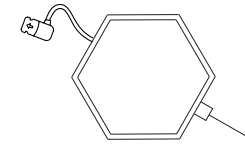

5. Identify the correct connecting port on the second light, snap the second light into place.

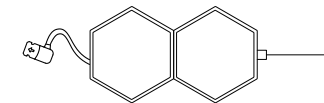

Steps of Connection on Mobile

1. A smart phone or tablet with IOS 8.0 (or later) or Android 4.3 (or later).
2. Download the "Tuya Smart" App from the APP store (IOS devices) or Google Play (Android devices).



Google play



Apple store



APP:Tuya Smart

3. Open on the Bluetooth, Wifi (2.4Ghz), and App. Click "+" and then click "Add Device" to search for nearby devices.

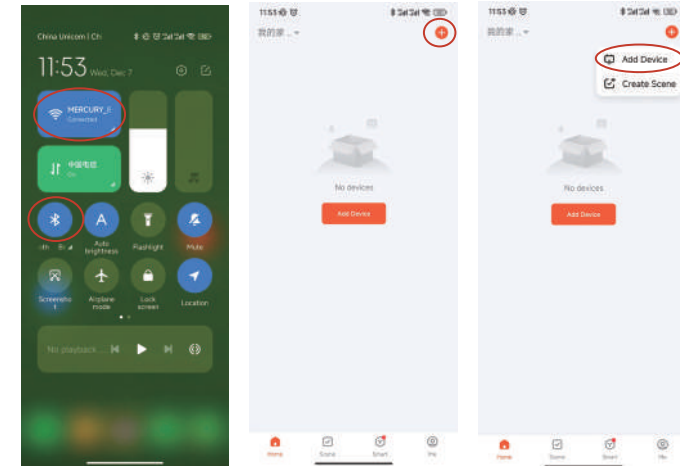

4. Press and hold on the "On/Off" button on controller for 10 seconds until the lamp flashes red color quickly to enter pairing mode.

5. After discovering the device,click "Add".
6. Enter password and connect the Wifi (2.4Ghz), then click "Next". Waiting for the connection.

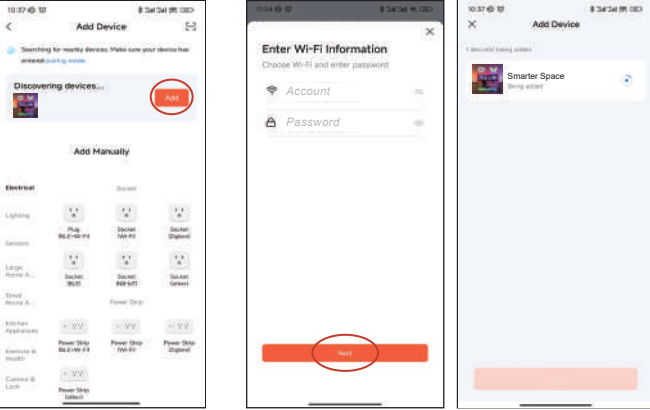

7. Done!

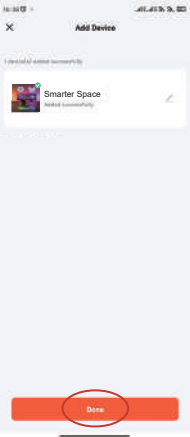

APP interface

Color

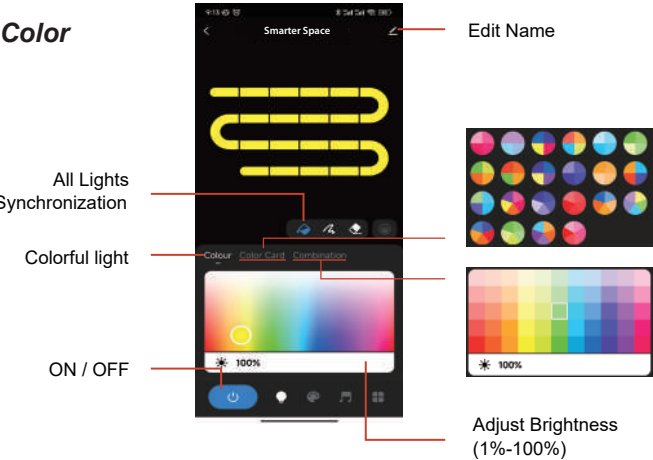

DIY

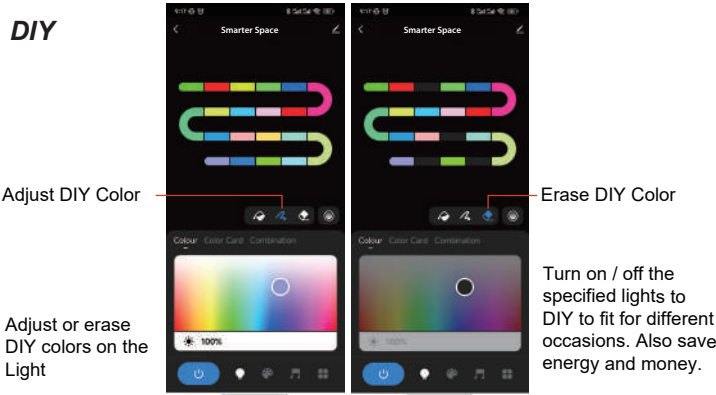

Preset Scene

44 Scenes for option

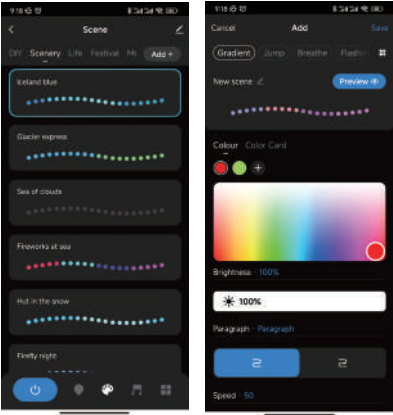

DIY Scene

Create custom light scene by yourself

Music

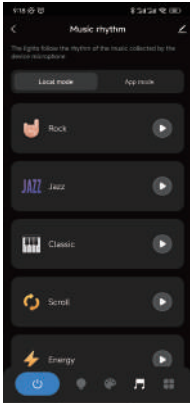

Lights colors will change with the music beats or your microphone.

Schedule

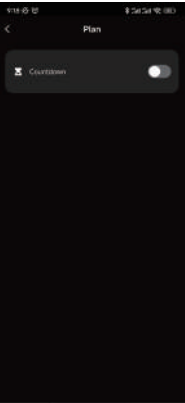

Create your own plan

Actual point

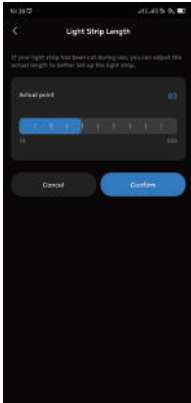

If your light has been cut during use,you can adjust the actual length to better set up the light strip.

Cautions

1. This light panel is ideally used on smooth surfaces (e.g. glass, etc.); not suitable for uneven, bumpy or wet surfaces (e.g. brick, stucco, etc.).
2. Clean and ensure the surface is totally dry before sticking the light panel on.
3. When installing the light panel, press its central point against the wall for more than 30s in order to maximize the adhesion.
4. Avoid installation above heat source objects, in areas where direct sunlight, airflow and temperature change significantly.
5. Avoid exposing the product to the outside and directly in the rain.
6. Do not use sharp and hard objects or rough pollutants to impact the atmosphere lamp, so as not to affect the function and appearance.
7. Do not leave the power cord idle on the ground to avoid stumbling.
8. Children who are not supervised by adults are not allowed to use this product alone. Some parts of this product are imported, there is a risk of choking.

FCC Statement

This device complies with part 15 of the FCC Rules. Operation is subject to the following two conditions: (1) this device may not cause harmful interference, and (2) this device must accept any interference received, including interference that may cause undesired operation.

Any changes or modifications not expressly approved by the party responsible for compliance could void the user's authority to operate the equipment.

NOTE: This equipment has been tested and found to comply with the limits for a Class B digital device, pursuant to Part 15 of the FCC Rules. These limits are designed to provide reasonable protection against harmful interference in a residential installation. This equipment generates, uses and can radiate radio frequency energy and, if not installed and used in accordance with the instructions, may cause harmful interference to radio communications. However, there is no guarantee that interference will not occur in a particular installation.

If this equipment does cause harmful interference to radio or television reception,which can be determined by turning the equipment off and on, the user is encouraged to try to correct the interference by one or more of the following measures:

- Reorient or relocate the receiving antenna.
- Increase the separation between the equipment and receiver.
- Connect the equipment into an outlet on a circuit different from that to which the receiver is connected.

-- Consult the dealer or an experienced radio/TV technician for help.
To maintain compliance with FCC's RF Exposure guidelines, This equipment should be installed and operated with minimum distance between 20cm the radiator your body: Use only the supplied antenna.