

HHWL-C02



User Manual

Thank you for purchasing and using our product!
To improve your experience, please kindly read the user manual first.

Product Specification:

Product name	HHWL-C02
Bluetooth version	V5.3
Product compatibility	Android/Apple
Transmission distance	8-10M
Trumpet	13 copper ring composite film
Power consumption	6mAh
Range	5H
Charging case battery life	16H+
Standby time	180 days
Charging Time	1.5H
Battery capacity	30mAh*2
Battery capacity	200mAh
Charging interface type	Type-C
Charging voltage	5V/1A
Color	White, black, green, blue, yellow, purple, orange, red, camel

Product Overview: charging

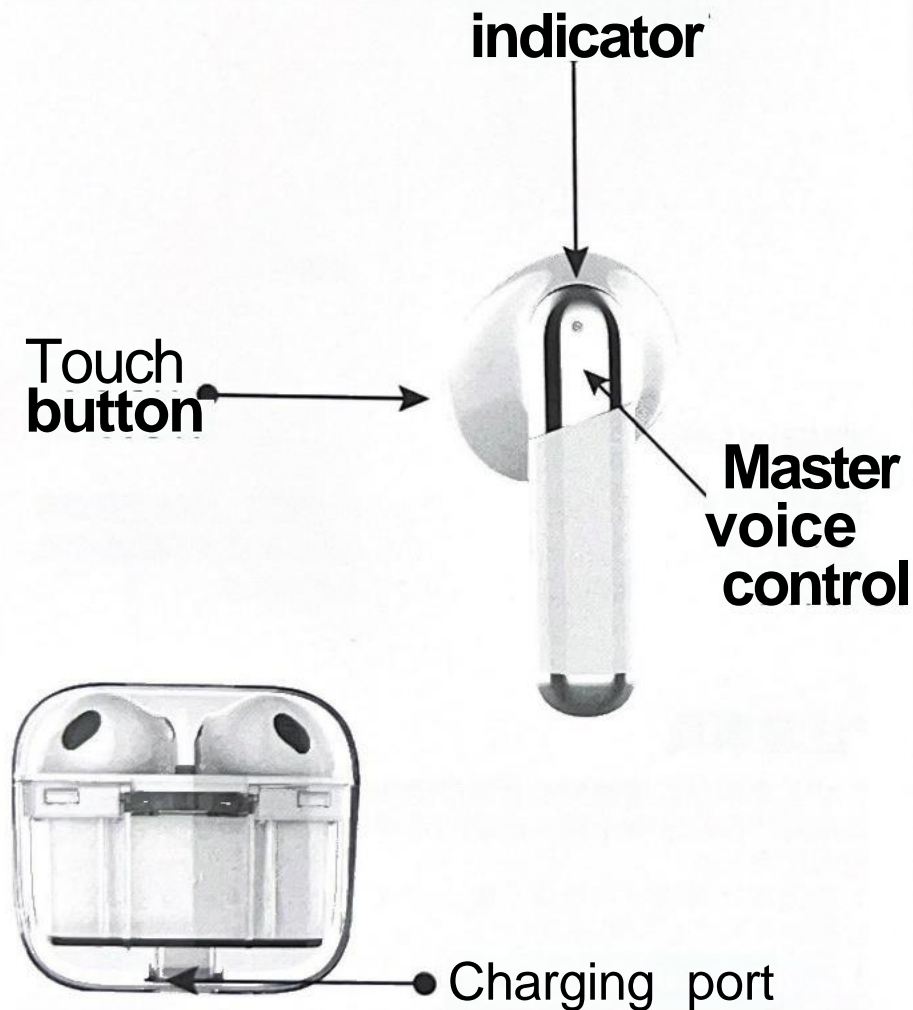

Accessories List

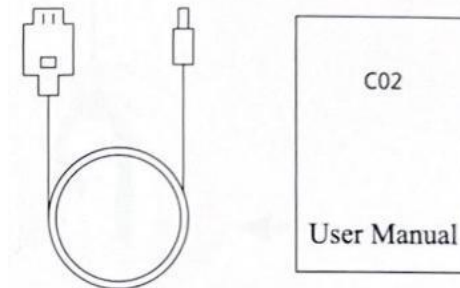

How to Use:

Turn on the device's Bluetooth and headset charging box to enter the pairing mode. Click the headset pairing name found by Bluetooth: C02 to pair. The headset will display a prompt tone to indicate successful pairing. If the headset is not paired successfully within 5 minutes, it will turn off automatically.

* Warning

1. Do not use corrosive detergent to clean this product.
2. Store the product in a dry environment and charge the charging case at least once a month.
3. Please adjust the volume to the most appropriate state when using it. High volume may cause a risk of hearing loss.
4. It is forbidden to dismantle, impact or throw into fire without permission. If expansion occurs, do not continue to use it. Do not put it in high temperature environment.

Operation Instructions

Left ear click pause/play

Double-click on the last track

Three clicks for volume reduction

Long press voice assistant

Right ear click pause/play

Double click on the next track

Three clicks for volume

Long press voice assistant

Call click answer/hang up, both ears

Double-click no action

Three clicks left ear volume reduction

Three clicks on the right ear to increase volume

Long press 3 seconds to reject, both ears

Maintenance instructions:

This card is only valid for use in products by the warranty, as detailed below:

1. Purchasing the products through legal and formal channels;
2. Non-human damage products, including but not limited to private disassembly, improper use, In case of natural disasters, etc, it is not covered by the warranty;
3. Not exceeding product warranty period, It includes and is not limited to the above, The company reserves the right of final interpretation.

Warranty Card

Customer name: _____

Contact Number: _____

Contact Address: _____

Product Model: _____

Brief description of the problem: _____

Product certification: _____

Inspectors: _____

Production and inspection date: _____

This device complies with part 15 of the FCC Rules. Operation is subject to the following two conditions: (1) this device may not cause harmful interference, and (2) this device must accept any interference received, including interference that may cause undesired operation.

Any changes or modifications not expressly approved by the party responsible for compliance could void the user's authority to operate the equipment.

NOTE: This equipment has been tested and found to comply with the limits for a Class B digital device, pursuant to Part 15 of the FCC Rules.

These limits are designed to provide reasonable protection against harmful interference in a residential installation. This equipment generates, uses and can radiate radio frequency energy and, if not installed and used in accordance with the instructions, may cause harmful interference to radio communications. However, there is no guarantee that interference will not occur in a particular installation.

If this equipment does cause harmful interference to radio or television reception,

which can be determined by turning the equipment off and on, the user is encouraged to try to correct the interference by one or more of the following measures:

- Reorient or relocate the receiving antenna.
- Increase the separation between the equipment and receiver.
- Connect the equipment into an outlet on a circuit different from that to which the receiver is connected.
- Consult the dealer or an experienced radio/TV technician for help.

The device has been evaluated to meet general RF exposure requirement.

The device can be used in portable exposure condition without restriction