

S-03 PRO LIGHT



SPECIFICATION

Model : S-03 PRO LIGHT

Screen: Amoled Display

Screen Size: 1.78"

Watch Size: 38.5mm X 45.5mm

Weight: 29g(Watch only)

Working Temp: -20-60 C

Battery : 320mAh

Input: 5VDC

Battery type: Lithium

BT Connection type: BLE5.0+BT3.0

Waterproof: 3ATM

Watch Strap: Silicon

Strap Size: 22mm

Support: Android 8, iOS 13 or above (Downloading the APP on iPad or Tablet is not supported)

WATCH ON/OFF



Long press the side pusher for 3 seconds, the display will show SECTOR logo and turn on. While turn on, you can long press the pusher turn off.

HOME DISPLAY



Watch Face



Left, Right Move



To change watch face, press and hold the display while in home mode. You can swipe right or left to change watch face, you will find 10 watchfaces in the WATCH and 10 additional watch faces in the APP that you will be able to switch directly from the APP.

Quick Change Function

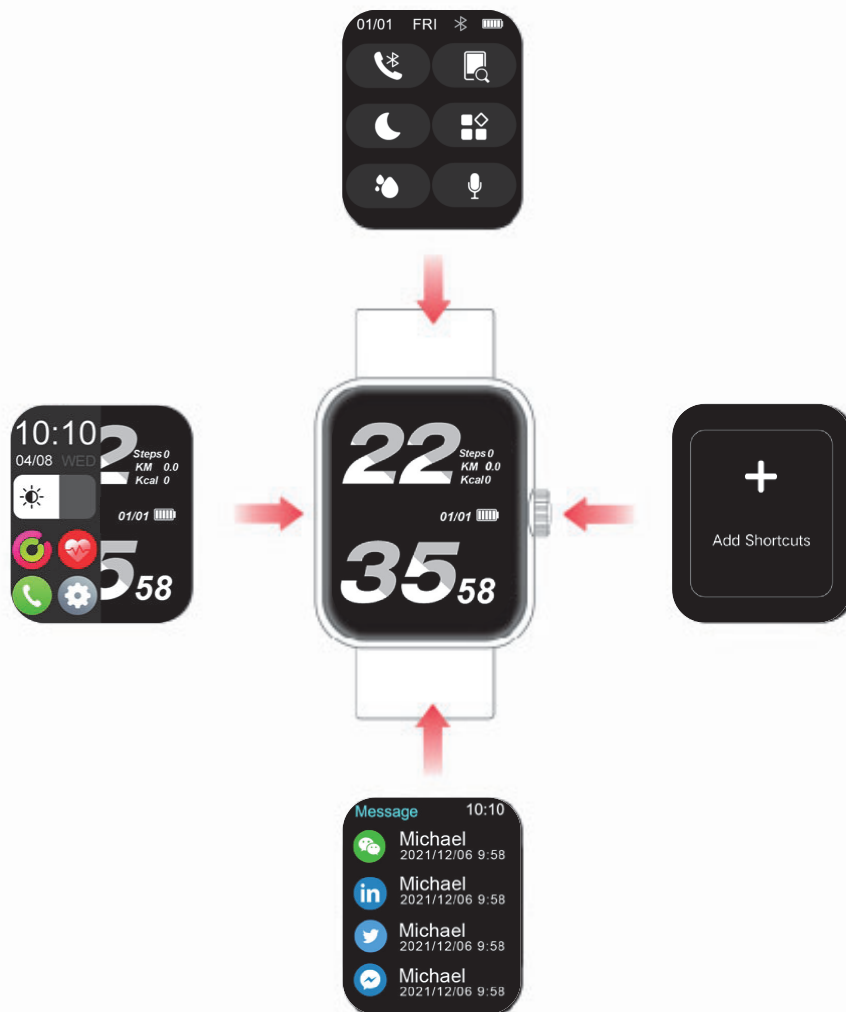

You can swipe down or right to the shortcut function button interface, swipe up to the notification interface, and swipe left to the interface of adding common function interface.

Quick Change Function

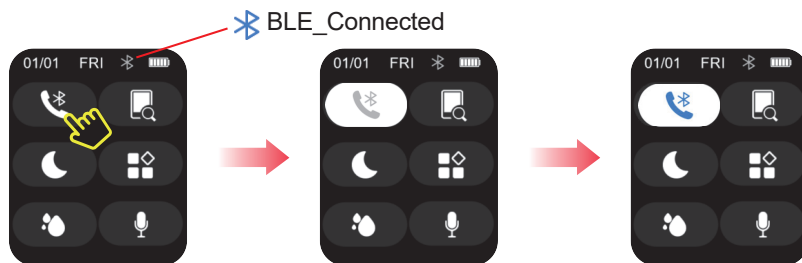

Press the phone icon and from grey (not activated) it will turn to white striped (active), then connect manually from the phone to S-03 PRO LIGHT. Once the BT connection is established, the icon will turn blue.



Press Search icon to Find phone interface.

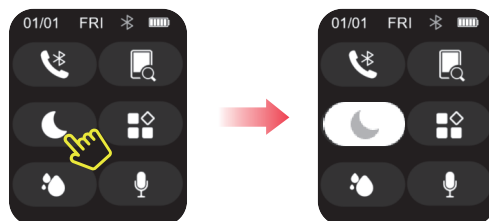

Press the moon icon and from grey (not activated) it will turn to white striped (active), enable do not disturb mode.

Quick Change Function

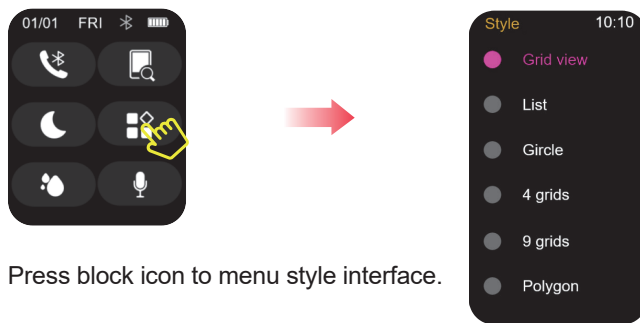

Press block icon to menu style interface.

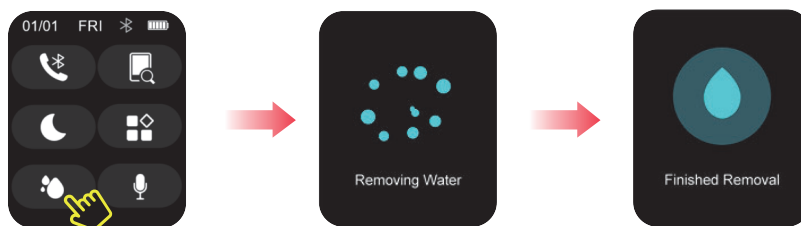

Press water drop icon, the watch will vibrate and drain the speaker cavity.
Note : waterproof 3ATM

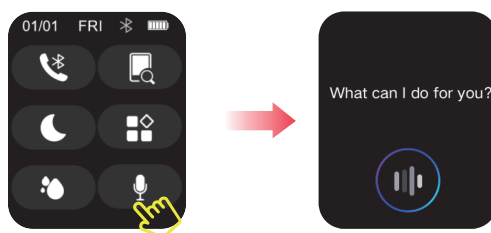

Press microphone icon to voice assistant interface, when the phone is connected to the watch via Bluetooth, the phone's voice assistant can be called up via the watch.

MAIN MENU

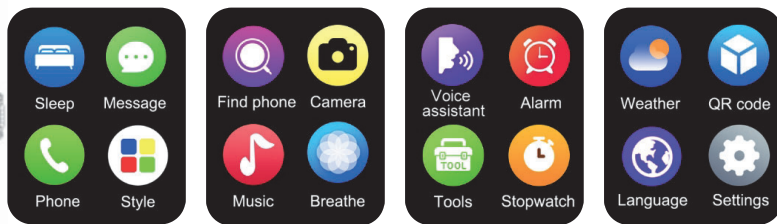

4 grids

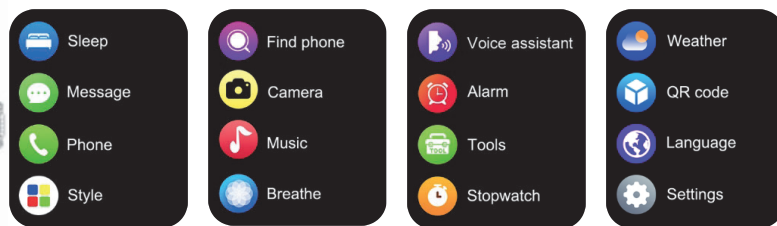

List

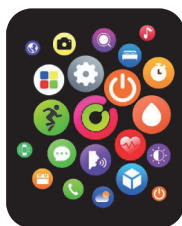

Grid view

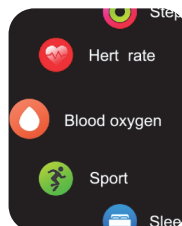

Circle



9 grids



Polygon

You can set 6 different menu styles.



Sports

Press "sports" to select the sport activity you want to perform.

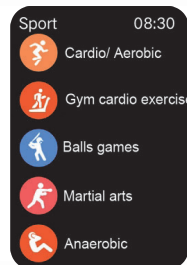

Total:
40 sport activitie

After pressing the icon you can find all the details of calories / timing of the activity. To stop the activity you can either long press on the icon or long press the side pusher. After the activity you will find a recap of distance / calories / time. We suggest to keep the phone close to the device as the GPS signal is from the phone.

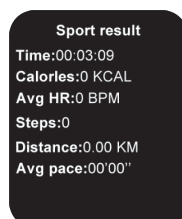
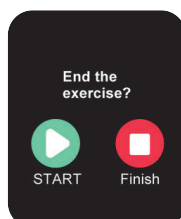
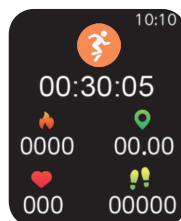
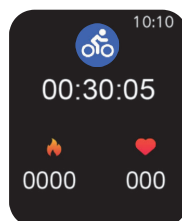
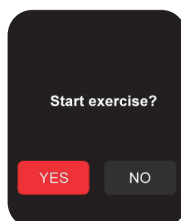



Heart Rate

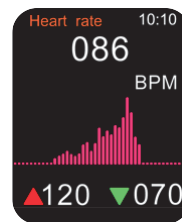
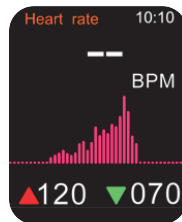

Press the heart rate icon and wear the smartwatch tightly. After around 10-12 seconds the heart rate record will show.



Blood oxygen

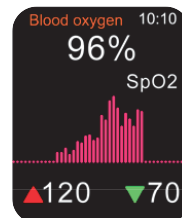
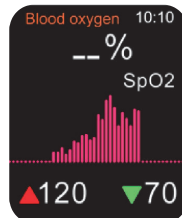

Press the blood oxygen icon and wear the smartwatch tightly. After around 30 seconds the blood oxygen record will show.

DISCLAIMER BLOOD OXYGEN

The method of capturing the blood oxygen through an optical sensor used by this Sector watch does not reach the level of precision and accuracy of a professional medical device, nor can it guarantee the equivalent stable readings. The watch cannot replace a medical device in its function of detecting or diagnosing pathologies, heart or other diseases.

If you suspect any anomaly, always consult your doctor and in case of emergency, immediately contact emergency services in your area.

We group assumes no responsibility for any claim that may arise from the use and/ or interpretation that the user of the device and/ or third parties may make of the blood oxygen information provided by their devices.

Steps

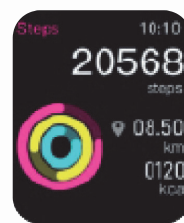

Press the step icon to read the step counter, distance, calories of the day. Swipe right to go back to the menu.

Message

One touch to read
Notification Message

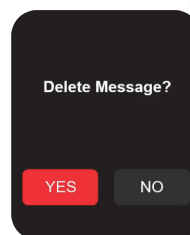
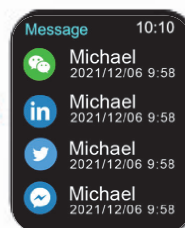
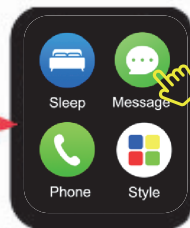

Press message icon and by swiping up and down you can read all the messages and notifications. Swiping left will ask you to delete all the notifications.



Sleep



By pressing "sleep" icon you will see your sleeping record if you have been wearing the smartwatch while sleeping. More sleeping details will be shown in the APP as well.



Weather

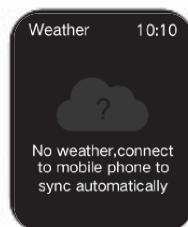

By pressing "weather" icon you will see weather of today and of the next few days. In order to show this function, the smartwatch need to be always connected to the smartphone.



Stopwatch

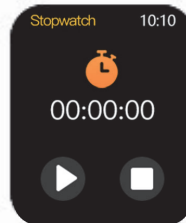
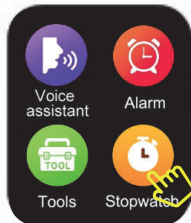

By pressing "stopwatch" icon you can start a timer. You can stop or resume the timer as you prefer.



Find Phone

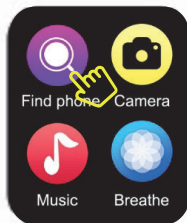

One touch on Find Phone

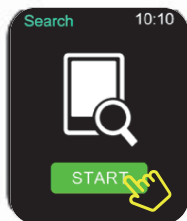

The smartphone will have a notification and ring / vibrate. It has to be connected via Bluetooth to the smartwatch.



Language



You may change up to 10 different languages:

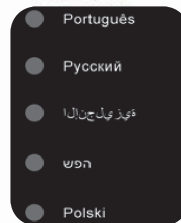
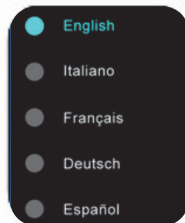

Phone

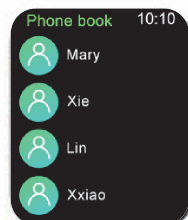

You might also sync your phone contacts to your smartwatch. You need to import the contact from the APP and they will be visible and open to call from the smartwatch.

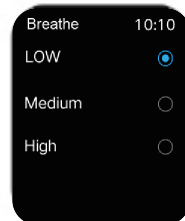
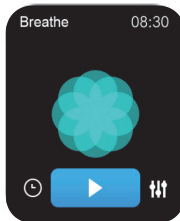
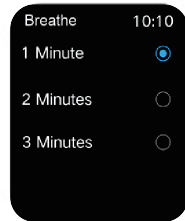
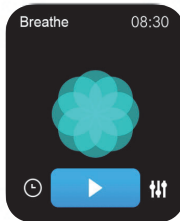

By pressing "breath" icon you will start a breath exercise. You can setup the length of the exercise as well as its pace.

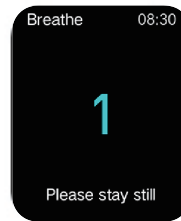
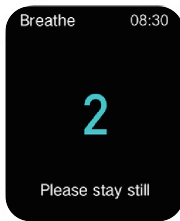
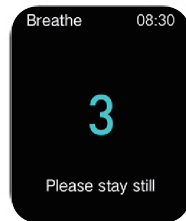
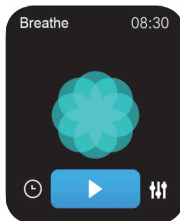

Breathe In(Vibrate)

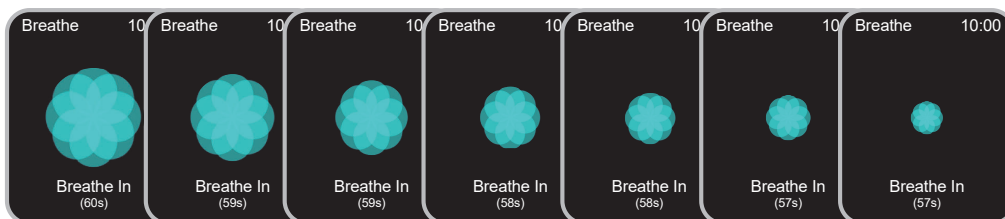

Breathe Out

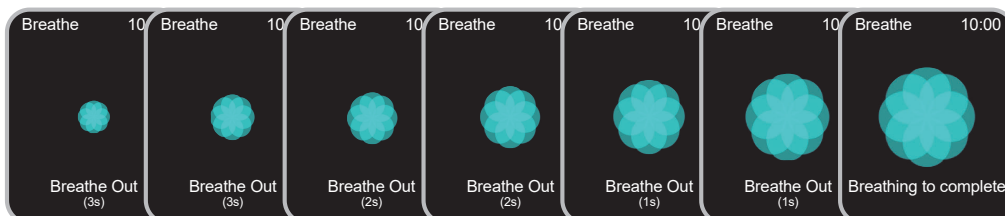



Voice assistant

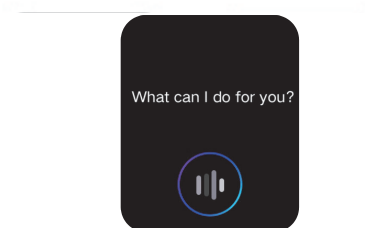

By pressing "voice assistant" icon to voice assistant interface, when the phone is connected to the watch via Bluetooth, the phone's voice assistant can be called up via the watch.



Calculator

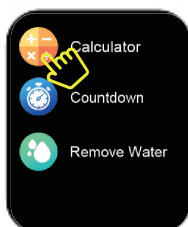

By press "Tools"--"Calculator" icon, you will enter the computer interface.



Countdown

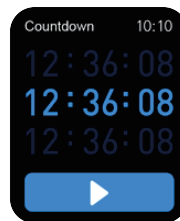
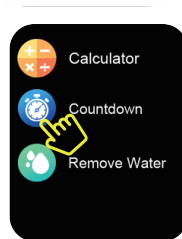

By pressing "Tools"--"Countdown" icon, you will enter the countdown interface.



Remove Water

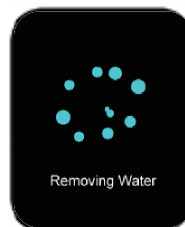
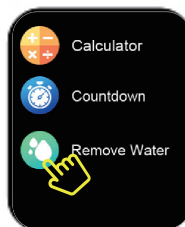

By pressing "Tools"--"Remove Water" icon, the watch will vibrate and drain the speaker cavity.

Settings



①



②



③



④

About

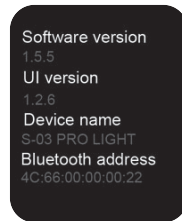
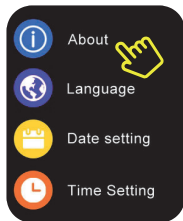

Press About icon to read your smartwatch information.

Date setting

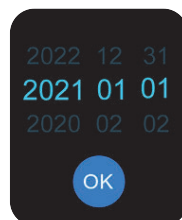
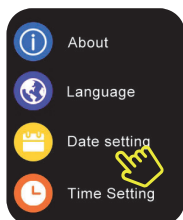

Press Date setting icon to set the date of your watch.

Time Setting

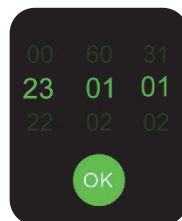
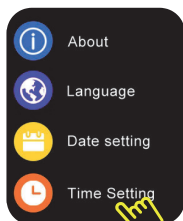

Press Time Setting icon to set the time of your watch.

Brightness

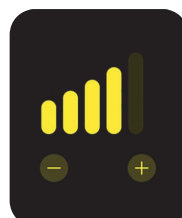
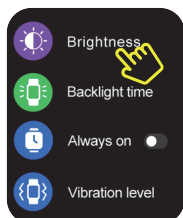

Press Brightness icon, Press + or - to select your watch brightness

Backlight time



Press "backlight time" icon, you will select for how long the display will remain active.

Always on

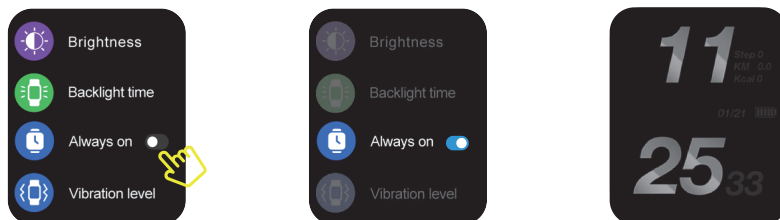

Press Always on, the switch dial screen will continue to light up.

Vibration level

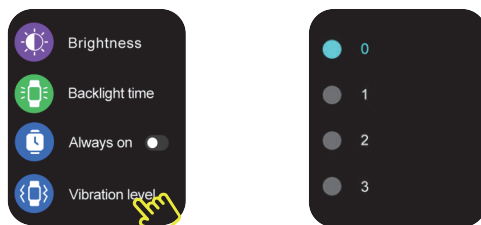

Press Vibration level icon, To set your watch vibration style.

Watch face



Press Watch face icon, you can set different dial for your watch.