

## Wireless Bluetooth 2D Barcode Scanner

### Quick Start Guide

#### Items List :

Barcode Scanner X1    USB Cable X1    Quick User Guide X1  
Bluetooth Adapter X1    Power Adapter (Optional)    Warranty Card X1



#### Warning:

- 1 Please remove the power and all cables under thunderstorm weather condition, to avoid damage from thunder and lightning.
- 2 Keep away from heat sources, please ensure sufficient air circulation.
- 3 Pay attention that the scanner is waterproof during storage, transportation and running.
- 4 Please use DC 5V1A power adapter offered by the authorised producer.

The product specifications and consultations mentioned in this manual are for reference only and are subject to change without prior notice. Unless there is a special agreement, this manual is only used as guidance. All statements and information in this manual will not constitute guarantees of any kind.

**The company reserves the right to interpret this manual.**

### Bluetooth wireless connect to computer

Bluetooth adapters support windows XP/win8/win10/MacOS etc. operation system. Support using without drivers(plug and play).



#### Bluetooth adapter

Instruction of bluetooth Adapter indicator light  
Blue LED flashing(on/off ration 1:1):  
Red LED keeps on :

Searching the sign of the scanner  
Successful connection. You 'll hear the sound of a drop after 5 seconds.

Red LED keeps on , blue light on and off quickly:

Successfully receive the message from the scanner



- ★ Rich decoding types
- ★ Completely independent intellectual property
- ★ Up to 30 million times button life
- ★ 2600mAh big capacity Li-ion

- ★ Wholebody shockproof dropresistance design
- ★ Extremely comfortable operating handle feeling
- ★ 16Mb mass storage
- ★ Deep sleep technology no boot press-and-scan

### Know Bluetooth 2D Barcode Scanner

Bluetooth red light 1D 2D barcode scanner gun integrates high-performance processor and decoding board, fast decoding and high-precision reading ability. It can effectively resist ambient light interference, easily read paper, goods and other media barcodes, also can scan barcodes on mobile phone, computer, TV, display, etc. Compared with similar products, scanning distance is greatly improved. It also boasts fast scanning speed, powerful reading performance with high accuracy.

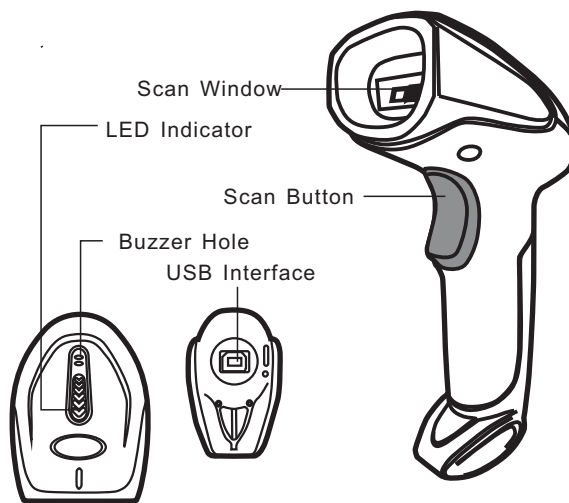

### Directly connect usb cable to windows

USB cable direct connecting supports WindowsXP/win7/win8/win10/Mac OS etc operating systems.



### Disclaimer

The company does not undertake any responsibilities for losses caused by natural disasters (such as earthquakes, floods, etc.) beyond the scope of our responsibility. The company also assumes no responsibility for any loss in any case (including loss resulting from the use of user manual) accompanied by the use of this product, such as: loss of company profits, reputation loss, business interruption, or loss / change of stored data, etc., and any special, incidental, consequential or indirect loss resulting from this.

The company accepts no liability for loss arising from misuse communication hardware or software unspecified by the company. The company does not provide any forms of guarantees and technical supports for information, data, files or other products and services obtained through using this product.

The company does not assume any forms of guarantees and technical support responsibilities for the third-party software used through this product.

### Connect with Android mobiles wirelessly via bluetooth

- 1 Enter bluetooth setup , search signal then click HID Keyboard.
- 2 You 'll get HID Keyboard in the device after successful connection.

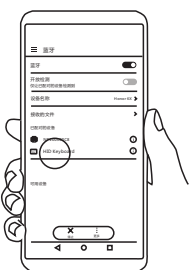

3

Open related APP/QQ/Wechat, you can get the barcode in the input box after scanning.

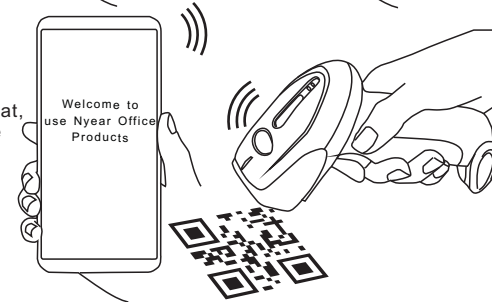

### Connect with IOS mobiles wirelessly via bluetooth

- 1 Enter bluetooth setup , searching signal then click HID Keyboard.
- 2 Click "pairing" then connect with HID Keyboard

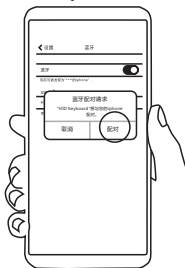
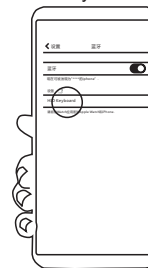

3

Open related APP, you can get the barcode in the input box after scanning.

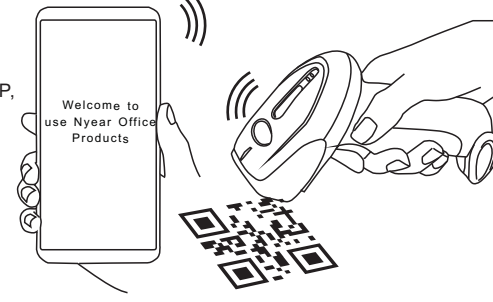

## Scanner light

The blue light is on and off quickly: The bar code is successfully read and a short tone (high frequency) is emitted at the same time

Flashing green (light and dark ratio 1:3) : indicates a successful connection

Red light charge indicator, red light will always be on when charging.Red light goes out when full

The blue light flashes blue light when Bluetooth transmits data A short tone (high frequency)

Blue light is always on Low reminder

## Scanner buzzer

### Whistle method

### Instruction

A long sound (high frequency)	Indicates that the power is on
A short tone (high frequency)	Indicates reading the bar code
Repeated long tone (low frequency)	Means upload data and clear FLASH
A short tone (high frequency)	Indicates that the power is off

### Function barcode remarks

Each type of barcode has its own unique properties. The module can be adapted to this through the setup code in this chapter. These properties change. The fewer types of barcodes that are enabled to enable reading, the faster the module can read. You can disable the type of barcodes that the module will not read, which can be used to improve the performance of the module.



\*Open EAN-8



Close EAN-8



\*Open EAN-13



Close EAN-13



\*Open Codabar



Close Codabar



\*Open Code 39



Close Code 39



\*Open Code 93



Close Code 93



\*Open Code 128



Close Code 128

## Common Function Barcodes



Output GBK format Chinese



Output UNICODE format Chinese



Add carriage return + line feed



Add TAB (HT)



Add Return CR



End character



Turn on 2D



Empty storage area



Five minutes automatic shutdown



Half-hour automatic shutdown



Turn on/off sound



Clear FLASH



Open inventory



Close inventory

Note: This scanner can only be paired and connected to a mobile phone if it is connected via Bluetooth. If it is replaced.The mobile phone needs to scan "Erase Pair" and then pair the connection.



Wipe out pairing



\*Open UPC-A



Close UPC-A



\*Open UPC-E0



Close UPC-E0



\*Open UPC-E1



Close UPC-E1



Open PDF417\*



Close PDF417



Open Industrial 2 of 5



\*Close Industrial 2 of 5



Open Matrix 2 of 5



\*Close Matrix 2 of 5



Open QR Code\*



Close QR Code



Open PDF417\*



Close PDF417



\*Open Data Matrix



Close Data Matrix



\*Disable Invoice Mode



Use Invoice Mode



Open Interleaved 2 of 5



\*Close Interleaved 2 of 5



1

Restore factory value

2

Note: After scanning 1 stagnates 5 seconds to sweep 2



**FCC Warning:**

This equipment has been tested and found to comply with the limits for a Class B digital device, pursuant to part 15 of the FCC Rules. These limits are designed to provide reasonable protection against harmful interference in a residential installation. This equipment generates, uses and can radiate radio frequency energy and, if not installed and used in accordance with the instructions, may cause harmful interference to radio communications. However, there is no guarantee that interference will not occur in a particular installation. If this equipment does cause harmful interference to radio or television reception, which can be determined by turning the equipment off and on, the user is encouraged to try to correct the interference by one or more of the following measures:

- Reorient or relocate the receiving antenna.
- Increase the separation between the equipment and receiver.
- Connect the equipment into an outlet on a circuit different from that to which the receiver is connected.
- Consult the dealer or an experienced radio/TV technician for help.

**Caution:** Any changes or modifications to this device not explicitly approved by manufacturer could void your authority to operate this equipment.

This device complies with part 15 of the FCC Rules. Operation is subject to the following two conditions:

(1) This device may not cause harmful interference, and (2) this device must accept any interference received, including interference that may cause undesired operation.

This equipment complies with FCC radiation exposure limits set forth for an uncontrolled environment. This equipment should be installed and operated with minimum distance 0cm between the radiator and your body.