

Smart Switch

Instruction Manual

>>>



Live View

Can monitor the current, voltage, and power of the load equipment in real time, and can also record the power consumption of the year, month, day, hour, and different time periods, helping users to check the power consumption of load equipment more clearly. Setting the switch status of the equipment in different scenarios, and remotely monitor the real-time situation of the load electrical appliances.

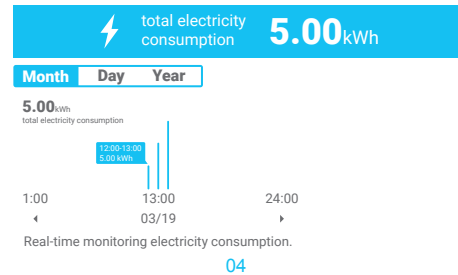

Fifth Step:
The switch is connected to the network.

Sixth Step:
After successful connection, the LED indicator light will change from flashing blue to stopping flashing.

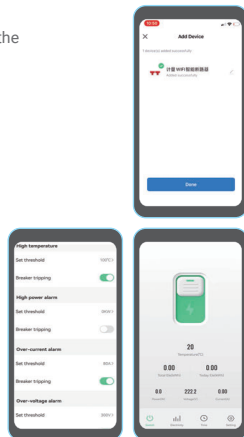

Main Function



Remote Control



Voice Control



Schedule Mode



Countdown



Temperature



Over-current



Over-voltage



Under-voltage

02

Configuration Steps

First Step:

To connect the wires from the upper of the WiFi Din Rail Switch, connect the live wire to the L pole and the neutral wire to the N pole, please make sure that the wiring is correct and the WiFi signal is strong.



Second Step:

Turn on the Bluetooth and WiFi of the mobile phone, open the APP, and then long press the "power" button, wait for about 5 seconds, the LED indicator will flash blue light.

05

FCC WARNING

This device complies with part 15 of the FCC Rules. Operation is subject to the following two conditions: (1) this device may not cause harmful interference, and (2) this device must accept any interference received, including interference that may cause undesired operation.

Any changes or modifications not expressly approved by the party responsible for compliance could void the user's authority to operate the equipment.
NOTE: This equipment has been tested and found to comply with the limits for a Class B digital device, pursuant to Part 15 of the FCC Rules. These limits are designed to provide reasonable protection against harmful interference in a residential installation. This equipment generates, uses and can radiate radio frequency energy and, if not installed and used in accordance with the instructions, may cause harmful interference to radio communications. However, there is no guarantee that interference will not occur in a particular installation. If this equipment does cause harmful interference to radio or television reception, which can be determined by turning the equipment off and on, the user is encouraged to try to correct the interference by one or more of the following measures:

- Reorient or relocate the receiving antenna.
- Increase the separation between the equipment and receiver.
- Connect the equipment into an outlet on a circuit different from that to which the receiver is connected.
- Consult the dealer or an experienced radio/TV technician for help.

08

Main Data Parameter

Protocol: Wifi (Default)

Rated Operating Voltage Range: 100v-240v

Control Type: Remote Control, Manual

Poles Description: 1P+N (N Pole Pass-through)

Customization: SigMesh/ ZigBee

Model selection: Non-metering Type/Metering Type

Non-metering Type/Metering Type LED Indicator Description

The LED indicator shows a steady blue light, indicating that the device is in ON status.

The LED indicator shows a light out, indicating that the device is in OFF status.

The LED indicator shows blue flashing, indicating that the device is in pairing mode.

03

Third Step:

Click the "+" in the upper right corner, then choose the "Add Device" button to wait discovering devices, then click "Add" button.



Fourth Step:

Enter the wifi account password and click next step, wait for the switch to connect to the network.

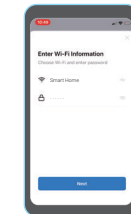

06

To maintain compliance with FCC's RF Exposure guidelines, This equipment should be installed and operated with minimum 20cm distance between the radiator and your body: Use only the supplied antenna.

Download APP



09