

The wiring method of the controller

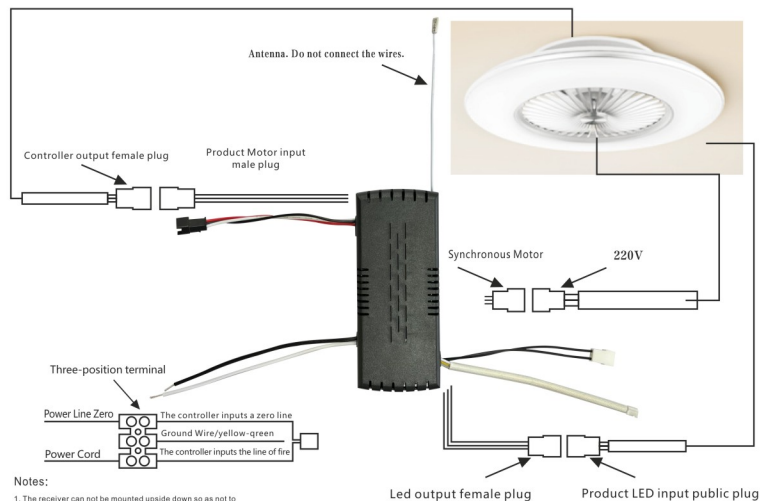

Notes:

1. The receiver can not be mounted upside down so as not to affect the cover and ceiling.
2. The receiver is divided into input and output. It is forbidden to switch the input and output.
3. Working Voltage of this product: AC: 110V-245V
4. If there is a wall switch on the fan, it must be on in order to control effectively.
5. please connect the wires according to the color of the wires and the instructions on the bushing.
6. When using the remote control, please check whether the battery (note the positive and negative pole of the battery), the handle control key, the indicator light will flash when you press each key.

DC converter (bedroom) fan and other remote control instructions

TMALL (2.4G) dimming and color mixing fan controller



Scan and download the APP

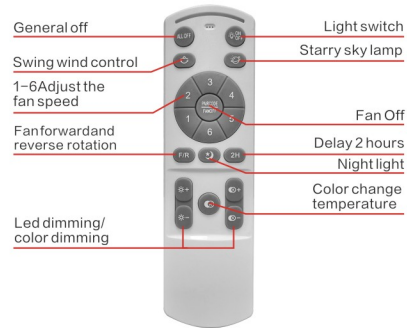
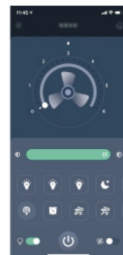

Battery type

7#1.5V*2

1. Turn on the power switch, hear the "Beep" within 3 seconds after a long press " Fan shutdown " key, the receiver issued "Beep" two sound, on the code success. If there is no successful code, turn off the power and wait one minute to repeat the operation.

Warning Sign

Remote control can not be effectively controlled please check the battery long-term non-use please remove the battery.

This device complies with Part 15 of the FCC Rules. Operation is subject to the following two conditions: (1) this device may not cause harmful interference, and (2) this device must accept any interference received, including interference that may cause undesired operation

NOTE: This equipment has been tested and found to comply with the limits for a Class B digital device, pursuant to Part 15 of the FCC Rules. These limits are designed to provide reasonable protection against harmful interference in a residential installation. This equipment generates, uses and can radiate radio frequency energy and, if not installed and used in accordance with the instructions, may cause harmful interference to radio communications. However, there is no guarantee that interference will not occur in a particular installation.

If this equipment does cause harmful interference to radio or television reception, which can be determined by turning the equipment off and on, the user is encouraged to try to correct the interference by one or more of the following measures:

- Reorient or relocate the receiving antenna.
- Increase the separation between the equipment and receiver.
- Connect the equipment into an outlet on a circuit different from that to which the receiver is connected.
- Consult the dealer or an experienced radio/TV technician for help.

Warning: changes or modifications not expressly approved by the party responsible for compliance could void the user's authority to operate the equipment

The devices has been evaluated to meet general RF exposure requirement , the device can be used in portable exposure condition without restriction