

Baby Bouncer Seat

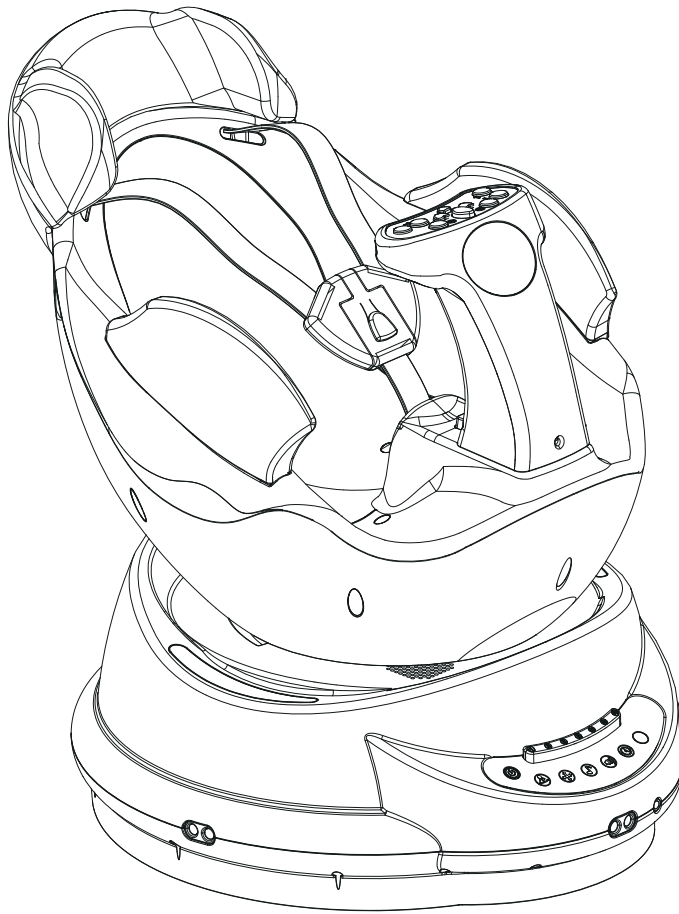

- Age : 6-36 months
- Maximum Loading weight: 20kg
- Assembly and each charge must be completed by an adult

⚠ WARNING :
Assembly by an adult

ASSEMBLY INSTRUCTION

Please read this manual carefully before use.

This manual includes important information, please keep it in for future reference.

For the first use, it is recommended to charge for 4~6 hours
Do not recharge the battery for more than 10 hours.

WARNING



To prevent children suffocating from plastic bag while playing, please keep it away with children.

never allow more than one rider(s).



Only allow to use this product on flat ground
(Not recommended to play on outdoor)

⚠ WARNING:
RISK OF FIRE. Do not bypass.
Replace only with 5 amp fuse.

FALL and STRANGULATION HAZARDS: Infants have suffered head injuries falling from swings and have strangled in straps. **ALWAYS** use restraints. Adjust to fit snugly. **STOP** using product when infant attempts to climb out

SPECIFICATION

Thank you for purchasing our products. We are always work hard to design comfortable and safe children's electric ride on toys to accompany your children through a lively and happy childhood.

A very important thing before using is to read this assembly instruction carefully. It will teach you the detailed installation procedures and the correct method of using. It can also guide you to avoid improper operations that damage the product or harm the kid. Especially, the important thing is that it will teach you a lot of safety precautions. Please memorize these contents and guide your children to use it. Please keep the assembly instruction properly and keep it in a place where it is easily to get.

Battery & fuse	6V4AH x1 (Fuse: 5A)		
Age:	6-36 months	Size:	59x48x56 CM
Loading weight:	Less than 20kg	Speed:	0.5 KM/H
Battery life:	300 times of charging	Charger:	Input: 100-240V Output: DC8V500MA
Charging time:	10~12 hours		

PART LIST

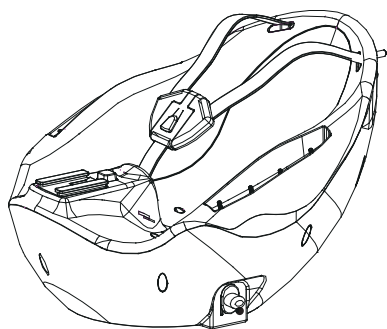

1、 Seat x1

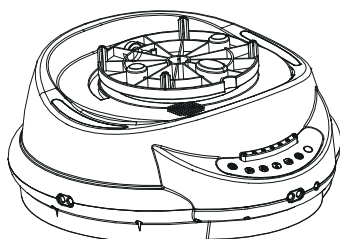

**2、 Multifunction
base x1**

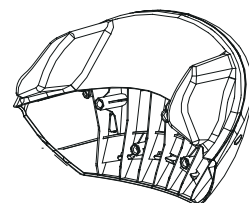

3、 pillow X1

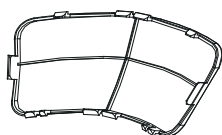

**4、 Cover of
headrest X1**

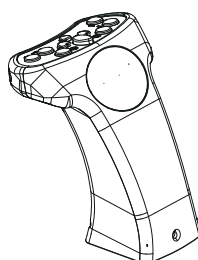

**5、 Remote
controller x1**

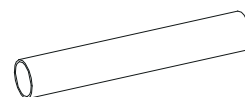

6、 Seat shaft X1

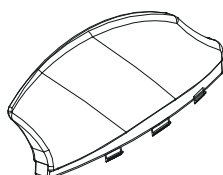

**7、 Left arm
rest X1**

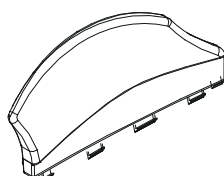

**8、 Right arm
rest X1**



9、 Seat plug A



10、 Seat plug A



11、 Seat plug A



12、 Seat plug A

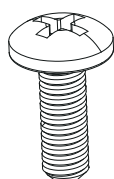

13、 Srew 4X12 x9



14、 Charger x1

ILLUSTRATION

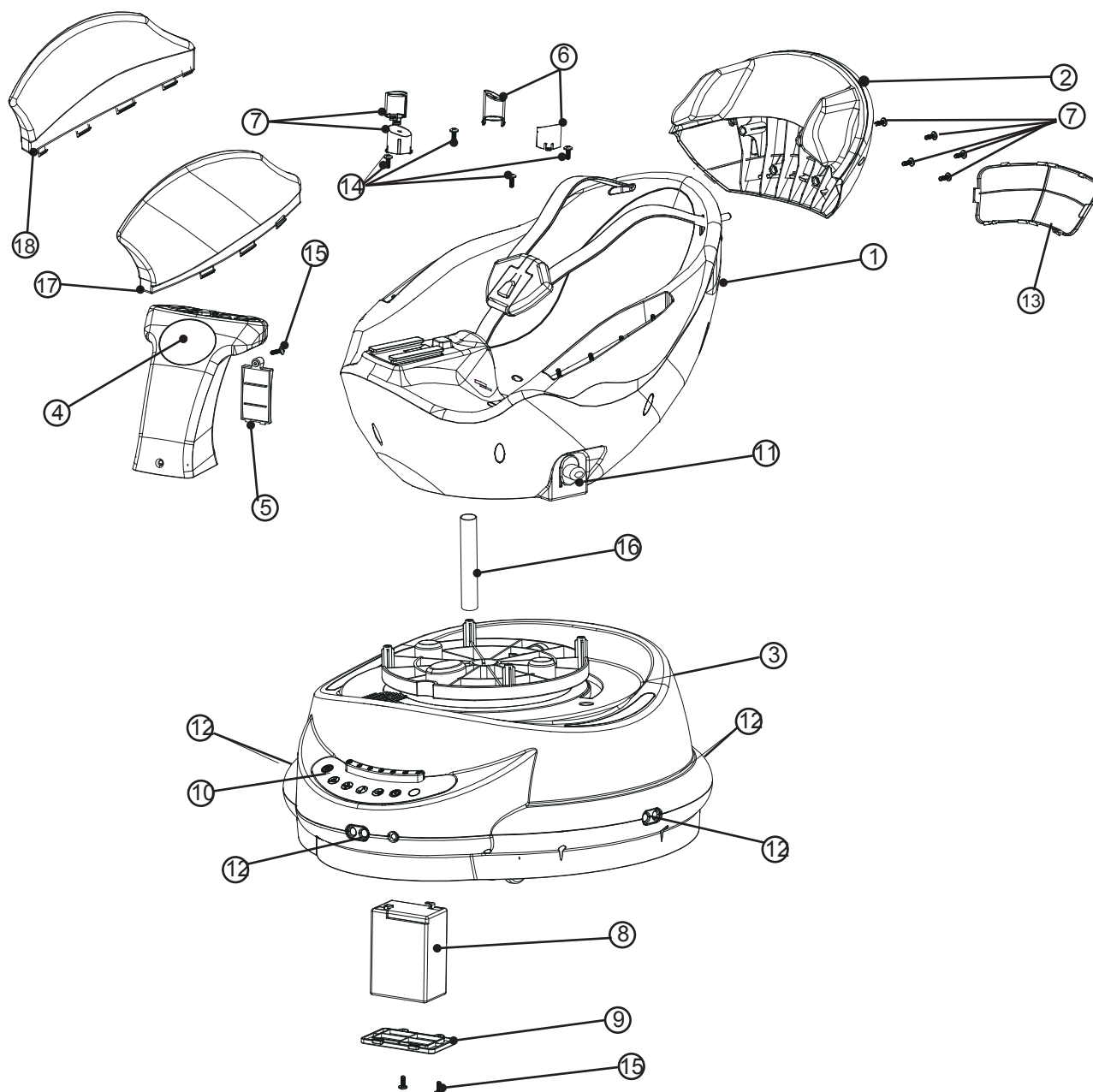

1	Seat*1	2	Head rest *1	3	Base *1
4	Remote controller *1	5	Battery cover *1	6	Seat plug AB *2
7	Seat plug CD*2	8	6V4AH Battery *1	9	Battery cover *1
10	Control panel *1	11	Seat Lock *1	12	Sensor *4
13	Cover of headrest *1	14	4X12 Screw *4	15	3.5X12 Screw *2
16	Seat shaft *1	17	Left arm rest*1	18	Right arm rest*1

ASSEMBLY STEPS

1. Assemble the vehicle before using, must be operated by an adult
2. Tools required for installation: screwdriver
3. Small parts would be the risk of choking, children are strictly prohibited to touch and play!
4. Please be carefully check the quantity of all parts before installation, and the product packaging plastic bag, please keep it properly, children are strictly prohibited to play, there is a danger of suffocation!

1

- Turn over the car base.
- Use screwdriver to remove two 3.5X12 screws.

2 x 3.5X12

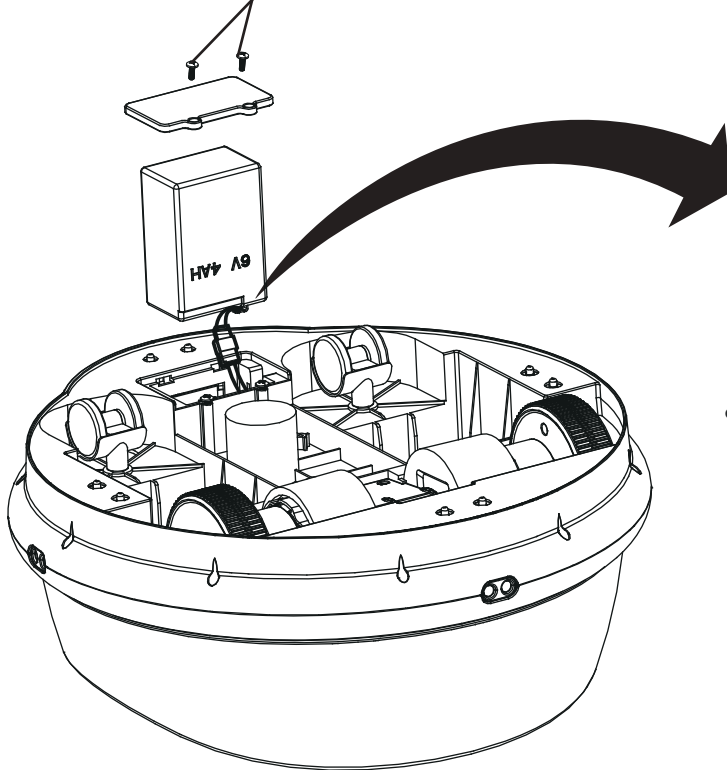

After installing the battery, turn on the power switch, wait for about 5 seconds, the car will complete self-check. Until it is OK, then turn off the power, and proceed to the next step.

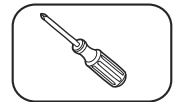

Not include



- Remove the wires on the side and plug into the terminals.

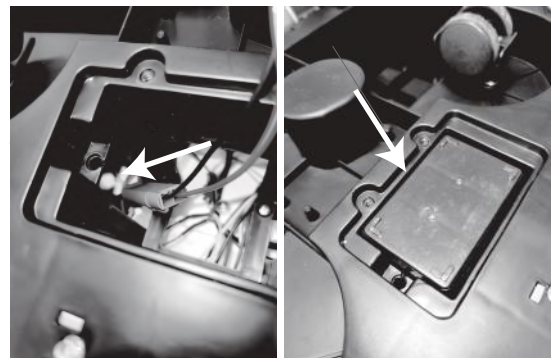

- Put the connected terminals into bottom space, put the battery in, assemble the battery cover and tighten the screws

ASSEMBLY STEPS

1. Assemble the vehicle before using, must be operated by an adult
2. Tools required for installation: screwdriver
3. Small parts would be the risk of choking, children are strictly prohibited to touch and play!
4. Please be carefully check the quantity of all parts before installation, and the product packaging plastic bag, please keep it properly, children are strictly prohibited to play, there is a danger of suffocation!

2

- Put the arm rest on the left side of the seat, Press down to snap.
- Put the arm rest on the right side of the seat, Press down to snap.

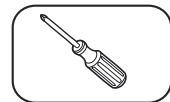

Not include

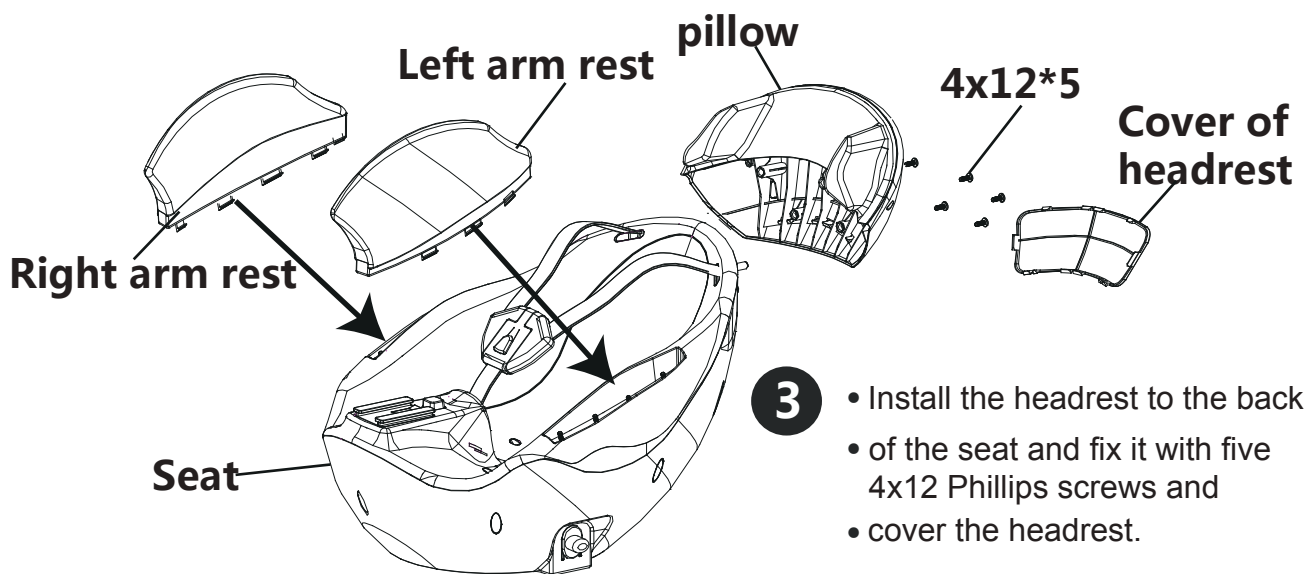

3

- Install the headrest to the back
- of the seat and fix it with five
- 4x12 Phillips screws and
- cover the headrest.

ASSEMBLY STEPS

Seat Plug A/B

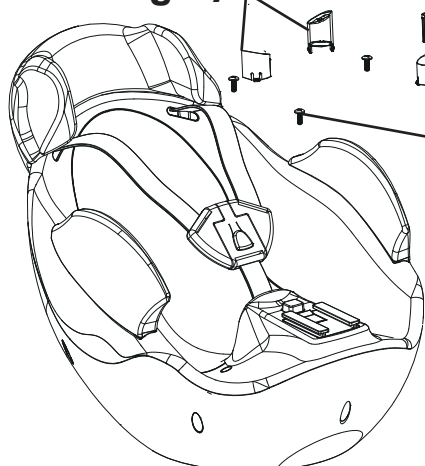

Seat Plug C/D

4X12*4

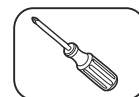

Not include

4

- Assemble the seat with the base
- Fix it with 4 pcs 4X12 screws
- Take seat plug A/B/C/D and plug into the screw hole

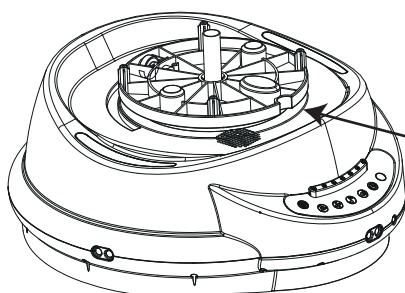

Note: The direction of the notch needs to be turned to the front before installing the seat.

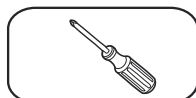

Not include

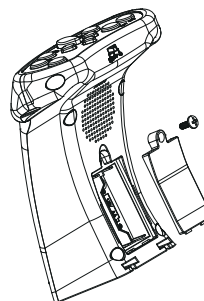
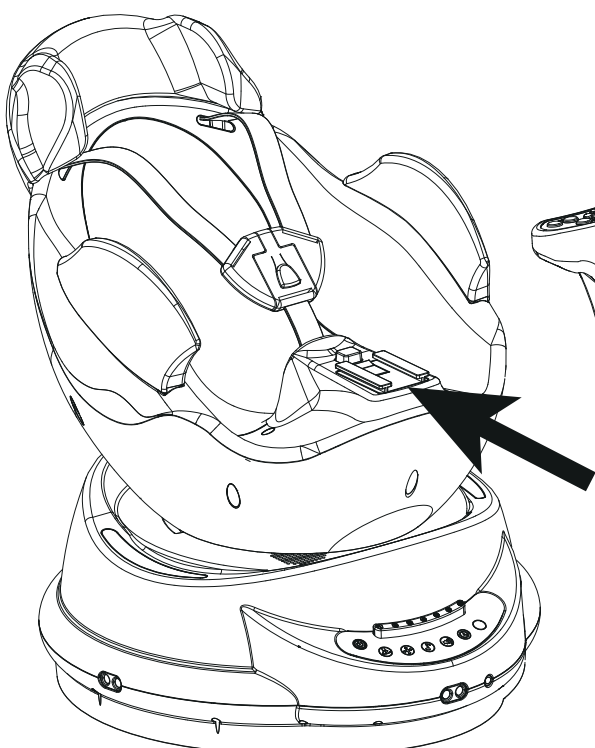

AA (No. 5) battery installation position
(Note: Positive and negative poles cannot be installed reversely).

5

- Slide in the controller carefully as beside illustration shown.

⚠ WARNING:

- Do not mix old and new batteries. Do not mix alkaline, standard or rechargeable batteries
- Non-rechargeable batteries are not to be recharged,
 - The rechargeable batteries should be charged under adult supervision
 - Batteries are to be inserted with the correct polarity (+ and -)
 - Exhausted batteries are to be removed from the toy.
 - The supply terminals are not to be short-circuited,

WARNING!

To prevent accident happend:

- When playing the car, it must be guided by adult or family to instruct, and adult should be accompanied with each other, keep your eye on your children all the time.
- Don't play at dangerous place such as road, near car and stairs.
- It is necessary to wear a shoe.
- The applicable age range of this product: 6 ~ 36 months; The maximum load is 20 kg.

Before using, noted to finish below process:

- **IMPORTANT!** First use, the battery needs to be charged for at least 4 - 6 hours, not more than 10 hours, and the charging can only be operated by adults
- Follow the steps described in the instruction manual to complete the installation of the whole toy. The battery plug-in has been plugged in and the power supply has been switched on;
- All positions requiring screw fixation ensure that they are locked.

Safty Warning

Please teach your child and his playmates the following safety rules and make sure they understand them!

- Must be played under adult supervision.
- A protective helmet should be worn when playing the toy.
- When playing the toy, you must wear shoes.
- When playing the toy, you must sit on the seat.
- Make sure your child plays the toy in a safe playing environment, such as home, garden or playground.
- Note that the toy is only suitable for playing on a hard and flat road surface. In order to ensure safety, it is prohibited to play in the following unsafe environments:
 - A Ditch pits, riversides, lawns, slopes or uneven ground;
 - B Roads or other vehicle forms, places where pedestrians walk;
 - C Possible to hit an obstacle that may cause injury;
 - D Other Unsafe places.
- Avoid children playing in the dark. Children will not deal with unexpected obstacles or accidents. Only during the day or in bright areas.
- Do not use this product outdoors when it rains or snows.
- When shifting gears, make sure the toy has stopped moving completely.
- Please confirm that the users of this product meet the applicable age range of this product and shall not exceed the maximum load capacity.
- Do not change the structure and wiring system of this product without authorization.
- Regularly check whether the electric wire plug-in of the toy is aging or falling off.
- To avoid accidents, please make sure the toy is safe before driving.
- Please don't let any children approach the moving toy and don't let them touch the wheels.

FUNCTION ILLUSTRATION

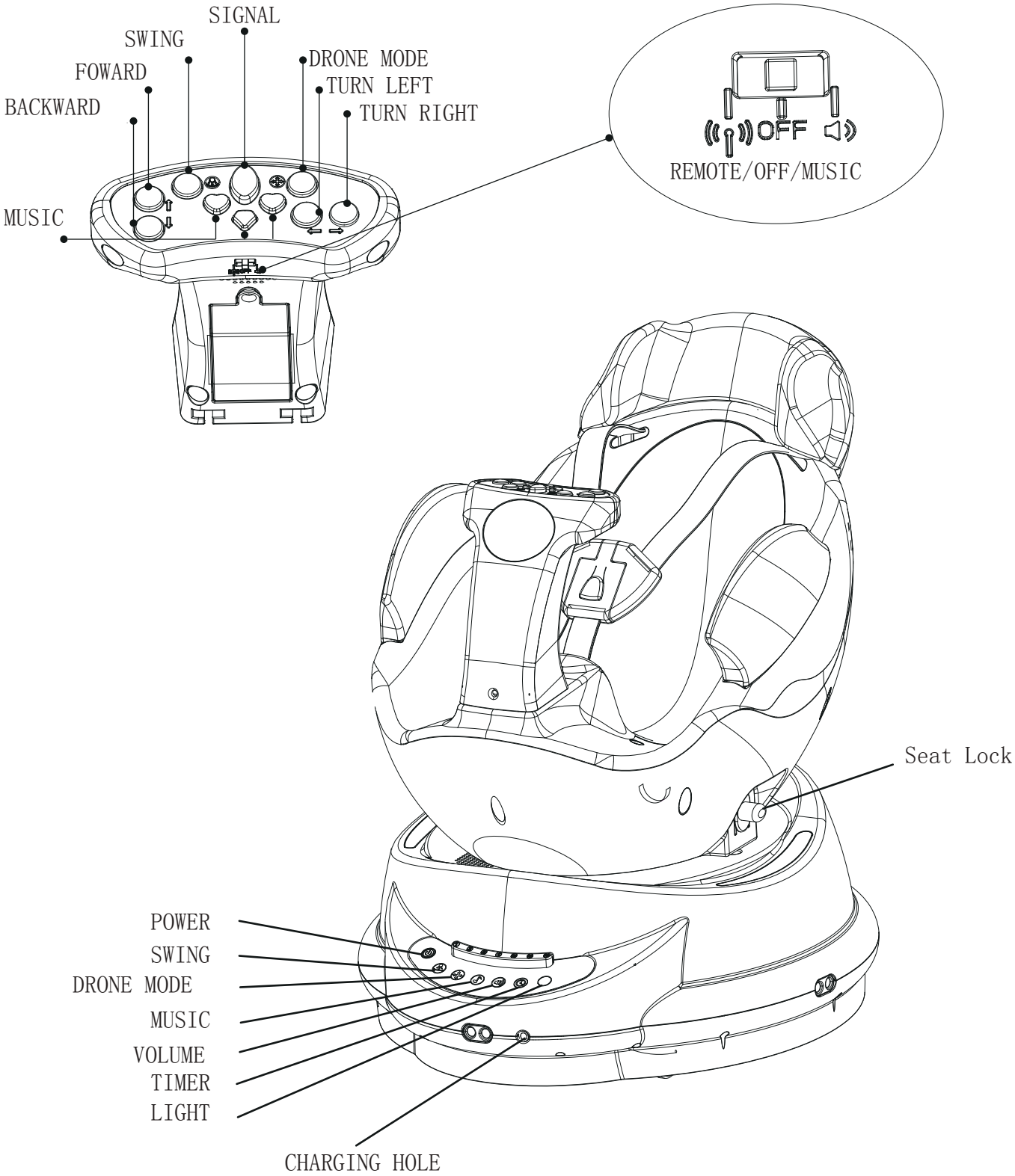

FUNCTIONS

REMOTE CONTROLLER :

1. Turn the switch to the remote control position, which can be used as a remote controller to control the car
2. Can be removed as a separate toy for babies to play
3. When the remote control is installed on the body, swing mode button on the remote control will be no function.

SWING MODE :

1. Close the seat lock (pull up)
2. Press swing mode button, the seat will slowly start to swing left and right
3. Three levels of swing.

DRONE MODE :

1. Open the seat lock (pull down)
2. Press drone mode button, car will randomly start to move forwards, backwards, left, and right. At this time, the front, back, left, and right sensor probes automatically sense the surrounding obstacles. When a certain distance, the car will automatically change directions and avoid obstacles automatically.
3. Press to start / stop / 3 routes of drone mode.

MUSIC :

1. Press the music button to play music.

VOLUME :

1. Press volume button to adjust.

TIMER :

1. Press the timer button to set timer, car will automatically turn off within the setting time.
2. Press the timer button to set, 15 / 30 minutes and stop.

LIGHT :

1. Press the light button to turn on and turn off.



WARNING!

1. The maximum speed of this car is about 0.5KM/H. Before the children drive by themselves, make sure the kid is proficient in controlling the car and fasten seat belt to avoid accidents due to excessive speed!
2. In the obstacle avoidance mode, car will stop after sensing an obstacle, and the obstacle avoidance function needs to be re-start.

CHARGING

Charging must be done by an adult

WARNING!

- Prevent fire and electric shock:

- Only the charger and battery specified by the manufacturer are allowed to be used, and other brands of chargers and batteries are prohibited. Otherwise, it may cause fire and explosion.

- Do not use this charger and battery on other products, otherwise overheating may lead to fire and explosion.

- Do not change the wiring structure of the product without authorization, otherwise it may cause fire and explosion and may cause permanent damage to the product.

- Do not connect the positive and negative poles of the battery with tools, otherwise it may cause fire and explosion

- Always keep the battery dry and do not expose it to fresh or salt water.

- When the battery is charged, it will generate harmful gases and have pungent odor. Smoking is strictly prohibited near the charged storage battery, and any fire or spark is strictly prohibited to prevent causing explosion and other accidents.

- The toy must be charged in a well-ventilated and dry area.

- Do not open the battery and charger.

- Do not reverse the battery.

- Before charging, please check whether the charger, battery and plug are damaged. If any damage is found, stop using it until it is repaired and reused.

- It is normal for the battery to generate heat during the charging process, but if the temperature is too high, it is necessary to check whether the charging current is too high or whether the battery is short - circuited.

- The battery must be fixed with a pressing plate. If the car overturned, the battery might fall out and hurt children.

- If the product is stored or not used for a long time, it must be fully charged and charged once a month to ensure the battery life.

- Chargers and batteries are not toys and children are not allowed to play.

- When charging, power switch must be turned off.

- It is recommended to charge for 4 - 6 hours before the first use, and less than 10 hours.

- When the normal running speed of the toy obviously slows down, it means the battery power is low. Please charge it in time.

- Every time use, please charge for 10 - 12 hours, but not more than 20 hours.

CHARGING

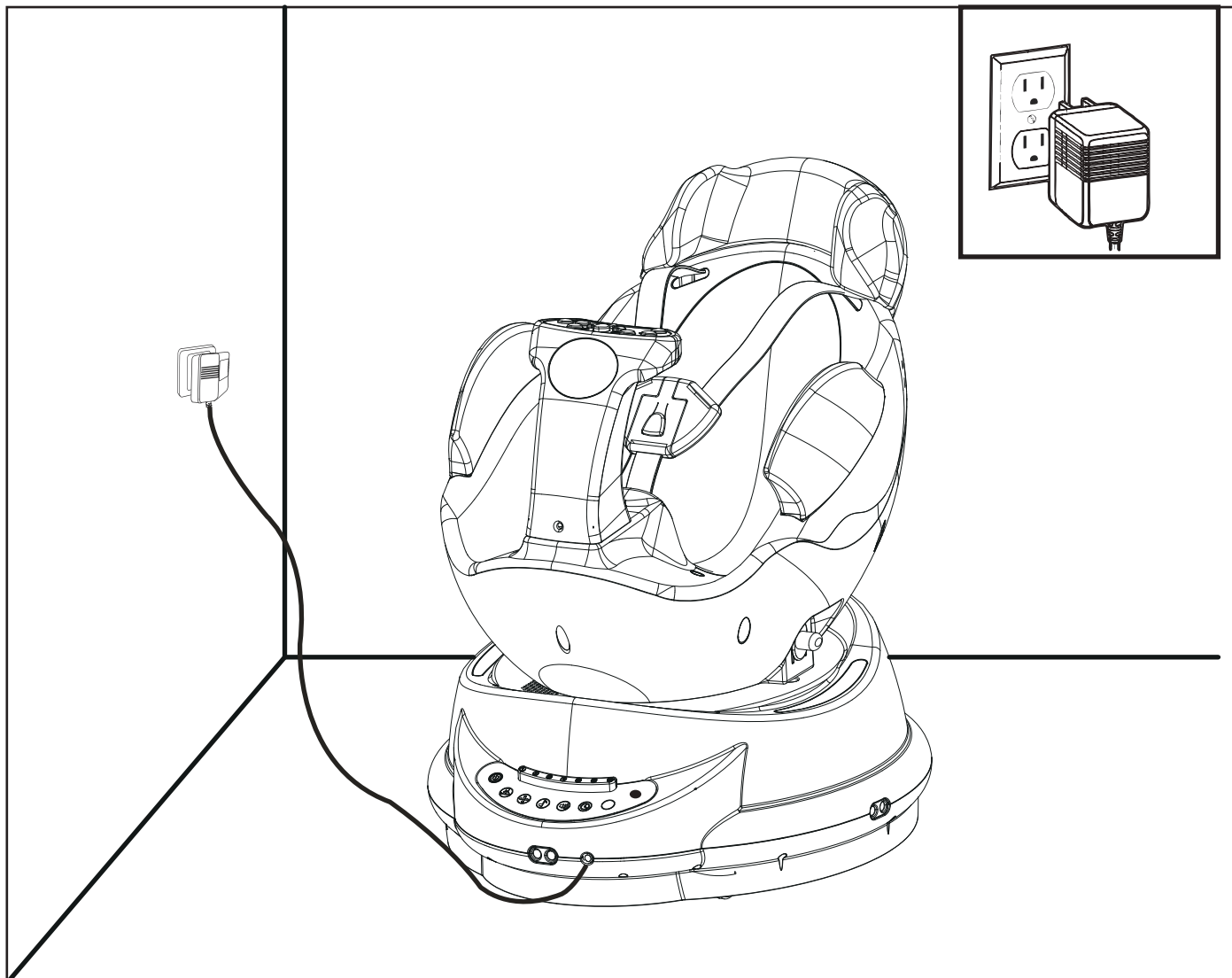

WARNING!

This product has a charging protection function: when charging, all functions of the vehicle are not available.



DISPOSAL OF BATTERY

- Your battery is a non-spillable lead-acid battery. It must be recycled or disposed of in an environmentally sound manner.
- Do not dispose of a lead-acid battery in a fire. The battery may explode or leak.
- Do not dispose of a lead-acid battery in your regular household trash. The incineration, landfilling or mixing of sealed lead-acid batteries with household trash is prohibited by law in most areas.
- Return an exhausted battery to a federal or state approved lead-acid battery recycler. Contact your local waste management officials for other information regarding the environmentally sound collection, recycling and disposal of lead-acid batteries. If you live in the state of Florida or the state of Minnesota, it is prohibited by law for anyone to throw away lead-acid batteries in the municipal waste system.

Problems & Solutions

■ Problems : Car can't move.

Reason: Battery's power is low.

After each use, please charge for 10 -12 hours, but not more than 20 hours.

Reason: Overloaded.

This car is equipped with a self-reset fuse, which will automatically cut off the power supply for 5 - 20 seconds and then restart when overloaded or not in use. The self-reset fuse of this car is installed under the seat (as shown in the photo).

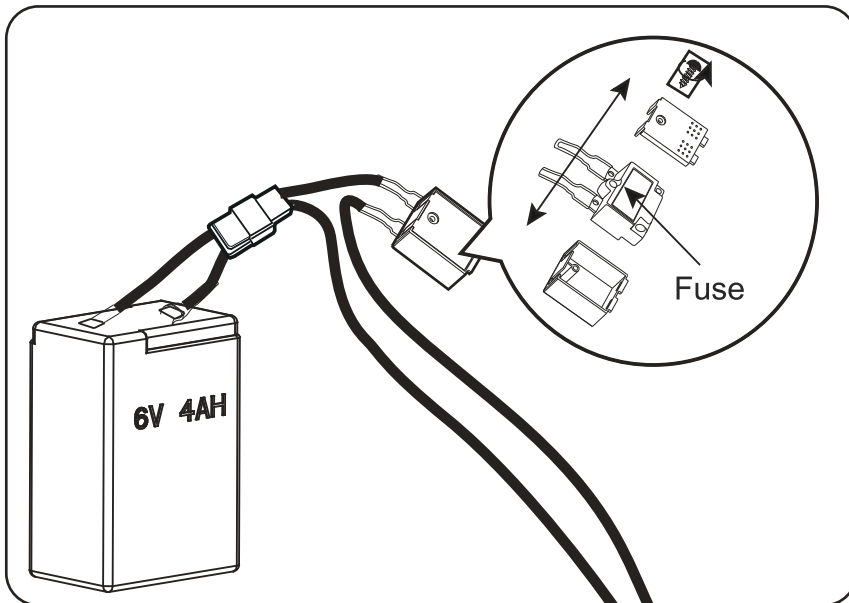

To prevent the fuse from cutting off the power supply:

- This product can not be overloaded.
The maximum load is 20kg.
- Do not drag and drop anything behind this product.
- Do not let water or other liquids soak into electrical components such as circuits and batteries.
- Don't change the wiring system and structure of this product without authorization.

Reason: Nut in drive wheel is loose.

If the nut of the driving wheel is not locked, the motor will not be able to drive the driving wheel and the toy will not be able to travel. Please lock the nut with a spanner.

Reason: The battery plug-in or wire is loose.

Make sure the battery plug-in is properly connected and there is no loose wire.

Reason: The battery is broken.

Please contact your agent or manufacturer.

Reason: Body wiring is damaged.

Please contact your agent or manufacturer.

Reason: Motor is broken.

Please contact your agent or manufacturer.

■ Problem : Charged but still no power

Reason: The battery plug-in is loose.

Make sure that the battery terminals and wires are firmly connected together.

Reason: The charger is not plugged in.

Make sure the charger is properly plugged into the power outlet.

(If the power outlet has a switch, make sure the switch is turned on.)

Reason: The charger does not work properly.

Does the charger feel slightly hot when charging? If not, it is likely that the charger has been damaged. Please contact your agent or manufacturer.

Problems & Solutions

■ Problem : The playing time of the car is very short.

Reason: The battery is under - charged.

The battery charge time is not enough. Please charge it in time after each use and at least once a month. It is recommended that the charge time should be 10 ~12 hours, not exceed 20 hours.

Reason: Battery aging.

The battery is a fragile and consumable part. Its service life mainly depends on the timeliness and correctness of its charging and maintenance operation. Therefore, the service life of the battery is 1 ~ 3 years. If it exceeds its service life, it is recommended to replace a new battery.

■ Problem: The charger is buzzing while charging.

This is a normal phenomenon.

■ Problem : The charger has a heating phenomenon during charging

This is a normal phenomenon, but if the temperature is too high, you should check whether the charging current is too high or the battery is short - circuited.

Maintenance

- Before using, parents should check whether the main components are in good condition and whether the battery, charger, wire, plug, housing and other components are damaged. Whether the screw is loose or not; Whether there is a potential safety hazard or not, stop using it when it is found damaged until it is completely repaired.
 - After a period of use, lubricate the iron parts of the vehicle with a small amount of lubricating oil to prevent wear and rust.
 - Toy should be placed far away from the fire source and avoid long-term illumination. They should be placed flat up and not upside down or tilted. In wet weather, the car should be parked indoors or covered with waterproof cloth.
 - Toy should be kept away from hotter objects such as stoves and heaters. Plastic parts may melt. Keep away from flammable objects when charging to prevent fire.
 - Please charge in time after use. Charging must be done by an adult. If it is stored or not used for a long time, it must be fully charged first and then charged at least once a month to prolong the battery life.
 - Wipe the toy with a dry soft cloth. You can also use a non - wax furniture polish instead of a soft cloth to wipe the plastic parts to achieve the surface clean effect. Do not use chemical solvents to wipe the plastic parts of toys. Do not clean the toy with soap and water. Do not drive the toy in rainy or snowy weather. Water will damage the motor, the vehicle's electrical system and the battery.
 - When you stop using or placing the product, please cut off the power supply of the product and turn all switches to the " stop" or " off" position.
 - Do not use fuses that do not conform to the specifications of this product.
 - Do not change the structure and wiring system of this product without authorization.
- Maintenance work must be carried out by professionals or under the guidance of technicians.

WARNING

FALL and STRANGULATION HAZARDS: Infants have suffered head injuries falling from swings and have strangled in straps.

- **ALWAYS** use restraints. Adjust to fit snugly.
 - **STOP** using product when infant attempts to climb out (approximately 9 months).
 - Stay near and watch baby during use. This product is not safe for sleep or unsupervised use. If baby falls asleep, remove baby as soon as possible and place baby on a firm, flat sleep surface such as a crib or bassinet.
 - **ALWAYS** place swing on floor. Never use on any elevated surface.
- SUFFOCATION HAZARDS:** Young infants have limited head and neck control. If the seat is too upright, infant's head can drop forward and compress the airway.
- **ALWAYS** keep swing seat fully reclined until infant is at least 4 months old AND can hold up head without help.

WARNING

- [1] "Never leave the child unattended"
- [2] "Do not use this product once your child can sit up unaided or weighs more than 9 kg"
- [3] "This product is not intended for prolonged periods of sleeping"
- [4] "Never use this product on an elevated surface (e.g. a table)"
- [5] "Always use the restraint system"
- [6] "To avoid injury ensure that children are kept away when unfolding and folding this product"
- [7] "Do not let children play with this product"
- [8] "Do not move or lift this product with the baby inside it"

This product does not replace a cot or a bed. Should your child need to sleep, then it should be placed in a suitable cot or bed.

- b. Do not use the product if any components are broken or missing.
- c. Do not use accessories or replacement parts other than those approved by the manufacturer.
- e. Instructions for storage (e.g. remove batteries, store away from children, ...)
- b. non-rechargeable batteries are not to be recharged;
- d. batteries are to be inserted with the correct polarity;
- e. exhausted batteries are to be removed from the infant swing.
- f. Transformers used with the infant swing are to be regularly examined for damage to the cord, plug, enclosure and other parts, and in the event of such damage, they shall not be used.
- g. The infant swing shall only be used with the recommended transformer.

WARNING:

To reduce the risk of injury, adult supervision is required.
Never use in roadways, near motor vehicles, on or near steep inclines or steps, swimming pools or other bodies of water; always wear shoes, and never allow more than one rider(s).

Manufacturer: Dongguan LiChuang Toys Co., Ltd.
Add: No. 2, Baishigang Market Middle Road, Changping Town,
Dongguan City, Guangdong Province

FCC Statement

This device complies with Part 15 of the FCC Rules.

Operation is subject to the following two conditions:

- (1) This device may not cause harmful interference, and
- (2) this device must accept any interference received, including interference that may cause undesired operation.

NOTE: This equipment has been tested and found to comply with the limits for a Class B digital device, pursuant to Part 15 of the FCC Rules. These limits are designed to provide reasonable protection against harmful interference in a residential installation. This equipment generates uses and can radiate radio frequency energy and, if not installed and used in accordance with the instructions, may cause harmful interference to radio communications. However, there is no guarantee that interference will not occur in a particular installation. If this equipment does cause harmful interference to radio or television reception, which can be determined by turning the equipment off and on, the user is encouraged to try to correct the interference by one of the following measures:

- Reorient or relocate the receiving antenna.
- Increase the separation between the equipment and receiver.
- Connect the equipment into an outlet on a circuit different from that to which the receiver is connected.
- Consult the dealer or an experienced radio/TV technician for help.

WARNING: Any changes or modifications not expressly approved by the party responsible for compliance could void the user's authority to operate this equipment.

The device must not be co-located or operating in conjunction with any other antenna or transmitter.

The device has been evaluated to meet general RF exposure requirement. The device can be used in portable exposure condition without restriction.

Warning. Not to be used in traffic.

WARNING:

The remote control is not a toy. It is for adult use only and should not be used by a child. A close adult supervision is always required. Reception range may change significantly with weather, battery and other environmental conditions.

WARNING:

Risk of accident if vehicle is used outside of a private area.
Do not use on public pathways.