

Packing list



R/C CAR X1



remote control X1

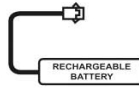

3.7V battery X1

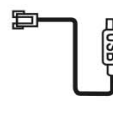

USB charging cable x1



manual x1

Battery charging

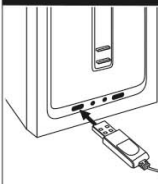

Connect the battery to the charging cable, then plug the USB charging cable into the USB port of the computer or the USB charger. Then turn on the power. When the red light is on, it means that charging is in progress, and when the red light is off it means the battery has been fully charged.

Remote Control Function

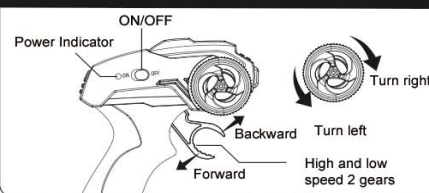

R/C car and charging method for the batteries of stunt car

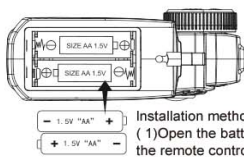

Installation method of remote control battery
(1) Open the battery cover on the backside of the remote control.
(2) Insert 2x1.5V AA batteries with correct direction and cover the battery cover.

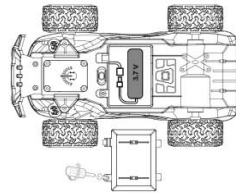

After charging is complete, open the battery cover and place the battery in the battery compartment. Connect the battery pack to the stunt car connector and close the battery cover.

Operation Method

Turn on the car's power switch. On a flat surface, stop flashing, you can operate the joystick and begin playing. Remark: Cannot operate the joystick when the transmitter indicator is flashing.

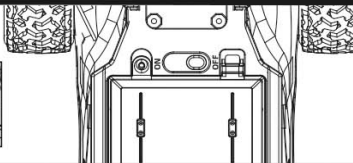
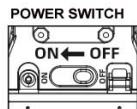

Basic operation picture showing how to USE this product

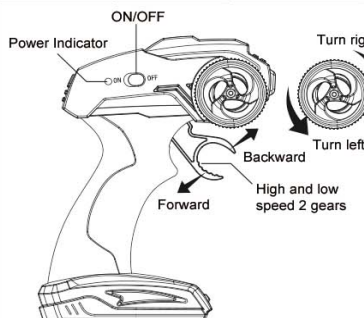

1. Pull the remote control lever backward to move the remote control car forward, and pull forward to move the remote control car backward. When the control lever is pulled backward half way, the remote control car will move forward slowly; when the control lever is pulled backward completely, the remote control car will move forward rapidly.
2. If you turn the "right/right steering wheel" clockwise, the car will turn right; if you turn the "left/left steering wheel" counter-clockwise, the car will turn left.
3. Gear acceleration (high/low speed two speeds)
The default is low speed, the joystick is pulled back, and the continuous pull Toggle high speed.

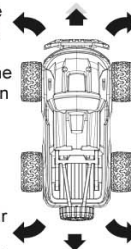

FCC WARNING:

This device complies with part 15 of the FCC Rules. Operation is subject to the following two conditions: (1) This device may not cause harmful interference, and (2) this device must accept any interference received, including interference that may cause undesired operation.

Any Changes or modifications not expressly approved by the party responsible for compliance could void the user's authority to operate the equipment.

Note: This equipment has been tested and found to comply with the limits for a Class B digital device, pursuant to part 15 of the FCC Rules. These limits are designed to provide reasonable protection against harmful interference in a residential installation. This equipment generates uses and can radiate radio frequency energy and, if not installed and used in accordance with the instructions, may cause harmful interference to radio communications. However, there is no guarantee that interference will not occur in a particular installation. If this equipment does cause harmful interference to radio or television reception, which can be determined by turning the equipment off and on, the user is encouraged to try to correct the interference by one or more of the following measures:

- Reorient or relocate the receiving antenna.
- Increase the separation between the equipment and receiver.
- Connect the equipment into an outlet on a circuit different from that to which the receiver is connected.
- Consult the dealer or an experienced radio/TV technician for help.

RF warning for Portable device:

The device has been evaluated to meet general RF exposure requirement. The device can be used in portable exposure condition without restriction.