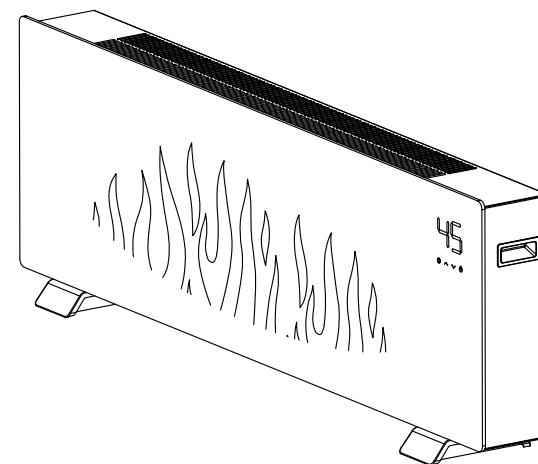

Table for information requirements for electric local space heaters					P
Model identifier : PM1356					
Item	Symbol	Value	Unit	Item	Unit
Heat output			Type of heat input, for electric local space heaters only (select one)		
Nominal heat output	P _{nom}	2.0	kW	Manual heat charge control with integrated thermostat	[no]
Minimum heat output (indicative)	P _{min}	1.0	kW	Manual heat charge control with room and/or outdoor temperature feedback	[no]
Maximum continuous heat output	P _{max.c}	1.98	kW	Electronic heat charge control with room and/or outdoor temperature feedback	[no]
Auxiliary electricity consumption			Fan assisted heat output		[no]
At nominal heat output	e _{lmax}	1.983	kW	Type of heat output/room temperature control (select one)	
At minimum heat output	e _{lmin}	0.985	kW	Single stage heat output and no room temperature control	[no]
In standby mode	e _{lSB}	0.0015	kW	Two or more manual stages, no room temperature control	[no]
				With mechanic thermostat room temperature control	[no]
				With electronic room temperature control	[no]
				Electronic room temperature control plus day timer	[no]
				Electronic room temperature control plus week timer	[yes]
Auxiliary electricity consumption					
				Room temperature control, with presence detection	[no]
				Room temperature control, with open window detection	[yes]
				With distance control option	[yes]
				With adaptive start control	[no]
				With working time limitation	[yes]
				With black bulb sensor	[yes]

USER INSTRUCTIONS

GLASS PANEL HEATER WITH DIGITAL TIMER



Model: NDW 15WT

Thank you for choosing our glass panel heater

CONTENTS	PAGE
BEFORE FIRST USE	1
IMPORTANT SAFEGUARDS	1
SPECIFICATIONS	3
DOWNLOAD APP	5
CONNECT WIFI	5
WARNING	7
MOUNTING GUIDE	8
WASTE ELECTRICAL RECYCLING	9
MODEL IDENTIFIER	10

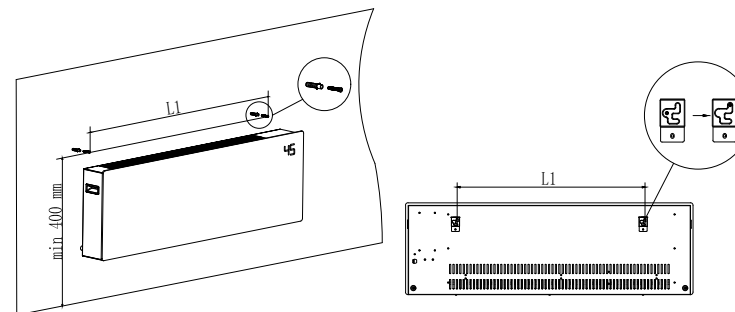

Caster Installation&removal

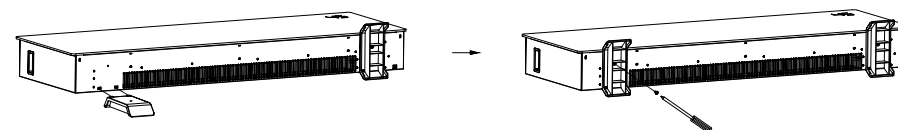

WASTE ELECTRICAL RECYCLING

This symbol indicates that this product is classed as Electrical or Electronic Equipment and should not be disposed of with other household waste.

The Waste Electrical and Electrical Equipment (WEEE) Directive has been introduced across the European Union:



To recycle waste electrical products using the best available recovery and recycling techniques in order to minimize the impact on the environment
To treat any hazardous substances and

To avoid increasing landfill.

WEEE product should be disposed of by handing it over at a designated collection point.

For more information about where you can drop off your waste product for recycling, please contact your local authority.

Learn more *about us in*



@ATLivingAndHome



@atlivingandhome



@LIVINGANDHOMEuk

6. Service

When you require service, contact your local dealer.

REPLACEMENT OF SUPPLY CORD

The supply cord damaged must be replaced by a service agent or equivalent qualified person in order to prevent a hazard.

7. Storage

If you do not plan to use the heater for extended periods of time, it is recommended that the heater is cleaned and then stored (preferably in its original packaging) in a cool dry place.

Mounting Guide

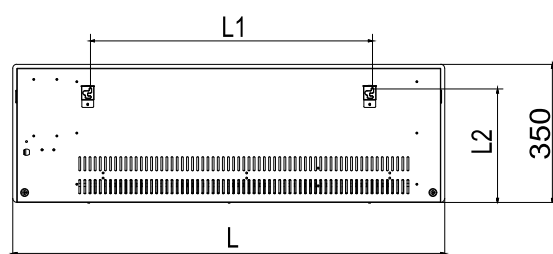

Specification

MODE	L mm	L1 mm	L2 mm
NDW-15WT	845	445	288

Wall mounted mode

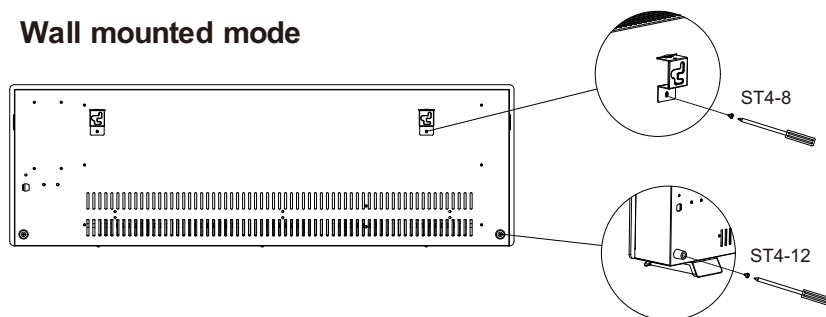

1. Insert the bracket (to the hole), turn it anticlockwise 90°, fasten it with screw;
2. Press the rubber pad (in the hole), fasten it with screw.

BEFORE FIRST USE

Read and follow all the instructions in this manual even if you feel you are familiar with the product, and find a place to keep it handy for future reference.

For your convenience record the complete model number (located on the product identification plate) and the date you received the product, together with your purchase receipt and attach to the warranty and service information. Retain in the event that warranty service is required.

NOTE: The rating of this product (as marked on the product identification plate) is based on specific loading tests. Normal use or the use of other recommended attachments may draw significantly less power.

IMPORTANT SAFEGUARDS

When using any electrically powered product, basic safety precautions should always be followed, including the following:

PLEASE READ ALL INSTRUCTIONS CAREFULLY BEFORE USING THE PRODUCT.

WARNING - to reduce the risk of fire, electrical shock or injury to persons or property:

- Read all instructions before using this appliance and keep them for future reference.
- Use only the voltage specified on the rating plate of the heater.
- Do not cover or restrict airflow to the inlet or exhaust grilles in any manner as the appliance may overheat and become a fire risk.
- Do not cover grilles, block entry or exhaust of airflow by placing appliance against any surface. Keep all object at least 1 meter from the front, side and rear of the appliance.
- Do not place the appliance close to a radiant heat source.
- Do not operate in areas where gasoline, paint or other flammable liquids are used or stored.
- This appliance heats up when in use. To avoid burns, do not let bare skin touch hot surface. Switch off and let cooling before moving.
- Do not use the appliance to dry clothes.
- Do not insert or allow foreign object or metal utensils to enter any ventilation or exhaust opening, as this may cause an electric shock, fire or damage to the appliance.
- Do not immerse in liquid or allow running into the interior of the appliance, as this could create an electrical shock hazard.
- Do not reach for an appliance that has fallen into water. Switch off at supply and unplug immediately.
- Do not operate any appliance with a damaged cord, plug or after the appliance malfunctions or has been dropped or damaged in any manner. Return to a qualified electrical person for examination, electrical or mechanical adjustment, service or repair.
- Do not operate appliance with wet hands.
- The most common cause of overheating is deposits of dust or fluff in the appliance. Ensure these deposits are removed regularly by unplugging the appliance and vacuum cleaning air vents and grilles.
- Do not use this appliance in a window as rain may cause electric shock.
- Do not use abrasive cleaning products on this appliance. Clean with a damp cloth (not wet) rinsed in hot soapy water only. Always remove plug from the mains supply before cleaning.
- Do not connect the appliance to the mains voltage until completely assembled and adjusted.

- This appliance is not intended for use in outdoor locations.
- Do not use this appliance in the immediate surrounds of a bath, a shower or a swimming pool or other liquids.
- Always operate upright.
- Switch off and let cooling before moving.
- Do not operate with cord set coiled up as a build up of heat is likely, which could be sufficient to become a hazard.
- The use of an extension cord with this appliance is not recommended.
- Do not remove plug from power socket until the appliance has been switched off.
- Do not remove plug from power socket by pulling the supply cord-always grip plug.
- Always unplug appliance when not in use.
- CAUTION: This product is NOT suitable to be used on long pile carpets or Flokati rugs.
- Do not allow cord to come in contact with heated surface during operation.
- Do not run cord under carpeting, throw rugs or runners etc. Arrange cord away from traffic areas so that it will not be tripped over.
- Do not twist, kink or wrap the cord around the appliance, as this may cause the insulation to weaken and split. Always ensure that all cord has been removed from any cord storage area.
- Do not use outdoors or whilst standing on a damp floor.
- Do not store appliance while it is still hot.
- This appliance is not intended for use by young children or infirm persons without supervision.
- Young children should be supervised to ensure they do not play with the appliance.
- The appliance must not be located immediately below a socket-outlet.
- Do not use this appliance with another programmer, timer or any other device that switches the heater on automatically, since a fire risk exists if the appliance is covered or positioned incorrectly.
- All covers of this appliance is intended to prevent direct access to the heating elements and must be in place when the appliance is in use.
- WARNING: In order to avoid overloading, do not cover the heater."
- To reduce the risk of electric shock, do not immerse or expose the product or flexible cord to rain, moisture or any liquid other than those necessary for correct operation of the product.
- the fireguard does not give full protection for young children and for infirm persons.
- If the supply cord is damaged, it must be replaced by a qualified electrical persons in order to avoid a hazard.
- Do not use this appliance outdoors or on wet surfaces. Avoid spilling liquid on the appliance.
- CAUTION: In order to avoid a hazard due to inadvertent resetting of the thermal cutout, this appliance must not be supplied through an external switching device, such a timer, or connected to a circuit that is regularly on and off by the utility."
- Use this appliance only as described in this manual. Any other use is not recommended by the manufacturer and may cause fire, electric shock or injury.
- This appliance is intended for household use only and not for commercial or industrial use.

3.Safety Feature

The unit is equipped with a high limit switch, the heater will automatically shut off if it is in an over-heating condition.

The heater will automatically turn back on when it has cooled down.

4.User tips

CLEANING INSTRUCTIONS

Cleaning behind the heater

It is very easy to clean behind it. Hold two sides of the heater ,after upward^S pull the heater forwards.then you can clean behind.

After cleaning, the heater must be fixed in the normal position.

Fig.3

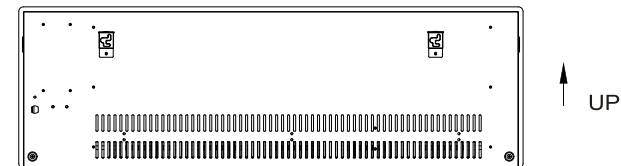

The heater requires regular cleaning to ensure trouble-free operation:

- Unplug the heater from the mains supply before cleaning.
- Ensure that the heater has been allowed to cool down completely before cleaning.
- Use a damp cloth (not wet) to wipe the exterior of the heater to remove dust and dirt.
- Use a vacuum cleaner to remove dust and fluff from around the grilles.
- Ensure the heater is dry before plugging back into the mains supply.

5.Warning

1. Fixing the heater rightly on the wall or put the heater in the right position.
2. The heater is to be installed so that the controls cannot be touched by a person using a bath or shower.
3. The heater is to be installed so that it is not located directly under a socket outlet.
4. When the heater is working as it is in free standing mode with the foot set, please do not use it in the vicinity of bath, shower, or swimming pool.
5. When the heater is working as it is in wall mounted mode, do not touch the control unit when using it in the vicinity of bath, shower or swimming pool.
6. Consult a qualified electrician or service technician If the power cord is damaged.
7. DO NOT cover the heater when it is working.
8. Always store the heater when not in use.
9. Make sure the heater has cooled down before store it away.

OVERVIEW OF THE APPLIANCE

Fig.1

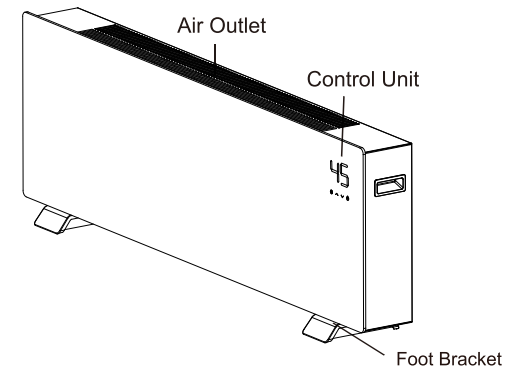

SPECIFICATIONS

Model Number	NDW-15WT
Rated Power	1500W
Rated Voltage	120V 60Hz
Dimensions(mm)	845x115x350

1. The function module

Circuit Diagram

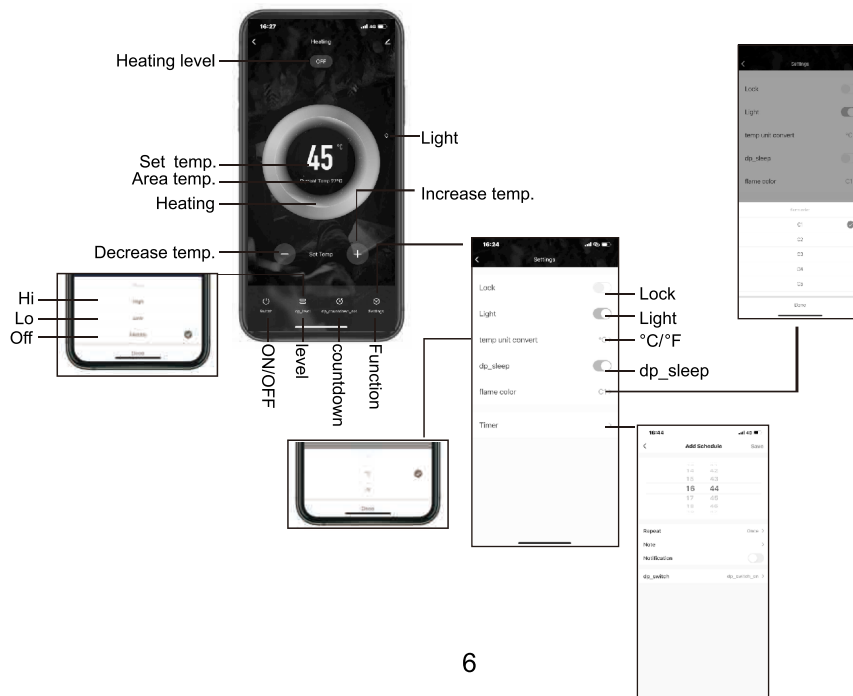
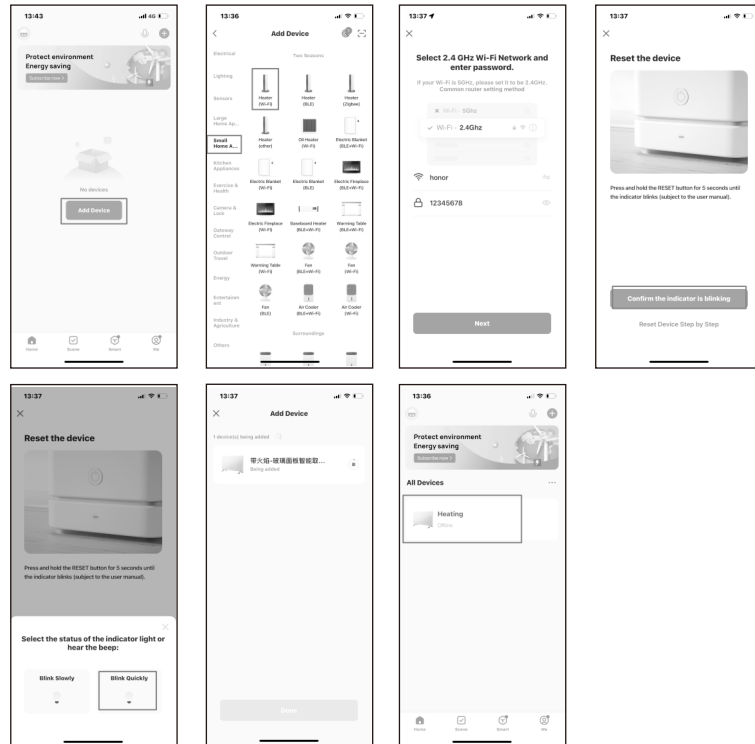
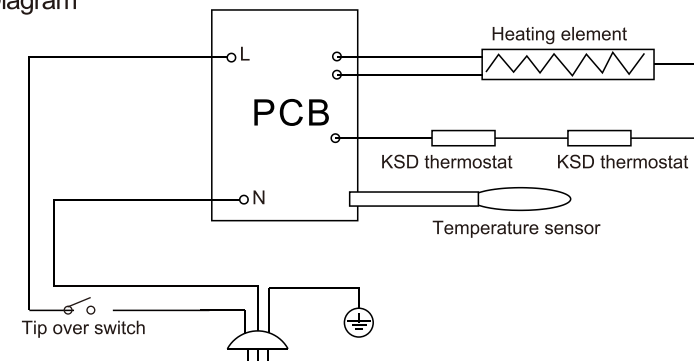

2 Control

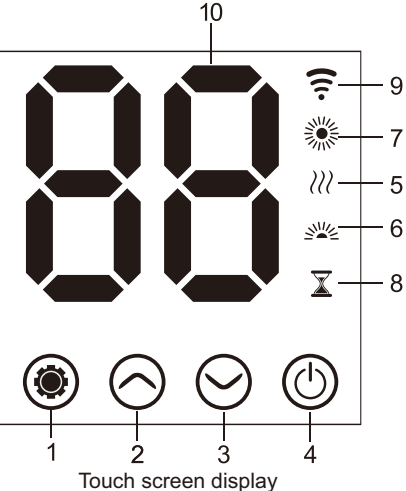

- 1.Setting button
- 2.Up button
- 3.Down button
- 4.Power button
- 5.Heating element working indicator
- 6.Low heating indicator
- 7.High heating indicator

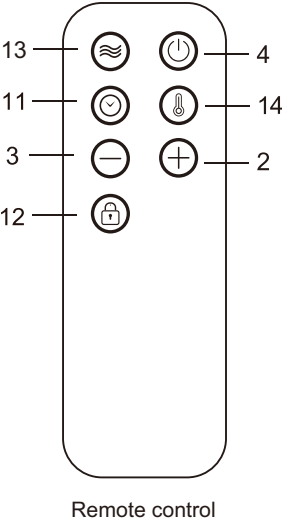

- 8.Timer indicator
- 9.Wifi indicator (if connected ok,wifi indicator lights on;if failed,it flashes)
- 10.LED number display
- 11.Timing settings
- 12.Child Lock / ECO
- 13. Low high heating selection
- 14. Temperature setting

Starting

- 1.Take out the heater from the carton carefully.Please save the carton for off-season storage.
- 2.Ensure the heater is fully assembled according to the Mounting Guide.
- 3.It is better not to use the same electric outlet with other high wattage electric appliances in order to avoid overloading your circuit.

Panel control

	Press to turn the fire On and Off.
	Press to change between the available heating levels.
	Press both and button for 3 seconds to lock the screen, and turn to ECO model.
	<p>Press to set temperature, then press or to add 1°C or reduce 1°C.</p> <p>Press twice to set the timer, then press or to add one hour or reduce one hour.</p> <p>Press three times, then or to select the frame colour(C1 to C7), or turn off the frame(OF).</p>

	Hold for three seconds to reset WIFI function.
	Hold both and for ten seconds to Switch the display between Degrees Fahrenheit and Celsius.

Remote control

 Power Button	Press to turn the fire On and Off.
 Up Button	Hold for three seconds to turn on/off the frame section.
 Down Button	Hold for three seconds to select the frame colours(C1 to C7).
 Temperature Setting Button	Press to set temperature, then press or to add 1°C or reduce 1°C.
 Low/High Heating Selection Button	Press to change between the available heating levels.
 Timer Setting Button	Press to set the timer(0-24H), then press or to add one hour or reduce one hour.
 Child Lock/ECO Button	Press for 3 seconds to lock the screen, and turn to ECO model.

DOWNLOAD APP

Scan the QR code below for a simple download using your smart device. Alternatively, search 'Smart Life' on your device application store to download.



CONNECT WIFI

1. Enter the interface.
2. Click the + icon in the upper right-hand corner or alternatively press Add Device.
3. Go to Small Home Appliances and select Heater.
4. Enter the corresponding password to the chosen Wi-Fi network account.
5. Check that the Wi-Fi icon is blinking on the device and tick the 'Confirm indicator rapidly blinking' box. If the indicator is not blinking reset the Wi-Fi (see Operation Instructions).
6. Set the device information and press Done to enter the control interface where you will now be able to control the heater.

FCC Warning:

This equipment has been tested and found to comply with the limits for a Class B digital device, pursuant to part 15 of the FCC Rules. These limits are designed to provide reasonable protection against harmful interference in a residential installation. This equipment generates, uses and can radiate radio frequency energy and, if not installed and used in accordance with the instructions, may cause harmful interference to radio communications. However, there is no guarantee that interference will not occur in a particular installation. If this equipment does cause harmful interference to radio or television reception, which can be determined by turning the equipment off and on, the user is encouraged to try to correct the interference by one or more of the following measures:

- Reorient or relocate the receiving antenna.
- Increase the separation between the equipment and receiver.
- Connect the equipment into an outlet on a circuit different from that to which the receiver is connected.
- Consult the dealer or an experienced radio/TV technician for help.

Caution: Any changes or modifications to this device not explicitly approved by manufacturer could void your authority to operate this equipment.

This device complies with part 15 of the FCC Rules. Operation is subject to the following two conditions:

(1) This device may not cause harmful interference, and (2) this device must accept any interference received, including interference that may cause undesired operation.

This equipment complies with FCC radiation exposure limits set forth for an uncontrolled environment. This equipment should be installed and operated with minimum distance 20cm between the radiator and your body.