

MILITARY CAR

RC Toys C8815

1 Parts identification

(Instruction Manual)

Product:

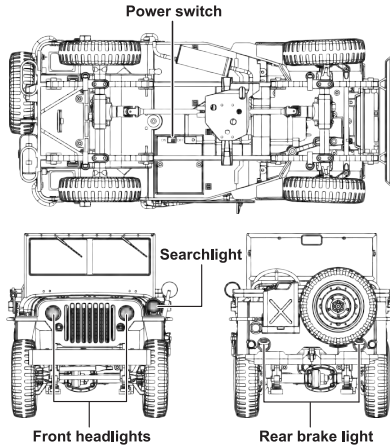

Remote control:

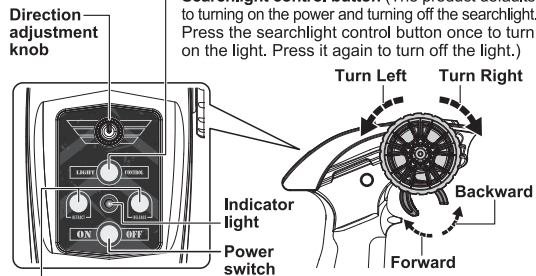

The winch lifting function button (can only be used after product upgrade and modification) is not equipped with a winch as standard at the factory, but this function is reserved for the remote control and receiving board.

- 1. RETRACT key:** Shrink the cable.
- 2. RELEASE key:** Release the cable.

Stuck protection: When the wheels of the product are blocked for three seconds, the product enters the stuck protection state, the drive stops outputting, the front car light flashes, and the stuck protection is released after releasing the throttle.

2 Battery charging and assembly

1. USB charging cable charging method
Insert the USB charging cable into the USB port of the computer or phone charger as shown in the diagram. At this time, the USB red indicator light is always on. Then connect the USB charging cable to the battery pack as shown in the diagram. At this time, the USB red indicator light is always on and the green indicator light is flashing slowly. Charging is currently in progress. After about 180 minutes, the red indicator light will turn off and the green indicator light will remain on. Charging is complete.

Notice: Please use the correct adapter for charging
Input: 100-240V~50/60Hz 0.2A;
Export: 5.0V --- 2A

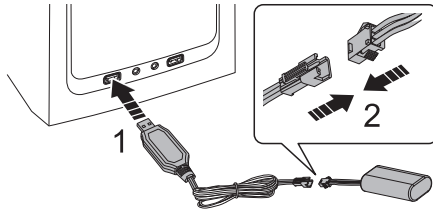

2. Open the front battery cover, assemble the battery into the battery slot with the correct electrode, and cover the front battery cover. (As shown in the picture)

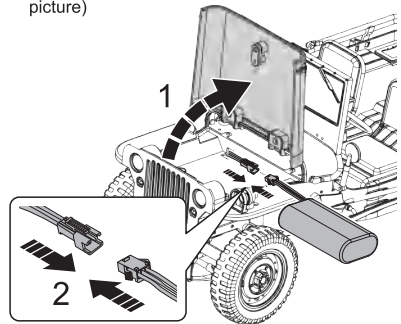

3. Installation method of remote control battery (as shown in the figure):
(1). Unscrew the screw counterclockwise with a screwdriver to open the battery cover.
(2). Install two 1.5V "AA" alkaline batteries (to be purchased separately) and pay attention to whether the positive and negative electrodes of the battery are installed correctly.
(3). Close the battery cover and tighten the screws clockwise with a screwdriver.

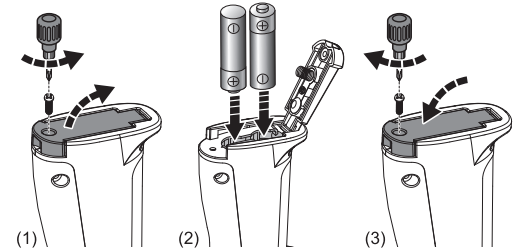

3 Control methods

Frequency matching operation: Short press the power switch on the remote control to turn on the power (long press to turn off the power), and the power indicator light on the remote control will flash. Then push the product power switch to the ON position, and the product and remote control will start frequency matching. At the same time, the remote control indicator light and the product front light will change from flashing to constantly on, indicating successful frequency matching. (Note: Before turning on the remote control power, the flashing of the product's front lights is in frequency mode.)

Remote control distance: The maximum remote control distance is about 50 meters, and the remote control emits three consecutive beeps of "beep beep" to indicate that it is beyond this remote control distance range.

Usage time: When fully charged, it can be used continuously for about 35 minutes.

Low battery state: When the product's battery is low, the front lights flash slowly, the car slows down, and the remote control buzzer emits intermittent beeps. When the remote control battery is low, the remote control indicator light flashes to indicate that it has entered a low voltage state.

Sleep: After 5 minutes of no control action on the remote control, the product enters sleep mode. The power of the product needs to be turned off and then turned on again, and the frequency needs to be re-tuned before it can be controlled.

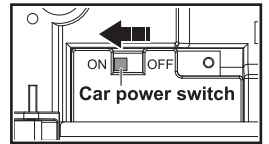

1. Pull the throttle trigger backward and the product will move forward.

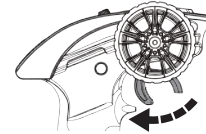

2. Push the throttle trigger forward and the product will move backward.

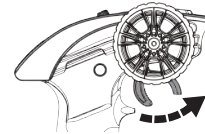

3. Pull the trigger backward and turn the steering wheel to the left, then the product will turn left while moving forward.

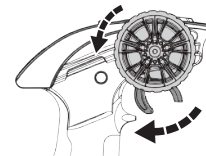

4. Pull the trigger backward and turn the steering wheel to the right, then the product will turn right while moving forward.

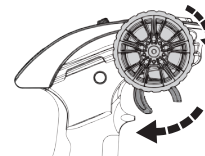

5. Push the trigger forward and turn the steering wheel to the left, the product will turn left while moving backward.

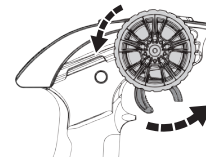

6. Push the trigger forward and turn the steering wheel to the right, the product will turn right while moving backward.

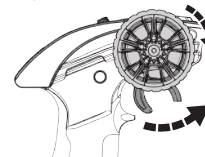

7. Direction adjustment knob: Adjust tire calibration to ensure stable and normal driving direction without deviation. When the Product moves to the left, turn the knob clockwise until the product travels in a straight line. When the product moves to the right, turn the knob counterclockwise until the product travels in a straight line.

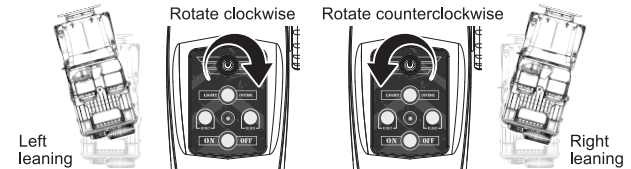

Notes:



Do not put hands into the wheels to avoid hurts. Do not touch the wheels when holding the product to avoid hurts by misoperation.

- Charge batteries should be used for the product and two 1.5V "AA" batteries should be used for the remote control;
- Please pay extra attention to the polarities during installation or change of batteries;
- Do not recharge any non-rechargeable batteries;
- Adult's supervision and protection is required when recharging the rechargeable batteries;
- Remove the rechargeable batteries before charging;

- Do not use old and new batteries or those of different types at the same time;
- In case the batteries run down, remove them from the toy;
- The power terminals shall never encounter short circuit.
- Due to the strong power and the inertia, when running at high speed, the car should not encounter emergency braking. Please pay extra attention when using the product.
- Decline of speed indicates low battery power. Please charge the product according to the above-mentioned method.
- Where the battery of the remote control is low and the power indicator light flashes quickly or turns off, replace the batteries with new ones.
- On charge, please make sure the charging plug and the charging interface are properly connected.
- When not in use for a long time, please remove the batteries from the remote control and shut down the power switch to the "OFF" position.
- Adult's guidance is required when unpacking the product.
- Keep the information for reference.

Federal Communications Commission Notice

This device complies with part 15 of the FCC Rules. Operation is subject to the following two conditions: (1) This device may not cause harmful interference, and (2) this device must accept any interference received, including interference that may cause undesired operation.

Any Changes or modifications not expressly approved by the party responsible for compliance could void the user's authority to operate the equipment.

Note: This equipment has been tested and found to comply with the limits for a Class B digital device, pursuant to part 15 of the FCC Rules. These limits are designed to provide reasonable protection against harmful interference in a residential installation. This equipment generates uses and can radiate radio frequency energy and, if not installed and used in accordance with the instructions, may cause harmful interference to radio communications. However, there is no guarantee that interference will not occur in a particular installation. If this equipment does cause harmful interference to radio or television reception, which can be determined by turning the equipment off and on, the user is encouraged to try to correct the interference by one or more of the following measures:

- Reorient or relocate the receiving antenna.
- Increase the separation between the equipment and receiver.
- Connect the equipment into an outlet on a circuit different from that to which the receiver is connected.
- Consult the dealer or an experienced radio/TV technician for help.

The device has been evaluated to meet general RF exposure requirement.

The device can be used in portable exposure condition without restriction.