

Lovfeel[®]

**WI-FI Digital Photo Frame
USER MANUAL**

Model:F156

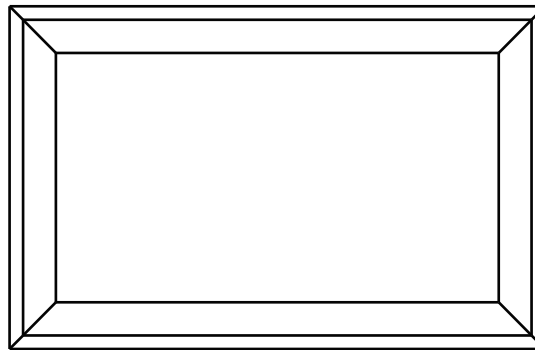

V1.0

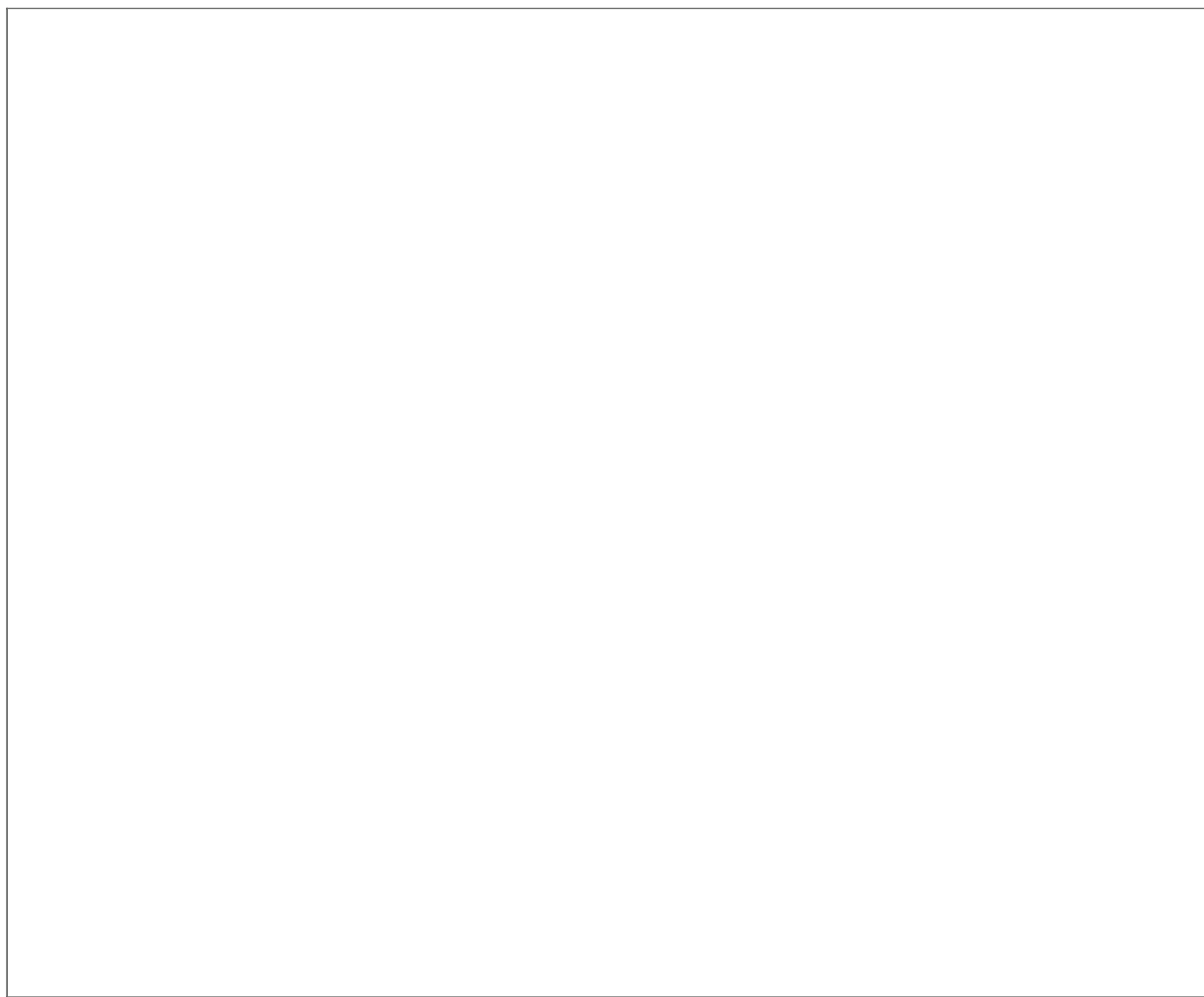

Contents

CONTACT US.....	2
WHAT'S IN THE BOX.....	3
GET TO KNOW YOUR DIGITAL PICTURE FRAME.....	4
PRODUCT FEATURES.....	4
PRODUCT SPECS.....	4
SYSTEM REQUIREMENTS.....	5
FRONT AND BACK SIDE OF FRAME.....	5
WALL MOUNT YOUR FRAME.....	6
IMPORTANT SAFETY PRECAUTIONS.....	7
SAFETY INSTRUCTIONS.....	7
CARE AND MAINTENANCE.....	8
GET YOUR FRAME READY.....	9
GETTING STARTED.....	10
HOW TO USE UHALE FRAME.....	11
SHARE PHOTOS.....	12
NAVIGATING YOUR FRAME.....	14
SETTINGS.....	18
PRIVACY.....	27
SUPPORT.....	27
FULL ONE YEAR MANUFACTURER'S WARRANTY.....	28
OBTAINING WARRANTY SERVICE.....	28

CONTACT US

In case you face any issues with the product you have received, please contact our support team by:

support@lovfeel.com

We will offer prompt and authoritative reply within 24 hours and try our best to solve your problem ASAP! More Safe Guarantee with LOVFEEL! If you are not satisfied with our product, please tell us about your thought. That would be much appreciated.

WHAT'S IN THE BOX

Please check the accessories as soon as you receive the frame to make sure you have all of them.

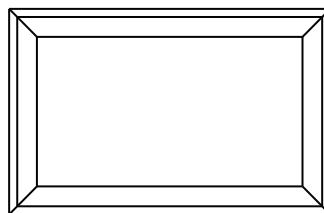

LOVFEEL Digital Picture Frame *1 pcs

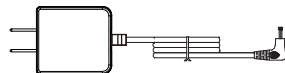

Power Adaptor * 1pcs

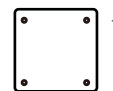

VESA Bracket * 1pcs

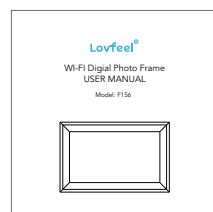

User Manual * 1pcs



Stand * 1pcs

GET TO KONW YOUR DIGITAL PICTURE FRAME

1 PRODUCT FEATURES

- 1920*1080 high resolution IPS touchscreen
- Wi-Fi enabled internet photo frame with free Uhale App
- Wi-Fi connected frame allows you to send photos/videos from Android/iOS smart phones and iPad*
- Pair multiple phones/devices (Android/iOS) to one frame or one phone/device to multiple frames
- Photos and videos can be stored in frame(32GB of internal memory*)
- Easily backup all your photos and videos in a SD card*
- Import photos and videos from your computer or camera to your frame via SD card*
- Directly play your photos and videos from SD card*
- Programmable sleep timer turns display on/off automatically

**1 This photo frame only supports 30 seconds MP4 videos.*

**2 The photo frame has 32GB built-in storage, however the operating system will take up some storage space.
The total usable storage space for photos and videos is about 27GB.*

**3 This photo frame supports SD cards up to 64GB, but only NTFS format, and SD cards of all
formats with less than 64GB memory.*

2 PRODUCT SPECS

- Wi-Fi: WLAN built-in Wi-Fi module; supports IEEE 802.11 b/g/n
- File format: supports JPG, JPEG, PNG picture files; supports MP4 video files
- I/O interface: SD port*1

- Power: adaptor input (100-240V, 50/60Hz), adaptor output (DC output,12V/1.5A)
- Screen: touch screen with high-resolution1920*1080, Aspect Ratio 16:9
- Storage: 32GB of internal memory
- Operating temp: 0°C to 40°C, storage temp: -10°C to 60°C
- Operating humidity: 10-90% (non-condensing)

3 SYSTEM REQUIREMENTS

- Wi-Fi router with a 2.4GHz internet connection
- Android mobile device with OS 6.0 or higher, or Apple mobile device with iOS 10.0 or higher

NOTE: This digital photo frame is NOT compatible with Linux or Windows phones.

4 FRONT AND BACK SIDE OF FRAME

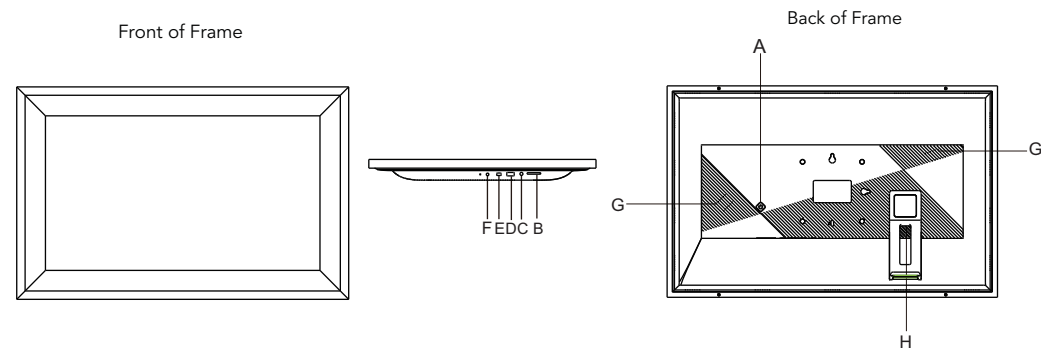

A: Power Button

Turns the digital frame on or puts it into standby. Long press around three seconds for turning on/off, short press for standby.

B: SD/SDHC Card Slot

Import photos to the digital photo frame from a SD/SDHC card (max 128GB), of which 64G and 128G only support NTFS format.

C: Headphone/Speaker Port

Connect your headphones or speakers.

D: USB Port

Import photos to the digital photo frame from a USB drive (max 128GB).

E: Mini USB port

For after-sales service only.

F: Power adapter DC input(12V)

Plug in the power adapter for power.

G: Loudspeakers

Built-in loudspeaker.

H: Removable bracket slot

Plug in the the bracket and slide up to lock into place.

5 WALL MOUNT YOUR FRAME

You have two ways to mount your frame on the wall.

- 1) Drill two screws on the wall, leave a 10mm gap between the wall and the head of screw. Mount the frame onto the screws by wall mount hole and slide down to lock into place.
- 2) Prepare a VESA mount bracket. Lock the VESA mount bracket into the VESA holes on the back side of the frame. Then you can hang the frame on the wall.

NOTE: A VESA mount bracket is included in our merchandise.

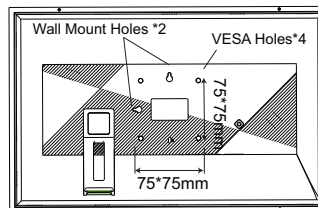

6 IMPORTANT SAFETY PRECAUTIONS

- High voltage product. Please do not open the casing of the digital photo frame. Servicing of the frame should be done by qualified personnel only.
- To reduce the risk of fire or electric shock, do not expose this product to rain or moisture.
- To avoid permanent loss of data, do not insert or remove memory cards or USB devices when the frame is powered on.

7 SAFETY INSTRUCTIONS

- Do not expose the product to liquids or objects filled with liquids, such as vases. Use in a dry location only.
- Keep product away from open flames, such as candles.
- Keep the digital photo frame clean and never store it near a heat source or in dirty, humid, or wet places. Keep it out of direct sunlight.
- Do not drop the product. It may result in damage to the product and loss of data.
- Do not attempt to repair or disassemble the unit by yourself. Only qualified service personnel should perform repairs.

- The digital photo frame is for indoor use only.
- Use only the DC 12V/1.5A power adaptor supplied with this product. Do not unplug the adaptor while viewing the pictures.
- Do not block the ventilation holes on the back of the digital photo frame.
- Children should be supervised to ensure safety.
- To prevent overheating and damage to the screen, unplug the product when you do not intend to use it for a long period of time.
- Please insert the plug into the DC IN jack on the unit completely before connecting the AC adapter to an electrical outlet.
- Do not use the product in extreme temperatures over 105° F (40° C).
- Do not allow metallic objects to touch the DC plug when the digital photo frame is on.

8 CARE AND MAINTENANCE

- Always turn off the unit and remove the power adaptor from the electrical outlet before cleaning the unit.
- Use a soft dry cloth to clean this product.
- Never spray or pour liquids directly onto the screen or casing.
- Do not use abrasive materials or chemical cleaners such as alcohol, benzene, etc. Do not allow any water or other liquid to enter the device.
- Do not drop the device as the devices cannot withstand shock from falls.
- Do not hit or scratch the screen. Handle it with care. The LCD panel of the photo frame may be damaged due to excessive force or if it comes in contact with sharp objects.

GET YOUR FRAME READY

1 Hook on the frame stand on the back. You can place the frame either in landscape or portrait (we recommend you to place it in landscape during the first setup).

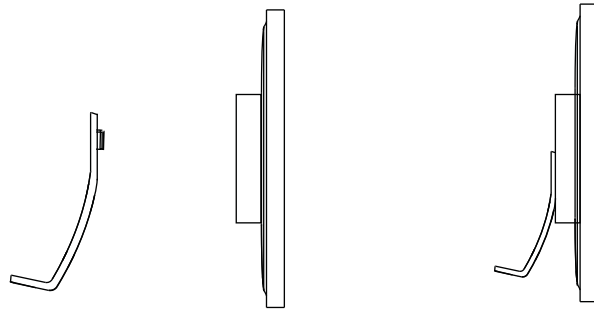

2 Connect the frame into the DC connector, and plug the power adaptor into the wall socket, the frame will turn on automatically, then you can follow the on-screen instructions.

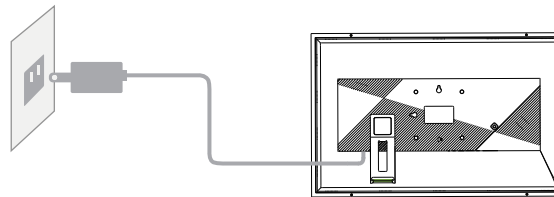

GETTING STARTED

If you are new to using Uhale:

1. Power on; 2. Start by following the Uhale quick setup on page or follow the on screen guide.

Once you have set up your Uhale, start connecting with your friends and family.

Introduce the Uhale Frame

Uhale Frame displays wonderful moments shared by mobile devices. Touch-screen operation is easy to use, making sharing photos and videos smoother and more convenient.

Uhale Web

Uhale Web is a convenient and fast web-based photo sharing tool that allows users to log in and use without registering an account. It supports sending up to 500 photos at once, making it easy for you to share your precious memories.

Uhale App

The Uhale App supports rich features for both Android and iOS systems, allowing easy sharing with connected photo frames anytime and anywhere. No matter where you are in the world, you can send photos at any time.

Download the Uhale App

Download the App by scanning the QR code.

Find the Uhale App on:

Android: Search for "Uhale" on Google Play

iOS: Search for "Uhale" on the App Store



HOW TO USE UHALE FRAME

When starting your frame for the first time, you will need to setup the frame.

- Uhale Frame may request to upgrade to the latest version. If so, it is recommended to upgrade the photo frame before proceeding.
- Choose a language you preferred as default.
- Connect the photo frame to the Internet via Wi-Fi.
- Set the date, time and set the time zone if needed.
- Name the photo frame (E.g. Jack's Frame).
- Set the location of the photo frame (E.g. Living Room, Kitchen, Office).
- Check the quick guide on the Uhale frame.

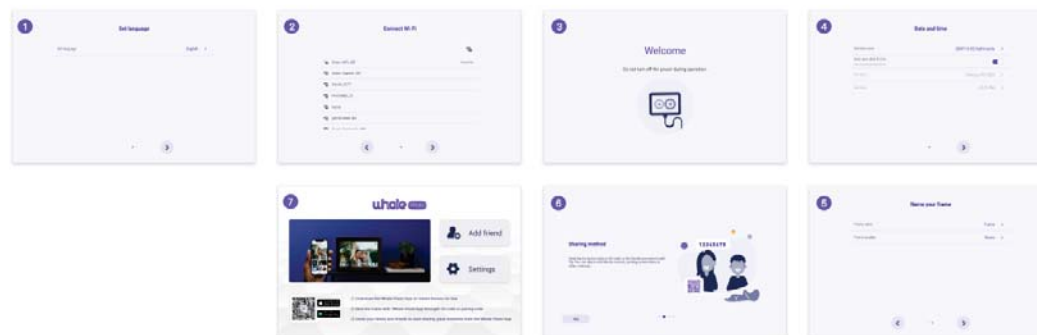

SHARE PHOTOS

You can share photos/videos in four ways.



Uhale App

You can download "Uhale" app from Google Play or App Store.
Before sharing, please connect Uhale app on mobile phone with the photo frame.

Connecting a new friend:

- Make sure that your friend has downloaded and installed the Uhale App.
- Click the "Add friend" icon on your frame . A dialog will appear and show both QR code and pairing code (valid for 12 hours).
- Now share either the QR code or the pairing code through your preferred way E.g. SMS, E-Mail, IM, phone call, to your friend.
- Once the frame is connected to your friend's Uhale App, you will be able to find them in "manage accounts" on the frame.



Uhale web

You can visit Uhale Web for sharing at: <https://uhale.zeasn.tv>.

Note: please connect with the photo frame in "Uhale" App before sharing from Uhale Web.

•Scan code login

Visit the website to get access to Uhale Web: <https://uhale.zeasn.tv>

Note: Download, install and open the "Uhale" App on your mobile devices, and find the QR code under [Scan] to log in.

•Account Login

Support login to the web terminal by account password.

Note: Email account registration is not supported on the web version. You need to download, install, and open the "Uhale" App on your mobile device to register for an account.

•Visitor Login

Support login to the web terminal by visitor login, If you change browser or clear your cache, user data will not be retained.

External storage (SD card)

You can copy photos and videos to SD card, then insert the SD card into the frame, and import photos to the frame through "Frame" – "Settings" – "Manage Photos" – "Import Photos".



Direct playback of photos from external storage (SD card)



You can play photos and videos directly from external devices without importing.

NAVIGATING YOUR FRAME

You interact with your frame through its touch screen.

Swipe left or right to go through your photos. To access the menu bar, simply tap once on the screen, this will show the menu.

In the menu you will find quick access to  and .

From the menu it is also possible to make relevant settings for the currently displayed photos, such as  and .

Connecting with your friend

SN and QR code are generated for device connection by tapping the icon .

Use either of the two to connect the frame with mobile devices to enable photo sending.

Gallery



Open the gallery and browse media sources in the gallery.

- In the gallery, you can view photos shared by different accounts;
- In the gallery, you can hide categories to view more photos;
- In the gallery, you can view photos in chronological order/reverse order;
- In the gallery, you can only view videos or photos;
- In the gallery, you can play a particular category individually;
- In the gallery, you can view photos directly in the SD card;
- In the gallery, you can easily find and review your photos and videos by using the Photo tab.

Favorite

Click the  on the screen to favorite the current photo or video. To hide the favorite button on the homepage, you can go to Settings - Photo Settings and turn off the "Show favorite" option. To show it, turn on the option.

Single repeat/ Repeat all

To set the picture display mode: select , the current photo or video will be presented in a loop; select  to play the contents of the gallery in sequence.

Hide photos

Hide the current photo. It means this photo will no longer be displayed in the slide show but still stored in the library. Go to settings-> Manage photos-> Show/hide photos.

Delete

Press and hold the screen to delete the current photo or video.

Fill frame/Fit to frame

This function is to switch the photo display mode in the frame.

Fill frame: It is the default display mode. The photo is scaled proportionally to fit the entire frame.

Fit to frame: the entire photo is displayed in the frame as its original proportion.



Adjust photos

You can adjust the photo up, down, left and right to choose the best display content. After adjusting it, click OK to return to the home page.

Rotate photos

You can adjust it 90 degrees clockwise. After adjusting it, click OK to return to the home page.

Slideshow

Set the playback effect through the menu's [Slideshow]. But only valid for the photo slideshow.

Auto rotation

Automatically rotate the photo based on actual positioning (landscape/portrait) of the frame.

Pause/Play

You can pause a playing video.

Volume/Brightness settings

Volume setting: For video, you can set the volume through the menu or swipe on the right side of the screen to achieve your comfortable listening enjoyment.

Brightness setting: You can adjust it by sliding on the left side of the screen to achieve your comfortable visual enjoyment.

Weather & Time

The home screen will display the weather and time in your area. To hide the weather and time on the homepage, you can go to Settings - Display Settings and turn off the "Show weather and time" option. To show it, turn on the option.

Best wishes

Show the wishes sent by your family or friends. You can manage the blessings in Settings - Manage photos - Best wishes.

How to send out wishes?

- 1) Open the Uhale APP on your phone. Tap the 📺 icon.
- Note: Please upgrade the APP to version 3.14 or above.*
- 2) Write down your wishes in text.
- 3) Select a style.
- 4) Choose a frame(s) you would like to send wishes to.

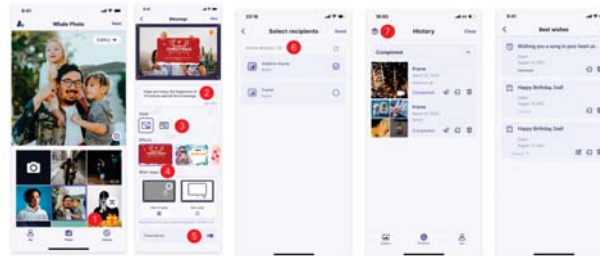

SETTINGS

With this setting, you can personalize your photo frame according to your needs.

My frame

Frame name

Set/Change the name of the frame. The frame name is also displayed in connected mobile devices, under the list of connected photo frames in the App.

Frame location

Set/Change the location of the photo frame. This location is displayed in the list of connected photo frames of your friends and family, helping to identify multiple frames.

Set time zone

Set time zone for a photo frame.

Set language

Set language used for a photo frame.

Auto sync date & time

Use network-provided time.

Set date/time

The date and time can be manually adjusted after the automatic date&time is turned off.

Use 24-hour format

Enable and disable the 24-hour clock.

Power

Click the power icon, you can choose from three options: power off, restart, and sleep.

Manage Photos

Memory usage

This section shows you the number of photos stored in the frame and the storage space occupied/remained.

Show/Hide photos

Select the photo you want to hide by tapping the photo. Hidden photos will not be deleted from the frame and can be re-displayed at any time. Use  to select or deselect all photos.

Favorite photos

Select the photo you want to remove from the favorite photos by tapping the photo.

Delete photos

Select the photo you want to permanently delete from the frame by tapping the photo.

Use  to select or deselect all and  to delete the selected photos.

You can also withdraw photos/videos which are already sent to frame from Uhale mobile app (note: withdraw only works when history is retained and frame stays online).

To withdraw: In Uhale App "history" - select the icon of the ones you would like to withdraw.

Import photos

Allows you to import photos from an external storage device (E.g. a SD card).

To import photos:

Insert an external storage device (E.g. a SD card) into the device with the photos to be imported.

Select the photos to be imported into the photo frame. Tap the import button  to start.

Export photos

Allows you to export photos from the photo frame to an external storage device (E.g. a SD card).

To export photos:

Select the photo to be exported from the photo frame. Tap the export button to start.

Play from external storage

Enables / disables playback of photos and videos directly from an external storage (e.g. SD card) without taking up space on the frame.

Best Wishes

You can view all the wishes you received from your family or friends.

Manage accounts

This contains all connected accounts that are authorized to send photos to your frame .

Add a new account

To add a new authorized account, tap the device share button, and then share the displayed SN or QR code you preferred with your friend.

Account Settings

You can delete the account (only delete the account, not the shared photos) or delete the account and its shared photos.

Display Settings

Brightness level

Adjust the screen brightness level.

Text size

There are 4 Font Size for selection.

Ambient clock

Once enabled, a clock will be displayed when the photo frame is in sleeping mode.

Sleep mode

When the sleep mode is on, the screen is turned off during a specific time to reduce energy consumption.

The default setting is to turn off the screen at 20:00 and to turn it back on at 08:00. This can be changed by setting your preferred sleep mode start/end time. Photos can still be received when the sleep mode is on.

Show weather & Time

Enable and disable the weather and time. When enabled, the weather and time are displayed on the home page, and when disabled, they are not displayed.

Set weather

View weather specific information and search to switch to other cities.

Temperature unit

Supports Celsius and Fahrenheit switching.

Photo settings

Timer

Set the photo display time interval.

Show caption

There are 3 options to set whether to show photo's caption or not.

Show favorite

Set whether or not to display the favorite button on the home page.

Fill frame

This function is to change the scaling of all current photos on the frame or not.

Slideshow

You can set your preferred photo display mode.

Photo display order

Set the the order of photo playing.

Video autoplay

When turned on, in silde show video will be automatically played; when turned off, video will be paused.

Playback audio

When turned on, videos are muted when palying.

Video volume

You can set the volume of video playing.

Playback mode

Determine how the photo will be displayed

Single repeat: lock the current photo or video or display in a loop.

Repeat all: play in accordance with the display mode.

Notifications

Notification volume

Adjust the notification volume of the photo frame.

Show notifications

Enables/disables whether notifications are shown in the slideshow (e.g. when a new photo is received).

Server connection

Enables/disables notifications showing server connection status.

Wi-Fi connection

Enables/disables notifications showing network connection status.

New friends

Enables/disables notifications shown when new friends are added.

Storage space

Enables/disables notifications shown when frame storage is low.

New photos

Enables/disables notifications shown when receiving new photos.

Backup and restore

Backup

Backup frame to external storage (e.g. SD card). Tap to make a backup of your photos. The time of the latest successful backup is also displayed here. Any existing backup on the external storage will be overridden!

Restore from backup

Before you attempt to restore your frame, start by confirming that your backup is up-to-date. This is done by confirming the date under "Backup". If e.g. the last backup is too old or if no backup is made, then press the "Backup" button to make a new backup.

NOTE: If you wish to restore a backup on a frame that has already been setup, please make sure that both frames are updated to the latest version beforehand.

Reset Frame: This is done by pressing the "Reset Frame" button. This operation will delete all the data on the frame and reset the frame to its factory preset values. After successful reset, select the "Restore from backup" button to restore the data.

Delete photos: Please delete all photos in "Manage photos - Delete photos". After deletion, select the "Restore from backup" button in "Backup and Restore" to recover data.

Reset frame

Delete all data of the photo frame. This will permanently delete all photos, friends/connections and settings.

Wi-Fi

Set the Wi-Fi connection.

Wi-Fi details

Display Wi-Fi details, such as Wi-Fi name, Wi-Fi strength, Wi-Fi status, etc.

Add a hidden Wi-Fi

Add a hidden Wi-Fi manually.

Refresh

Refresh the current Wi-Fi list.

Help

FAQ

Provide answers to common questions to facilitate users in quickly solving problems.

Guide

Simply introduce how to use the Photo Frame.

Privacy policy

Display the content of the privacy agreement.

App download

Download the Uhale App by scanning the QR code here.

Support

For technical support and feedback.

About

Software version

Check the photo frame software version update.

Build Number

Check the OS version update.

System version

Display Android system version information.

MAC

Display the Mac address of the photo frame.

Terminal ID

Show the ID number of photo frame.

PRIVACY

For more information regarding privacy, please visit www.lovfeel.com.

SUPPORT

Please contact support@lovfeel.com for FAQ, support and to provide feedback.

FULL ONE YEAR MANUFACTURER

LOVFEEL warrants the product hardware components against defects in materials and workmanship when used in accordance with the company's documentation for a period of ONE YEAR after the date of original purchase from the company. If a hardware defective arises and a valid claim is received within the Warranty Period, at its option and to the extent permitted by law, Company will either (1) repair the hardware defect at no charge, using new or refurbished replacement parts, (2) exchange the product with a new or manufactured from new or serviceable used parts and is at least functionally equivalent to the original product or (3) refund the purchase price

We only cover warranty for purchase made within the USA, Canada.

OBTAINING WARRANTY SERVICE

Please access and review the online help resources referred to in the documentation accompanying this hardware product before requesting warranty service. If the product is still not functioning properly after making use of these resources, please contact our representatives at support@lovfeel.com. No replacements will be sent out by the manufacturer until the returned item is received.

Warning Statement

This device complies with part 15 of the FCC Rules. Operation is subject to the following two conditions: (1) This device may not cause harmful interference, and (2) this device must accept any interference received, including interference that may cause undesired operation.

Any Changes or modifications not expressly approved by the party responsible for compliance could void the user's authority to operate the equipment.

Note: This equipment has been tested and found to comply with the limits for a Class B digital device, pursuant to part 15 of the FCC Rules. These limits are designed to provide reasonable protection against harmful interference in a residential installation. This equipment generates uses and can radiate radio frequency energy and, if not installed and used in accordance with the instructions, may cause harmful interference to radio communications. However, there is no guarantee that interference will not occur in a particular installation. If this equipment does cause harmful interference to radio or television reception, which can be determined by turning the equipment off and on, the user is encouraged to try to correct the interference by one or more of the following measures:

- Reorient or relocate the receiving antenna.
- Increase the separation between the equipment and receiver.
- Connect the equipment into an outlet on a circuit different from that to which the receiver is connected.
- Consult the dealer or an experienced radio/TV technician for help.

This equipment complies with FCC radiation exposure limits set forth for an uncontrolled environment. This equipment should be installed and operated with minimum distance 20cm between the radiator & your body.