

User Manual Rev . 00

XliteBT Smart Bicycle Tail Light with thief alarm



DongGuan Enfitnix Technology Co., Ltd.

Please Note: Specification are subject to change without notices.

© 2023 by ENFITNIX Technology Co, Ltd.

1. Product Specification

Product Name: XliteBT Smart Bicycle Tail Light with Thief Alarm

Dimensions: see Fig.1

Mode: Flash1, Flash2, Flash3, Breath, Costant on

Battery: 750mAh rechargeable Lithium-ion battery

Run Time: 13~67hrs

Weight: 79g(Without mounting bracket)

Color: Black

Waterproof: IPx6

Wireless System: Bluetooth 5.0

Cover Distance: About 40m* (Bluetooth signal covering range)

Lock Distance: 3~5m**

Note:

* Test in open area.

** The distance could affect by the surrounding, e.g.Obstacle, interference source,etc.

- ① Bluetooth indicator
- ② Auto Indicator
- ③ Bluetooth function button
- ④ Power button
- ⑤ USB type C connector
- ⑥ Charge indicator

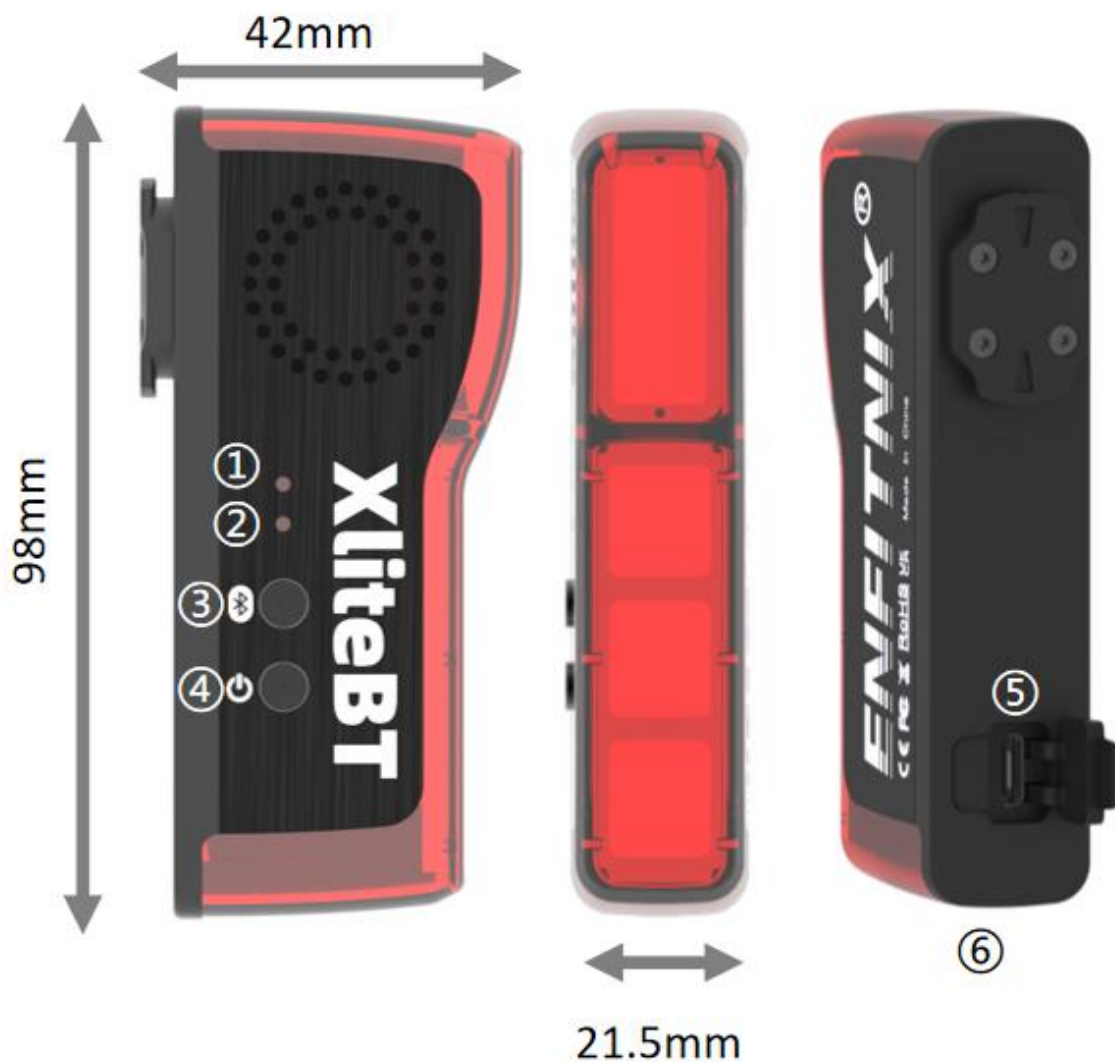

Fig. 1

2. Accessory

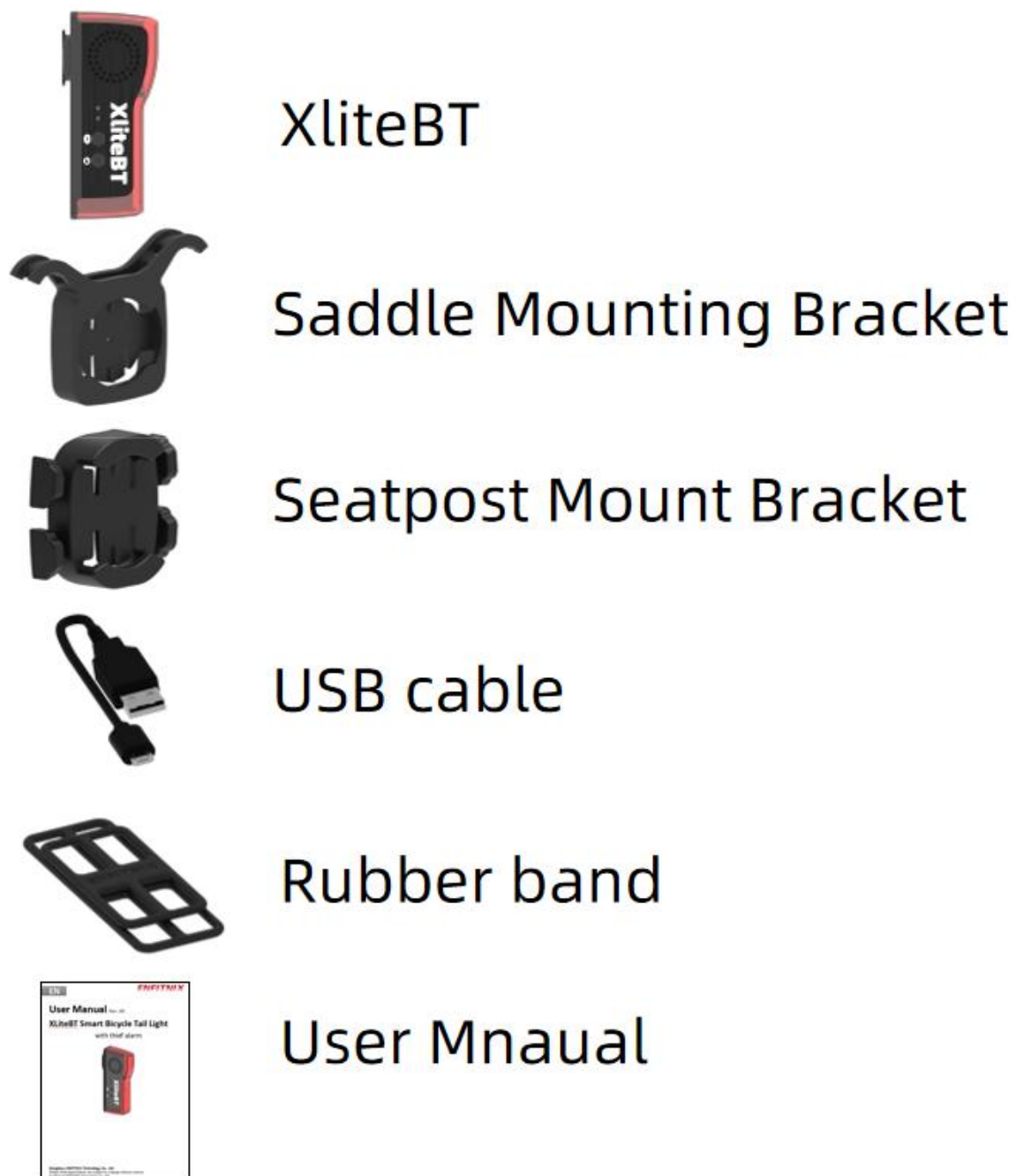

Fig. 2

3. Operation and functionality

Power button (④ as in FFig.1)

The Power Button is used to change the flash mode、working mode or turn on/off the light.

Operation	Function
-----------	----------

Single Click	Change the flash mode
Double Click*	Switch between Auto and Manual mode
Press down for more than 1s	Switch off **

Table. 1

Note:

*The “AUTO” LED indicator (Fig.1 ②)will start to blink when operate under Auto mode.

**The light will be reactivate in “Auto” mode if motion detected.

Bluetooth function button (③ as in FIg.1)

The BLE function button is use to control the connection of the Buletooth.

Operation	Function
Press down for more than 1s	Searching for new connection

Table. 2

Operation and Condition for Tail light

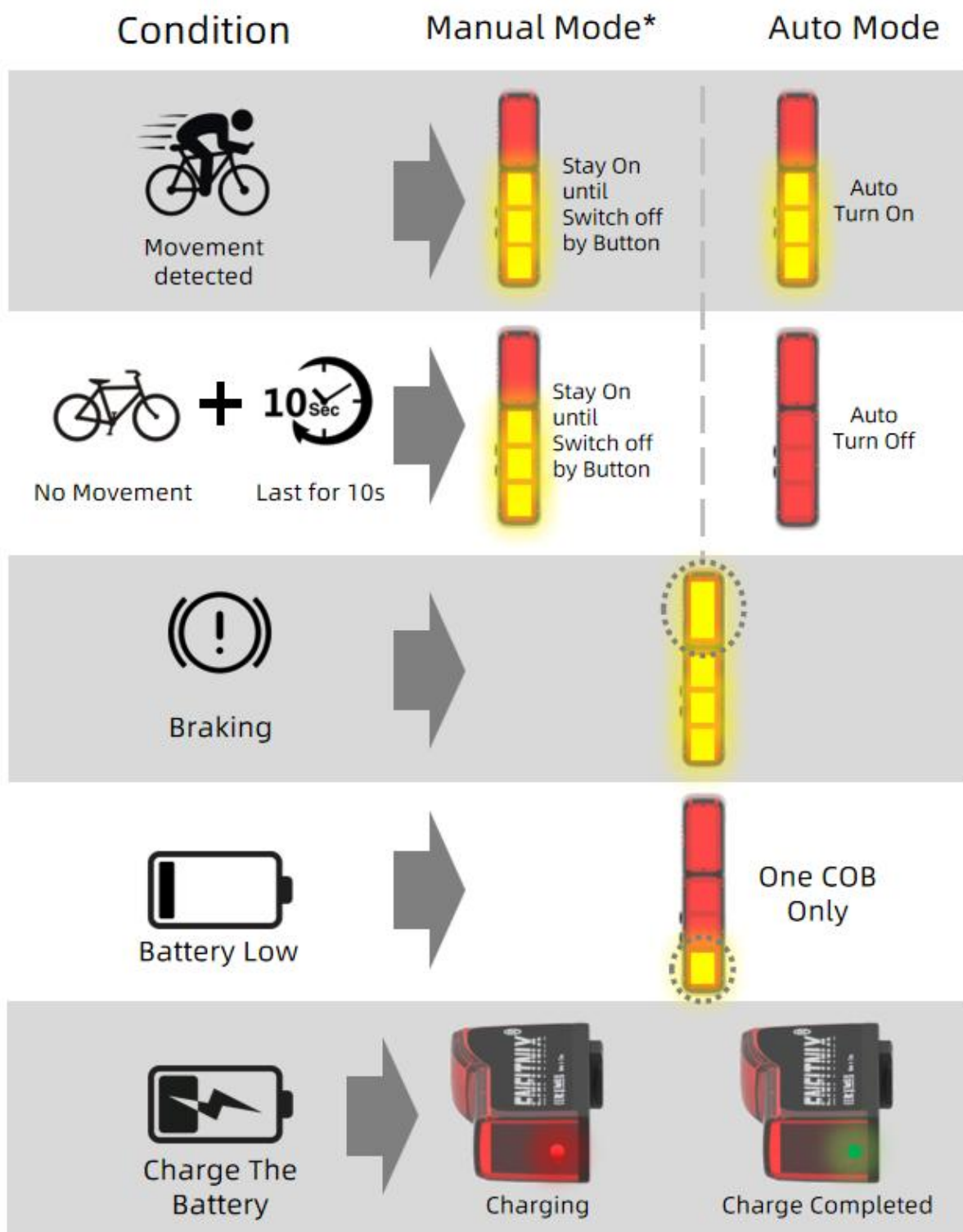

Fig. 3

Note:

Only the button④ can turn off the light when operating under “Manual” mode.

Anti-theft alarm operation

Refer to Chapter 5.

4. EFXLink

In order to control the XliteBT, please download the EFXLink by scan the following QR code:



Android



IOS

The function description for EFXLink is shown as below:

- 1: Paired product select
- 2: Reconnect paired products
- 3: Delete device
- 4: Activate/deactivate alarm function
- 5: Bike searching(only allow to used when the alarm is activated)
- 6: Adjusting the brightness of the tail lights
- 7: Settings menu
- 8: Language setting
- 9: Auto/Manual mode switch
- 10: Brake sensor enable switch
- 11: Alarm music select
- 12: Flash mode select
- 13: Firmware upgrade
- 14: Restore factory settings

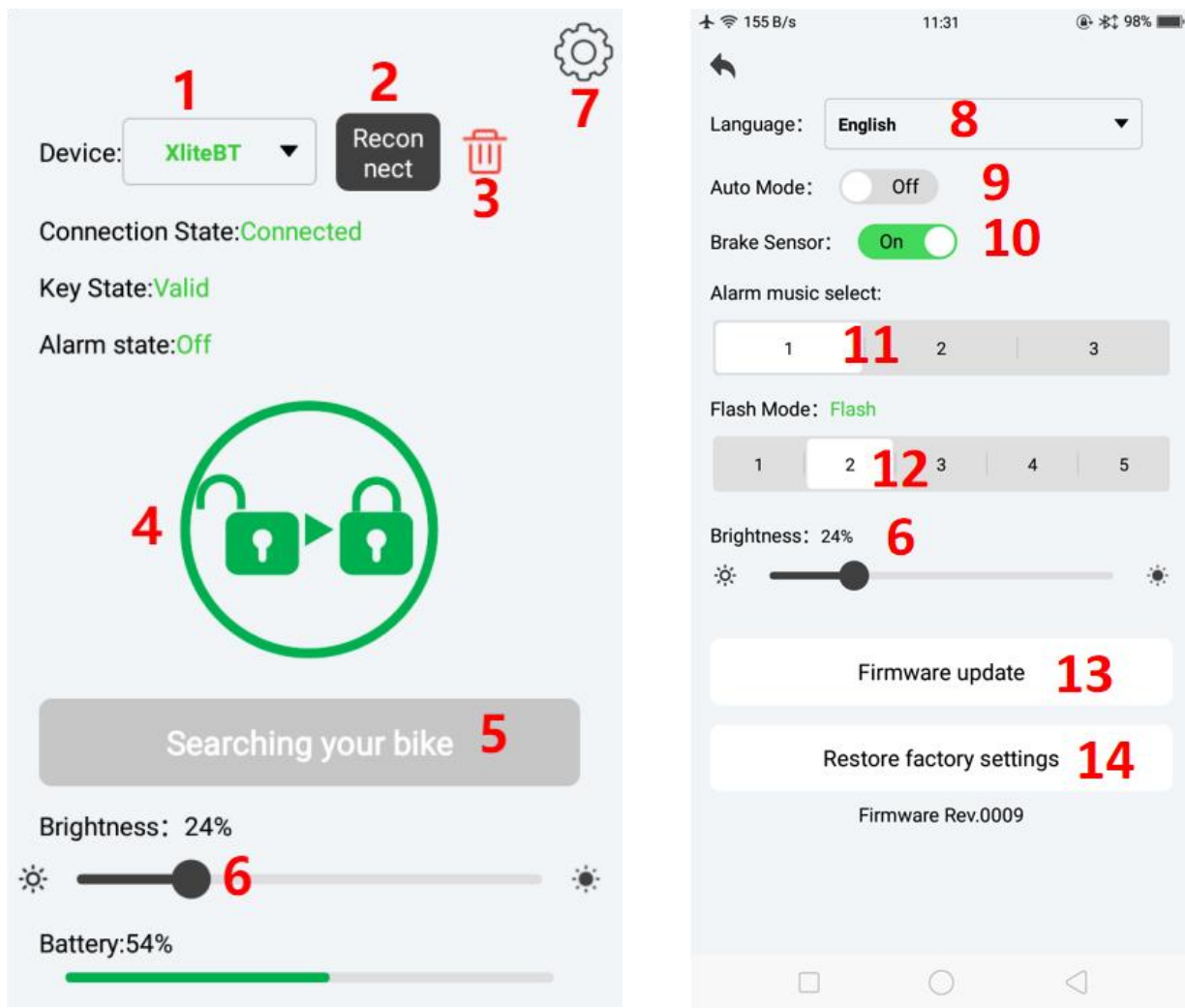

Fig. 4

4.1. Connect the XliteBT to your phone

1) Turn on XliteBT and press ③ on XliteBT until ① start blinking. Open the

FFXLink App and click the  button , see Fig.5 below.

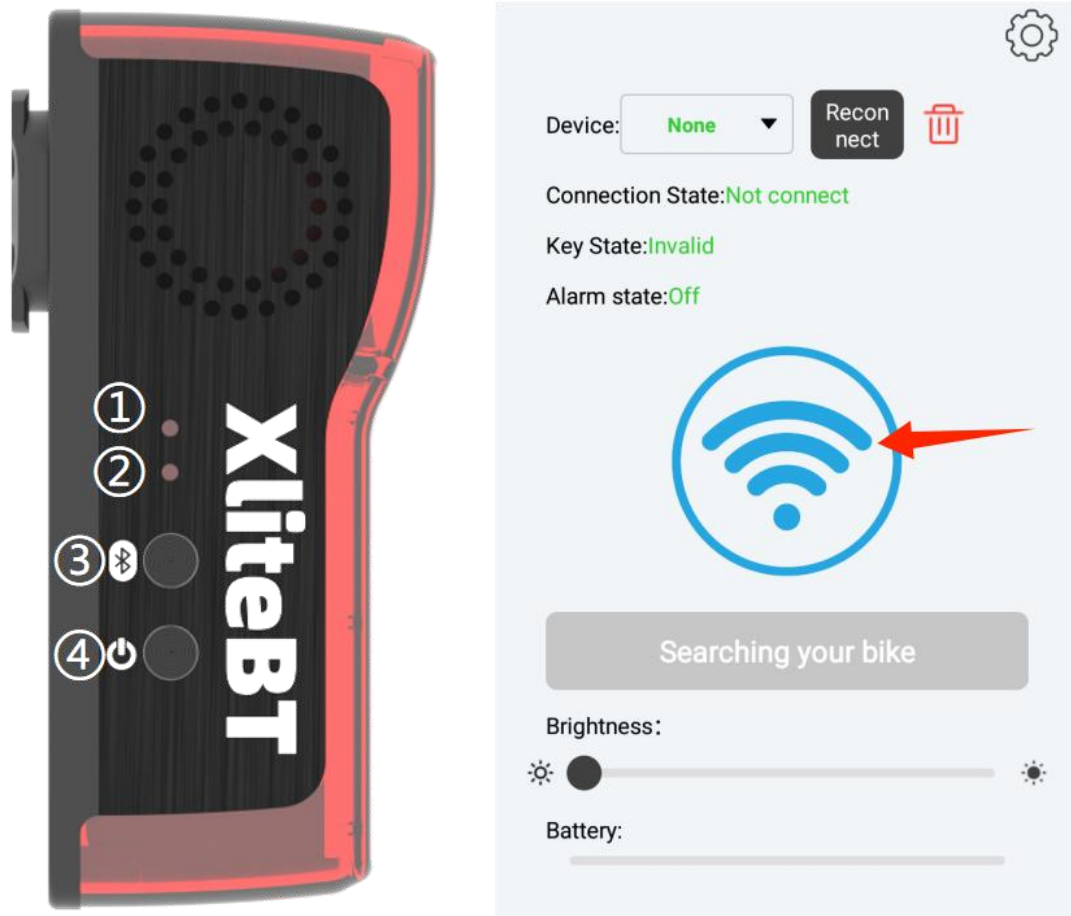

Fig. 5

2) Make sure the Bluetooth on your phone is turned on. When you see the XliteBT on the list below, please follow step 1~5 in Fig.6 below. Please enter the key in the text box '1'. You can create any 8-digits key for your device. Please make sure the key is only use on ONE XliteBT if you have more than one XliteBT.

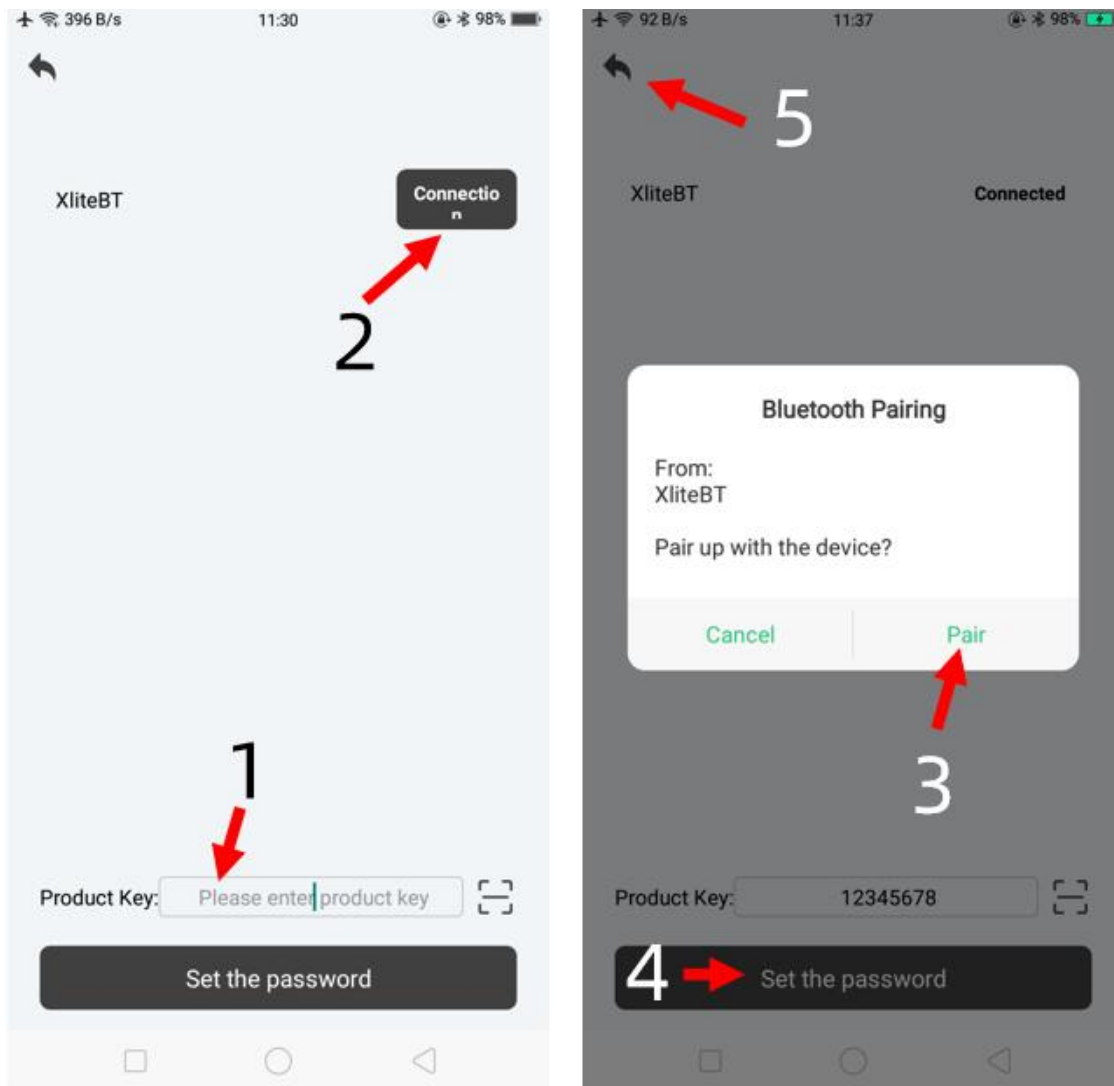

Fig. 6

3) For Android system, please make sure you' ve conduct this step after finished pairing with the XliteBT in the EFXLink:

Go to the “System Setting->Bluetooth” of the phone as shown in Fig. 7, then click the XliteBT device. Make sure the status is “Connected”. Please do not ignore this step for Android system otherwise it could affect the auto-connect feature.

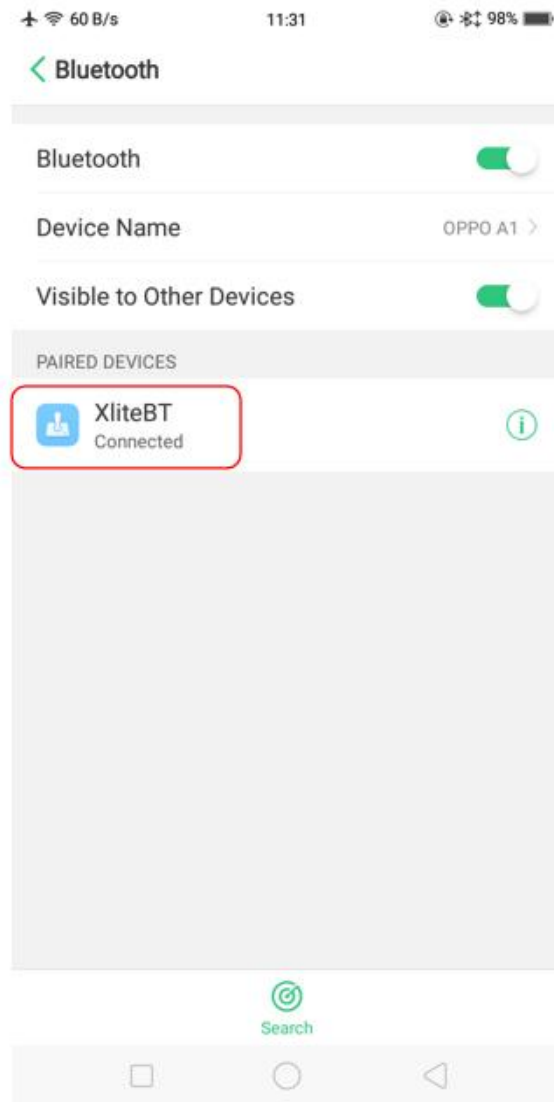



Fig. 7

5. Anti-thief alarm

The XliteBT is come with anti-thief alarm. The alarm will be triggered by any movement when the anti-thief function is activated . Therefore this will draw attention of the surrounding and avoid the bike getting stolen.

To **activate** the anti-thief function, you could:

- 1) In Manual Mode or Auto-Mode: Click the “Lock button”  on the EFXLink App. Please make sure the phone is with the CD (see Fig. 8, normally CD=10~15 meters) as in Fig. 8.

or

2) **In Auto-Mode only:** Keep (the phone) away from the bike with the distance greater than the LD(see Fig.8, normally LD= 3~5 meters). Please make sure the bike is working under Auto Mode(double click the Power Button as in Table.1).

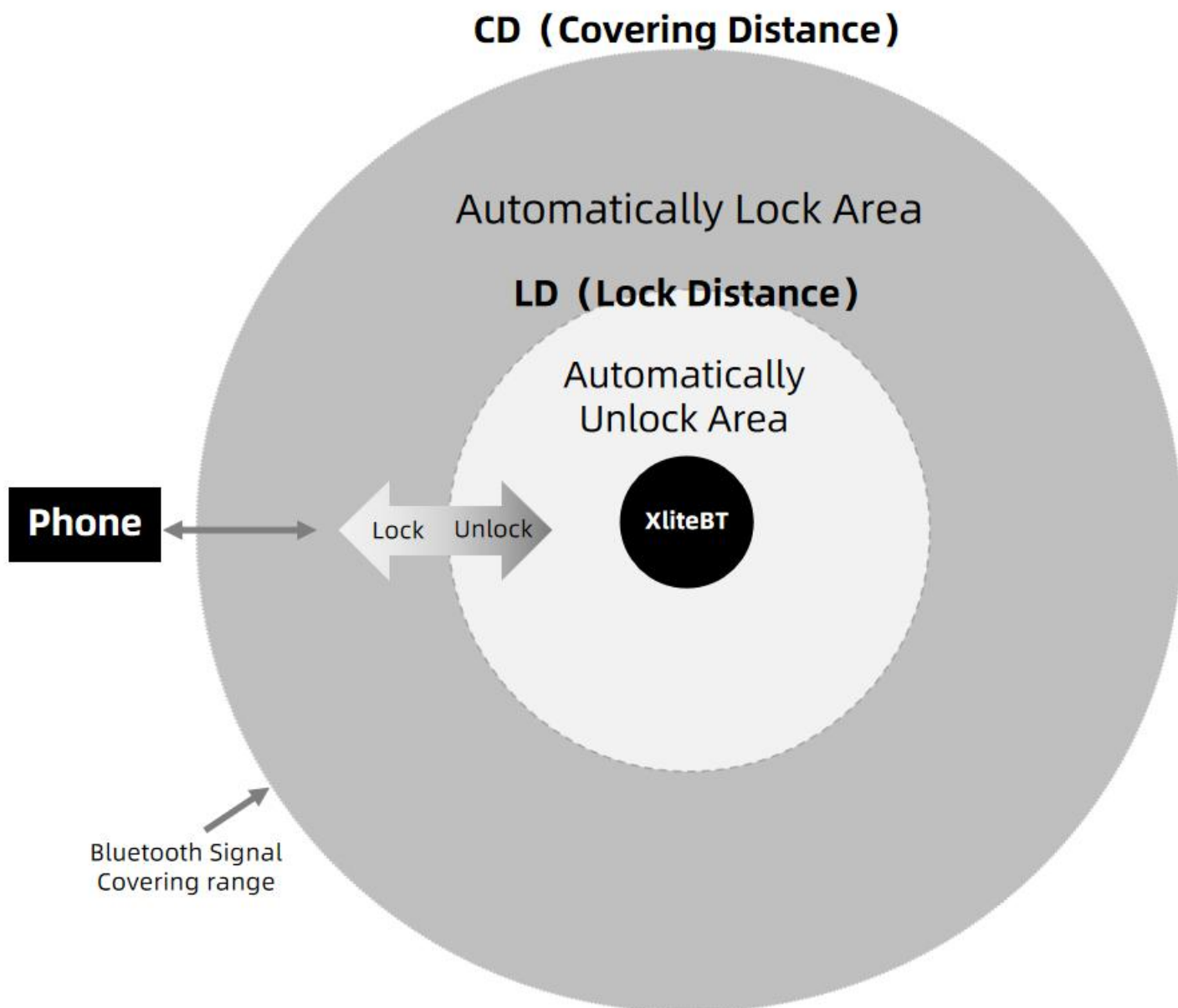



Fig. 8

To **deactivate** the anti-thief function, you could:

1) **In Manual Mode or Auto-Mode:** Click the “Unlock button”  on the EFXLink App. Please make sure the phone is within the CD as in Fig.8.

or

2) **In Auto-Mode only:** Move (the phone) close to the bike with the distance less than the LD(see Fig.8, normally LD= 3~5meter). Please make sure the bike is working under Auto Mode.

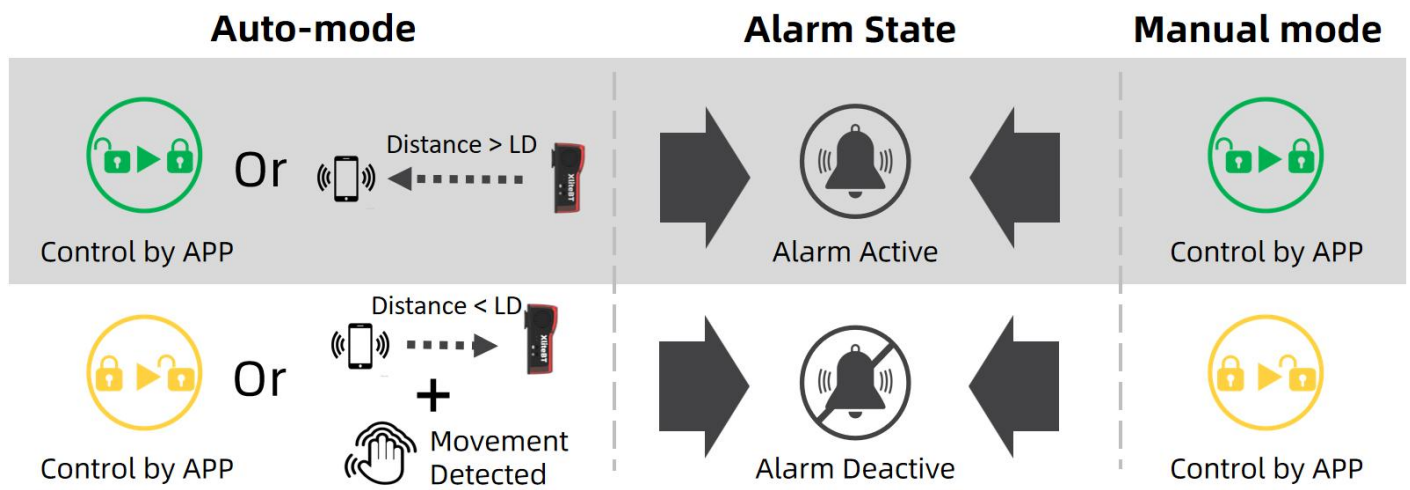

Fig. 9

6. Installation

Seatpost mount

1. Step1: Tighten the Seatpost Mount Bracket with the rubber band.



Fig. 10

- Step2: Fit the XliteBT onto the seatpost mounting bracket as show below



Fig. 11

Saddle mount

Step1: Place the mounting bracket on the seat rails and tighten with the zip-ties. Cut excess length off if need.



Fig. 12

Step2:Insert the XliteBT and turn clockwise until the light is click-in.



Fig. 13

7. Charge the battery

The XliteBT will change to Battery Low mode (as show in Fig. 3) when the battery is running low. Please charge the battery via the USB connector (⑤) as in Fig. 1). The battery will be fully charged in about 2~3 hours.

8. Warranty

The XliteBT is covered by a one year warranty.

Please contact the reseller or Enfitnix Customer Service in case of any quality issues:

Tel: +86 (0)769-2223 4810

Email: ecs@enfitnix.com

FCC Statement

Note: This equipment has been tested and found to comply with the limits for a Class B digital device, pursuant to part 15 of the FCC Rules. These limits are designed to provide reasonable protection against harmful interference in a residential installation. This equipment generates, uses and can radiate radio frequency energy and, if not installed and used in accordance with the instructions, may cause harmful interference to radio communications. However, there is no guarantee that interference will not occur in a particular installation. If this equipment does cause harmful interference to radio or television reception, which can be determined by turning the equipment off and on, the user is encouraged to try to correct the interference by one or more of the following measures:

- Reorient or relocate the receiving antenna.
- Increase the separation between the equipment and receiver.
- Connect the equipment into an outlet on a circuit different from that to which the receiver is connected.
- Consult the dealer or an experienced radio/TV technician for help.

This device complies with part 15 of the FCC Rules. Operation is subject to the following two conditions: (1) This device may not cause harmful interference, and (2) this device must accept any interference received, including interference that may cause undesired operation.

Any changes or modifications not expressly approved by the party responsible for compliance could void the user's authority to operate the equipment.

The device has evaluated to meet general RF exposure requirement. The device can be used be in portable exposure without restriction.



DongGuan Enfitnix Technology Co., Ltd.

Please Note: Specification are subject to change without notices.

© 2023 by Enfitnix Technology Co., Ltd.