

USER MANUAL

1.PRODUCT INTRODUCTION&BUTTON DEFINITIONS

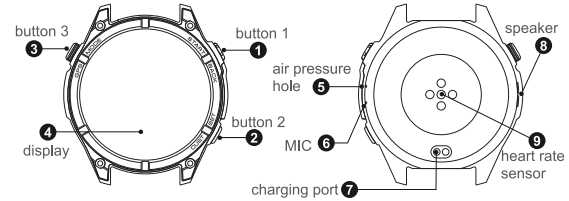

1- Power button; 2- Return key/shortcut key; 3- Sports button;

2.TOUCH SCREEN CONTROL DEFINITIONS

On the watch face interface, press and hold the watch face for 2-3 seconds to switch watch faces. Swipe left or right to switch watch faces, and click to select a watch face.

- Swipe down: Swipe down on the watch face interface to open the status bar
- Swipe up: Swipe up on the watch face interface to access the card shortcut function
- Swipe left: Swipe left on the watch face interface to enter the main menu interface
- Swipe right: Swipe right on the watch face interface to enter the notification information interface.

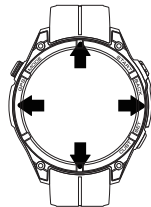

-01-

3.CHARGING

- When charging, in order to ensure stable charging, the watch will turn off the screen to charge. Click the button to wake up the watch. When the battery of the watch is too low, it takes 3-5 minutes to wake up the watch. This is normal. Please wait for 5 minutes before checking the charging status of the watch.
- Please use a charger with a rated output voltage of 5V and a rated output current of 0.5A-2A or a computer USB port to charge the watch.

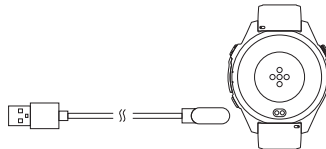

4.GPS USAGE INTERFACE

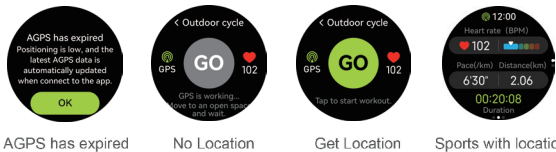

5.APP CONNECTION

-02-

Scan the watch QR code or go to major application markets to download and install the "GloryFitPro" APP. When you open the APP for the first time, a permission pop-up window will pop up. Please click "Allow" to ensure that the APP can obtain the corresponding permissions.

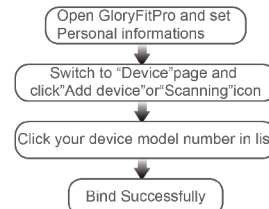

During the connection process, a pop-up window will pop up to confirm the pairing connection with the watch and mobile phone. Please click to confirm the pairing. After the connection is successful, the call icon and data connection icon in the watch status bar will turn green. In gray, it is not connected.



BT Call and APP Disconnected

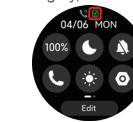

APP Connected
BT Call Disconnected



APP Connected
BT Call Connected

6.UNBINDING APP

-03-

IOS: Find "Unbind" in the "Device" interface of the APP and click on it to enter the "Settings-Bluetooth" interface of the mobile phone system. Click on the ! on the right of the device and select "Forget this device" to unbind it from the mobile phone system. Make sure it is no longer connected to the mobile phone, otherwise it will not be able to connect again next time.
Android: Find "Unbind" in the "Device" interface of the APP and click on it to disconnect from the mobile phone

7.NOTES

- Hot water shower or sauna etc. can not be worn to prevent water vapor intrusion. If the watch is damaged by water ingress due to use not according to the instructions, we will not provide free warranty.
- Do not place the device close to heat sources or naked flame sources, such as induction cookers, microwave ovens, ovens, water heaters, stoves, candles, or other places where high temperatures may be generated.
- This device is equipped with a non-removable built-in battery, please do not replace the battery by yourself.
- If the watch has been in contact with water, after leaving the water source, please dry the water stains on the watch surface in a timely manner. If there is too much residual water stains in the sound chamber of the speaker and it is not discharged in time, the sound effect may be affected. Please find the sound hole of the speaker and shake out the residual water in the sound cavity in time.

8.FCC Caution:

This device complies with part 15 of the FCC Rules. Operation is subject to the following two conditions: (1) This device may not cause harmful interference, and (2) this device must accept any interference received, including interference that may cause undesired operation.
Any Changes or modifications not expressly approved by the party responsible for compliance could void the user's authority to operate the equipment.

-04-

Note: This equipment has been tested and found to comply with the limits for a Class B digital device, pursuant to part 15 of the FCC Rules. These limits are designed to provide reasonable protection against harmful interference in a residential installation. This equipment generates uses and can radiate radio frequency energy and, if not installed and used in accordance with the instructions, may cause harmful interference to radio communications. However, there is no guarantee that interference will not occur in a particular installation. If this equipment does cause harmful interference to radio or television reception, which can be determined by turning the equipment off and on, the user is encouraged to try to correct the interference by one or more of the following measures:
-Reorient or relocate the receiving antenna.
-Increase the separation between the equipment and receiver.
-Connect the equipment into an outlet on a circuit different from that to which the receiver is connected.
-Consult the dealer or an experienced radio/TV technician for help.
The device has been evaluated to meet general RF exposure requirement. The device can be used in portable exposure condition without restriction.

-05-