



## 使用说明书

扫描下面二维码观看摄像机操作视频教程



### 1. 手机APP下载安装

- (1). 微信/浏览器扫描二维码下载APP并安装
- (2). 中文语言选第一行Android(中国), 苹果IOS选第二行IOS APP Store, 英文语言选第三行Android(Google Play)



VI365下载 (使用浏览器打开)

- Android
- IOS AppStore
- Android GooglePlay

### 2. APP连接摄像机/摄像机联网

- (1) 打开手机设置连接2.4G WIFI路由器并开启手机蓝牙和定位服务
- (2) 打开APP (出现权限弹窗, 请选择同意)

#### (3) 配网方式一: 蓝牙配网

- ①: +请在此处新增设备
- ②: 扫描到DG开头设备后点→立即配网
- ③: 输入WIFI名称和WIFI密码
- ④: 下一步
- ⑤: 配网中, 连接过程需要1~2分钟
- ⑥: 点击确定, 配置网络成功
- ⑦: 配网成功, 在线



#### (4) 配网方式二: AP配网

- ①: +请在此处新增设备
- ②: 扫描到DG开头设备后点→立即配网
- ③: 输入WIFI名称和WIFI密码
- ④: 下一步
- ⑤: 连接→连接成功后配网需要1~2分钟
- ⑥: 点击确定, 配置网络成功
- ⑦: 配网成功, 在线



### 视频界面功能指示

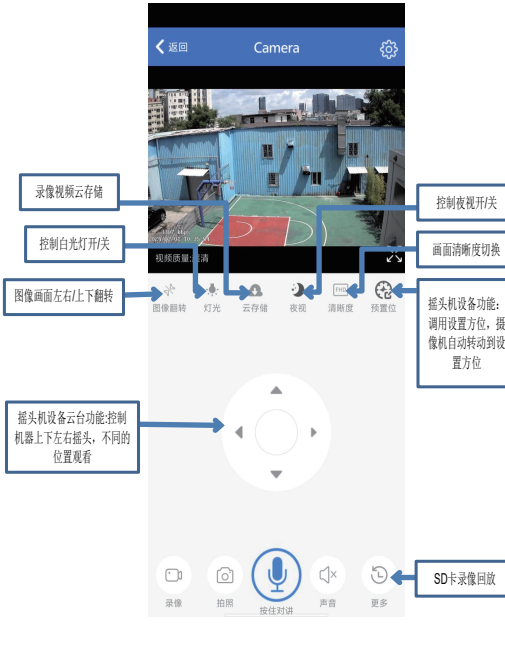

### 4. 常见问题

1. APP无法配置WIFI路由器?  
答: 请确认设备连接正常, 检查设备指示灯状态: ①红灯快闪=正在联网或密码错误②红灯慢闪=AP模式 (未联网) ③红灯常亮=联网成功。重新打开APP再按说明操作
2. 摄像机提示用户名和密码错误?  
答: 相机默认用户名: Camera 密码: 6666, 如果您忘记了用户名或密码, 您可以将相机恢复出厂设置, 然后重新添加摄像机
3. 怎么将摄像机恢复出厂设置?  
答: 请按下摄像机的复位按钮约5 秒钟, 直到相机重新启动。
4. 添加设备时, 摄像机名称是什么?  
答: DG开头的名称, 如: DGXX-XXXXXX-XXXX
5. 功能无法使用或异常?  
答: 打开APP后, 允许APP内弹出的所需权限或者打开手机设置→应用管理开启APP所需权限
6. APP观看没有图像  
答: 把手机移至信号强的区域观看或者把设备网络配置到信号强的路由器

本产品属于家用正规监控设备, 应当在中国法律法规允许范围内使用, 严禁拆卸, 严禁用于其他违法用途, 否则由此带来的相应法律责任由购买者自行全部承担。



VI365

## Instruction Manual

Scan the QR code below to watch the camera operation video tutorial



### 1. Download and install mobile apps

- (1) Scan the QR code on WeChat/browser to download the app and install it
- (2) Choose the first line of Android (China) for Chinese language and the second line of iOS for Apple iOS APP Store, Choose the third line of English language for Android (Google Play)



VI365

Android

iOS AppStore

Android GooglePlay

### 2. APP connection camera/camera networking

- (1) Open the phone settings to connect to a 2.4G WIFI router and enable Bluetooth and location services on the phone
- (2) Open the app (permission pop-up appears, please choose agree)
- (3) Network distribution method one: Bluetooth network distribution
- ① :+Please add a new device here
- ② After scanning the device at the beginning of DG, click on it → immediately connect to the network
- ③ : Enter WIFI name and WIFI password
- ④ : Next step
- ⑤ In the distribution network, the connection process takes 1-2 minutes
- ⑥ : Click OK, network configuration successful
- ⑦ : Network distribution successful, online

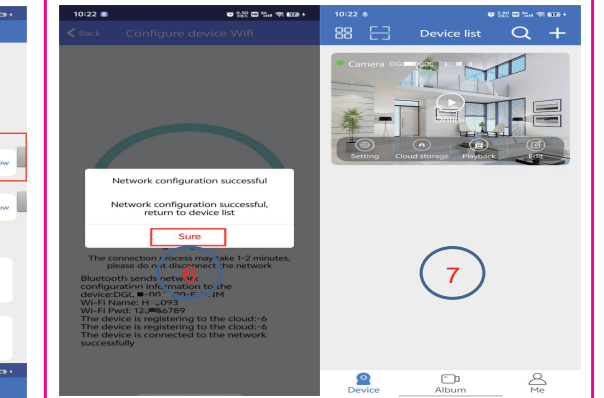
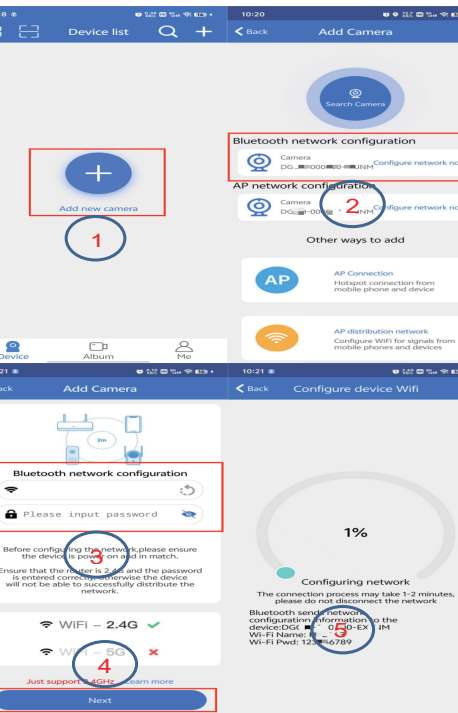

### (4) Distribution Network Method 2: AP Distribution Network

- ① :+Please add a new device here
- ② After scanning the device at the beginning of DG, click on it → immediately connect to the network
- ③ : Enter WIFI name and WIFI password
- ④ : Next step
- ⑤ : Connect → After successful connection, it takes 1-2 minutes for network distribution
- ⑥ : Click OK, network configuration successful
- ⑦ : Network distribution successful, online

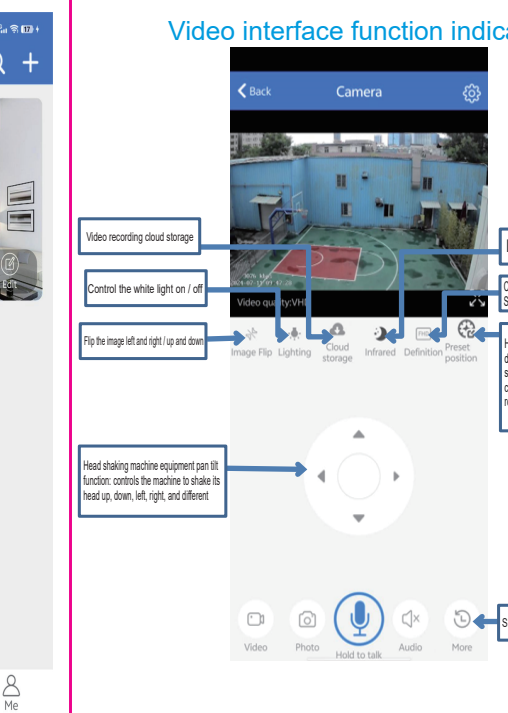
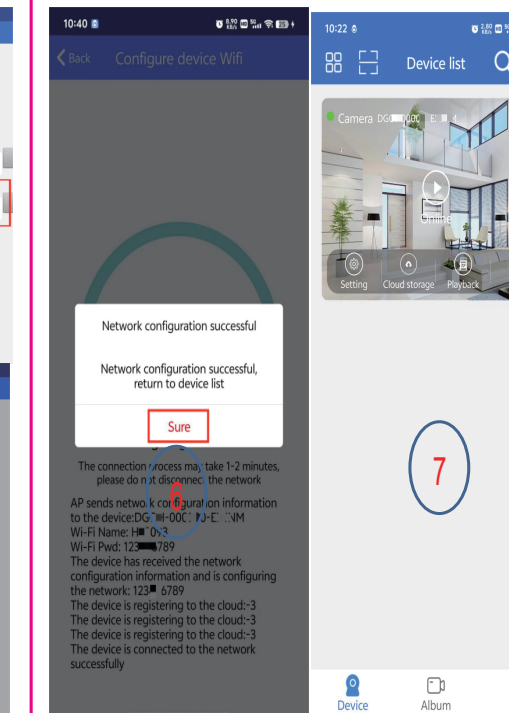

### 4. Common issues

1. Can't the app configure a WIFI router?  
Answer: Please confirm that the device is connected properly and check the status of the device indicator light: ① Red light flashing quickly=connected to the network or password error ② Red light flashing slowly=AP mode (not connected to the network) ③ Red light constantly on=connected successfully. Reopen the app and follow the instructions again
2. The camera prompts that the username and password are incorrect?  
Answer: Camera default username: Camera password: 6666. If you forget your username or password, you can restore the camera to its factory settings and then add the camera again
3. How to restore the camera to its factory settings?  
Answer: Please press the camera's reset button for about 5 seconds until the camera restarts.
4. What is the camera name when adding devices?  
Answer: Names starting with DG, such as DGXX-XXXX-XXXX-XXXX
5. Is the function unusable or abnormal?  
Answer: After opening the app, allow the required permissions to pop up within the app or open the phone settings → Application Management to open the app's required permissions
6. There are no images when watching the app  
Answer: Move your phone to an area with strong signal for viewing or configure your device's network to a router with strong signal

### Information to User:

FCC Warning Statement  
Changes or modifications not expressly approved by the party responsible for compliance could void the user's authority to operate the equipment. This equipment has been tested and found to comply with the limits for a Class B digital device, pursuant to Part 15 of the FCC Rules. These limits are designed to provide reasonable protection against harmful interference in a residential installation. This equipment generates uses and can radiate radio frequency energy and, if not installed and used in accordance with the instructions, may cause harmful interference to radio communications. However, there is no guarantee that interference will not occur in a particular installation. If this equipment does cause harmful interference to radio or television reception, which can be determined by turning the equipment off and on, the user is encouraged to try to correct the interference by one or more of the following measures:  
- Reorient or relocate the receiving antenna.  
- Increase the separation between the equipment and receiver.  
- Connect the equipment into an outlet on a circuit different from that to which the receiver is connected.  
This device complies with part 15 of the FCC Rules. Operation is subject to the following two conditions: (1) This device may not cause harmful interference, and (2) this device must accept any interference received, including interference that may cause undesired operation.

RF Exposure Statement  
To maintain compliance with FCC's RF Exposure guidelines, This equipment should be installed and operated with a minimum distance of 20cm between the radiator and your body. This device and its antenna(s) must not be co-located or operated in conjunction with any other antenna or transmitter.