

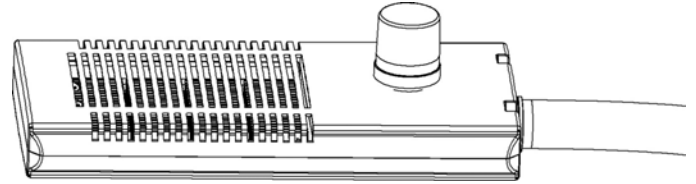

Light Sense Node Installation Guide

for installation at Luminaire



Before you begin

Read these instructions completely and carefully. Save these instructions for future use.

Carton Contents (provided by Verizon)

- LightSensenode4GLTE0-10VNEMA120-277V
SKU: S80-000123
- Installation Guide

Safety



- All work must be performed only by a licensed electrician.
- Installation should conform to all national and/or local municipal laws and codes.
- Disconnect or safe-off all power before installation.
- DO NOT INSTALL DAMAGED PRODUCT
- This node has been properly packed so that no parts should have been damaged during transit. Inspect to confirm. Any part damaged or broken during or after assembly should be replaced.
- Installation is intended for outdoor luminaires.
- Product should not be installed less than 20 feet above ground level and must be considered out of reach from normal access.
- These instructions do not purport to cover all details or variations in equipment nor to provide every possible contingency to meet in connection with installation, operation or maintenance. Should further information be desired or should particular problems arise which are not covered sufficiently for the purchaser's or owner's purposes, please contact Verizon Smart Communities technical support at vscsupport@verizon.com.

FCC Statement

- This device complies with part 15 of the FCC Rules. Operation is subject to the following two conditions:
 - This device may not cause harmful interference, and
 - This device must accept any interference received, including interference that may cause undesired operation.
- **Caution:**
 - Changes or modifications not expressly approved by the party responsible for compliance could void the user's authority to operate this equipment.

General

- Node installation work must be completed in one continuous phase.
- Installer shall assist Verizon during commissioning to debug equipment issues. It is possible that the equipment will need to be physically adjusted.

Installation

1. (SKIP this step if not using Barcode app)

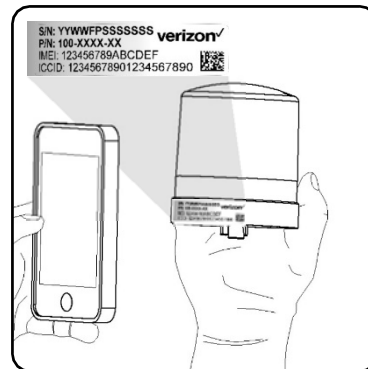

(Optional Step) Scan the 2D barcode from the node label before installing the node to the NEMA socket.

2.

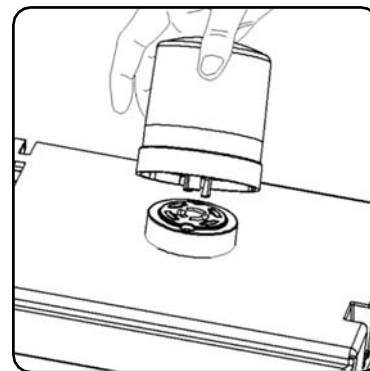

Orient the Light Sense node so that the large leg aligns with the large slot in the receptacle and insert into the receptacle.

3.

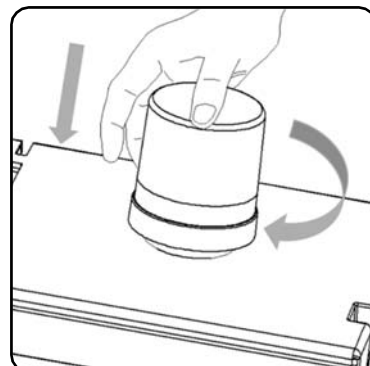

Press down firmly on the Light Sense node and twist in a clockwise direction until the Light Sense node locks into position. Do not over-rotate.



WARNING: This product can expose to chemicals including Antimony oxide (Antimony trioxide) which is known to the state of California to cause cancer. For more information go to www.P65Warnings.ca.gov

Luminaire

- Ensure that the luminaire is equipped with a five- or seven-pin NEMA connector. If the fitting is incompatible, contact Verizon Smart Communities technical support at vscsupport@verizon.com for assistance.

Barcode app

If using the scanning tool provided by Verizon, open the app and scan the 2D barcode from the label.



FCC Statement

This equipment has been tested and found to comply with the limits for a Class A digital device, pursuant to part 15 of the FCC Rules. These limits are designed to provide reasonable protection against harmful interference when the equipment is operated in a commercial environment. This equipment generates, uses, and can radiate radio frequency energy and, if not installed and used in accordance with the instruction manual, may cause harmful interference to radio communications. Operation of this equipment in a residential area is likely to cause harmful interference in which case the user will be required to correct the interference at his own expense.

RF Exposure

This equipment complies with FCC radiation exposure limits set forth for an uncontrolled environment. End users must follow the specific operating instructions for satisfying RF exposure compliance. This transmitter must be at least 20 cm from the user and must not be co-located or operating in conjunction with any other antenna or transmitter.

The information in this guide may change without notice. The manufacturer assumes no responsibility for any errors that may appear in this guide.