

User Manual

Before using

InHandWatch (InHandPlus smartwatch) provides video-based medication behavior analysis and can also measure health data (heart rate, pulse oxygen saturation (SpO2), steps, etc.).

To ensure safe and correct use of the product, please read this user manual before use.

- The content in this user guide is based on the product's default settings.
- The contents of the user guide may vary depending on the software version, model, and specifications of the product.
- If the problem is caused by installing an app not provided by InHandPlus, it is not covered under warranty.
- The warranty does not apply if you have modified the registry settings or operating system software on your own, causing problems with functionality and compatibility. If you modify the operating system on your own, the product or app may not function properly.
- The software and content used in this product are copyrighted works that are licensed for limited use under agreements between InHandPlus and the respective copyright holders. Any extraction and use for other purposes, including commercial use, is an infringement of the copyright of the copyright holders, and the user assumes all responsibility for such infringement.
- Any disassembly or modification of the watch will not be covered by the warranty.
- This radio facility cannot be used for services related to life safety due to possible radio interference during operation.

Precautions for wearing

- Keep your watch away from open flames or high-temperature environments.
- Skin reactions may occur due to prolonged exposure to irritants such as soap and sweat, or due to allergies, environmental factors, or other factors. If you experience a skin reaction, stop using the product immediately and wait 2-3 days to see if the symptoms go away. If skin symptoms worsen, consult a doctor for appropriate treatment.
- If your smartwatch is in contact with your skin for an extended period of time or if you engage in strenuous exercise while wearing your smartwatch, the friction and pressure may cause a skin reaction. After prolonged wear, remove your smartwatch and do not put it on your wrist for a sufficient amount of time.

Keeping your product waterproofing and dustproof

This product is waterproof and dustproof. To ensure that the waterproof and dustproof functions work properly, please observe the following points. Failure to observe the following points may result in damage to the product.

- Avoid contact with water under high water pressure and avoid exposing the product to sudden water pressure such as diving, engaging in wading, diving or other water sport, under water with a high current velocity.
- The performance and appearance of the product may be affected if the product is wet or your hands are wet. Wipe with a dry cloth and let the product dry before using.
- If your product gets wet in clean water, wipe it dry with a soft clean cloth. If your product is exposed to liquids that are not clean water (such as salt water, pool water, soapy water, oils, perfumes, and chemicals such as sunscreen, hand sanitizer, cosmetics), rinse it off with clean water and wipe it dry with a soft clean cloth. Failure to do so may impair the performance or appearance of your product.
- Do not disassemble the product yourself. You may damage the waterproof or dustproof features.
- Avoid exposing the product to sudden changes in air and water temperature.
- Do not use heating devices, such as hair dryers to dry products.
- Water resistance may be compromised in environments such as saunas and steam rooms.
- If you use your product in water, some features, such as touch, may not work.
- Clean your wrist and band after exercising or sweating. For rubber bands, wash the band with clean water, wipe with a small amount of rubbing alcohol and let dry completely.
- If the rubber band is heavily stained or has debris buildup, scrub it with a soft-bristled toothbrush dampened with water and clean it.

Precautions for overheating

- If you feel any discomfort from overheating while using the product, stop using the product immediately and remove it from your wrist. If the surface of an overheated product is in contact with your skin for an extended period of time, there is a risk of cold burns.
- If the product overheats and reaches a certain temperature, it will automatically turn off to prevent product failure, skin irritation and damage, battery leakage, and more.

Explanation of notated symbols



Warning: Use to indicate a warning that could cause serious harm if you are not careful when using the product.



Caution: Used to indicate precautions for safe and proper use of the product.



Reminders: Use to provide notes or additional information about using the product.

Name and role of each part

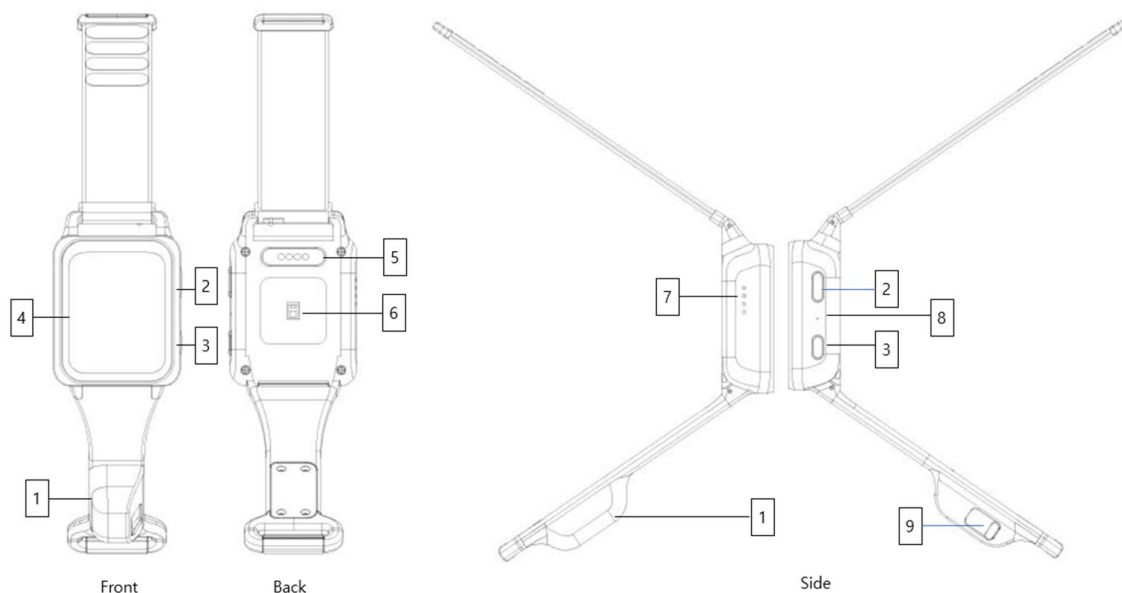

1. Camera

Take a video when a user engages in taking medication.

2. Top(Home) button

While the screen is on, a short press will switch to the medication screen.

While the screen is off, a short press will switch to the screen on.

3. Bottom(Power) button

While the screen is on, a short press will switch to the screen off. While the screen is off, a short press will switch to the screen on.

Press and hold while powered off to power on the smartwatch (power on, boot smartwatch), and press and hold while powered on to power off the smartwatch (power off).

4. LCD and touch screens

The user swipes or taps the screen with finger to operate the screen.

5. USB charging port

It used to smartwatch charging. The charging port uses pogo pin for waterproofing.

6. PPG sensor

The PPG sensor use for pulse oxygen saturation(SpO2), heart rate and etc.

7. Speaker

It uses for alarms.

8. Microphone

It is used to record sound as needed to improve the accuracy of the medication behavior.

9. Camera cover

It is used to protect user privacy when no medication video is taken.

10. Other

The vibration motor is used for user alarm and is located inside the watch.

Charging the battery

When you first use smartwatch after you buy it or leave is for a long time. You charge the battery before using it.



Incorrect connection of the charger may cause the product to malfunction. Damage caused by incorrect usage is not covered under warranty..

- ① Connect the USB cable terminal (pogo pin) of the smartwatch to the charging port.
- ② Connect the USB cable (USB Type A) to the charger
- ③ When charging is complete, the battery icon on smartwatch will display '100%'
- ④ When charging is complete, remove the USB cable.

Main screen configuration and description

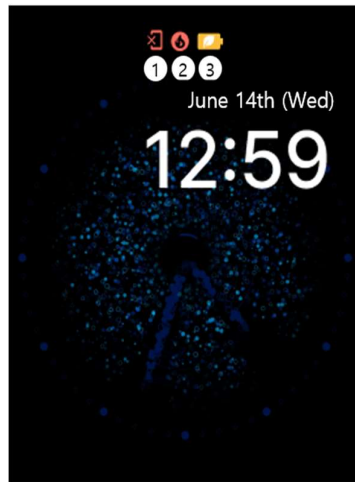

The main screen configuration is kept simple and clear for user convenience and intuitiveness.

The icon function is as below

- ① Check phone's connection : Check whether phone is connected or not
- ② Hot temperature warning : alert you to situation that may occur if you smartwatch get hot due to external shocks, excessive motion, unclear cause, etc.
- ③ Power saving mode : This icon is provided when the battery is less than 15%(the percent is programable) and you can choose whether to set power saving mode. Applying power saving mode may limit the functional use of the smartwatch.

It implemented the following interactions.

When swiping your finger from top to bottom on the main screen : Control Center screen

When swiping your finger from bottom to top on the main screen : Medication screen

When swiping your finger from left to right on the main screen : Notification screen

When swiping your finger from right to left on the main screen : Health data screen

Initial setup

Once the initial setup or initialization of smartwatch is complete, It will be prompted to begin the initial setup, click "Start" to proceed it.

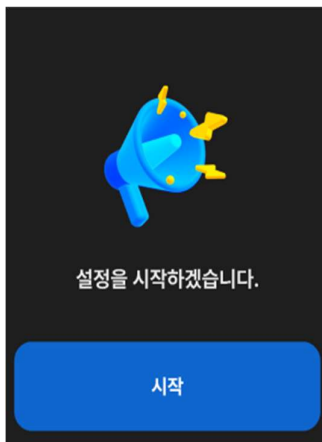

The language setting screen appears. It selects the proper language.

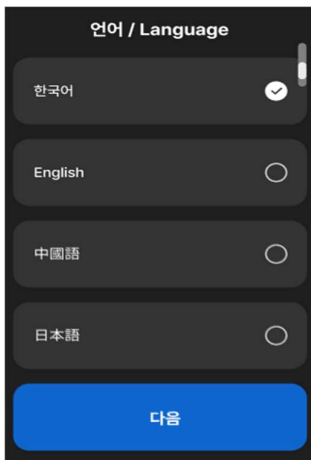

It'll be prompted to choose which hand you want to wear the smartwatch on.

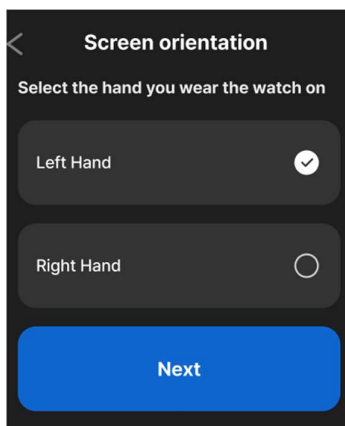

It'll be prompted to set up a phone connection to connect smartwatch. If it doesn't need a connection, skip it.

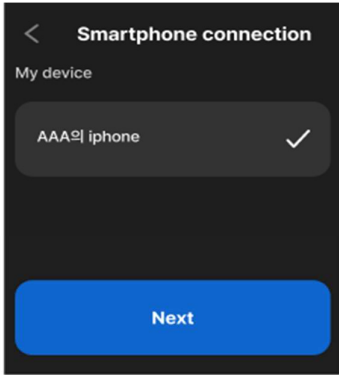
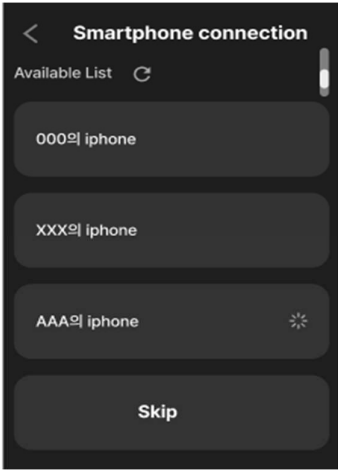
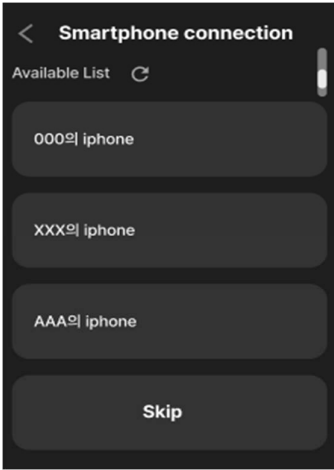
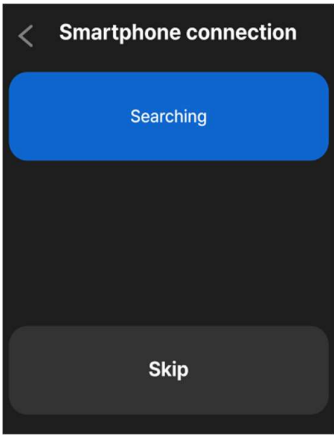

It will be prompted to set up a Wi-Fi connection to connect with smartwatch. If it doesn't need a connection, skip this step.

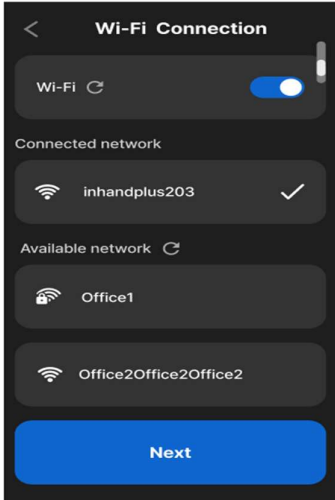
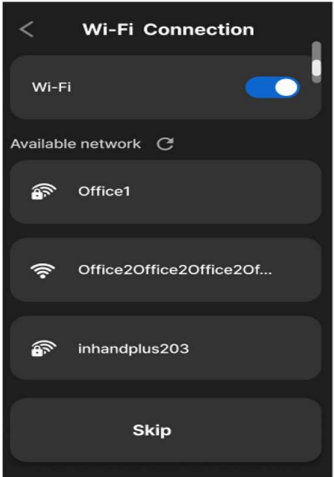

After setting the clock type and the time and date, the initial setup is complete.

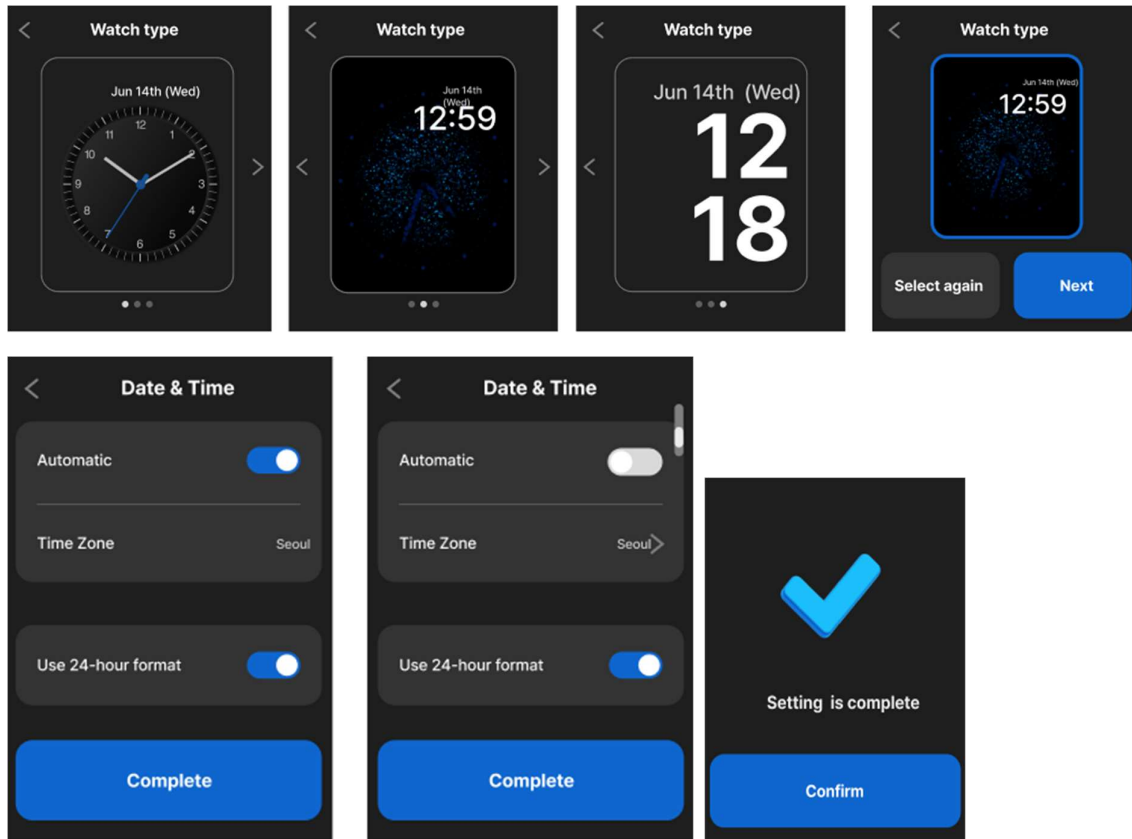

Health data

Provides health monitoring of the user. Please use the health data for reference only, as the values may vary depending on the user's wearing method and environmental conditions.

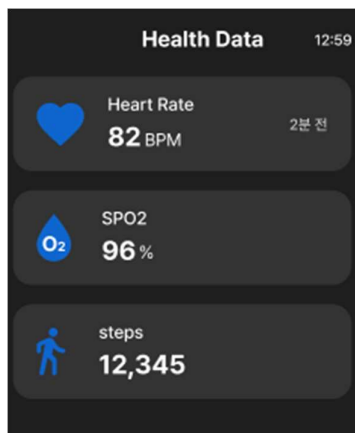

Control part

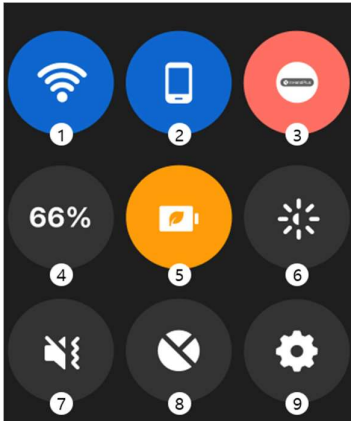

The control screen provides the status of various devices and system settings for smartwatch

- ① This icon sets up which devices on the Wi-Fi can connect, whether they are connected or disconnected.
- ② This icon sets up smartphone finding, connection, disconnection.
- ③ This icon sets up dongle(BLE sensor) finding, connection, disconnection.
- ④ This icon indicates the battery level of the smartwatch.
- ⑤ This icon is power saving mode. This may be limited by the capacity of the battery and this is user-selectable.
- ⑥ This icon is control of the screen brightness.
- ⑦ This icon is control of the speaker intensity.
- ⑧ This icon is medication history.
- ⑨ This icon is setting the font size, language, date, time, initial of smartwatch.

Wi-Fi connection



If it clicks the Wi-Fi status bar, you can select the available network. If the Wi-fi has password, you enter it.

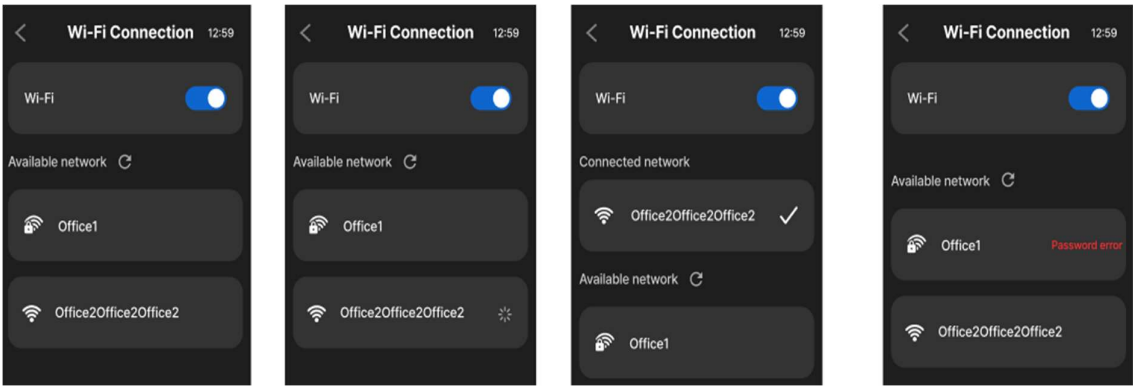

Smartphone connection

If it clicks the search icon, you can select the available smartphone.

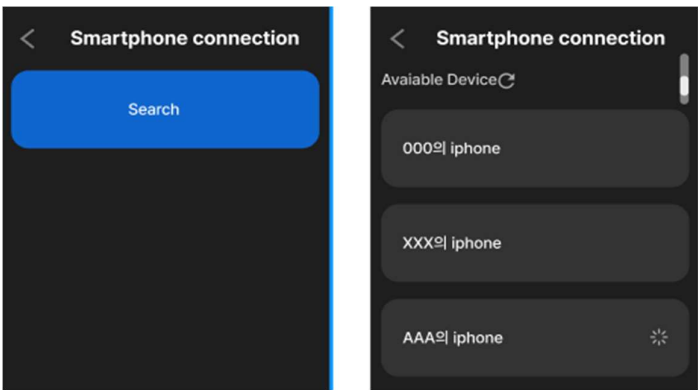

If the user removes the stored smartphone list, it click the Delete icon.

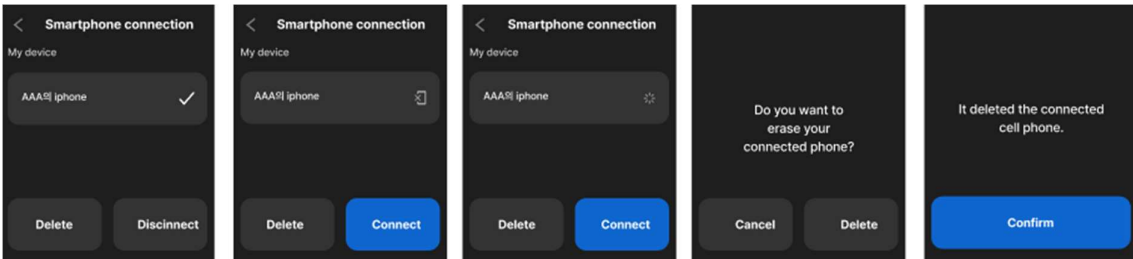

Dongle(BLE sensor) connection

When the user click the dongle icon , the user can see the available list. If the user wants to disconnected the dongle, click the Disconnect icon.

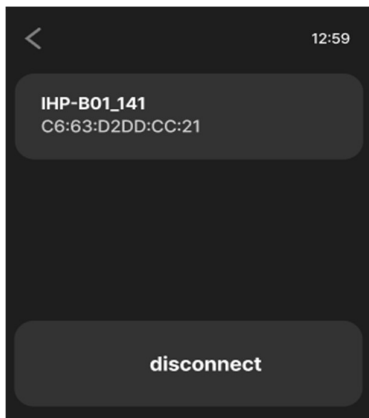
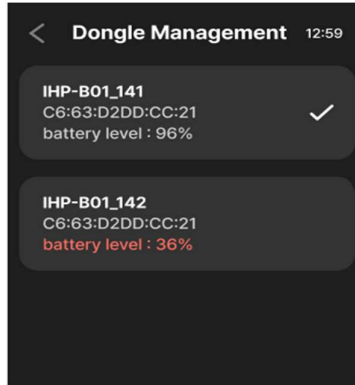
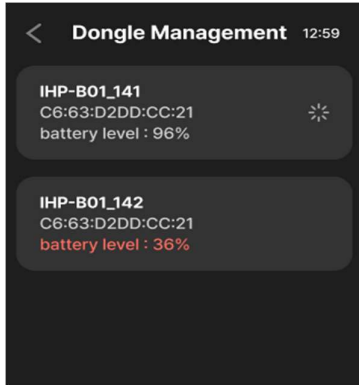

Brightness adjustment

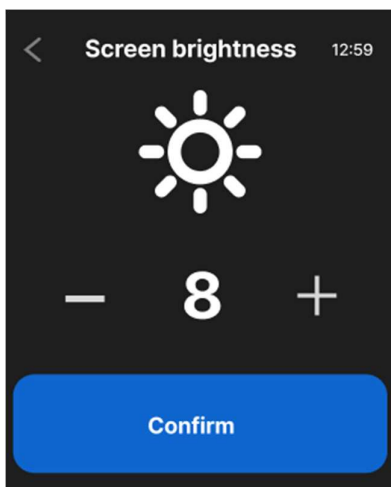

This part is brightness adjustment of smartwatch.

Medication management

When the user click the medication management  icon, the user can add the history of medication.

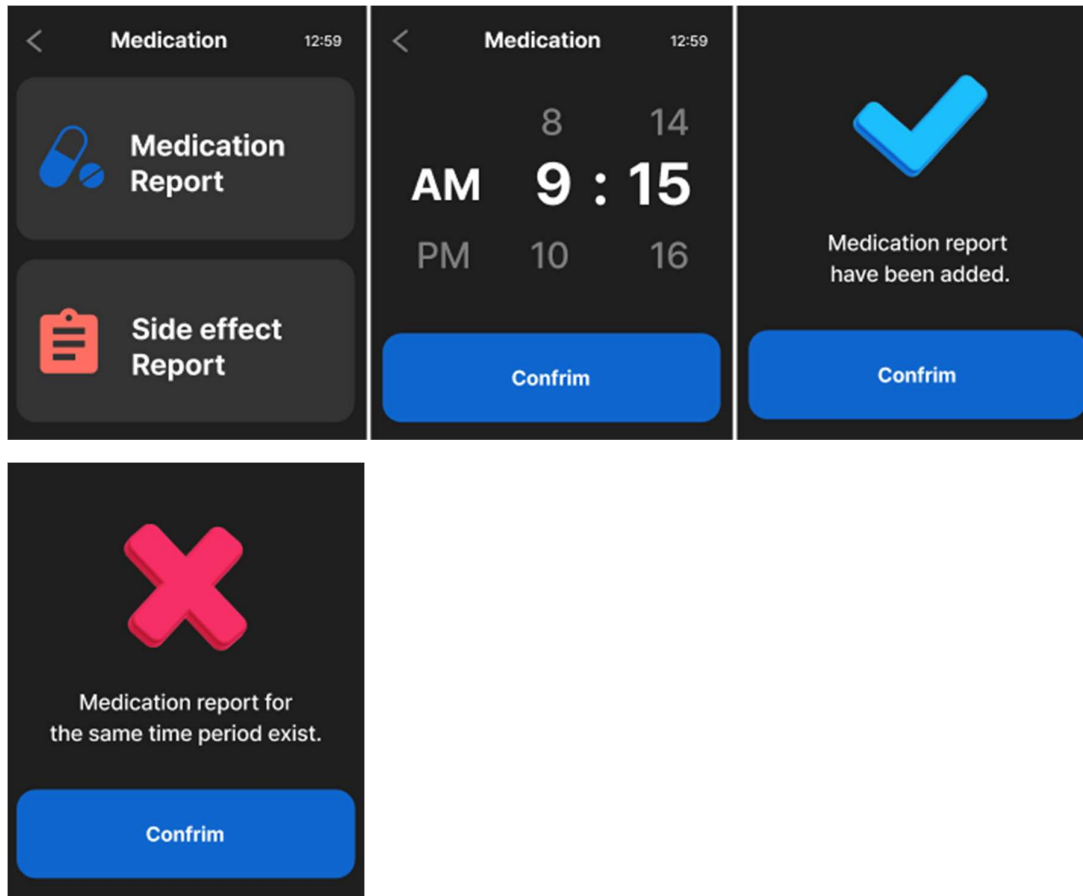

Preferences

Preferences include language, font size, screen orientation, date & time, clock type, reset, smartwatch information.

If the user want to smartwatch initial, it clicks the reset icon.

 Reset items are divided into network reset(Wi-Fi, BT), user setting reset(font size, wearing orientation, time settings, etc), system reset (factory default).

After the initialization, the existing information will be lost on the smartwatch. Please be careful when performing the initialization process.

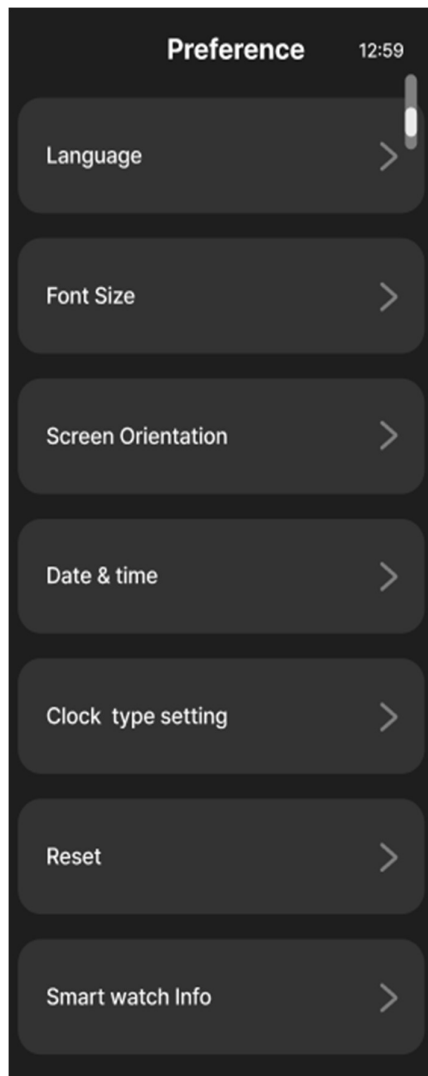

Medication recording

If the user's medication is being recorded, a screen display to remind the user of the recording time.
If the recording was caused by a mistake, the user can cancel the recording.

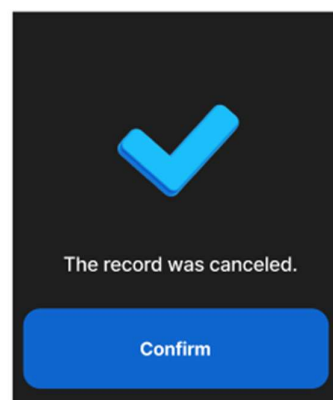
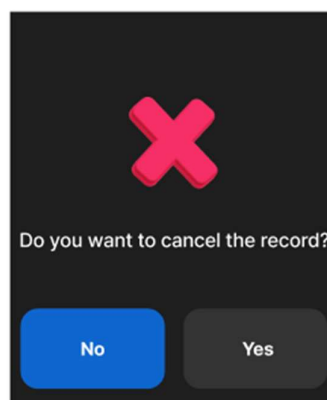
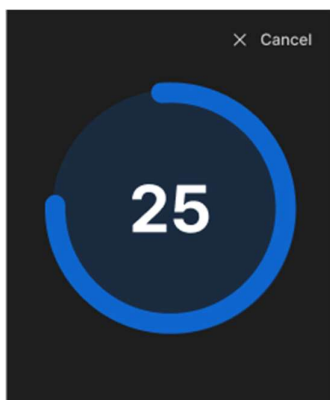

Alarm part

Alarm part provides a pop-up message that smartwatch events. The pop-ups message last for one minute (the last time is programable). After one minutes, it will be archived in the notification center, the user can see missed notifications.

Alarms include high temperature warning, camera cover closed waring, Wi-Fi connection request, dongle battery replacement, continuous dosing detection and so on.

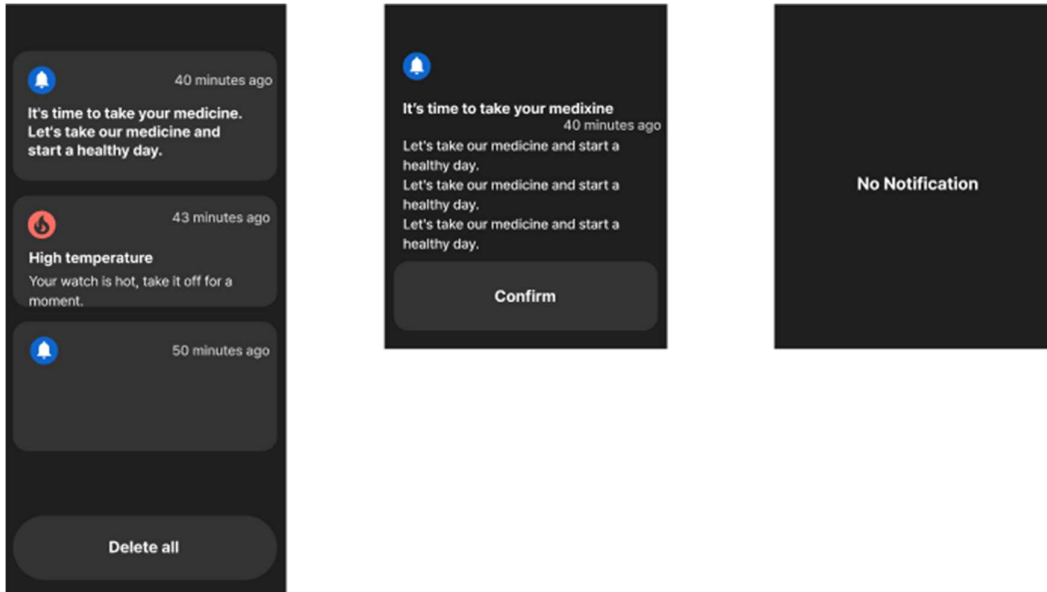

⚠ Among the alarm message, If the high temperature warning occurs, the user quickly removes the smartwatch from their wrist. Check the smartwatch condition or surface temperature of smartwatch.

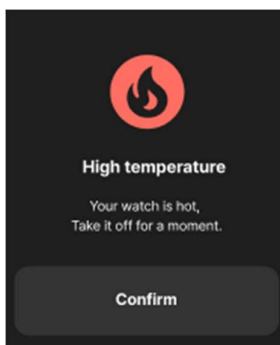

Other information

We will not reuse the personal information and don't use any purpose other than providing the service.

IHP-Watch02

Specifications and Feature

Product	
Waterproof	IP65 level
Size	58.9(L) x 47 (W) x 16.2(D)(Based on Max thickness, mm)
Operating Temp	0 ~ 45℃
Relative humidity	0 ~ 95%
KC Certification	R-R-ihp-Watch02
무선	
WLAN frequency	802.11 a/b/g/n/ac
BT version	BLE (BT5.0)
Battery	
Battery type	Lithium polymer
Battery capacity	500mAh
Charge type	PoGo pin
Display	
LCD	1.78 inch AMOELD LCD (368 x 448), MIPI-DSI
Sensor	
PPG	MAXM86161

Copyright

Copyright© 2023 InHandplus inc.

This user guide is a copyrighted work protected by copyright law. You may not reproduce, publicly transmit, distribute translate, or put into electronic media or machine-readable form, in whole or in part, this user guide.

Registered trademarks

- 인핸드플러스, InHandPlus, InHandPlus logo are registered trademarks of InHadPlus.
- All other trademarks and copyrights are the property of their respective companies.

FCC Information to User

This equipment has been tested and found to comply with the limits for a Class B digital device, pursuant to Part 15 of the FCC Rules. These limits are designed to provide reasonable protection against harmful interference in a residential installation. This equipment generates, uses and can radiate radio frequency energy and, if not installed and used in accordance with the instructions, may cause harmful interference to radio communications. However, there is no guarantee that interference will not occur in a particular installation. If this equipment does cause harmful interference to radio or television reception, which can be determined by turning the equipment off and on, the user is encouraged to try to correct the interference by one of the following measures:

- Reorient or relocate the receiving antenna.
- Increase the separation between the equipment and receiver.
- Connect the equipment into an outlet on a circuit different from that to which the receiver is connected.
- Consult the dealer or an experienced radio/TV technician for help.

Caution

Modifications not expressly approved by the party responsible for compliance could void the user's authority to operate the equipment.

FCC Compliance Information : This device complies with Part 15 of the FCC Rules. Operation is subject to the following two conditions: (1) This device may not cause harmful interference, and (2) this device must accept any interference received, including interference that may cause undesired operation