

# Wi-Fi Pet Feeder

## User Manual

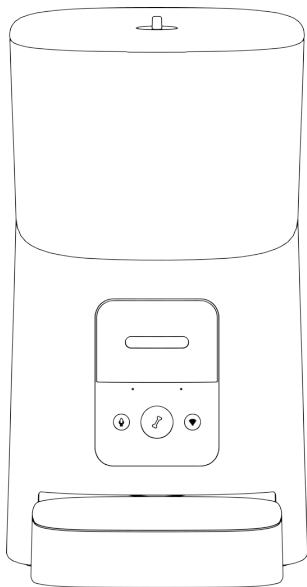

## Contents

Hardware installation and introduction.....	1
Battery.....	1
Software Installation.....	4
Feeding.....	8
Manual feeding.....	8
Timed feeding.....	9
Feeding voice recording.....	10
Feeding records and alarm.....	11
Others.....	13
Basic settings.....	13
Advanced settings.....	13
FAQ.....	15
Reset.....	16

# Hardware installation and introduction

1. Insert the Type-c USB power cord into the connector at the bottom; and extend the power cord out along the designed guide. You can also insert 3 pieces of D cell batteries which will enable the feeder to work automatically according to your scheduled feeding plan even without an external power supply.

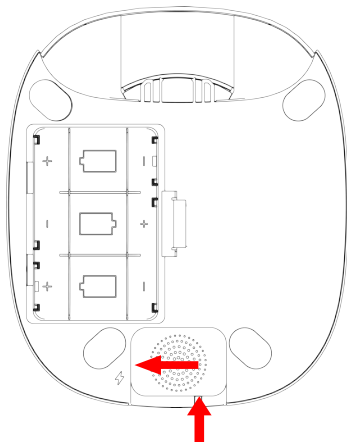

## Battery

The back-up battery is designed as a short-term alternative for when the external power supply is cut. When the pet feeder works on battery back-up, it will go into sleep mode and some functions will be limited:

- a. When there is battery supply only, the feeding voice recording will be played only once before feeding the pets. It will not play during feeding.
- b. When there is battery supply only, the feeder's Wi-Fi connection will be disconnected. All the operations on the App will be unavailable.

2. Rotate the knob on the top cover. The feeding tray is in the food bucket. Place the feeding tray into the feeder from the front, then pour pet food into the feeder.

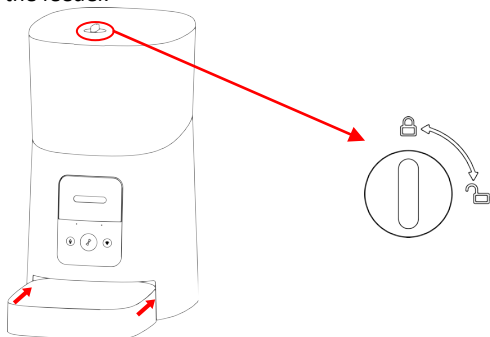

Note: Due to the wide variety of pet foods on the market, it cannot be guaranteed 100% that the mechanical structure of the feeder will fit all types of pet food. We recommend to use only dry food within 3-15mm in size. Wet food and damp food are strictly prohibited from being placed in the feeder.

3. For your pet's health, please wash the food bucket and feeding tray regularly. The feeder body should not be filled with water. Please wipe it with a wring-able wet cloth.

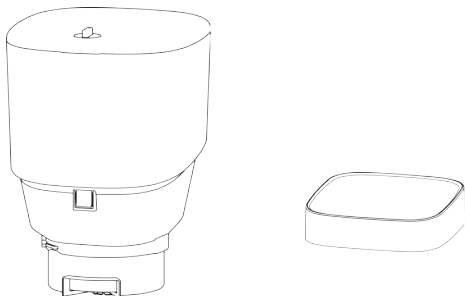

4. To release and clean the food bucket, please unlock the bucket lock at the rear of the feeder body. Rotate the food distribution cover to unlock and clean the food distributor easily.

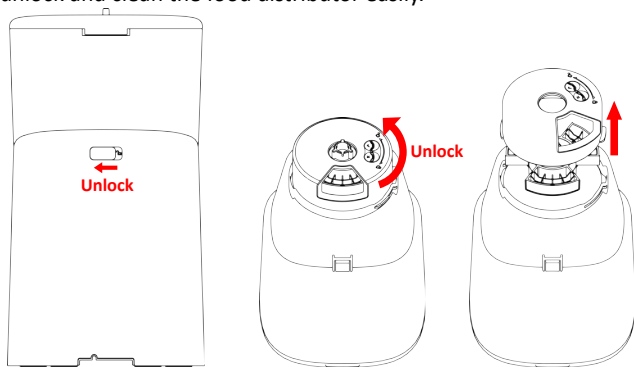

Operation panel introduction:

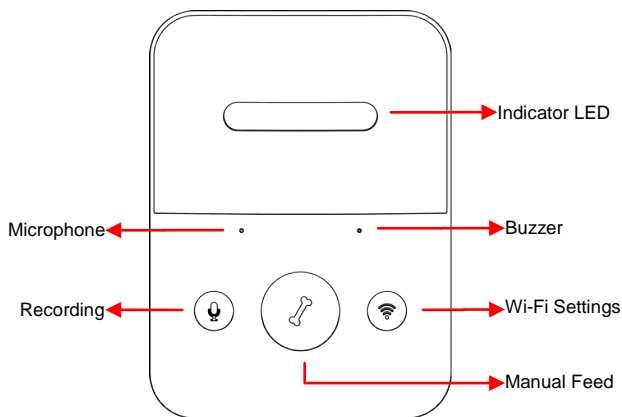

# Software Installation

1. Search the App Store or scan the QR code below to download and install **Pet Zero**.



Pet Zero



Download Website 1



Download Website 2

2. Run the App, read and agree to the privacy policy, and register a new account or login to a registered account. When you register or login to the account, please choose the correct country or area.

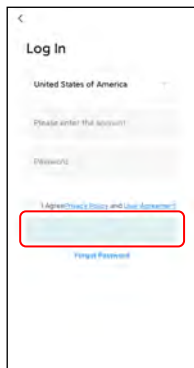
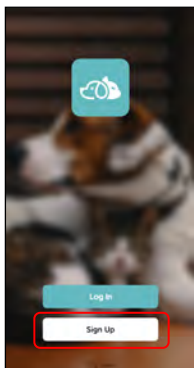
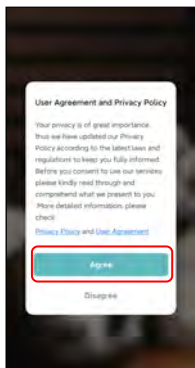

3. Click **Add Device** or **+** to add a new pet feeder.

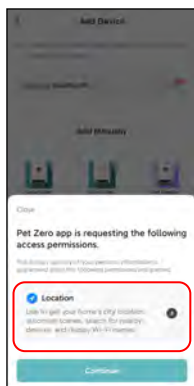
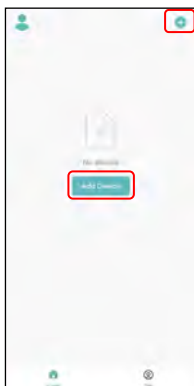

4. Power on the feeder, check whether the feeder's indicator is flashing in RED. If the current indicator LED is in any other state, please press and hold the Wi-Fi Settings button for about 5 seconds to reset the feeder.

Indicator LED status:

Flashing rapidly in RED	Feeder is waiting for Wi-Fi network
Flashing slowly in RED	Feeder is waiting for Wi-Fi network
Always on in RED	Feeder is configured for the Wi-Fi network and trying to connect. If the connection fails, it will always be red.
Always on in BLUE	Feeder is connected to the Wi-Fi network. It can be turned off in the settings.
Flashing in BLUE	Feeder is feeding.
Always off	Feeder is only powered by battery or turned off manually.

5. Then please fill in the Wi-Fi network information. The name of Wi-Fi network will appear in the textbox automatically.

Next, please enter the Wi-Fi password and click **Next**.



6. Then the App will ask you to switch your mobile phone's network to a new network broadcast by the feeder. Please go to **Wi-Fi settings on the mobile phone** and connect to the Wi-Fi which starts with **SmartLife-**. No password is necessary.



7. Return to the App after the Wi-Fi is connected.

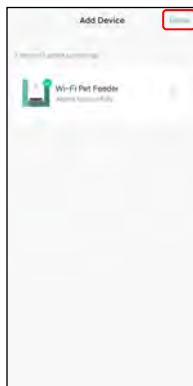
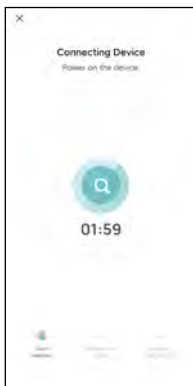

### Important Notice:

- When entering the password, be aware that it is case sensitive.
- The feeder does not support WPA3 and WEP encryption, please choose WPA or WPA2 encryption in the router's WLAN settings.
- We recommend not using non-English letters and numbers as SSID.

- d. Make sure the feeder is not far away from router and reboot router to try again.
- e. Make sure that MAC address filtering and wireless device isolation is turned off on the wireless router.
- f. The feeder may not support the Wi-Fi signal of the wireless repeater. If the connection fails, try connecting to the wireless router.

## Feeding

### Manual feeding

1. Enter feeder's main interface. Click **Manual feed**. Choose the feeding portions and click **OK**. The feeder will feed immediately.

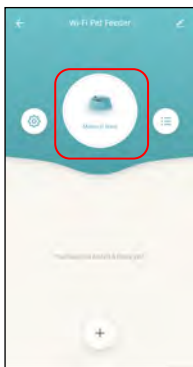
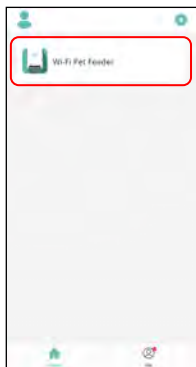

2. You can also double click the Manual feed button on the feeder to feed manually. The feeding amount can be adjusted in the App.  
Click  and set up Feed portions using the button. Setting it to 0 can disable this function.

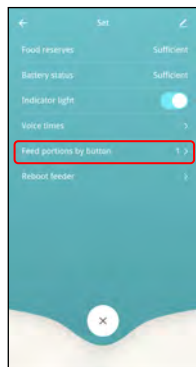
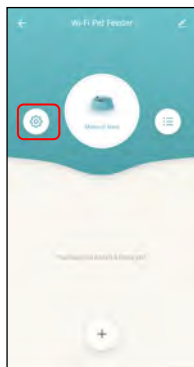
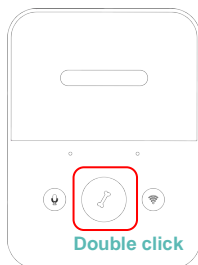

## Timed feeding

1. The pet feeder supports the scheduled feeding of exact portions at exact times. Click the **+** button in App, choose **feeding time**, **repeat rules for each day of the week**, and **feed portions**, then click **Save**.

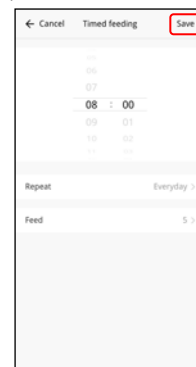
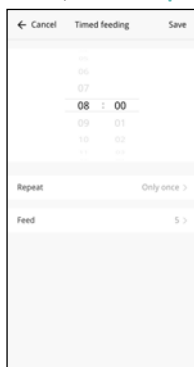
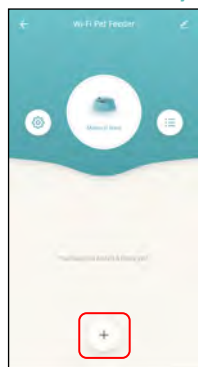

2. The feeder supports up to 15 feeding schedules. If you need to disable a schedule, you can disable it by disable its switch. You can also delete it by swiping the feeding schedule to the left to access the delete option.

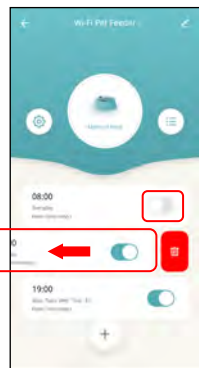
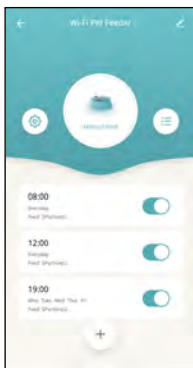
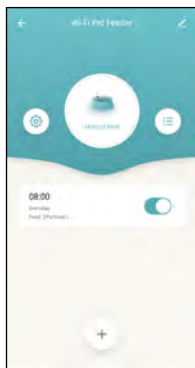

## Feeding voice recording

1. To develop good feeding habits for pets, the feeder supports pre-recording a maximum of 10 seconds of audio, which is played during feeding.
2. Press and hold the record button for 3 seconds until the feeder makes a “Drip” sound, then you can start talking at the microphone position. Note that the recording button should always be pressed continually. After the recording is complete, release the button, the feeder will make two “Drip” sounds.
3. After recording is complete, you can preview the recorded audio by short pressing the record button. If you need to change the recording, please re-record it. The closer you are to the microphone, the louder your voice can be recorded.
4. The default voice recording playback is 3 times. It can be customized for a maximum of 5 times. Click  and set up **Voice times**. Setting it to 0 can disable the feeding audio function.

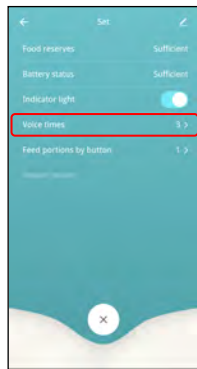
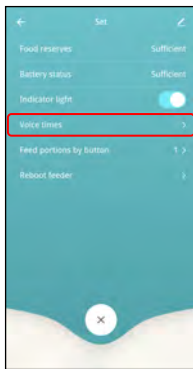
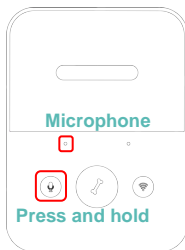

### Notice:

- When the pet feeder is connected by the regular power adapter, the pet feeder recording will be played during feeding. It will play the number of set times(3times/4times/5times) until the feeder has finished feeding.
- If pet food blocks the food tray, the pet feeder will stop feeding and wait for 10 minutes. The voice recording will be played 1 time per minute to call the pets. If the pets finish the food in the tray, the pet feeder will work as scheduled in the feeding plan. Otherwise, it will stop feeding if the pets still do not finish feeding after 10 minutes. The feeder cannot be operate until feeding resumes.
- The voice recording will not play when feeding by button.

## Feeding records and alarm

- After feeding, there will be feeding records in the App. Click  to check the feeding records. The feeding records of the last 7 days will be

shown.

2. When the food level is insufficient or zero, a message will appear on the  page.

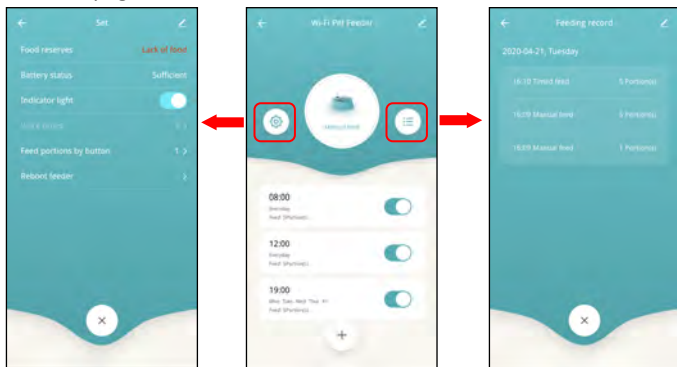

3. Machine malfunctions include low food storage, low battery and food jammed in the feeding bucket or feeding tray.
4. When a malfunction occurs, a message will appear in the App. And you can check error messages in the message center. Make sure that prompt message (notification) is enabled.

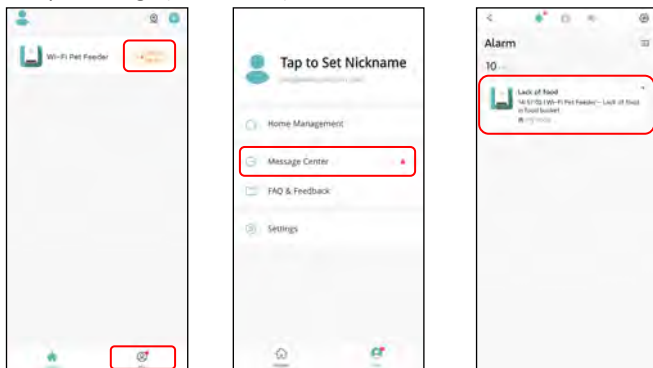

# Others

## Basic settings

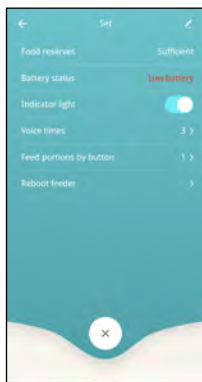

**Battery Status:** Shows the status of the battery.

**Indicator lights:** Turns on/off the indicator when the feeder is connected to the Wi-Fi network.

**Reboot feeder:** Reboots the feeder manually.

## Advanced settings

Click  to access the advanced settings page.

**Device information:** Check feeder information. Please make sure that the time zone of the feeder is correct. It should be same as the mobile phone's time zone when adding the feeder. If it is incorrect, the feeder may feed at incorrect times, so please remove the feeder and add it again.

**Offline Notification:** When the feeder is offline, a notification will sent to your mobile phone.

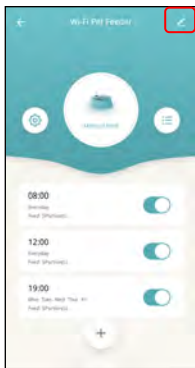

**Share Device:** If you want to add the feeder to another mobile phone, register a new account on the new mobile phone, then share the device with the new account. Please make sure that both 2 accounts are in the same country or area when registering them.

**Add to home screen:** Add this feeder to home screen to enter the feeder's control page easily.

**Remove Device:** There are 2 options that will both remove the device from the App but not delete the settings in the feeder. You could re-configure the feeder's Wi-Fi network using these 2 options. If you wish to remove all the settings in the feeder, please long press the Wi-Fi button on the feeder until you hear a beep.

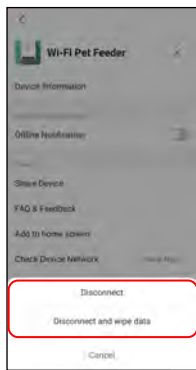
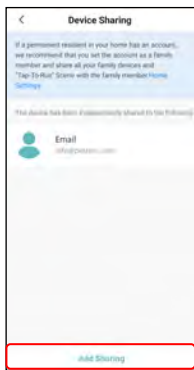
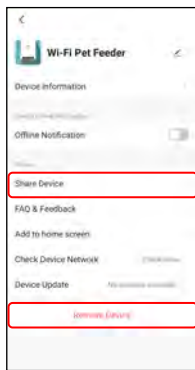

## FAQ

### Q: Why the motor runs reversely?

A: When the food gets stuck, the motor will run reversely to solve the food stuck problem.

### Q: Why did the feeder fail to connect to my Wi-Fi network?

A: Please check the important notice on Page 7 for help.

### Q: Why is the feeding recording only played once or never when I set the recording multiple times?

A: Please press and hold the record button to record your voice first. If the feeder is working on battery supply only, the recording will be played only once before feeding.

### Q: Why does the feeder feed at the wrong time?

A: Please check that the time zone of the feeder is correct. You can find help about time zone information on page 13.

### Q: Why does it always prompt that food is blocking at the feeding tray when it is not actually the case?

A: Once food falls into the tray, the feeder will wait for 10 minutes for the pet to eat the food. If the pet does not come to eat during this time, the

feeder will send a message that food is blocking the feeding tray. If the pet ate the food after 10 minutes, you will still receive the message. It is also possible that food is stuck in the food slot. If that is the case, clean the food slot.

**Q: Why is the indicator LED still flashing after I disabled?**

A: When it is feeding, the indicator LED cannot be disabled.

**Q: Why the indicator LED is always off?**

A: There are 2 reasons. The indicator LED will be turned off when the feeder is only powered by battery. The indicator LED could also be disabled manually in settings.

**Q: Why my feeder could not connect to Internet when it is only powered by battery.**

A: When there is battery supply only, the feeder's Wi-Fi connection will be disconnected. All the operations on the App will be unavailable.

## **Reset**

To restore the feeder to factory default setting, please connect the feeder to external USB power supply. Then long press the Wi-Fi settings button for 5 seconds until you hear a beep.

Note: 5G band (W52) indoor use only.

### **ISED Canada Statement:**

This device contains licence-exempt transmitter(s)/receiver(s)/ that comply with Innovation Science and Economic Development Canada's licence-exempt RSS(s). Operation is subject to the following two conditions:

- 1) this device may not cause interference and
- 2) this device must accept any interference, including interference that may cause undesired operation of the device.

Radiation Exposure: This equipment complies with Canada radiation exposure limits set forth for an uncontrolled environment; To maintain compliance with IC's RF Exposure guidelines, This equipment should be installed and operated with minimum distance of 20cm the radiator your body. This device and its antenna(s) must not be co-located or operation in conjunction with any other antenna or transmitter.

### **Déclaration de l'ISED Canada :**

Cet appareil contient des tasmittre (s) / récepteur (s) sans licence / conformes à l'innovationRSS exemptes de licence de Sciences et Développement économique Canada. L'opération est sous réserve des deux conditions suivantes :

- 1) cet appareil ne peut pas causer d'interférences et
- 2) cet dispositif doit accepter toute interférence, y compris peut provoquer le fonctionnement indésirable de l'appareil.

Exposition aux rayonnements : Cet équipement est conforme aux radiations du Canada limites d'exposition pour un environnement incontrôlé noncé d'exposition RF Pour maintenir le respect des guides d'exposition RF d'IC, cquipment doit être installé et actionné avec une distance minimale de 20cm le radiateur de votre corps. Cet appareil et

ses antennes ne doivent pas être co-localisé ou en opération en conjonction avec toute autre antenne ou émetteur.

### **FCC Warning Statement**

Changes or modifications not expressly approved by the party responsible for compliance could void the user's authority to operate the equipment. This equipment has been tested and found to comply with the limits for a Class B digital device, pursuant to Part 15 of the FCC Rules. These limits are designed to provide reasonable protection against harmful interference in a residential installation. This equipment generates uses and can radiate radio frequency energy and, if not installed and used in accordance with the instructions, may cause harmful interference to radio communications. However, there is no guarantee that interference will not occur in a particular installation. If this equipment does cause harmful interference to radio or television reception, which can be determined by turning the equipment off and on, the user is encouraged to try to correct the interference by one or more of the following measures:

- - Reorient or relocate the receiving antenna.
- - Increase the separation between the equipment and receiver.
- - Connect the equipment into an outlet on a circuit different from that to which the receiver is connected.
- - Consult the dealer or an experienced radio/TV technician for help.

This device complies with part 15 of the FCC Rules. Operation is subject to the following two conditions: (1) This device may not cause harmful interference, and (2) this device must accept any interference received, including interference that may cause undesired operation.

## **RF Exposure Statement**

To maintain compliance with FCC's RF Exposure guidelines, This equipment should be installed and operated with minimum distance of 20cm the radiator your body. This device and its antenna(s) must not be co-located or operation in conjunction with any other antenna or transmitter.