

Nokia Essential True Wireless Earphones E3100 Plus

User guide

FCC ID:2BCCT-E3100PLUS

Contents

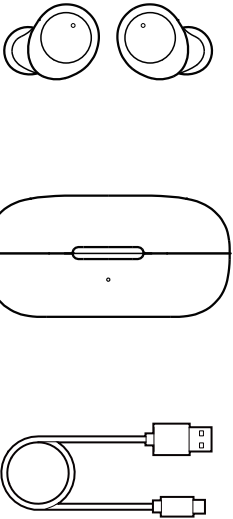

Powering on

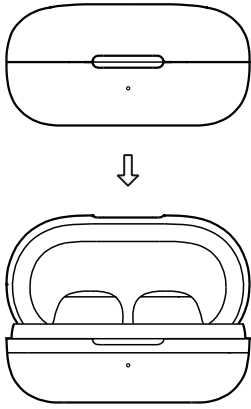

Pairing mode

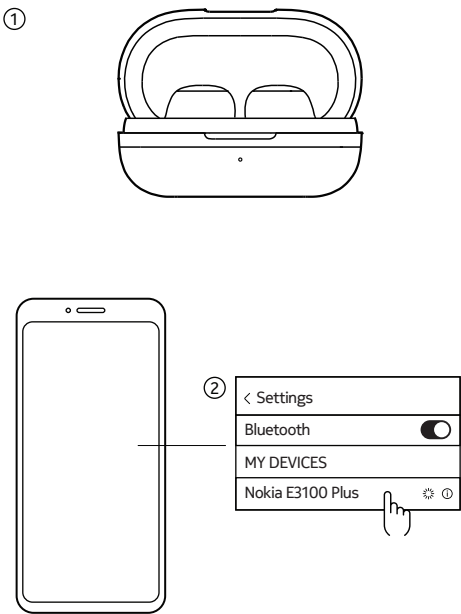

Charging

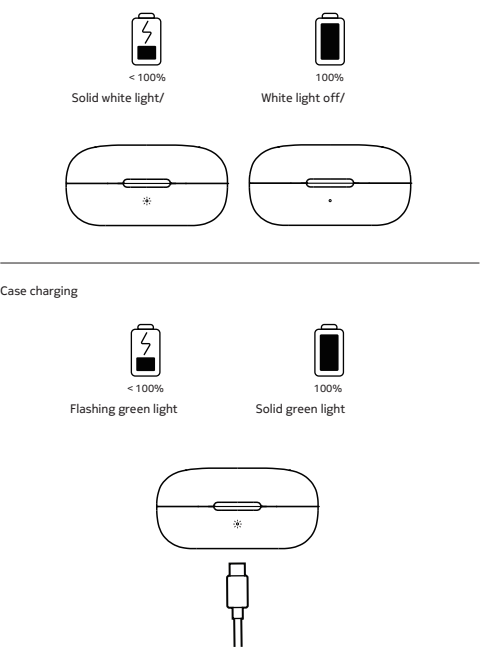

Troubleshooting

Problem	Reason	Solutions
Does not power on / Does not respond	Battery is low	Charge the earphones for 1.5 hours and reconnect the earphones
No sound after pairing	Incorrect pairing	Pair the earphones again or reset the earphones
Turns off automatically	Battery is low	Charge the earphones for 1.5 hours
Failing to charge	Error with power supply	Perform a reset
No light on the case during charging	Error with power supply	Check that the charging cable is plugged in. Ensure that the wall switch is on using a wall charger
Hearing an echo	Volume is too loud or the environment is too noisy	Adjust the volume or change your location
Noise in-call / Sound occasionally drops	Noisy environment or distance between earphones and mobile phone is too far	Change your location or bring your earphones and mobile phone closer together
Sound is too soft	Low volume	Increase the volume
Pairing unsuccessful / Only one side has sound / Cannot find the pairing name on the device / Mono pairing unsuccessful	Too many pairing records or not paired properly	Remove at least one pairing from your device's pairing list, reset and pair the earphones again
Earphones don't power on after removing them from the charging case	Charging case is low in battery	Charge the earphones and the charging case for 1.5 hours

Specifications

Nokia Essential True Wireless Earphones E3100 Plus

Wearing style	: True wireless earphones
Ear coupling	: Ear canal
Frequency response	: 20Hz to 20kHz
Transducer principle	: Dynamic driver
Transducer size	: 6mm
Sound pressure level(SPL)	: 102dB±3dB
Impedance	: 32Ω
Microphone principle	: MEMS x 2
Power supply	: Built-in Lithium rechargeable batteries
	: Left earphone: 35mAh/3.7V
	: Right earphone: 35mAh/3.7V
	: Charging case: 300mAh/3.7V
Operating time	: Up to 5hrs (music playback via A2DP with 70% of the volume) with rechargeable batteries of the earphones* Up to 24hrs with rechargeable battery of the charging case*
Charging time	: Earphones: approx. 1.5hrs Charging case: approx. 2hrs
Ingress protection (earphones)	: Anti-dust and splash proof (IP44)
Weight	: Left earphone; approx. 3.4g Right earphone; approx. 3.4g Charging case; approx. 36g
Volume control	: Yes

Bluetooth

Version	: Bluetooth specification version 5.2
Profiles	: HFP, HSP, AVRCP, A2DP
Effective range	: Line of sight approx. 30ft(10m)
Transmission frequency	: 2400MHz to 2483.5MHz
Output power	: 3mW (max.)
Supported audio format(s)	: SBC

* Charging case that holds multiple charges for total playtime. Battery life depends on device settings, environment, usage and many other factors.

Safety guide

Important safety instructions

- Please read this user guide and warranty manual carefully before using the product for the first time.
- Do include this user guide if passing the product on to new users.
- Please inspect the product before use. If there are signs of defects, please stop using the product immediately.
- Use only the product in environments where wireless Bluetooth®transmission is permitted.

Preventing damage to health and accidents

- Do not listen at high volumes, especially for extended periods, to prevent hearing injury.
- The permanent magnetic fields created by this product may interfere with medical implants such as cardiac pacemakers and implanted defibrillators (ICDs). Please always maintain a distance of at least 10cm (3.94") between the products' magnetic component/s and implanted medical device/s at all times.
- Keep this product, its accessories and packaging out of reach of young children or pets, as these may pose choking hazards.
- Do not use the product in an environment that requires your special-attention (e.g. in traffic).

Preventing damage to the product and malfunctions

- Always keep the product dry and avoid exposure to heat sources (including hairdryers, heaters, prolonged strong sunlight etc.) as this may result in product deformation or malfunction. The normal operating temperature of the product is 0 °C-40 °C or 32 °F-104 °F.
- Please do not use any attachments, accessories, or spare parts with the product unless they are included with the product or recommended by RichGo Technology Co. Ltd.
- The product should only be cleaned, where necessary, with a soft, dry cloth.

Safety instructions for lithium rechargeable batteries

WARNING
In extreme cases, rechargeable batteries may leak and may cause the following hazards if abused or misused:

- explosion • fire development • heat generation • smoke or gas development

Dispose of defective products with built-in rechargeable batteries at special collection points or return them to your specialist dealer.

Only use rechargeable batteries recommended by RichGo and the appropriate chargers.

Only charge the product / rechargeable batteries at ambient temperatures between 10°C/50°F and 40°C/104°F.

Switch battery pack-powered products off after use.

When not using for extended periods of time, recharge the product / rechargeable batteries regularly (about every 3 months).

Do not heat the product / rechargeable batteries above 70 °C/158°F. Avoid exposure to sunlight and do not throw the product / rechargeable batteries into fire.

Reset

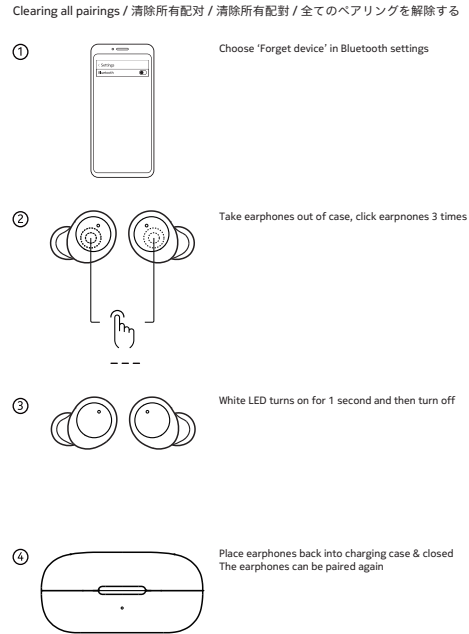

Intended use/Liability

RichGo will not be responsible for any indirect or consequential loss, loss of profits or loss of data. Warranty will be void under the following conditions, and manufacturer reserves the right to refuse to provide service and to demand charges for any costs of servicing from the customer.

There will be no warranty if the product has been modified or repaired by persons not authorized by manufacturer; Mishandling or wrong application of product, such as leaving batteries over an extended period in the product causing battery fluid leakage, or applying wrong voltage, manual destruction, damage caused by natural disaster or accident; Product caused by impact sand or liquid damage, tampering, or operating fail; Install and maintain product without following instructions provided by the manufacturer; If the model number or item code attached with the product has been erased or modified; Modify without authorization the contents of this warranty policy.

If the product have been used for commercial, display, demonstration or rental purpose. All parts replaced within the warranty period are properties of manufacturer. We have the right to handle those parts as necessary.

Warranty covers only the hardware of the product's main body. All other accessories are not covered within the warranty terms, such as external connection cable, power cable, computer cables, software, CD, external cover/cabinet and user manual. (For item description and accessories, please refer to the user manual/instruction manual/user guide)

Manufacturer Declarations
More information on legal compliance labels can be found at the end of this document.

Always return your used electronic products, batteries, and packaging materials to dedicated collection points. This way you help prevent uncontrolled waste disposal and promote the recycling of materials. Electrical and electronic products contain a lot of valuable materials, including metals (such as copper, aluminum, steel, and magnesium) and precious metals (such as gold, silver, and palladium). All materials of the device can be recovered as materials and energy. The crossed-out wheellie bin symbol on your product, battery, literature, or packaging reminds you that all electrical and electronic products and batteries must be taken to separate collection at the end of their working life. Do not dispose of these products as unsorted municipal waste: take them for recycling. For info on your nearest recycling point, check with your local waste authority.

FCC Statement
Note: This equipment has been tested and found to comply with the limits for a Class B digital device, pursuant to part 15 of the FCC Rules. These limits are designed to provide reasonable protection against harmful interference in a residential installation. This equipment generates, uses and can radiate radio frequency energy and, if not installed and used in accordance with the instructions, may cause harmful interference to radio communications. However, there is no guarantee that interference will not occur in a particular installation. If this equipment does cause harmful interference to radio or television reception, which can be determined by turning the equipment off and on, the user is encouraged to try to correct the interference by one or more of the following measures:

- Reorient or relocate the receiving antenna.
- Increase the separation between the equipment and receiver.
- Connect the equipment into an outlet on a circuit different from that to which the receiver is connected.
- Consult the dealer or an experienced radio/TV technician for help.

This device complies with part 15 of the FCC Rules. Operation is subject to the following two conditions (1) This device may not cause harmful interference, and (2) this device must accept any interference received, including interference that may cause undesired operation.

Any changes or modifications not expressly approved by the party responsible for compliance could void the user's authority to operate the equipment.

The device has evaluated to meet general RF exposure requirement. The device can be used in portable exposure without restrictions.