

120g双胶纸

整本尺寸:140mmx210mm

四色印刷

USER MANUAL



AIRTHEREAL

SMART FRAGRANCE DIFFUSER SAM200S

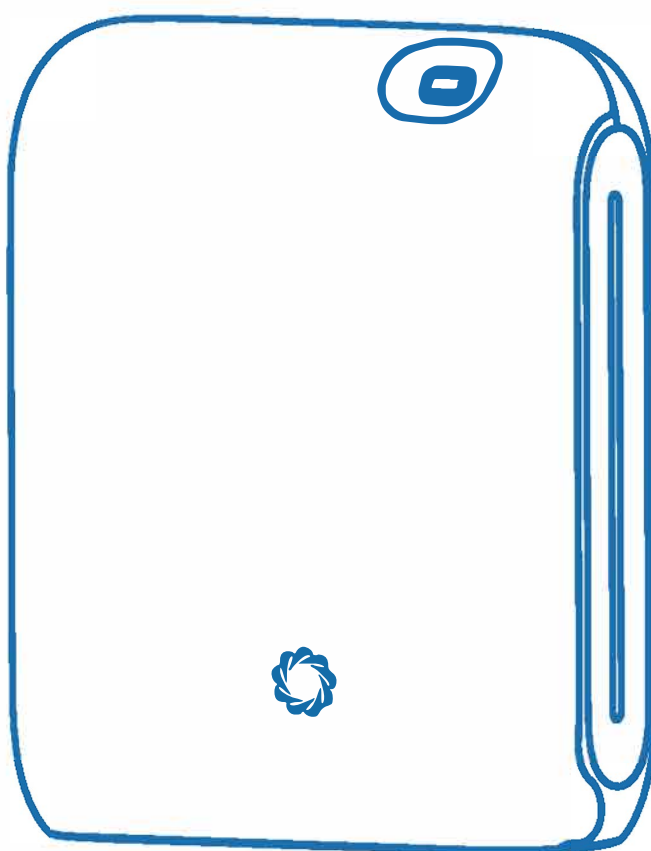

Please read this user manual in its entirety before use and keep it for future reference.

CONTENTS

SAFETY INSTRUCTIONS	02
SPECIFICATIONS	02
COMPONENTS	03
OPERATION	04
CONTROL	05
CLEANING INSTRUCTIONS	08
TROUBLESHOOTING	09
FCC STATEMENT	10
FCC RADIATION EXPOSURE STATEMENT	10
LIMITED WARRANTY	11
ATTRIBUTIONS	11

SAFETY INSTRUCTIONS

IMPORTANT SAFEGUARDS: To avoid the risk of serious injury when using your Fragrance Diffuser, basic safety precautions must be followed, including but not limited to the following.

- Do not install the device where children can reach it.
- Do not tilt the device as oil may spill.
- Do not use the device in high-temperature or wet environments.
- Keep the device away from fire and heat sources, and do not store flammable or explosive materials near the device.
- Install the device in a well-ventilated area.
- Do not use flammable, explosive, corrosive, or other hazardous solvents with the device.
- Do not block the sprayer by hand or other obstructions when the device is in use.
- Do not spill water or conductive, corrosive liquids on the device or allow such liquids to get inside of the device.
- Do not overuse the device without pausing. The average daily use time is not to exceed 14 hours.
- Choose a safe way to cut off the power in extreme weather environments.

SPECIFICATIONS

Product Name	SMART FRAGRANCE DIFFUSER
Model Number	SAM200S
Rated Voltage	AC 120V to DC 1.5V / Battery
Rated Power	1.2W
Capacity	6.8oz (200ml)
Use Ambient Temp.	41°-113°F
Use Ambient Humidity	30%-80%
Battery	3 x 1.5V D Cell LR20
Unit Weight	0.95 Lbs
Unit Dimensions	5.5 x 2.6 x 7.0 Inches

COMPONENTS

Product

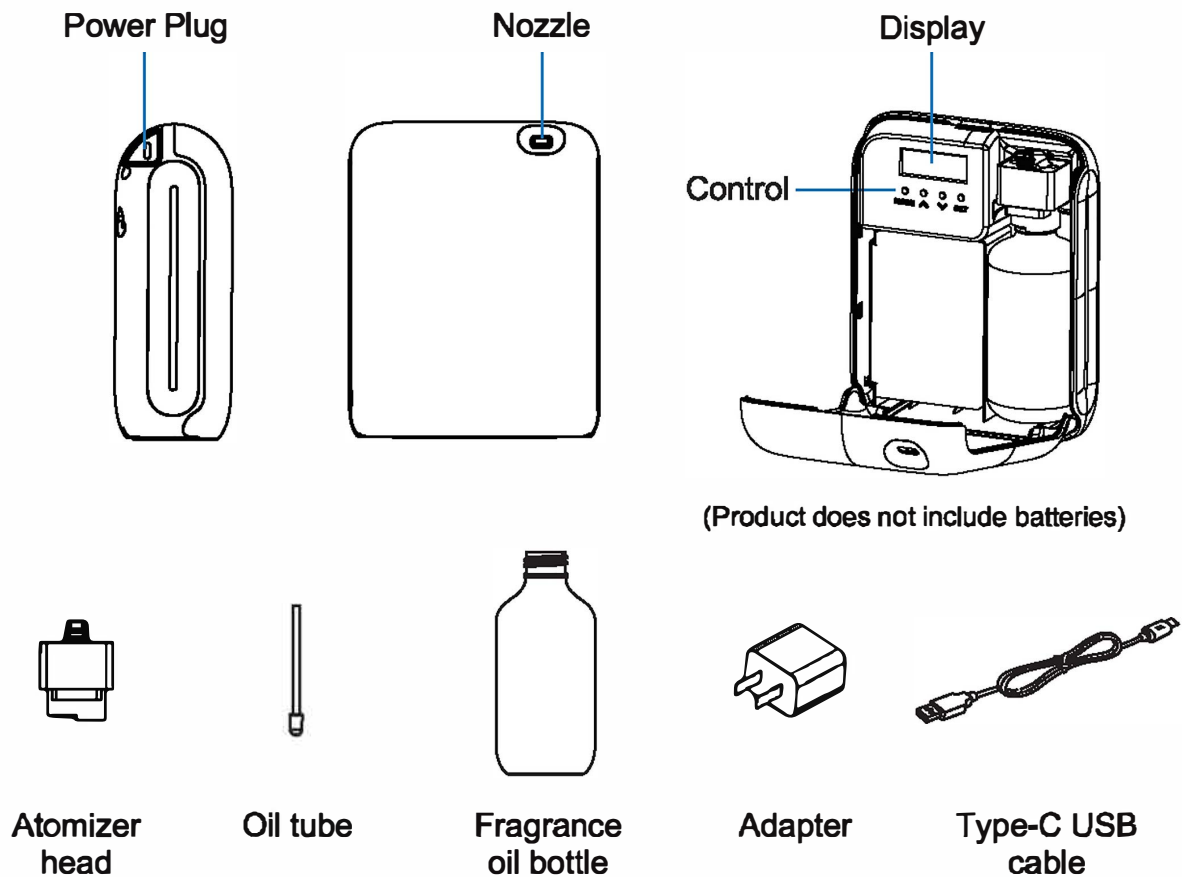

WARNING

1. Please keep the machine vertical. Tilting may cause oil to overflow and the long-term efficiency of the machine may be affected.
2. Do not use this product in high humidity or high-pressure environments.
3. Do not install the device in a place that cannot bear load or may fall over.
4. Do not overuse the device without pausing. The average daily use time is not to exceed 14 hours.
5. Pay attention to adding essential oil after it is used. If operated without essential oil for prolonged periods, the machine will be damaged.

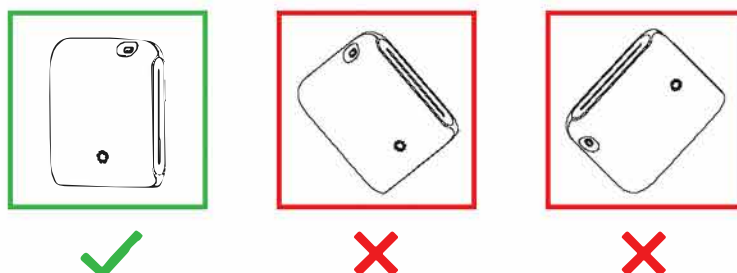

OPERATION



1. Press the open button.



2. Remove the oil bottle and pour essential oil into the bottle.



3. Insert the atomizer into the machine.



4. Install three (3) D-size batteries for battery power or plug in a Type-C wire for direct power.



5. Use the control panel or the AIR.ai app to change the settings.

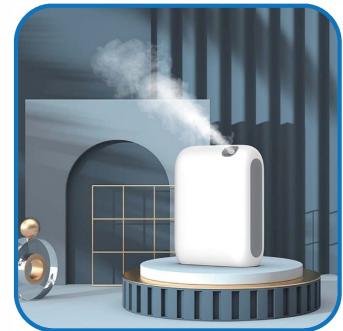

6. Enjoy the fragrance.

Note: Water does not need to be mixed with the essential oil.

Default mode: The diffuser will work for 10 seconds and pause for 120 seconds, then repeat.

CONTROL

APP Control

Step 1

Download the **AIR.ai** app from the App Store (iOS devices) or Google Play (Android devices).



Google Play



App Store

Step 2

Turn on the bluetooth function on your phone, (only connect with bluetooth).
Open AIR.ai and tap the “+” icon in the top right corner (phone should be near the machine).
It will appear an added page, click “Go to add”,

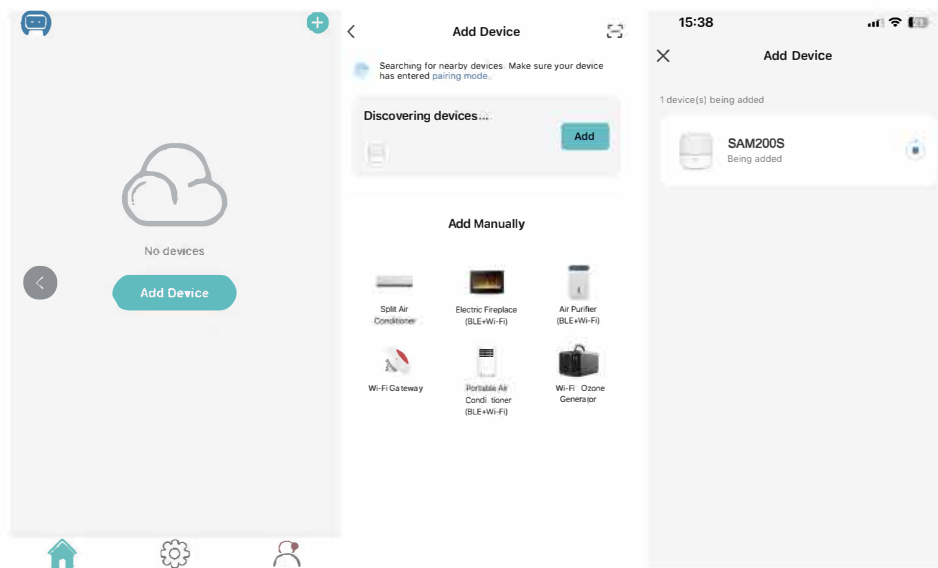

Step 3

Your device is connected successfully now. You can find the SAM200S in the device list.

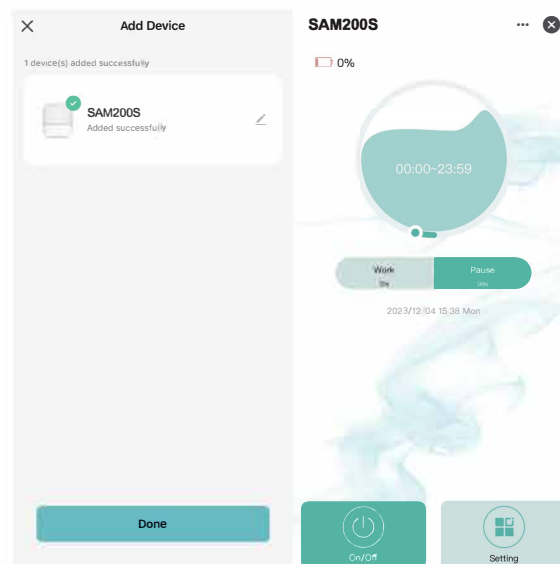

Mode control with the AIR.ai app

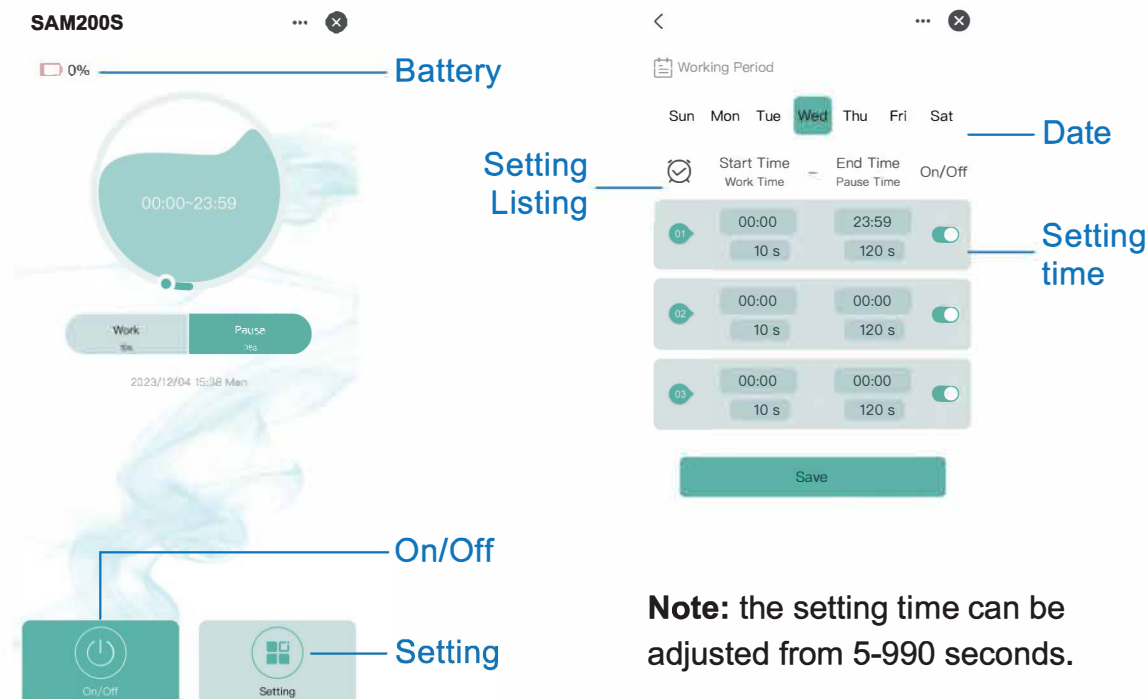

Note: the setting time can be adjusted from 5-990 seconds.

Manual Control

Attention: Please use a 5V/1A adapter

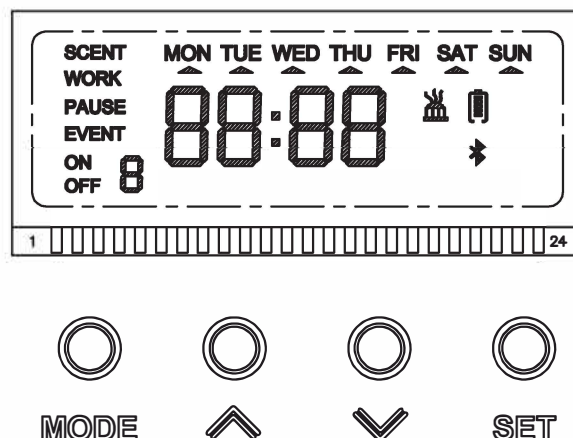

- **Turn on / off:** press and hold the "MODE" button for 5 seconds to turn the unit on or off.
When turned on, the display will show an "on" icon flashing 3 times.
When turned off, the display will show an "off" icon flashing 3 times.
NOTE: The unit will auto-start on after powering on.
- **Local time setting:** long press and hold the "SET" button for five seconds to enter the time setting.
Hour: press the ^/v button to adjust the hour, then press "SET" to confirm and enter the minute setting.

Minute: press the $\wedge \vee$ button to adjust the minute, then press "SET" to confirm and enter the week setting.

Week: press the $\wedge \vee$ button to adjust the days of the week the machine will run, then press "SET" to confirm and finish the setting.

- **Work time and Scent intensity setting:** press the "MODE" button to adjust these settings.

Five working events:

event 1:



- **Work time**

Event on setting:

1. Press the "SET" button to adjust the the hour setting. Press the $\wedge \vee$ buttons to set the hour the unit will start running, then press "SET" to confirm and enter the minute setting.
2. Press the $\wedge \vee$ buttons to set the minute the unit will start running, then press "SET" to confirm and enter the day setting.
3. Press the $\wedge \vee$ button to select the day(s) of the week the machine will run Press the $\wedge \vee$ button to exit the day setting and save your settings.

Event off setting:

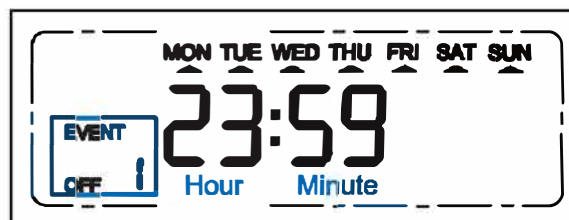

1. Press the "MODE" button to adjust the hour setting. Press the $\wedge \vee$ buttons to set the hour the unit will stop running, then press "SET" to confirm and enter the minute setting.
2. Press the $\wedge \vee$ buttons to adjust the the unit will stop running minute. Press the $\wedge \vee$ button to exit the minute setting and save your settings.

- **Scent intensity setting**

Scent work



1. Press the "MODE" button to enter the scent intensity adjustment. Press the ^/ buttons to adjust how long the machine will release scent. The operating range is 5 to 30 seconds (the default is 10 seconds.)
 2. Press the "MODE" button to enter the scent intensity **pause time** adjustment. Press the ^/ buttons to adjust the length of break between scent releases. The operating range is 90 to 900 seconds (the default is 120 seconds.)
- **Repeat above steps for event settings 2-4, as needed.**
 - **Reset Operation:**
Press and hold the "Mode + Set" buttons for 5 seconds to reset the device to factory settings. The default factory settings are set to run from 00:00 to 23:59, the scent frequency is 10-120 seconds. The remaining four event settings are 00:00-00:00, and the scent frequency is 10-120 seconds.
 - **Battery power display (if using battery power)**
One cell remaining: battery power remaining 20%
Two cells remaining: battery power remaining 40%
Three cells remaining: battery power remaining 60%
Four cells remaining: battery power remaining 80%
Five cells remaining: battery power remaining 100%

When the battery power is lower than 5%, the device will stop working.

CLEANING INSTRUCTIONS

The machine needs to be cleaned under the following circumstances:

1. You're about to change to another kind of essential oil.
2. The atomization volume goes weak.
3. Hasn't been used in a long time.

Cleaning steps:

1. Turn off the power.
2. Unscrew the lower cover and take out the oil bottle.
3. Find a larger container and fill with isopropyl alcohol. Then soak the oil bottle for 5-10 minutes.
4. Place in a well-ventilated area to air dry.

TROUBLESHOOTING

Symptom	Possible Causes	Approach
The indicator does not light up and the diffuser cannot be started	No power	Reconnect the power
There is no mist produced	The oil tank has too little oil.	Add essential oil to the tank
	The machine is in the standby period	Normal, wait for the standby period to end (Default: 120 seconds)
Machine works but no scent or scent is weak	The nozzle is blocked.	Contact AIRTHEREAL for support
	The pipette of the oil bottle fell off.	Reconnect the pipette.
	The atomizer is blocked.	Clean the atomizer
	There are impurities in the essential oil.	Replace with pure essential oil.
Oil overflow	Check whether the oil bottle is loose	Please install it correctly
	Check whether the gasket of the atomizer head is damaged	Contact AIRTHEREAL for support
	Did not keep the machine vertical	Please keep the machine vertical
Abnormal Noises	Internal structure is damaged	Contact AIRTHEREAL for support
If the above methods cannot be improved, please consult the customer service hotline for assistance		

FCC STATEMENT

This device complies with Part 15 of the FCC Rules. Operation is subject to the following two conditions:

1. This device may not cause harmful interference.
2. This device must accept any interference received, including interference that may cause undesired operation.

Any changes or modifications not expressly approved by the party responsible for compliance could void the user's authority to operate this equipment.

This equipment has been tested and found to comply with the limits for a Class B digital device, pursuant to Part 15 of the FCC Rules. These limits are designed to provide reasonable protection against harmful interference in a residential installation. This equipment generates, uses and can radiate radio frequency energy and, if not installed and used in accordance with the instructions, may cause harmful interference to radio communications. However, there is no guarantee that interference will not occur in a particular installation. If this equipment does cause harmful interference to radio or television reception, which can be determined by turning the equipment off and on, the user is encouraged to try to correct the interference by one of the following measures:

- Reorient or relocate the receiving antenna.
- Connect the equipment into an outlet on a circuit different from that to which the receiver is connected.
- Increase the separation between the equipment and receiver.
- Consult the dealer or an experienced radio/TV technician for help.

FCC RADIATION EXPOSURE STATEMENT

This equipment complies with FCC radiation exposure limits set forth for an uncontrolled environment. End users must follow the specific operating instructions for satisfying RF exposure compliance. To maintain compliance with FCC RF exposure compliance requirements, please follow operation instructions as documented in this manual. This transmitter must not be co located or operating in conjunction with any other antenna or transmitter. This equipment should be installed and operated with a minimum distance of 20 cm between the radiator and your body. The availability of some specific channels and/or operational frequency bands are country dependent and are firmware programmed at the factory to match the intended destination. The firmware setting is not accessible by the end user.

LIMITED WARRANTY

We provide a 1-year warranty. For more information please visit:

www.airthereal.com/warranty

- **What's covered?**

Defects due to faulty materials and/or workmanship of the product.

- **What's not covered?**

1. Damage caused by the owner when attempting to fix or alter the product by himself or herself.
2. Damage caused by misuse, abuse, neglect, alterations, or unauthorized repair.
3. Natural depreciation.

- **Warranty Period**

Warranty becomes effective from the date of original purchase and will last for **1 year**.

- **Who's covered?**

This limited warranty is only effective for the original purchaser. It is non-transferable.

- **How to request warranty services?**

To obtain the benefit of this warranty, please email support@airthereal.com.

Our customer service team will address your issue as soon as possible!

ATTRIBUTIONS

Apple App Store is a trademark of Apple Inc.

Google, Android, and Google Play are trademarks of Google LLC.

Wi-Fi® is a registered trademark of Wi-Fi Alliance®.

Amazon, Alexa and all related logos are trademarks of Amazon.com, Inc. or its affiliates.

iOS is a registered trademark of Cisco Systems, Inc. and/or its affiliates in the United States and certain other countries.

The Bluetooth® word mark and logos are registered trademarks owned by Bluetooth SIG, Inc. and any use of such marks by Arovast Corporation is under license.

Always here to help you
www.airthereal.com



WARNING Cancer and Reproductive Harm
www.p65warnings.ca.gov

Produced for: West Ryder Technology LLC
2330 Paseo Del Prado STE C304
Las Vegas, NV 89102

Made in China

V 202312

FOR THE AIR WE CARE