

正面

Certificate of Conformity

Item name: _____
Model: _____
Inspection: _____
Date: _____



Wireless MIC Instructions

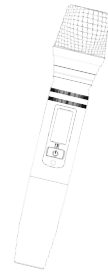

1-4

1-1

设计制作	Lisa
尺寸	80×100mm
折叠方式	双折页
材质	80g哑粉纸
制作/调整日期	2023/7/26

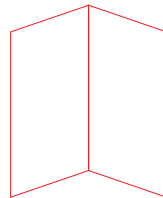

背面

Wireless Receiver Board Parameters

Product Size:	88*24 mm
Working Voltage:	5V
Working Current:	190mA
Receiving Sensitivity:	-94dbm
Receiving Frequency:	580 -599MHZ
Delay Time:	<5MS
Audio Output:	100mV (Wireless MIC Input
	Signal 30mV input)

Wireless MIC Parameters

Product Size:	230*48 mm
Working Voltage:	3V (AA battery)
Working Current:	150mA
Transmitting Power Degree:	10dbm
Communication Frequency:	580 -599MHZ
Pickup Method:	One-way Moving Coil
Sensitivity:	-42±3dB (at 1KHz)
Frequency Response Range:	70Hz - 14KHz
Signal-to-noise Ratio:	≥ 75dB
Distortion Degree:	≤0.3%
Working Temperature:	-10 - 55℃

1-2

Pairing Method

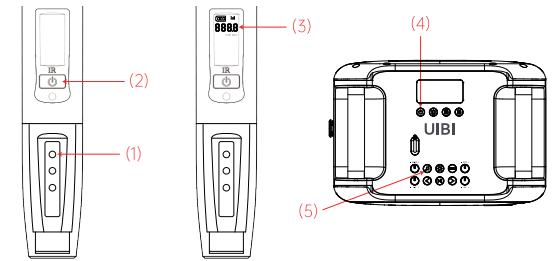

- Step 1: Long press the microphone (1) pairing switch, then press (2) microphone power switch, 2 seconds after the microphone Frequency display flashes (3) after letting go.
- Step 2: Press the (4) key, then press the audio switch (5) to turn on the audio Bluetooth, the host displays the music label, and the microphone pair prepares the speaker for 3-5 seconds The pairing process.
- Step 3: After 5 seconds, press the microphone button (1) to confirm, then the microphone pairing is complete
- Step 4: After the pairing is completed, the voice detection is successful.

There are no additional auxiliary devices when the microphone is used normally

1-3

FCC Statement

This device complies with part 15 of the FCC rules. Operation is subject to the following two conditions: (1) this device may not cause harmful interference, and (2) this device must accept any interference received, including interference that may cause undesired operation.

Changes or modifications not expressly approved by the party responsible for compliance could void the user's authority to operate the equipment.

NOTE: This equipment has been tested and found to comply with the limits for a Class B digital device, pursuant to part 15 of the FCC Rules. These limits are designed to provide reasonable protection against harmful interference in a residential installation. This equipment generates uses and can radiate radio frequency energy and, if not installed and used in accordance with the instructions, may cause harmful interference to radio communications. However, there is no guarantee that interference will not occur in a particular installation. If this equipment does cause harmful interference to radio or television reception, which can be determined by turning the equipment off and on, the user is encouraged to try to correct the interference by one or more of the following measures:

- Reorient or relocate the receiving antenna.
- Increase the separation between the equipment and receiver.
- Connect the equipment into an outlet on a circuit different from that to which the receiver is connected.
- Consult the dealer or an experienced radio/TV technician for help.

The device has been evaluated to meet general RF exposure requirement. The device can be used in portable exposure condition without restriction.