

Note:

1. After turning off, the water outlet component enters standby mode. If there is no operation within 30 minutes, the water outlet component will automatically turn off. If the user want to use it again, the water outlet component needs to be taken out then place it into the child seat socket again to wake up its working state.
2. If the battery level is low, when the water outlet component is placed into the child seat socket to wake up, the water outlet component will beep three times, and the battery should be replaced in a timely manner to avoid affecting use.
(This step is performed anyways when the user fills the water bottle with water and connects it with the water outlet component.)



Model:A100

Product name: Child Bidet Seat

Operation Frequency: 433.92MHz

Max Output Power: -29.67 dBm EIRP

Caution: The user is cautioned that changes or modifications not expressly approved by the party responsible for compliance could void the user's authority to operate the equipment. This device contains licence-exempt transmitter(s)/receiver(s) that comply with Innovation, Science and Economic Development Canada's licence-exempt RSS(s) and Part 15 of the FCC Rules. Operation is subject to the following two conditions:

- (1) This device may not cause interference.
- (2) This device must accept any interference, including interference that may cause undesired operation of the device.

L' émetteur/récepteur exempt de licence contenu dans le présent appareil est conforme aux CNR d' Innovation, Sciences et Développement économique Canada applicables aux appareils radio exempts de licence. L' exploitation est autorisée aux deux conditions suivantes :

- (1) L' appareil ne doit pas produire de brouillage;
- (2) L' appareil doit accepter tout brouillage radioélectrique subi, même si le brouillage est susceptible d' en compromettre le fonctionnement.

NOTE: This equipment has been tested and found to comply with the limits for a Class B digital device, pursuant to Part 15 of the FCC Rules. These limits are designed to provide reasonable protection against harmful interference in a residential installation. This equipment generates, uses and can radiate radio frequency energy and, if not installed and used in accordance with the instructions, may cause harmful interference to radio communications. However, there is no guarantee that interference will not occur in a particular installation.

If this equipment does cause harmful interference to radio or television reception, which can be determined by turning the equipment off and on, the user is encouraged to try to correct the interference by one or more of the following measures:

- Reorient or relocate the receiving antenna.
- Increase the separation between the equipment and receiver.
- Connect the equipment into an outlet on a circuit different from that to which the receiver is connected.
- Consult the dealer or an experienced radio/TV technician for help.

FCC& IC Radiation Exposure Statement:

This equipment complies with FCC and Canada radiation exposure limits set forth for an uncontrolled environment.

This transmitter must not be co-located or operating in conjunction with any other antenna or transmitter.

Déclaration d' IC sur l' exposition aux radiations:

Cet équipement est conforme aux limites d' exposition aux radiations définies par le Canada pour des environnements non contrôlés. Cet émetteur ne doit pas être installé au même endroit ni utilisé avec une autre antenne ou un autre émetteur.

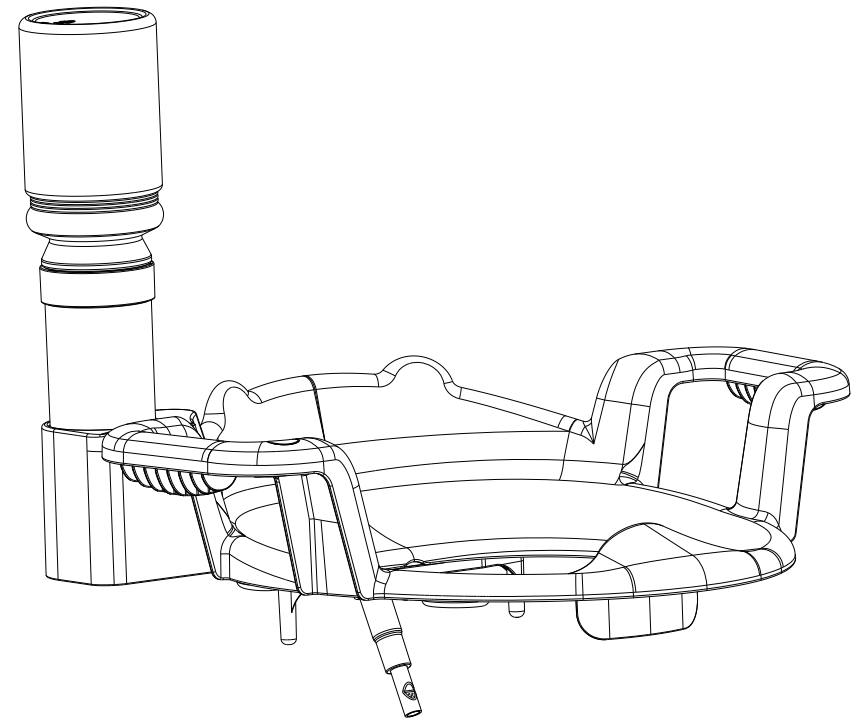

User Manual

A100 Child Bidet Seat

1.Product component diagram

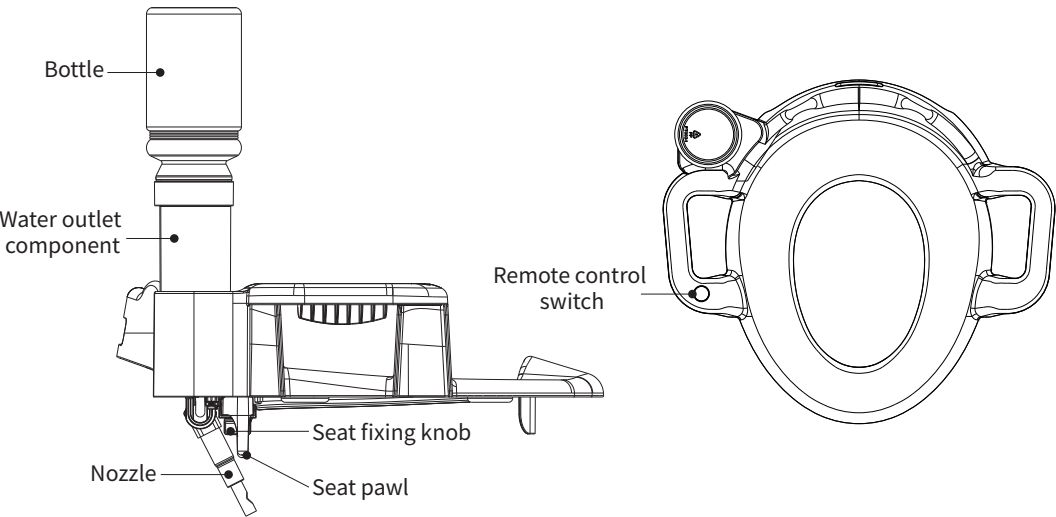

2.Pairing instructions

Loosen the battery box knob, insert 4pcs AAA batteries upwards according to the positive and negative pole markings inside the battery box. After tightening the battery box knob, press and hold the wake up button for 3 seconds within 20 seconds, and then press the remote control switch on the child seat. If the water outlet component starts working, it is considered a successful pairing.

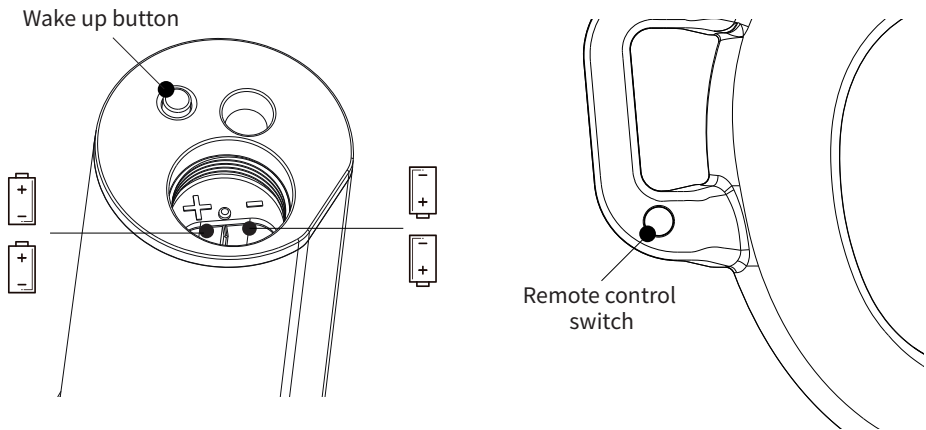

Note: This step is performed anyways when the user fills the water bottle with water and connects it with the water outlet component.

3.Product Installation Instructions

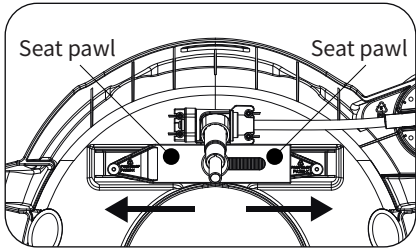

After loosening the seat fixing knob at the bottom of the child bidet seat, adjust both the upper and lower seat pawl according to the inner diameter distance of the toilet, tighten the seat fixing knob and place the child bidet seat to ensure stable installation on the toilet cover.

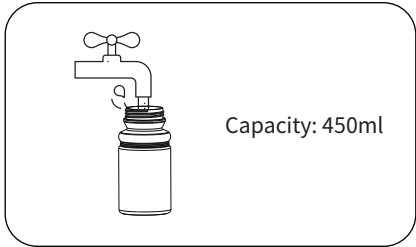

Remove the water bottle and collect the water.

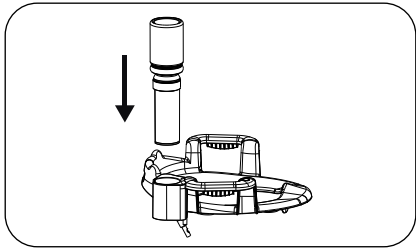

Slide the assembly of the water outlet component and bottle to to the holder as shown on the image. Ensure the apparatus is inserted fully. This will ensure the wake up button is pressed to enable pairing.

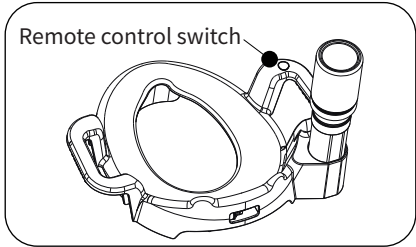

Press the remote control switch on the left handle of the child seat, and the water outlet component is in first gear power output, press again to output at second power, and press the third time to turn off. If the water outlet does not turn off, the water outlet component will automatically stop after approximately 50 seconds work.

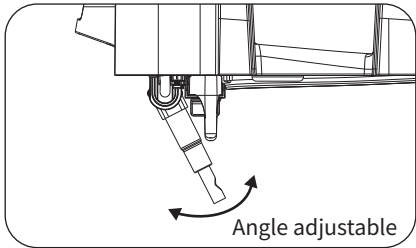

The nozzle can be adjusted in angle by manual according to actual usage.