

Product guidelines

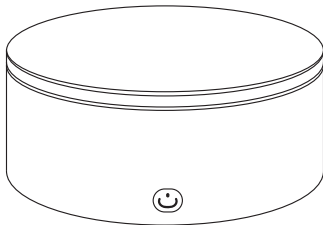

Thermal printer

Packing list



Thermal label printer



USB cable

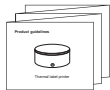

Quick Start Guide

Product information

Name: Thermal label printer

Connection: Bluetooth

Print type: Thermal print

Battery capacity: 3.7 V/1000 mAh

Paper bin capacity: 15 * ϕ 45mm

Product size: 81.3 mm in diameter and 37.3 mm in height

Paper cutting method: Manual tearing paper

Support consumables: continuous/gap paper (gap distance 10mm)

Model: HP3

Print accuracy: 203DPI

Charging interface: Type-c

Charging instructions

- 5V=1A input charge, it is recommended to use a mobile phone charger for charging;
- Recommended after the first use after the purchase please charge first;
- Long non-use interval of 3 months to charge once, so as to avoid long-term natural loss of lithium batteries can not be charged.
- Recommended charging time: 2 hours

Warning! This product is not sold with power adapter, if consumers use power adapter supply, they should buy supporting use. CCC certification and meet the requirements of the standard power adapter, adapter output specifications should meet: 5V 1A

Visual description

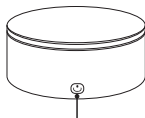

Power Switch Key

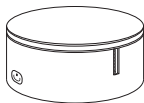

Open the round cover directly

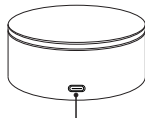

Type-c Charging port

Power indicator status light description

LED	<ul style="list-style-type: none">· Green light often bright: work· Red light often bright: paper shortage, open cover· Red light flashing: low power· Standby: The Green Light is always on.· Power off: The Green Light Flickers slowly; when it is full, the light goes out
------------	--

Paper roll installation

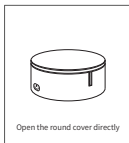

① Open the lid

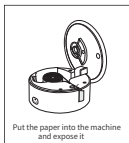

② put the paper

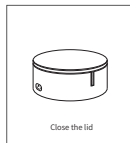

③ Closure

Connect the print operation steps

Support:IOS/Android system

1. Device Boot, long press the boot button, the indicator lights up after release; as follows:

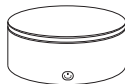

2. Download the APP, in the mobile APP store to search for “XEasyLabel” or scan the following two-dimensional code, download and install XEasyLabel APP, during the installation process, allow the application to obtain the relevant permissions of the mobile phone;



3. Connect the APP connection, and the printer will install the paper to boot. At the same time, the Bluetooth of the mobile phone will be turned on. Enter the APP and click the “+” number in the upper right corner to search for the printer device and click the connection. After the connection is successful, the icon next to the model in the top left corner of the APP's home page lights up;

4. Template printing, according to the printer currently placed label Paper Type (continuous or gap label paper) , in the home page to choose the corresponding type (home, skin care, kitchen...) template, click on the template to modify the text or pattern, and then print;
5. Click on the middle icon at the bottom of the home page to print the new label. According to the label paper in the body, select the corresponding paper type “Continuous” or “Gap” to edit and print. Later, when you need to change the paper type, at the top of the self-edit page, click toggle (as shown) to switch between “Gap paper label” or “Continuous paper label”, and then click the label Specification Option, after determining the type and size of the label loaded into the printer, select “OK”, and then enter the corresponding text or pattern in the text box, and then print;
6. Text settings, select the text input label, that is, the text appears at the edge of the dotted box, and at the bottom of the screen text settings options, you can “Input” text, select text “Font”, and the text of the “Typesetting” operation

Electronic information products toxic and harmful substances declaration

A poisonous substance or element	Plastic casing	Circuit board	Internal cable	Batteries
Aluminum (Pb)	○	×	○	○
Mercury (GG)	○	○	○	○
Cadmium (CD)	○	○	○	○
Hexavalent chromium (Cr6)	○	○	○	○
Polybrominated biphenyls (pbbs)	○	○	○	○
Polybrominated diphenyl ethers (pbdes)	○	○	○	○
<p>This form is prepared in accordance with SJ/11364</p> <p>○: Indicates that the content of the hazardous substance in all homogeneous materials of the component is below the limit specified in GB/T 25125-2011.</p> <p>×: Indicates that the content of the toxic substance in at least one homogeneous material exceeds the limit specified in GB/T 26125 -2011.</p>				

FCC STATEMENT :

This device complies with Part 15 of the FCC Rules. Operation is subject to the following two conditions:

This device may not cause harmful interference, and

This device must accept any interference received, including interference that may cause undesired operation.

Warning:

Changes or modifications not expressly approved by the party responsible for compliance could void the user's authority to operate the equipment.

NOTE:

This equipment has been tested and found to comply with the limits for a Class B digital device, pursuant to Part 15 of the FCC Rules. These limits are designed to provide reasonable protection against harmful interference in a residential installation. This equipment generates uses and can radiate radio frequency energy and, if not installed and used in accordance with the instructions, may cause harmful interference to radio communications. However, there is no guarantee that interference will not occur in a particular installation.

If this equipment does cause harmful interference to radio or television reception, which can be determined by turning the equipment off and on, the user is encouraged to try to correct the interference by one or more of the following measures:

Reorient or relocate the receiving antenna.

Increase the separation between the equipment and receiver.

Connect the equipment into an outlet on a circuit different from that to which the receiver is connected.

Consult the dealer or an experienced radio/TV technician for help.

RF warning statement:

The device has been evaluated to meet general RF exposure requirement. The device can be used in portable exposure condition without restriction.

Product guidelines

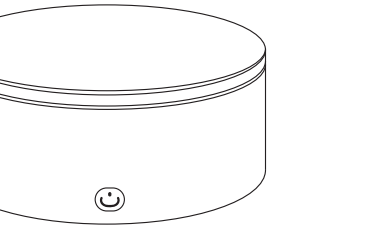

Thermal printer

Packing list



Thermal label printer



USB cable

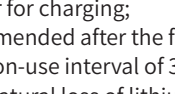

Quick Start Guide

Product information

Name: Thermal label printer

Model: HP3

Connection: Bluetooth

Print accuracy: 203DPI

Print type: Thermal print

Charging interface: Type-c

Battery capacity: 3.7 V/1000 mAh

Paper bin capacity: 15 * φ45mm

Product size: 81.3 mm in diameter and 37.3 mm in height

Paper cutting method: Manual tearing paper

Support consumables: continuous/gap paper (gap distance 10mm)

Charging instructions

- 5V==1A input charge, it is recommended to use a mobile phone charger for charging;
- Recommended after the first use after the purchase please charge first;
- Long non-use interval of 3 months to charge once, so as to avoid long-term natural loss of lithium batteries can not be charged.
- Recommended charging time: 2 hours

Warning! This product is not sold with power adapter, if consumers use power adapter supply, they should buy supporting use. CCC certification and meet the requirements of the standard power adapter, adapter output specifications should meet: 5V 1A

Visual description



Power Switch Key



Open the round cover directly



Type-c Charging port

Power indicator status light description

LED	<ul style="list-style-type: none">· Green light often bright: work· Red light often bright: paper shortage, open cover· Red light flashing: low power· Standby: The Green Light is always on.· Power off: The Green Light Flickers slowly; when it is full, the light goes out
-----	--

Paper roll installation

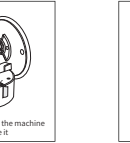

① Open the lid

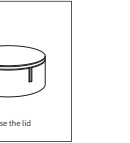

② put the paper



③ Closure

Connect the print operation steps

Support:IOS/Android system

1. Device Boot, long press the boot button, the indicator lights up after release; as follows:

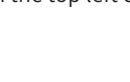

④

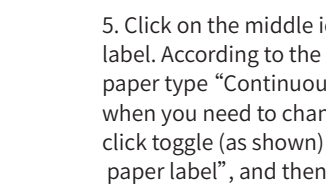

⑤

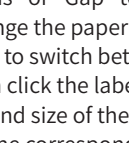

⑥

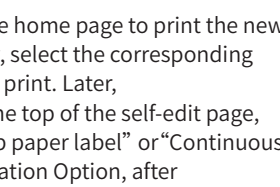

⑦

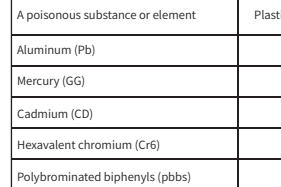

⑧

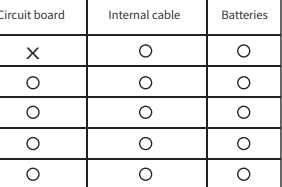

⑨

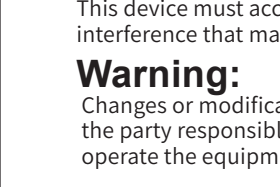

⑩

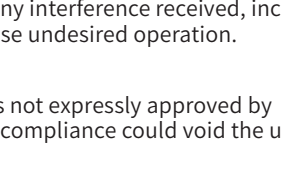

⑪

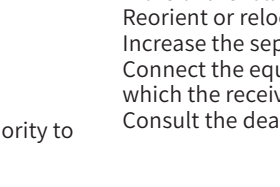

⑫

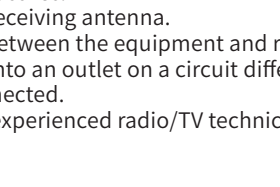

⑬

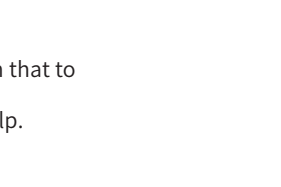

⑭

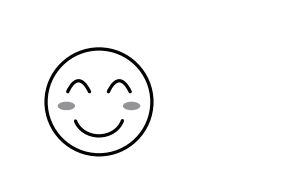

⑮



⑯

Thank you for using it



RF warning statement:

The device has been evaluated to meet general RF exposure requirement. The device can be used in portable exposure condition without restriction.

⑰

FCC STATEMENT :

This device complies with Part 15 of the FCC Rules. Operation is subject to the following two conditions:
This device may not cause harmful interference, and
This device must accept any interference received, including interference that may cause undesired operation.

Warning:

Changes or modifications not expressly approved by the party responsible for compliance could void the user's authority to operate the equipment.

NOTE:

This equipment has been tested and found to comply with the limits for a Class B digital device, pursuant to Part 15 of the FCC Rules. These limits are designed to provide reasonable protection against harmful interference in a residential installation. This equipment generates uses and can radiate radio frequency energy and, if not installed and used in accordance with the instructions, may cause harmful interference to radio communications. However, there is no guarantee that interference will not occur in a particular installation.

⑱

Electronic information products toxic and harmful substances declaration

A poisonous substance or element	Plastic casing	Circuit board	Internal cable	Batteries
Aluminum (Pb)	○	×	○	○
Mercury (GG)	○	○	○	○
Cadmium (CD)	○	○	○	○
Hexavalent chromium (Cr6)	○	○	○	○
Polybrominated biphenyls (pbbs)	○	○	○	○
Polybrominated diphenyl ethers (pbdes)	○	○	○	○

This form is prepared in accordance with SJ/11364

○:Indicates that the content of the hazardous substance in all homogeneous materials of the component is below the limit specified in GB/T 25125-2011.

×:Indicates that the content of the toxic substance in at least one homogeneous material exceeds the limit specified in GB/T 26125 -2011.

⑲