

Where to Buy a WOO 4.0

Go to [Find a Shop](#) to be taken to your best option right away.

Manufacturer: [Woo Sports](#)

Online @ US Shop

United States and Canada

We offer direct shipping right from WOO H.Q in the North America. Buying direct means you have access to our complete catalog of products, including accessories and apparel. To see everything, visit: [WOO U.S. Shop](#).

Online @ EU Shop

Austria, Belgium, Czech Republic, Denmark, France, Germany, Ireland, Italy, Netherlands, Poland, Portugal, Slovakia, Slovenia, Spain, Sweden, United Kingdom, and Russia

We offer direct shipping from our team in the Netherlands. Place an order at: [WOO E.U. Shop](#).

EU importer: XXXXXXXXX Address: XXXXXXXXXXXXXXXX

Online @ AU Shop

Austria and New Zealand

We offer direct shipping to our friends down under via: [WOO A.U. Shop](#).

Local Shops

WOO is carried in Surf, Kite, Wake and Snow shops around the world! [Find your Shop](#)

Manufacture Information

Company : WOO Watersports BV

Address: WOO Watersports BV, Breelaan 5b, 1861GC Bergen, Netherlands

Tel.: +1-617-794-6251

Homepage: www.woosports.com

Supported Devices

WOO Sports App for iOS

Phones and tablets with iOS 7+ including:

- iPhone v4s and later
- iPod Touch v5 and later
- iPad v3 and later

WOO Sports App for Android

Phones and tablets with v4.4 KitKat including:

- Google Nexus 5, Nexus 6, Nexus 7 (2013)
- HTC One Mini+, One Mini 2
- LG L9
- Motorola Moto X (2013), Moto X (2014)
- Samsung Galaxy S4, Galaxy S5, Galaxy S6
- Sony Xperia Z2

What's in the Box

Every WOO package includes:

- [WOO Sensor](#)
- [Charger](#)
- [Mount](#)
- Alcohol swab
- Quick Start Guide

The WOO 4.0 supports Kiteboarding via the WOO Sports App. The App is available now on [iOS](#) and [Android](#).

Creating a WOO Account

To begin using your WOO, start by downloading the app to your phone or tablet.

On iOS, download the [WOO Sports App](#).

On Android, download the [WOO Sports App](#).

Once the app's installed, open it up and click Create A New Account. Input your name, email, and password and you're in! You will receive an email confirming your account, so double check your inbox to verify that the email address is yours.

To complete your profile, click the three lines top left and click your name. Then at the top right of the screen, click Edit to add a profile picture, cover photo, gender, birthday, weight, and homespot.

Also, be sure to head over to Find Friends to start following your buddies on WOO! It's much more fun riding with your friends. Get them in the Game!

Note: With your login you can access all WOO Games ([Kite](#) / [Wake](#) / [Snow](#)) communities, however your homespot, profile picture, profile background, and followers/following will be specific to that community.

Attaching the WOO Mount

Every WOO comes with an adhesive mount that's used to attach the sensor to your board. For maximum accuracy, the sensor needs to be placed in the center of the board with the long edge parallel to the long edge of the board:

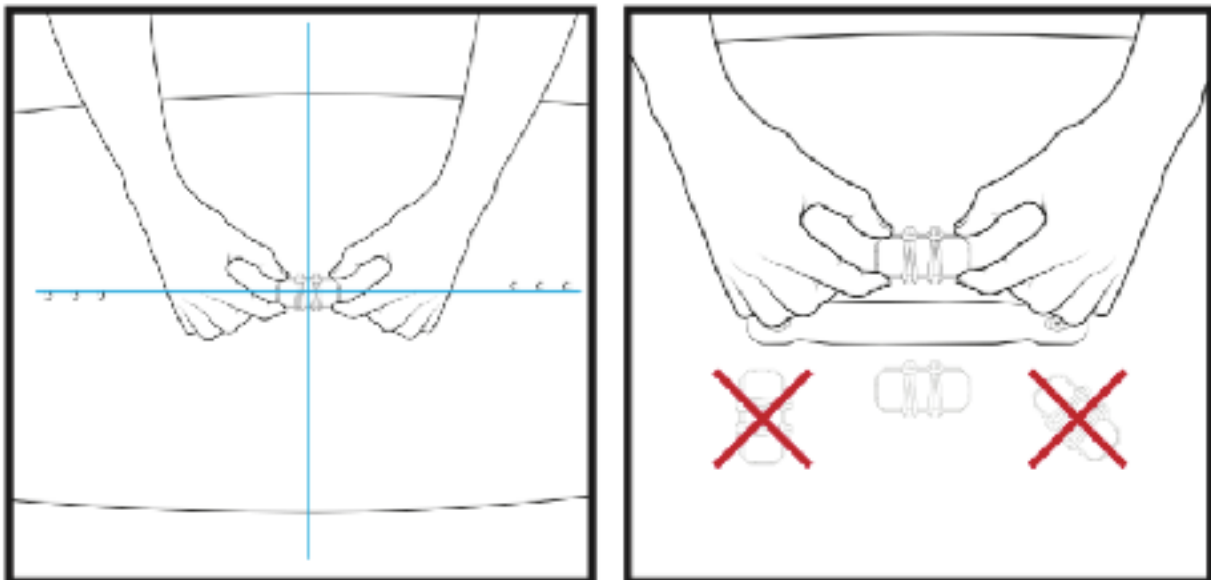

To attach the mount:

1. Start by identifying the center of your board. You'll want to place the mount on the center of your board, running parallel with the rail. If you use a grab handle, place your WOO so you can still use your handle (we recommend just to the side of the handle - still in the "middle" but slightly to one side).
2. Use the alcohol swab provided to clean the center of your board and let the board dry.

3. Remove the backing from the WOO Mount and place on the center of the board. Press firmly to make sure it's solidly attached.
4. For best results, let the mount set overnight before riding.

Recording your First Session

So you're ready to get some airtime with your new WOO - awesome! Here's a quick checklist to run through to ensure you have a perfect session:

1. The Night Before

1. Charge up your WOO with the USB Charger
2. Attach the mount to the center of your board, with the mount running parallel with the long edge
3. Download the App and setup your profile
4. Power on your WOO and pair it in the App. Check that it's all charged up and in the correct mode. To be sure, check the LED-light on the WOO or connect through the [My WOO](#) section of the WOO Sports App to check the mode your WOO is in.

2. Ready to Ride



Make sure to place your WOO with the power button facing your RIGHT foot!

1. Power on the WOO and double check the Mode is correct.
2. Attach the WOO to your board with the power button toward your right foot.
3. Set your WOO to record the session by tapping the power button. The light will change to Red.
4. Send it!!!

To split up your session into multiple, you can stop and restart your WOO at any time by clicking the power button.

To change between Freestyle Kite and Big Air Kite while you're on the water, press and hold the power button for 4 seconds while the WOO is in standby mode (green light). You should see the blink pattern change to confirm the switch was successful.

3. Download your Session

When your done with your session, stop recording by clicking the button on the WOO and make sure the WOO is in standby mode (green light).

1. Get your phone, open the WOO Sports App, and go to the [My WOO](#) section from the side-menu.
2. Connect your phone to your WOO by clicking Add New WOO, then click <your WOO's ID: WOO-XXXX-XXXX>, and finish with a press the button on the WOO to confirm the connection. Also see [My WOO](#) for more documentation.
3. Click the Download Sessions button, and wait for the session to be downloaded from your WOO.
4. Once downloaded, click the Sessions to Save button and select the session you just had.
5. Add the spot, session photo, and description (include #hashtags to create a custom leaderboard!), and upload it to your profile! Once successfully saved, you will be taken to your session details to review your session and see how well you did!

AWESOME! You did recorded and posted your first session on WOO!

F.A.Q.

Here we list the most frequently asked questions. Don't find what you're looking for? Send us an email at support@woosports.com

USING THE WOO

How do I record my session?

To record a session, power on the WOO by pressing and holding the front button. Once powered on, tap the front button again and the WOO will begin recording. To finish a session, tap the front button. Power down by pressing and holding the front button.

How do I download my session?

Within the WOO Kite App, open the My WOO tab from the menu, pair your phone with your WOO, and download the session(s) onto the phone. For each session, set the spot, a description and an optional picture. Save the session by completing the session log and uploading it to your WOO profile.

How Do I Find My WOO ID

Your WOO-ID is engraved and can be found on the bottom of your WOO. Alternatively, connect your WOO to your phone and you will see your WOO-ID under the image of a WOO once connected.

How do you charge the WOO?

Charge the WOO by connecting the sensor to a USB port using the USB adapter and wall USB outlet will do the trick!

How long does the battery last?

The WOO can record sessions for approx. 8 hrs on one charge, so you can just focus on riding!

Where should I place the WOO on my board?

The WOO should be placed directly in the center of your board, running parallel with your rail.

Does WOO work internationally?

Yes, WOO has a database of spots around the globe so whether you are at your home location or traveling you can share your stoke. Found a spot that is missing from our database, [Add a Spot!](#)

PHONE

What phones and OS's does it work with?

The WOO Kite App currently works with iPhones, iPads and iPod Touch's running iOS 7. or iOS 8. that support Bluetooth LE (iPhone 4S or later, iPod Touch 5th gen or later, iPad 3 or later).

Can I connect my WOO & Apple Watch to my iPhone simultaneously?

We recommend unpairing your Apple Watch before you connect your WOO to the iPhone. While it's technically possible to connect multiple accessories via Bluetooth to your iPhone (according to Apple), riders have reported that sessions may not download if your Apple Watch is competing for Bluetooth bandwidth.

Can I use other apps while I'm recording a session?

The WOO does not need the phone to record sessions, so other apps on the phone can be used while riding with the WOO.

Where should my phone be when using the WOO?

You don't need your phone while using WOO, just strap the WOO in, turn it on and go. After the session download the session onto your phone and share them with friends online. But you might want to know which friend you want to beat beforehand...

What happens if my phone dies during my session?

Simply charge your phone when you get home and save your session, no data will be lost.

Can I transfer my profile between iOS and Android?

Yes, the iOS and Android apps use the same database, so your profile (username, sessions, homespot, etc) will be the same regardless of your device or platform. Users can compete against each other regardless of device type.

Please note: if you sign out of your account you will lose all the data from your unsaved sessions. Be sure to save your sessions before signing out of your account and signing in on another device.

DATA

Can I make my data private?

No. The data is shared automatically with the community on the WOO platform.

How can I view my WOO results in real time?

Currently the WOO syncs up after your session only.

OTHER

Can WOO help me find a lost board?

No.

Can I use the WOO on my PC?

Currently the WOO App is only supported on iOS and Android devices. We do have several sweet web features, like [Explore \(Web\)](#) and [Leaderboards \(Web\)](#)!

Will WOO support more sports than kiteboarding, wakeboarding, and snowboarding?

Yes, eventually. Right now the team is working really hard to make the best and most fun possible experience while riding with WOO. Stay tuned to our social media channels to stay up-to-date for updates!

When are you adding GPS?

GPS is not included on the WOO Sensor due to power consumption, but it is something we may incorporate into sensors in the future.

Sensor

Learn more about your new little blue friend: the WOO

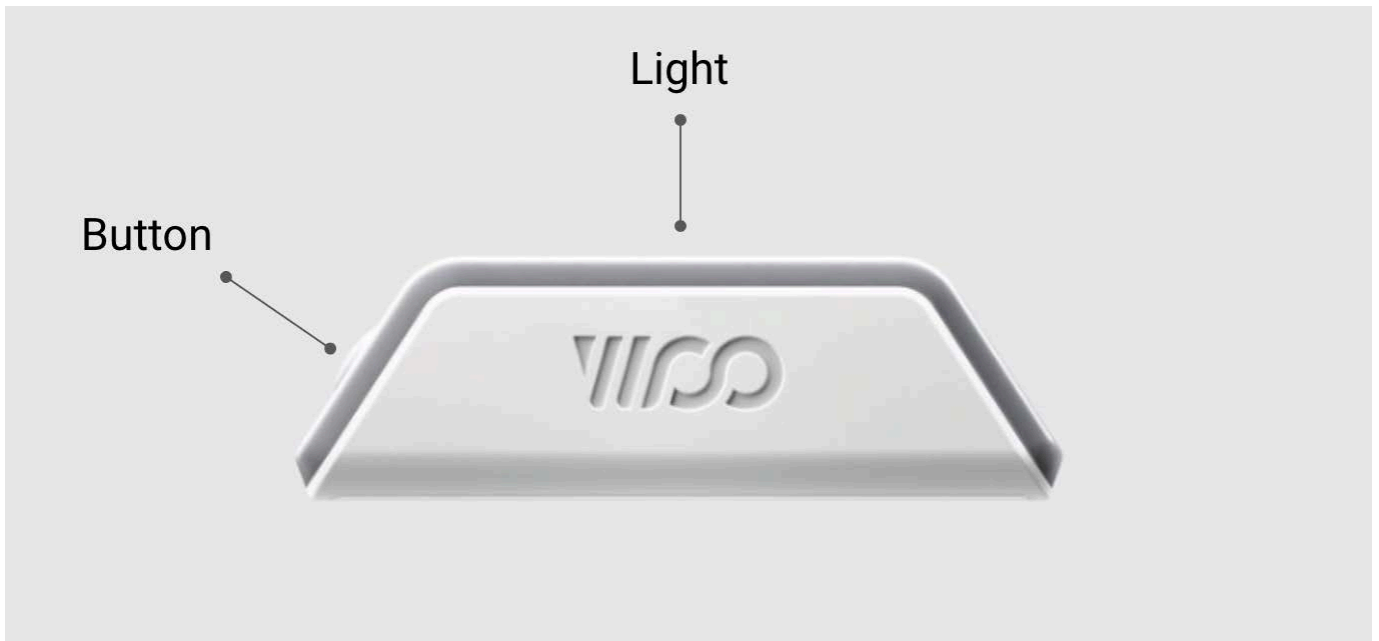

The WOO Sensor (the 'WOO' for short) is the key to recording and playing during your sessions. Compare our blue little nugget to a gaming console, our different modes are the games, you are the controller! Get in the Game!

Note: Be sure your WOO is in the correct Mode before riding, and remember to point the button on the WOO to your right foot (independent of your stance)

BATTERY

Long battery life (8 hours / 1200+ jumps)

9-AXIS MOTION SENSOR

Records relative position to determine jump height, airtime, landing force, trick performed, and landing quality.

BLUETOOTH (BLE)

Wirelessly synchronize WOO to your phone or tablet on the go

SHOCKPROOF

Designed to take a beating and keep recording

WATERPROOF

Completely sealed to protect against damage

CORROSION RESISTANT

The device contacts hold up to repeated contact with water

How does the WOO work?

Power on the WOO by pressing and holding the power button until a green light appears on the top light. This indicates the WOO is in stand-by mode, ready to connect with your phone or begin recording.

The WOO detects jumps by tracking and analyzing your motion. To do this, it fuses data from the 9-axis motion sensor to understand orientation in space and the accelerations acting on it. It is able to categorize your riding into distinct phases of motion: inactivity, riding, jumping, landing or crashing and so forth.

The WOO analyzes acceleration and rotations on the board to detect jumps and calculate their characteristics. As you ride, the WOO stores your jump data, so that when you have a moment not riding, everything is ready to be synced with your phone.

What is the WOO 4.0 sensor?

The WOO is a performance tracker for kiteboarding, wakeboarding, and snowboarding. It calculates jump height, airtime, landing force, and rotation and has four different game modes: [*Kite - Big Air](#), [*Kite - Freestyle](#), [*Wake](#), and [Snow](#) that correspond to whichever activity you choose to do.

The WOO is designed to be placed in the center of your board in order to properly gather information on your jumps and rotations. The sensor measures the vibration in your board and can detect once it has left the water or a kicker. Once in the air, 9-axis rotational sensors study and calculate your movements until you make contact with the water again. Learn more about [Attaching the WOO Mount](#) to ensure you place your sensor in the correct location to gather the most accurate data possible.

How much does it weigh and how big is it?

The sensor and mount together weigh about as much as a AA battery.

Dimensions: 5.4 x 2.2 x 1.7 cm. (2.1 x 0.9 x 0.7 in.)



Your kit comes with a mount that is designed to hold the device securely in place as you boost to the moon and learn new tricks! Make sure you read up on properly [Attaching the WOO Mount](#) to ensure your device stays on the board and records the right data.

What if my mount doesn't look like the ones pictured?

If you have an older blue mount, [contact support immediately](#)! Blue mounts can damage the device and make it more susceptible to being lost out on the water.

Why does my WOO need a mount? Can't I just wear it on my body?

The WOO is designed to start calculating jumps based on your board's vibration. When the board leaves the water, the WOO will start measuring your acceleration and rotation. As a result, the sensor needs accurate vibrational feedback which can only come from being mounted flat on the center of the board. If you put your WOO on the tail of the board, if you mount it on top of something else on your board, or if you wear it on your body it will not produce accurate data and therefore can't be trusted as a tool for competition with other riders around the world!

How do I remove a mount?

Our mounts use 3M VHB tape which is an industrial grade adhesive that is commonly used as a substitute for screws, rivets, welds, and other similar fasteners. As a result it is extremely difficult to remove, but not impossible!

Removing your WOO mount:

1. Take your WOO out of the mount
 2. Apply heat to the top of the mount with a heat gun or hair dryer to soften the adhesive (be careful not to apply too much heat directly to the board since it could damage the topsheet)
 3. Stick a knife in the layer of adhesive between the mount and the board and gradually work it free
 4. This will leave a thin layer of adhesive that can easily be peeled off by hand
- Be careful not to damage your board when using the knife!** Keep it flush against the surface of the board and try to avoid using something with a sharp tip

Charger



How to charge your WOO

Step 1: Take out the 3M VHB tape in the package and tear the protective film on the surface.



Step 2: Place the wireless charger back up on the desktop and attach 3M VHB tape to the bottom of the charger.



Step 3: Tear the protective film on the other side.



Step 4: Paste the exposed 3M VHB tape on the desktop or a certain surface to ensure that it is fixed on the desktop and cannot be moved at will.

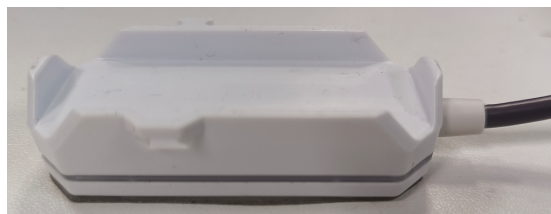

Step 5: Plug your wireless charger into a USB port or a wall outlet with a USB adapter and insert the WOO into the charger. A blue light will start pulsing as your WOO charges and when it is finished the light will blink green until the device shuts off.

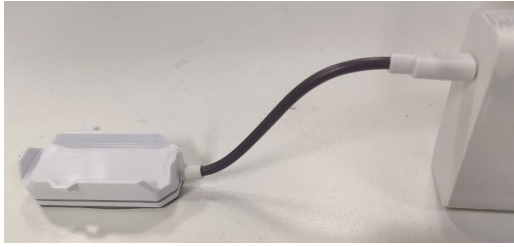

How long does it take to charge?

It takes 60 minutes for your WOO to fully charge and that will give it 24 hours of recording time.

How do I remove a mount?

Our mounts use 3M VHB tape which is an industrial grade adhesive that is commonly used as a substitute for screws, rivets, welds, and other similar fasteners. As a result it is extremely difficult to remove, but not impossible!

Removing your WOO mount:

1. Take your WOO out of the mount
2. Apply heat to the top of the mount with a heat gun or hair dryer to soften the adhesive (be careful not to apply too much heat directly to the board since it could damage the topsheet)
3. Stick a knife in the layer of adhesive between the mount and the board and gradually work it free
4. This will leave a thin layer of adhesive that can easily be peeled off by hand

Be careful not to damage your board when using the knife! Keep it flush against the surface of the board and try to avoid using something with a sharp tip

Kite - Big Air



While recording in Big Air mode, the WOO will measure jump height, airtime, and landing force as well as total accumulated height and airtime for the session.

How do I record in Big Air mode?

Big Air is indicated by a single blink on the WOO's LED in both standby and record mode. If you power on your WOO and it is blinking once, you are ready to record in Big Air mode!

If it is blinking twice, the device is in [Freestyle](#) mode. Hold the power button for 5 seconds while in standby. The light will flash several times and then begin blinking once at regular intervals.

If it is blinking three times, it is in [Wake](#) mode and will need to be switched within the WOO Sports app.

What happens if I do tricks in Big Air mode?

Tricks in Big Air mode will simply be registered as jumps. The device will tell you how high you jumped, how long you were in the air, and how hard you landed but it will not detect or score any tricks you do while recording in that mode.

How do I display Big Air leaderboards?

When the app is in Kite mode, you can always swipe between Big Air and Freestyle in the Activity feed, Global Leaderboards, and within your own profile. Just make sure the top bar is set to whichever mode you want to view, as seen here:

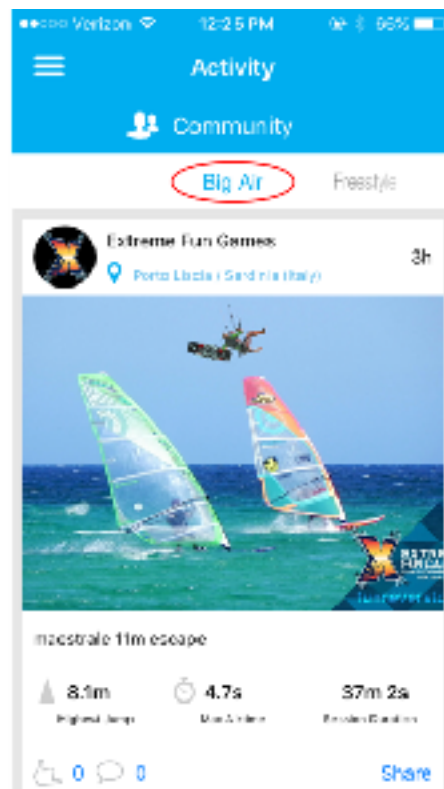

Kite - Freestyle



While in Kite - Freestyle mode, the WOO will detect and score tricks based on rotations, airtime, kite position, and landing quality.

How do I record in Freestyle mode?

In Freestyle mode, the WOO's LED will blink twice rapidly in both standby and record mode. If you power on your WOO and the light consistently blinks twice, you are ready to record in Freestyle mode!

If your device only blinks once, you are in [Big Air](#) mode. Hold the power button on the device for 5 seconds while in standby. The light will blink several times and then begin blinking twice at regular intervals.

If it is blinking three times, it is in [Wake](#) mode and will need to be switched within the WOO Sports app.



Make sure to place your WOO with the power button facing your RIGHT foot!

How do I download a Freestyle session?

If you have recorded both Big Air and Freestyle sessions on the same device, your phone will download whichever session corresponds to the mode the WOO is in at the time. When you turn your device on standby mode to connect to your phone, check the light to see if it is blinking once or twice. If it is blinking twice it will download the Freestyle session and vice versa. Once you have downloaded one you can switch modes by holding the power button for 5 seconds and download the other.

How can I view Freestyle leaderboards?

When you are in the Kite section of the app you can always swipe between Big Air and Freestyle on the Activity Feed, Global Leaderboards, and your own profile as seen below:

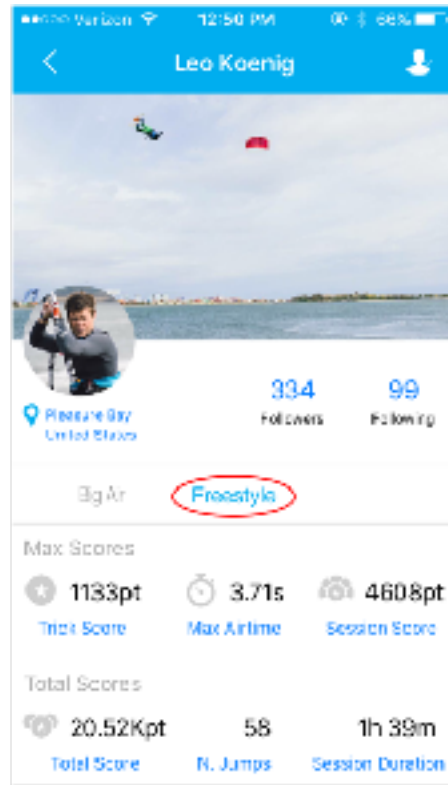

How does the scoring system work?

Note: Kite - Freestyle is designed for riders to do tricks with the kite low (around 45 degrees). The highest scoring tricks will be those that have little assistance from the kite and therefore rely on the rider's ability to load and pop, keep the kite stable, and land smoothly.

Tricks are assigned a score based on a number of factors:

- **Rotations:** Your score will largely depend on the number of rotations you do on 3 different axes and the complexity/difficulty of those movements.
- **Height & Airtime:** The highest scoring jumps will have big height and low airtime. The WOO is looking for jumps that are relatively unassisted by the kite, so jumps with airtime over 3 seconds will be labeled as "Floaty" and will be given 0 points.
- **Kite Position:** Based on your height and airtime, the WOO can determine your kite's position and also see if you have gotten proper slack in your lines while unhooked.
- **Landing Quality:** Your score will partly be based on how well you land and will be assigned a category: Crash, Sketchy, Good, or Stomped. Not only does the device measure the g-force of the landing, but it also assesses how well you ride away from the trick.

Please also check out woosports.com/kite/tricktionary, for a list of tricks the WOO can recognize when the trick is well-performed. The WOO Tricktionary for Kite can also be found in [Settings](#) when in the Kite part of the WOO Sports App.

Why are my tricks not being detected?

The WOO will pick up a trick if it is executed correctly according to the professional riders who have trained the device. We know not everybody will be doing tricks perfectly, so each trick has a field of lenience around it where the device will still register it has been done properly.

It is helpful to think of the WOO as a coach that will score every trick and offer you stats as you progress to the point where you can perfect it with proper form and kite position. Once it labels whichever tricks you do you can confidently show your friends that you're proficient at that trick! Even if tricks aren't detected, the algorithm is designed so that the best freestyle riders will consistently score the highest.

Lastly you should double check that the power button is pointed towards your right foot to ensure proper board orientation!

What happens if I boost in Freestyle mode?

Since Freestyle mode is designed for the kite to be low, jumps with the kite overhead will not be scored well and whichever tricks you do will not be detected. Jumps with an airtime of over 3 seconds will be labeled as "Floaty" and assigned 0 points.

I invented a rad new trick and want it to be added - how do I do that?

If you would like to add a trick or train a particular trick, send us a video of you doing it roughly 10 times in a row. Start recording your session when the video starts and we can match up the data and help train the algorithm to detect it. We are looking for consistency and proper execution, so make sure you can stomp it a bunch of times in a row!

Share your WOOvie to Facebook, YouTube, Instagram, Vimeo and more! Add #WOOvie for a chance to be featured on woosports.com and our social media pages.

FAQ

What do you need to use it?

A WOO, a Mac computer, and a camera or a friend with a camera.

How do you shoot a WOOvie?

WOOvie is designed to be as simple as possible, no syncing your camera before your session or updating time stamps. We want you to go out and have fun on the water.

All you need to do to film a WOOvie is make sure you film the moment you turn your WOO into Record Mode (blinking red). WOOvie does the rest. Feel free to stop and start your camera as many times as needed.

So I have to film putting my WOO into record mode?

Yup, that's all you need to do to be able to sync your WOO session data to your video. Again our goal isn't to add steps on the beach but instead make capturing your session fun again. WOOvie cuts the crap.

How do I film putting my WOO into record if I am using a line mount, DSLR, Drone or other camera?

So you don't love clenching your GoPro in your mouth like the Pros? Neither do we, no worries. Try giving the camera a thumbs up when you put your WOO into record mode, or a thumbs down, really you just need to do something you will recognize when you open the footage up in the WOOvie editor.

Pro Tip: The WOOvie editor likes it when you turn the WOO on in your first video clip. You can cycle through clips to find the right one but our suggestion is to turn the camera on just before you go to turn on your WOO and hit the water.

So what do I do after my session?

Pack up your gear, save your WOO session in the App, compare your WOO results with your buddies, hydrate. Pretty much everything you would normally do.

When you get home just plug your cameras memory card into your computer, open the WOOvie Editor and get started.

Can I have someone film me using an iPhone or other mobile device?

Sure! Same rules apply, make sure they get the moment you start your WOO into record mode and then go out and do your coolest tricks. Remember you can start and stop as many times as you want so keep those clips small to make it easy to get off your phone.

Return Policy

We offer a 30-day money back policy for unused and unopened devices.

Service

Request a Warranty

If you are experiencing an issue with your WOO sensor, please contact support@woosports.com:

1. Email WOO Customer Support at support@woosports.com with a description of the problem you're experiencing. Please make sure to include your WOO account email, WOO ID, and receipt of purchase.
2. We'll help troubleshoot the problem with you. If the WOO sensor needs to be replaced, we'll ask for your sensor to be mailed back to our offices in either Boston or the Netherlands.
3. Upon receipt of the WOO sensor or a confirmation of shipment, we'll set you up a replacement through our online store.

We'll do our best to get you back on the water and logging sessions - thanks for your patience!

Policy

Warranty Details

If a product is found to be defective by WOO Sports, in its sole discretion, WOO Sports' only responsibility shall be limited to repair or replacement of the defective product. WOO Sports will not be responsible for any costs, losses or damages incurred as a result of loss or use of product. This warranty is subject to the following limitations in addition to any imposed by virtue of applicable

WOO does not warrant that the operation of the Product will be uninterrupted or error-free. WOO is not responsible for damage arising from failure to follow instructions relating to the Product's use.

This Limited Warranty does not cover software embedded in the Product and the services provided by WOO to owners of the Product. Refer to the license agreement accompanying the software and the WOO services terms of use for details of your rights with respect to their use.

This Limited Warranty is valid only in the jurisdictions where the Products are sold by WOO itself or through its authorized reseller or agent, and is valid to the extent permitted by the applicable laws of such jurisdictions. Any replacement hardware product will be warranted for the remainder of the original warranty period or thirty (30) days, whichever is longer, or for any additional period of time that may be applicable in your jurisdiction.

Exclusions and Limitations

This Limited Warranty applies only to the Product manufactured by or for WOO that can be identified by the "WOO" trademark, trade name, or logo affixed to it. The Limited Warranty does not apply to any (a) WOO products and services other than the Product, (b) non-WOO hardware product, (c) consumables (such as batteries), or (d) software, even if packaged or sold with the Product or embedded in the Product.

This warranty does not apply to a Product or part of the Product that has been altered or modified (e.g., to alter functionality or capability) by anyone who is not a representative of WOO or if the Product is inserted or installed in a casing not provided by WOO. In addition, this Limited Warranty does not apply: (a) to damage caused by use with non-WOO products; (b) to damage caused by accident, abuse, misuse, flood, fire, earthquake or other external causes; (c) to damage caused by operating the Product outside the permitted or intended uses described by WOO or with improper voltage or power supply; or (d) to damage caused by service (including upgrades and expansions) performed by anyone who is not a representative of WOO. Recovery and reinstallation of software programs and user data are not covered under this Limited Warranty.

No WOO reseller, agent, or employee is authorized to make any modification, extension, or addition to this Limited Warranty. If any term is held to be illegal or unenforceable, the legality or enforceability of the remaining terms shall not be affected or impaired.

EU Compliance statement:

This device has been tested and meets applicable limit for radio frequency (RF) exposure. Exposure value is 12.08V/m.

Hereby, WOO Watersports BV declares that the radio equipment type WOO 4.0 and 4.0 Charger is in compliance with Directive 2014/53/EU.

Technical specifications:

Propert	Units	Value	Description
Bluetooth	MHz	2402-2480	Working Frequency
E.I.R.P	dBm	≤-10	Max
Charging temperature	°C	-20 to 30	The environment temperature of the charger and main device during charging.
Discharge temperature	°C	-20 to 55	The environment temperature of the main device during discharge
Operating current @ LED on green	mA	2	Type
Operating current @ LED on red	mA	5.5	Type
Coil	uH	8	RX2915(3*16.8)-8uH
Ratings	V/A	DC 5V,1A	Wireless charger
Working Frequency	kHz	110-205	Working frequency range of wireless charging
Output power	W	5	Output power of wireless charging
Operating temperature	°C	-20 to 55	Operating temperature of the WOO4.0
Supply Voltage	V	5 +/- 0.5	Supply voltage of the charger
Coil	uH	7	TX3420(3*16.8)-7uH
Dimensions	mm	54x22x17	main device
Weight	grams	17	main device
Waterproof		IP68(3Bar)	main device
Battery	v,mAh	3.7V,120mAh 3.7V,100mAh	Li-Polymer Battery Li-Polymer Battery
Max. Transmitting Power	24.56dBμA/m at 3m		

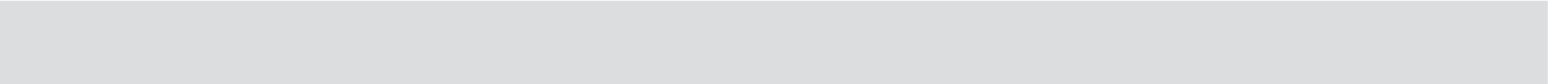

FCC Statements:

This device complies with FCC radiation exposure limits set forth for an uncontrolled environment and it also complies with Part 15 of the FCC RF Rules.

This equipment has been tested and found to comply with the limits for a Class B digital device, pursuant to Part 15 of the FCC Rules. These limits are designed to provide reasonable protection against harmful interference in a residential installation.

This equipment generates, uses and can radiate radio frequency energy. However, there is no guarantee that interference will not occur in a particular installation. If this equipment does cause harmful interference to radio or reception, which can be determined by turning the equipment off and on, the user is encouraged to try to correct the interference by one or more of the following measures:

- Reorient or relocate the receiving antenna.
- Increase the separation between the equipment and receiver.
- Connect the equipment into an outlet on a circuit different from that to which the receiver is connected.
- Consult the dealer or an experienced technician for help.

This device complies with part 15 of the FCC Rules. Operation is subject to the following two conditions:

- 1) This device may not cause harmful interference, and
- 2) This device must accept any interference received, including interference that may cause undesired operation.

MODIFICATION: Any changes or modifications not expressly approved by the grantee of this device could void the user's authority to operate the device.

IC Statements:

-English:

The device meets the exemption from the routine evaluation limits in section 2.5 of RSS 102 and compliance with RSS-102 RF exposure, users can obtain Canadian information on RF exposure and compliance.

CAN ICES-001 (B) / NMB-001 (B)

CAN ICES-003 (B) / NMB-003 (B)

This device contains licence-exempt transmitter(s)/receiver(s) that comply with Innovation, Science and Economic Development Canada's licence-exempt RSS(s). Operation is subject to the following two conditions:

- 1: This device may not cause interference.
- 2: This device must accept any interference, including interference that may cause undesired operation of the device.

-French:

Le dispositif rencontre l'exemption des limites courantes d'évaluation dans la section 2.5 de RSS 102 et la conformité à l'exposition de RSS-102 rf, utilisateurs peut obtenir l'information canadienne sur l'exposition et la conformité de rf.

L'émetteur/récepteur exempt de licence contenu dans le présent appareil est conforme aux CNR d'Innovation, Sciences et Développement économique Canada applicables aux appareils radio exempts de licence. L'exploitation est autorisée aux deux conditions suivantes :

1. L'appareil ne doit pas produire de brouillage;
2. L'appareil doit accepter tout brouillage radioélectrique subi, même si le brouillage est susceptible d'en compromettre le fonctionnement.

Operating temperature of WOO4.0:

The maximum environment temperature of the main device and charger during charging is 30°C; The maximum operating temperature of the main device during discharge is 55°C;

CAUTION:

1. Risk of explosion if the battery is replaced by an incorrect type;
2. Disposal of a battery into fire or a hot oven, or mechanically crushing or cutting of a battery, that can result in an explosion;
3. Leaving a battery in an extremely high temperature surrounding environment that can result in an explosion or the leakage of flammable liquid or gas.
4. A battery subjected to extremely low air pressure that may result in an explosion or the leakage of flammable liquid or gas.

Température de fonctionnement de WOO4.0:

La température ambiante maximale de l'appareil principal et du chargeur pendant la charge est de 30 °C ; La température maximale de fonctionnement de l'appareil principal pendant la décharge est de 55°C ;

PRUDENCE:

1. Risque d'explosion si la batterie est remplacée par un type incorrect ;
2. La mise au rebut d'une batterie dans un feu ou dans un four chaud, ou l'écrasement ou la découpe mécanique d'une batterie, pouvant entraîner une explosion ;
3. Laisser une batterie dans un environnement à température extrêmement élevée pouvant entraîner une explosion ou une fuite de liquide ou de gaz inflammable.
4. Une batterie soumise à une pression d'air extrêmement faible pouvant entraîner une explosion ou une fuite de liquide ou de gaz inflammable.

Warning of charger:

-English

This equipment (4.0 Charger) complies with relevant RF radiation exposure limits set forth for a public/uncontrolled environment. This equipment (4.0 Charger) should be installed and/or operated with a minimum distance as below between the radiator and your body: 15 centimeters.

-French

Cet équipement (4.0 Charger) respecte les limites d'exposition aux rayonnements RF pertinentes établies pour un environnement public/ non contrôlé. Cet équipement (4.0 Charger) doit être installé et/ou utilisé à une distance minimale comme ci-dessous entre le radiateur et votre corps: 15 centimètres.

EU Declaration of Conformity

We WOO Watersports BV

Breelaan 5b, 1861GC Bergen, THE NETHERLANDS

declare under our sole responsibility that the product

Product Name: : WOO 4.0 Sensor

Model name: : Sensor: WOO 4.0, Wireless Charger: 4.0 Charger

Hardware version: Sensor: 4.0, Wireless Charger: Rev A

Software version: Sensor: 40.1.13, Wireless Charger: V1.0.0

Accessories: N/A

comply with the following directives and regulations:

2014/53/EU (The Radio Equipment Directive)

For the evaluation of the compliance with these Directives and Regulations, the following standards/requirements were applied:

Safety Article 3.1(a)	EN 62368-1:2014/A11:2017 EN 62311:2008 EN IEC 62311:2020 EN 62479:2010 EN 50663:2017 EN 50665:2017
EMC Article 3.1(b)	EN 55032:2015/A11:2020 EN 55035:2017/A11:2020 EN 301 489-1 V2.2.3 (2019-11) EN 301 489-3 V2.1.1 (2019-03) EN 301 489-17 V3.2.4 (2020-09)
Radio Article 3.2	EN 303 417 V1.1.1 (2017-09) EN 300 328 V2.2.2 (2019-07)

The conformity assessment procedure as referenced in Article 17 and detailed in Annex III of the Radio equipment Directive has been followed with the involvement of a notified body:

Notified Body: TUV SUD DANMARK ApS NB No.: 2443

certificate No.: DK-RED002805 i01

Responsible for making this declaration is the:

☐ Manufacturer ☐ Authorised representative established within the EU

Person responsible for making this declaration

Print name/Title: Leonard Koenig

2023/9/7
(Date)

(Signature)