

# **G5**

# **Manual**

## **FIVE MODES**

Auto Follow  
Cruise control  
One-Click Recall  
Hand push mode  
Remote & APP control

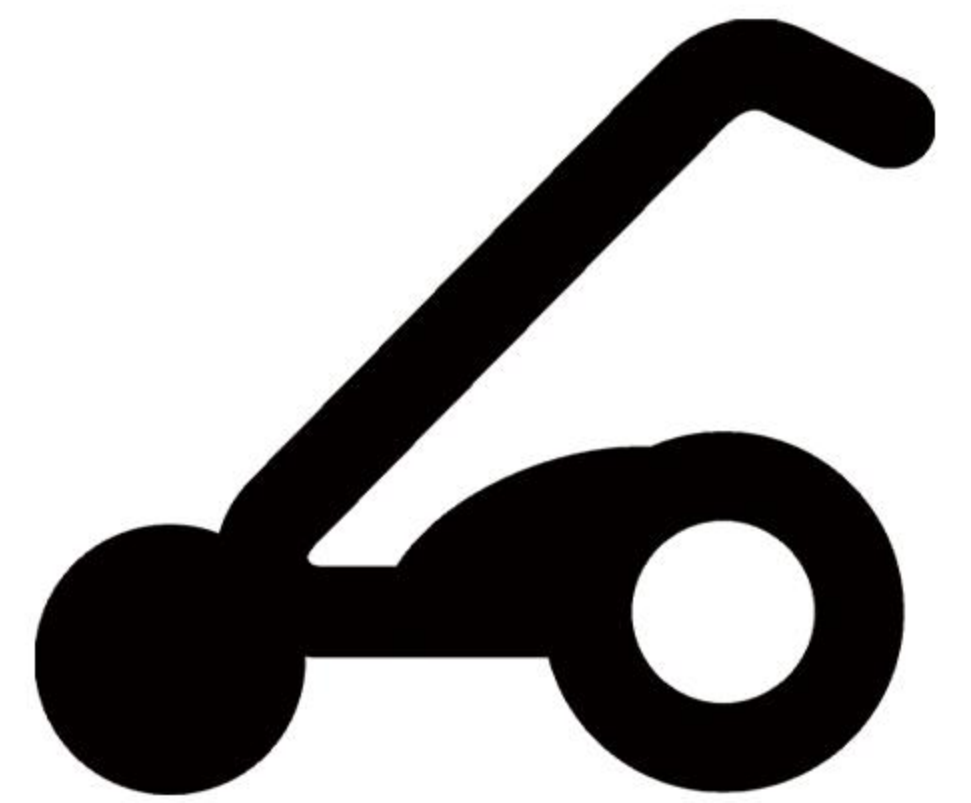
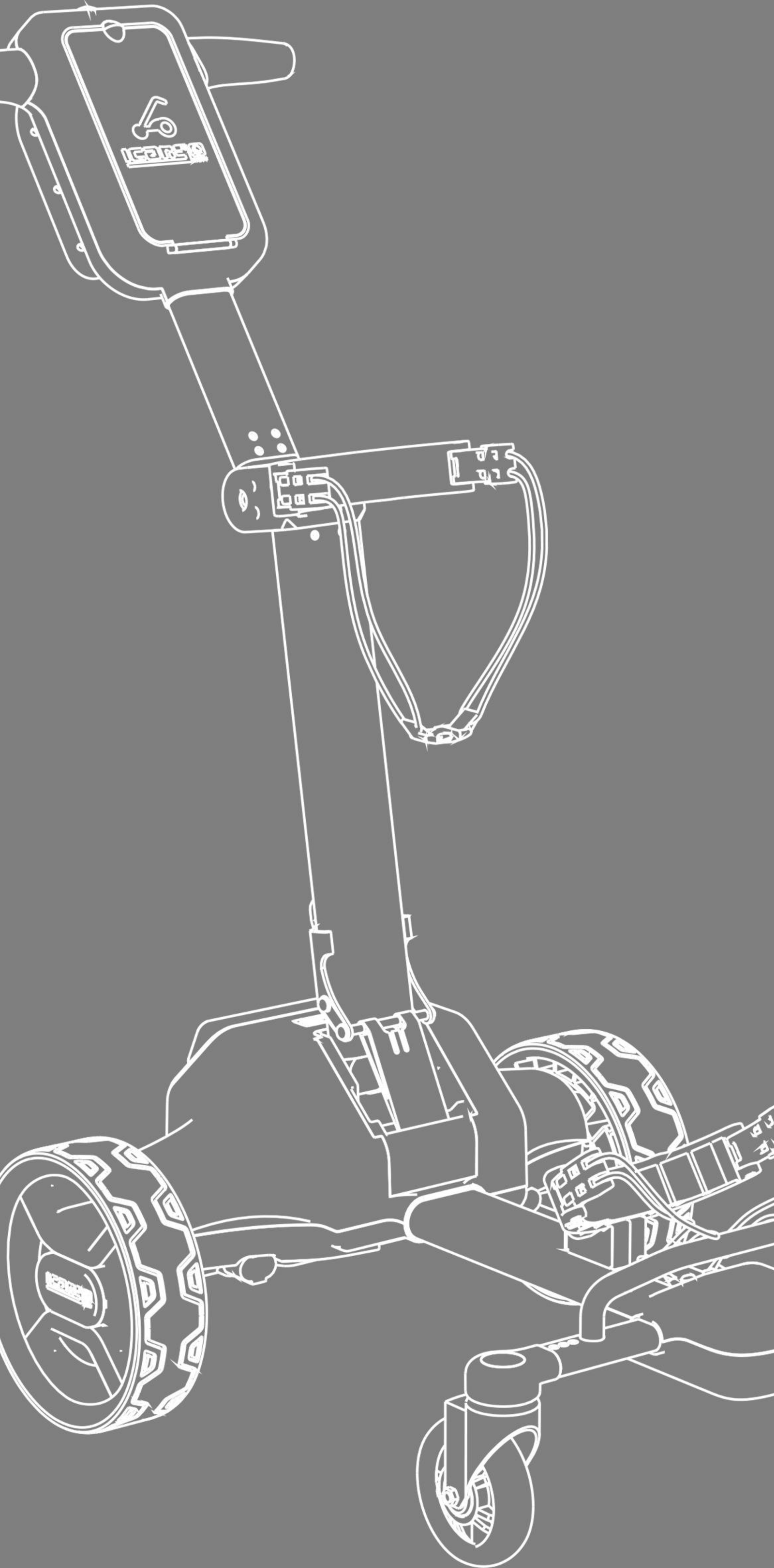

# PACKING LIST

1. Trolley ×1
2. Remote ×1
3. Battery ×1
4. Charger ×1
5. Umbrella Holder ×1
6. Cup Holder ×1
7. Mainwheel ×2
8. Front Universal Wheel ×2
9. Toolkit ×1
10. User Manual ×1



# INSTALLATION

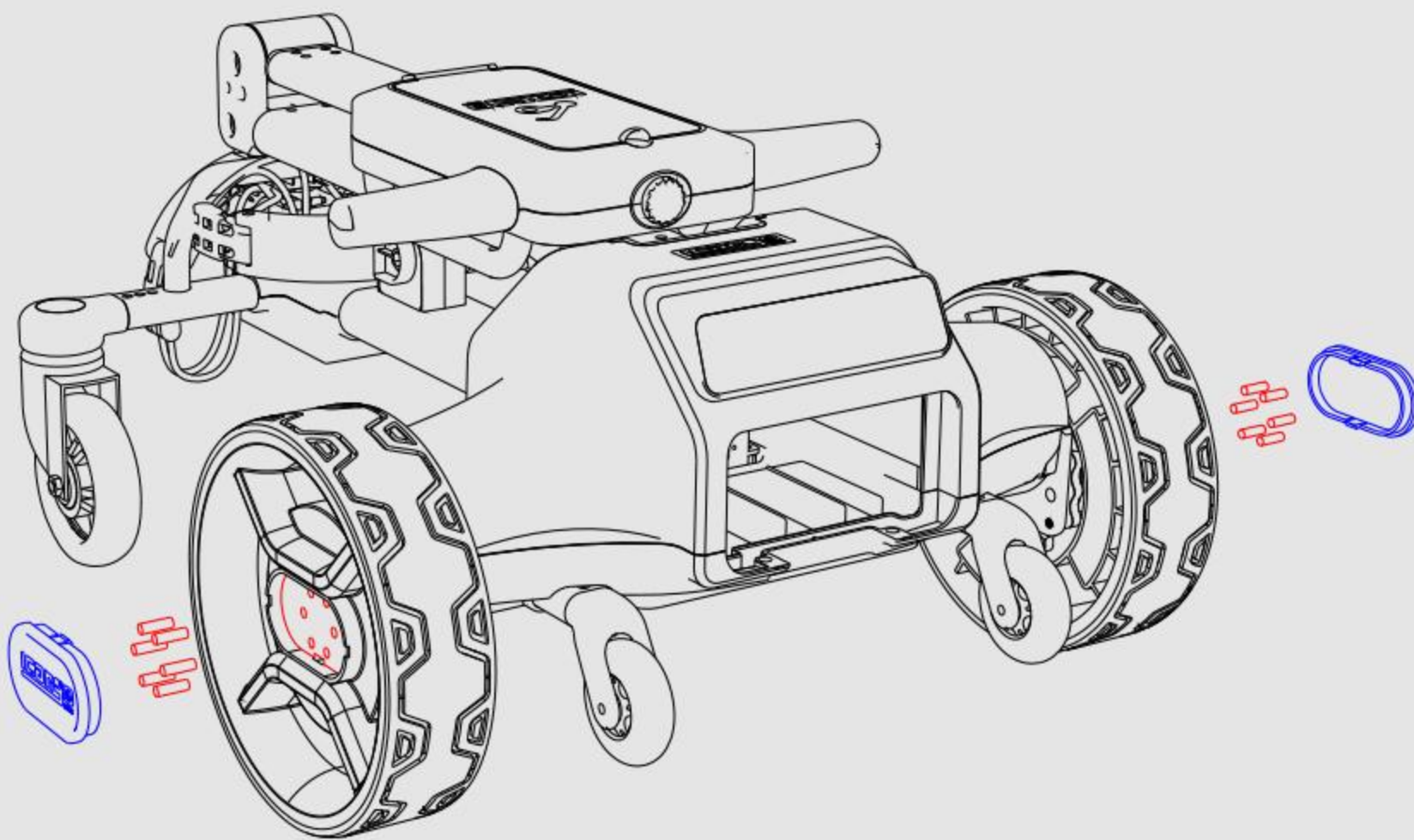

1. Use M6\*12 mm screws to fix main wheels with motors, then put the covers on

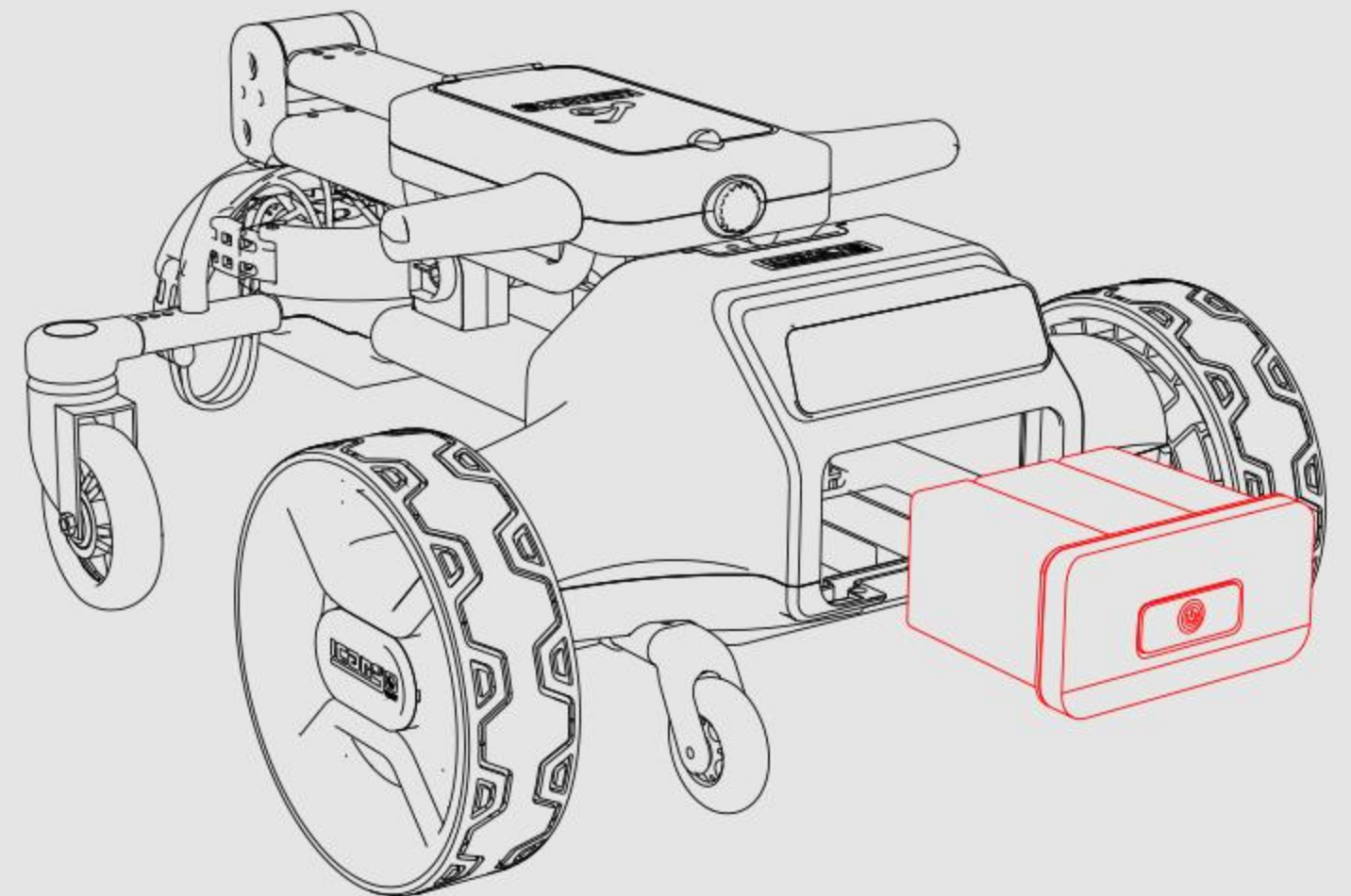

2. Insert the battery into battery housing

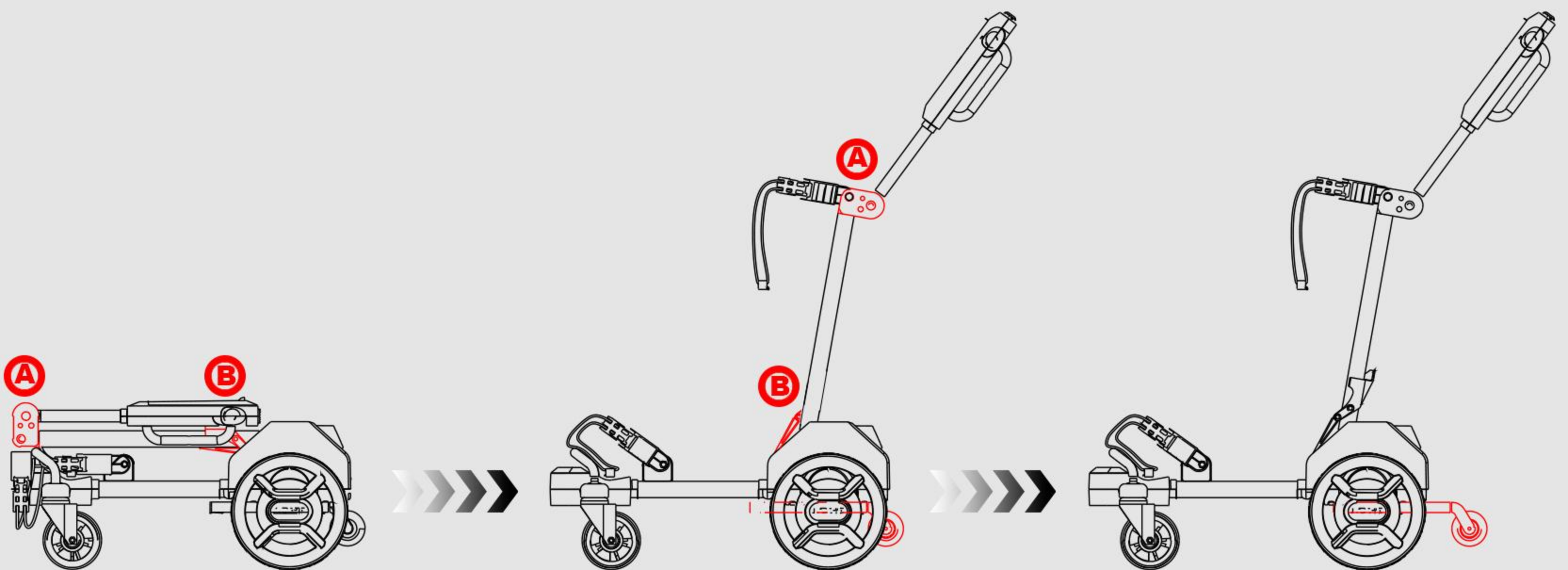

3. Fix A with spacer, and put the handle to a appropriate height, then lock the knob (B)

4. When climbing a slope, turn the rear





# How to use?

After the installation,

2. Turn on the battery switch, when the LED display on, G5 is worked and stay at manual mode

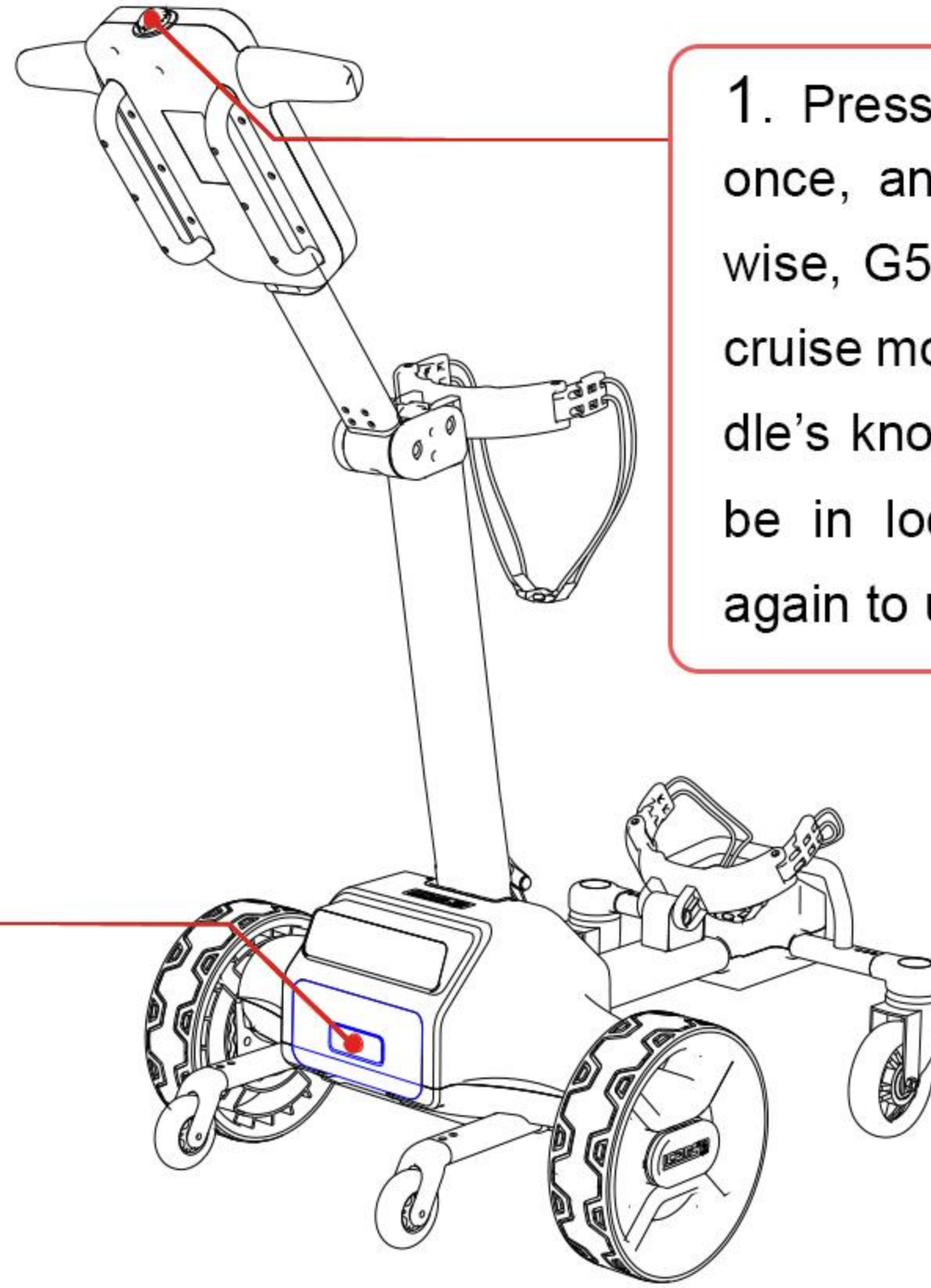
1. Press handle's knob once, and turn it clockwise, G5 will switch into cruise mode ; Press handle's knob twice, G5 will be in lock state, press again to unlock it.



3. Press  , G5 will switch to follow mode; When the trolley is far away from you, this button can also be used as a one-click recall button. Just click once and the trolley will return to your nearby area.

4. Press  , APP will appear the recording page, press again to exit

5. press the remote switch to unlock.

6. Turn on the remote switch, you will hear a “beep” sound, and press the joystick, G5 will switch to remote control mode

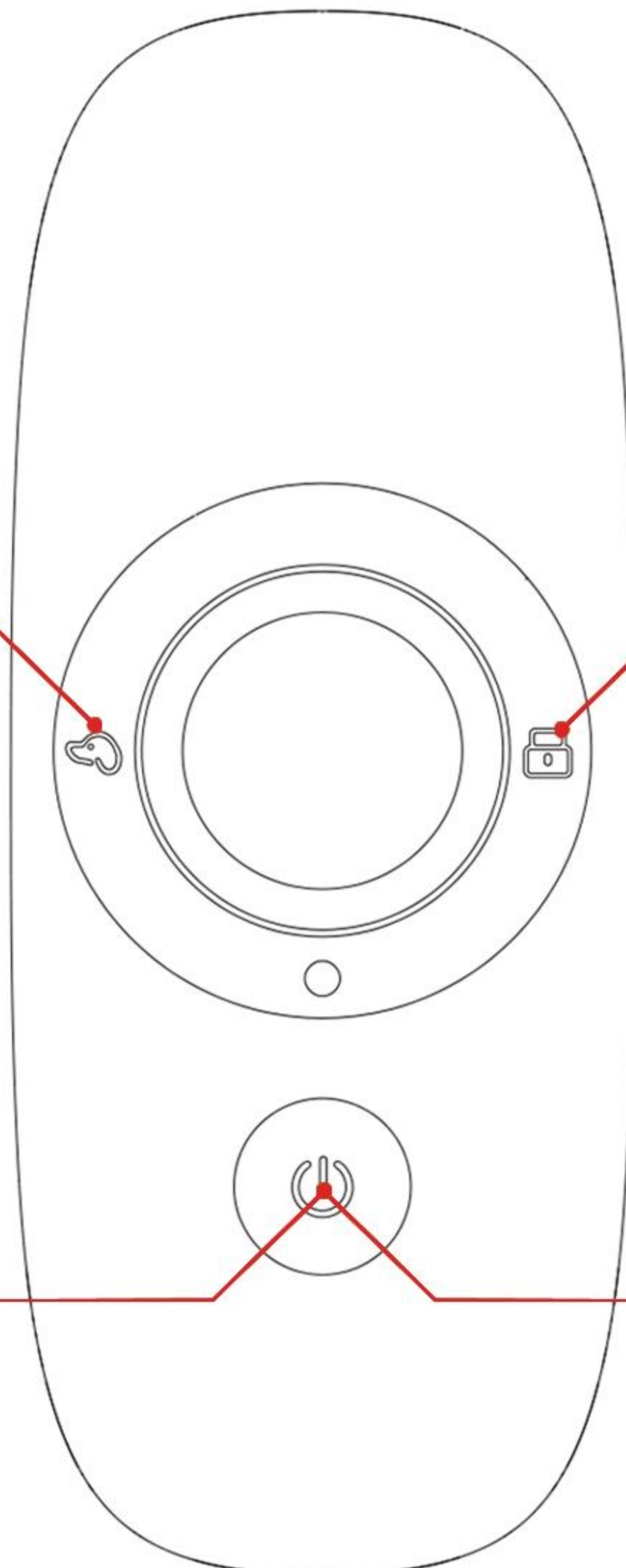



# **FUNCTIONS**

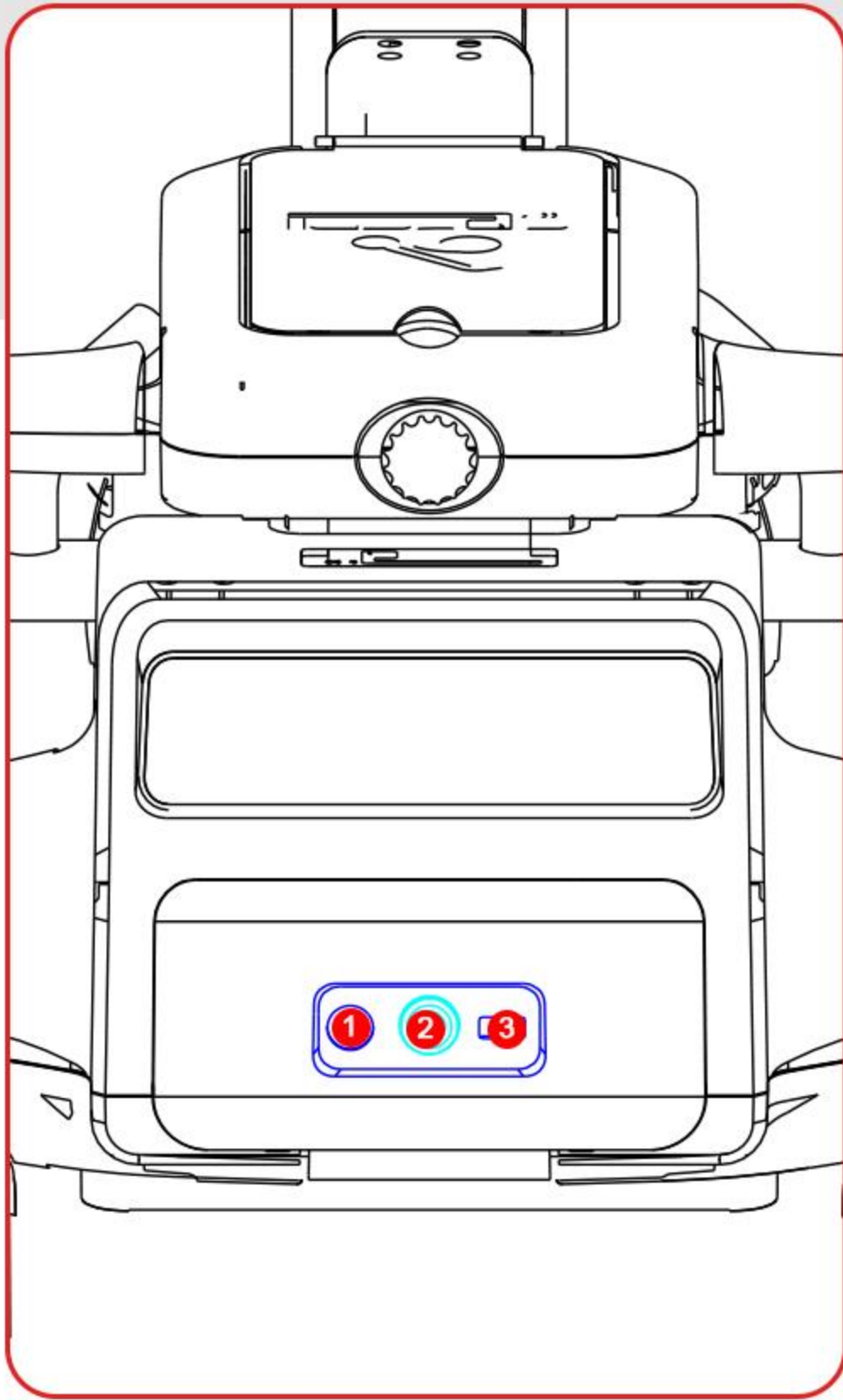

- 1. Battery Charging Port
- 2. Battery Switch
- 3. USB Port

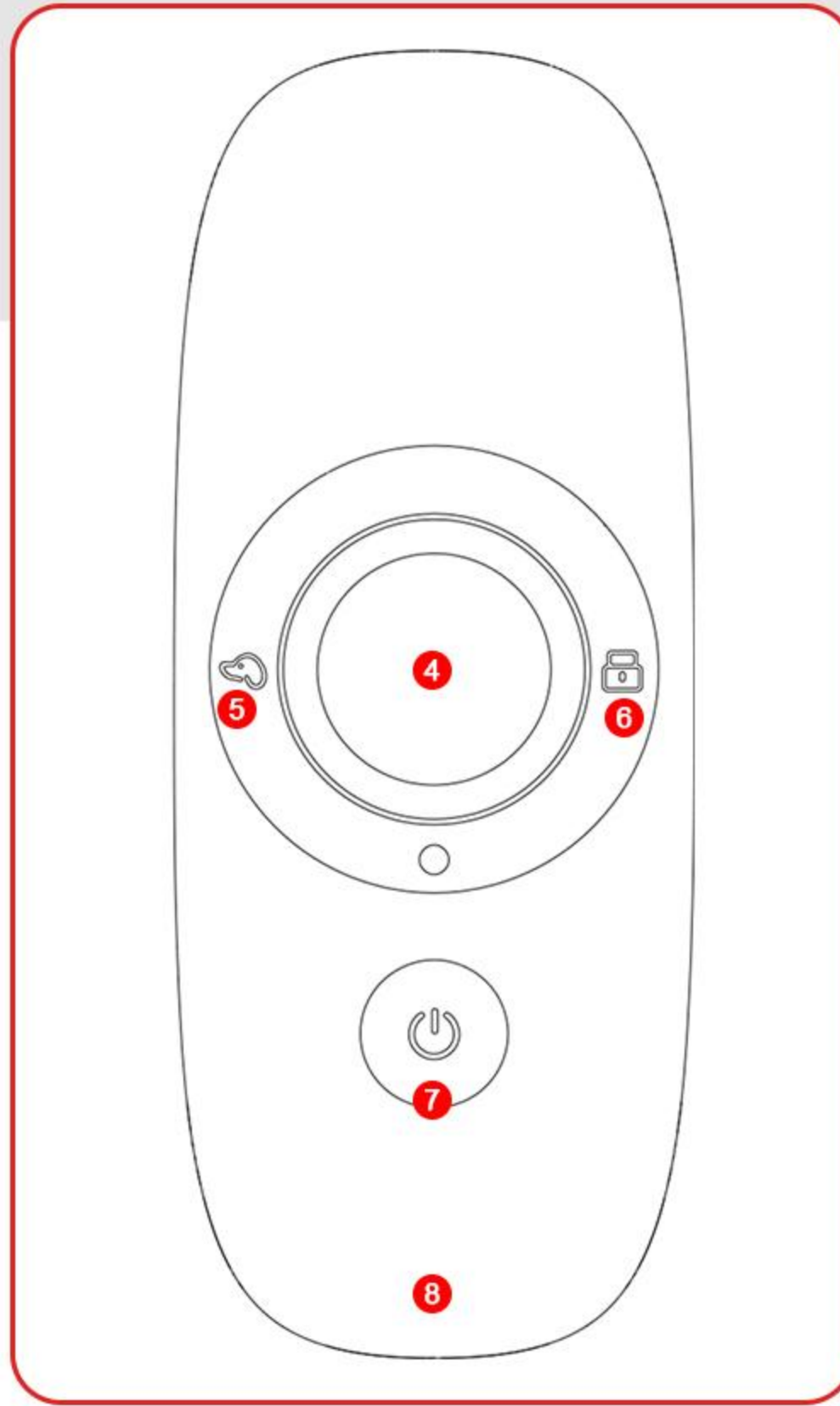

- 4. Joystick
- 5. Follow Me Button
- 6. Recording Button
- 7. Remote Switch
- 8. Remote Charging Port

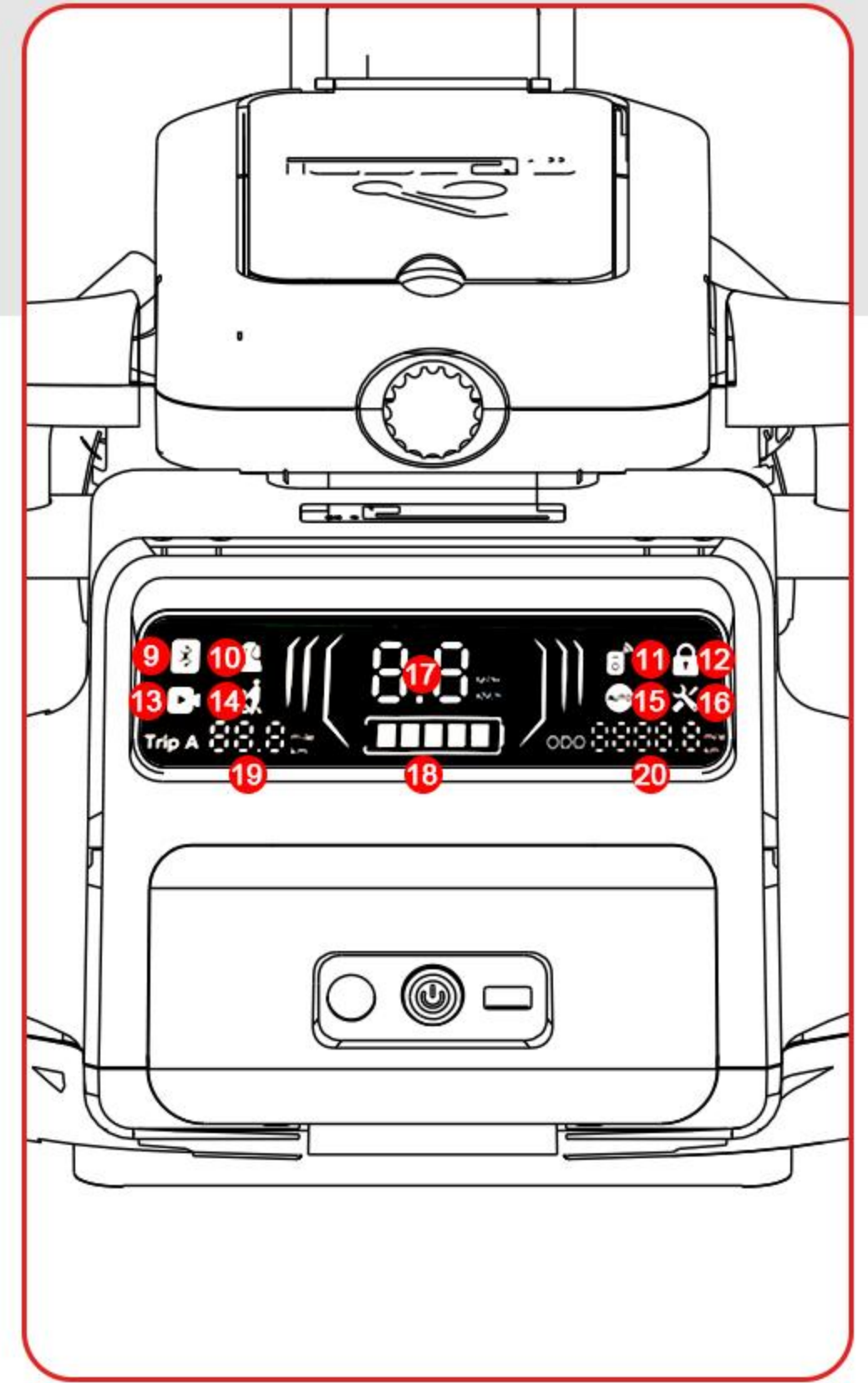

- 9. Bluetooth
- 10. Follow Mode
- 11. Remote Control Mode
- 12. Locking State
- 13. Recording
- 14. Manual Mode
- 15. Cruise Mode
- 16. Fault
- 17. Speed Display
- 18. Battery Display
- 19. Single Mileage
- 20. Total Mileage



# Modes



## Manual:

- a. Under the switch off state;
- b. when G5 is first turned on;
- c. Other non-remote control state.

Notice: Under manual mode, trolley needs to be manually locked on the slope to prevent from rolling away.



## Remote Control Mode:

Turn on battery and remote switch, press the joystick once. If the trolley moved, then it is under remote control mode.

## APP Control Mode:

Open "icango" and connect with bluetooth. Turn to the remote page, you can use APP to control G5 with the joystick.



## One-Click Recall Mode:

When the trolley is far away from you, this button can also be used as a one-touch recall button. Just click once and the trolley will come back to you.



## Follow Me Mode:

Turn on the battery and remote switch, press "🏠", if icon "2" in the LED on, G5 turns to follow me mode. Push the joystick "13" can disable.



## Cruise Mode:

- a. Press the handle's knob once, and turn it clockwise, G5 will turn to cruise mode, spinning again to increase the speed. (7 gears: 1-2-3-4-5-6-7km/h)
  - b. Press the remote joystick twice in a row, G5 will turn to cruise mode under the speed 2km/h, press again to increase the speed to 4km/h and again to 7km/h.
- Note: Press the handle's knob or press the remote switch can disable the cruise mode.



Scan the QR code to download " icango " APP



(Android / Google Play / IOS)

# APP & Setting

Display battery storage data percent

Display of current speed data

Remote Control Pairing and Remote Control Battery Display

Viewing of stored photos

Data Setting Menu

View different data parameters

Video recording possible

A screenshot of the icango app interface on a smartphone. The screen is black with green and red accents. At the top, it shows the status bar with "中国联通 16:34 2.3 4G" and "中国移动 4G (41)". Below the status bar is a back arrow and the text "PlusRobot4542". The main display features a large circular speedometer with "0.0 km/h" in the center. Below the speedometer is a green battery level indicator showing "95%". Below the battery indicator is a button that says "Click here to pair". At the bottom of the screen are five icons: "Video", "Remote control", "Photo", "Information", and "Settings". Red lines connect the callout text to the corresponding elements on the screen: "Display battery storage data percent" points to the battery indicator; "Display of current speed data" points to the speedometer; "Remote Control Pairing and Remote Control Battery Display" points to the "Click here to pair" button; "Viewing of stored photos" points to the "Photo" icon; "Data Setting Menu" points to the "Settings" icon; "View different data parameters" points to the "Information" icon; and "Video recording possible" points to the "Video" icon.

5



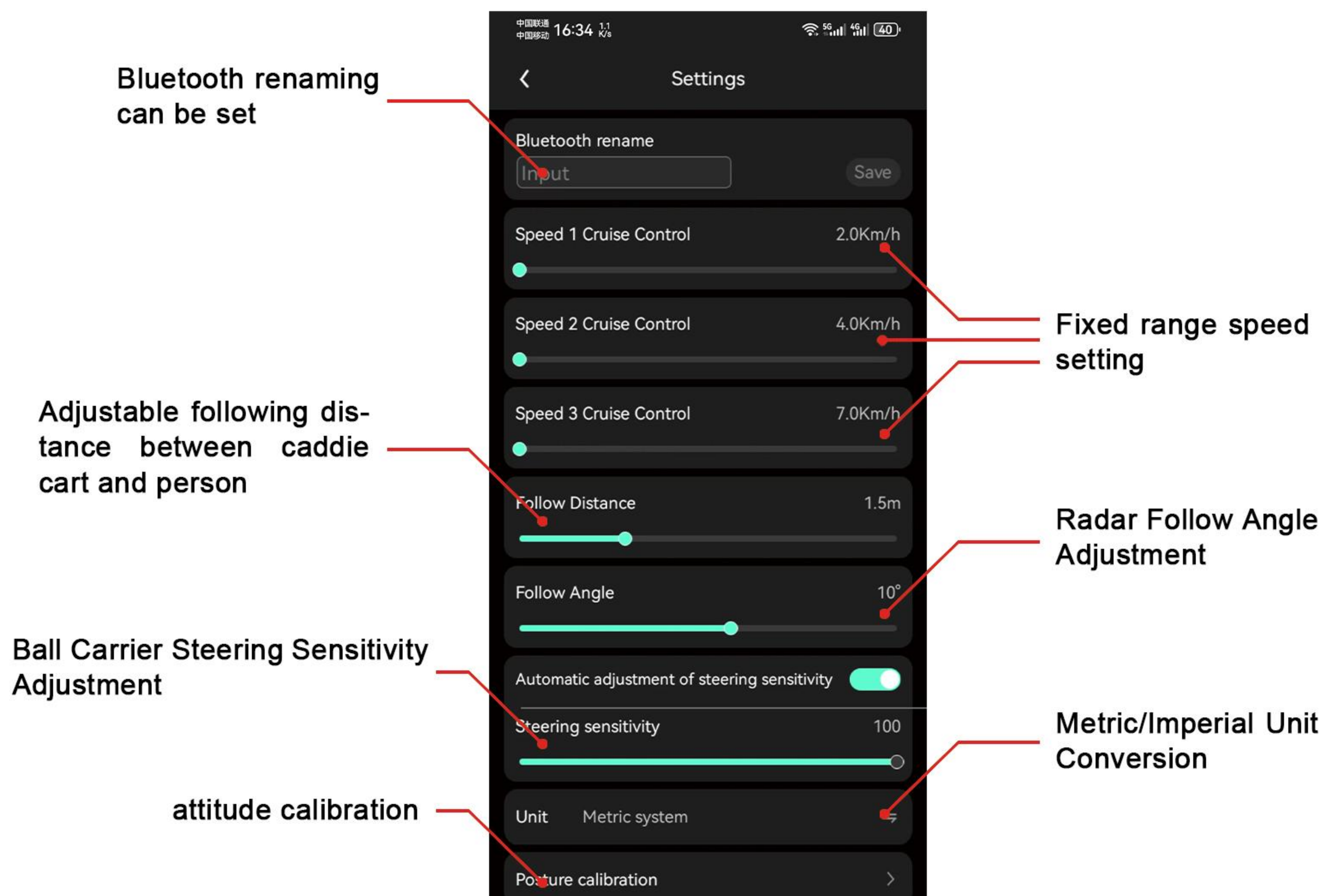
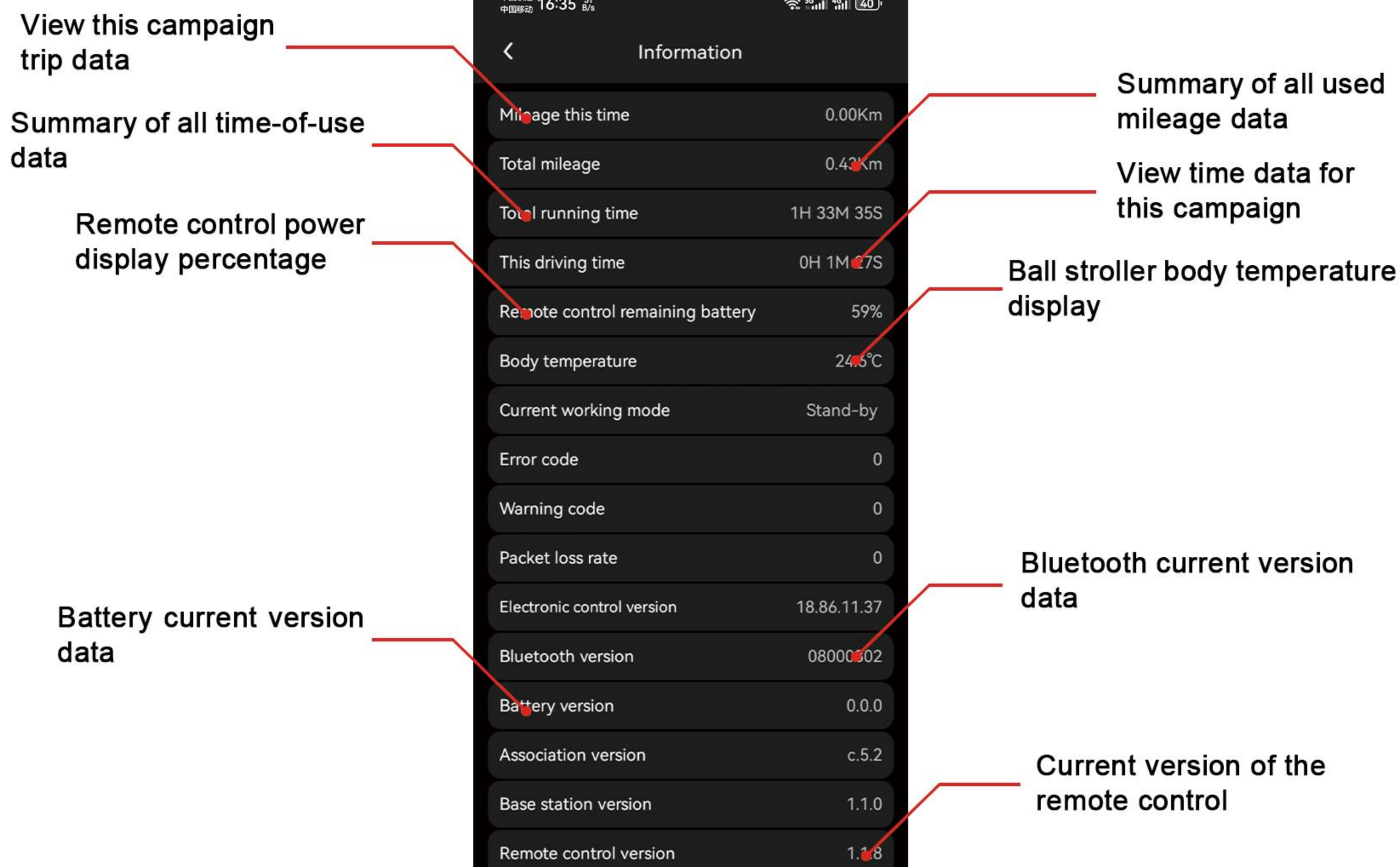



Pairing a caddy with  
a remote control

Firmware upgrades  
can be viewed

Software Settings  
Reset Option

Remote control to locate  
the position of the ball  
stroller

Firmware upgrade ex-  
ceptions are available  
with the forced firmware  
upgrade option

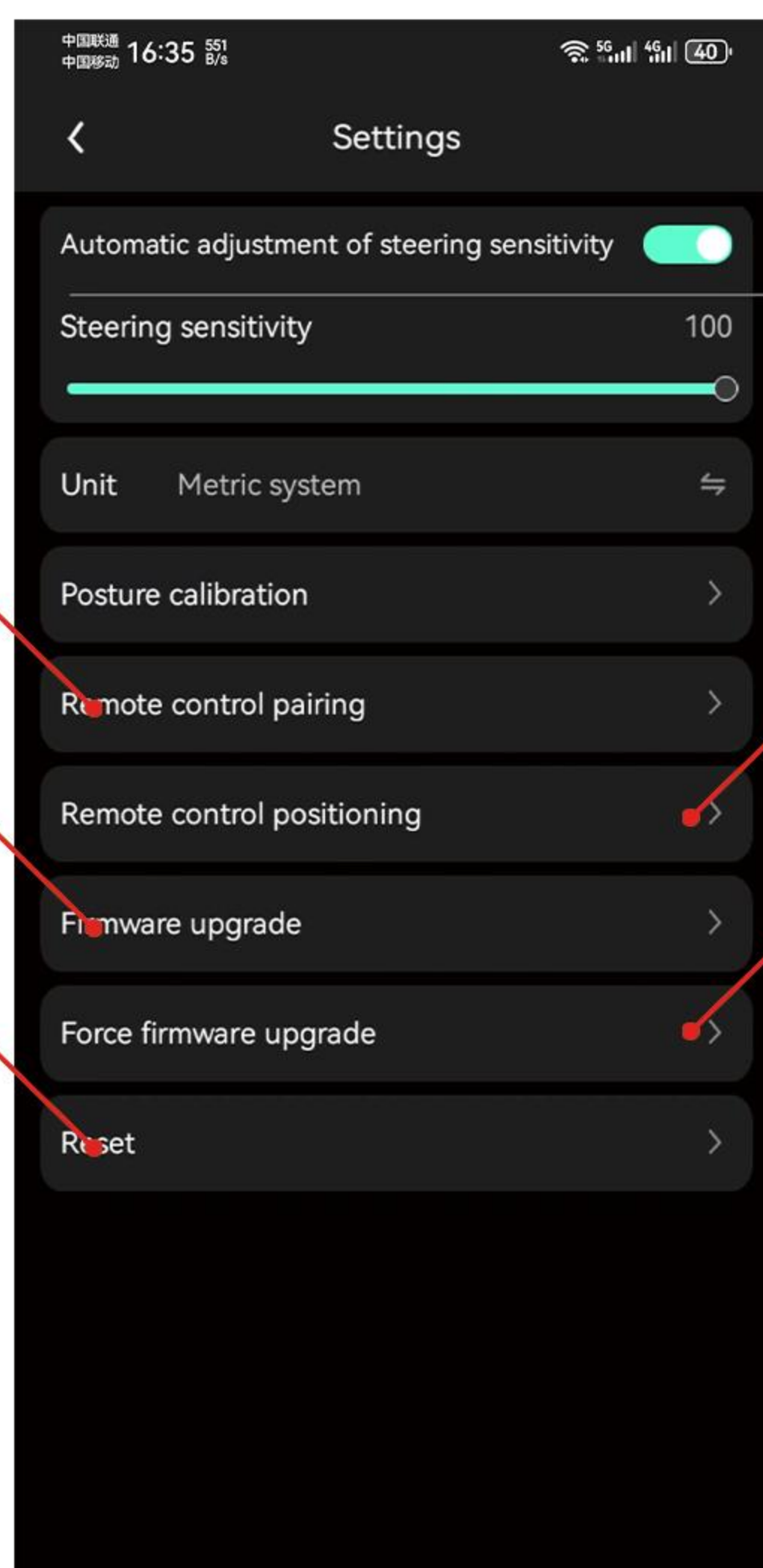

Joystick speed  
adjustment

APP Joystick





# PARAMETERS

Product Name:	G5 Electric Golf Trolley
Folded size:	28.6*24.5*14.4 inches
Expanded size:	28.6*24.5*42.7 inches
Package size:	30.7*24.8*16.9 inches
Battery weight:	1.8kg
Net/Gross weight:	18.5kg/21.8kg
Number of wheels:	6
Swivel front wheel:	yes
Body frame material:	aluminum alloy
Removable Battery:	Yes
Foldable:	Yes
Cruise speed:	1km/h-7km/h
Motor power:	80W*2
Battery:	25.2V, 10.4Ah
Battery Life:	45 Holes(23 Miles)
Charging time:	about 4 hours
Remote control distance:	50m(open space)
Climbing ability:	40 degrees
Remote control speed:	2-7km/h
Follow the technology:	UWB Ultra Wideband Technology
Material:	ABS+PC, Aluminum
Driving mode:	rear-wheel drive
Control modes:	auto-follow, hand-push mode, cruise control, remote control. APP control
Following distance:	0.5-4m(recommended to set above 1.5m)

## FCC Warning Statement

Changes or modifications not expressly approved by the party responsible for compliance could

void the user's authority to operate the equipment. This equipment has been tested and found to comply with the limits for a Class B digital device, pursuant to Part 15 of the FCC Rules. These

limits are designed to provide reasonable protection against harmful interference in a residential installation. This equipment generates uses and can radiate radio frequency energy and, if not installed and used in accordance with the instructions, may cause harmful interference to radio communications. However, there is no guarantee that interference will not occur in a particular installation. If this equipment does cause harmful interference to radio or television reception, which can be determined by turning the equipment off and on, the user is encouraged to try to correct the interference by one or more of the following measures:

- Reorient or relocate the receiving antenna.
- Increase the separation between the equipment and receiver.
- Connect the equipment into an outlet on a circuit different from that to which the receiver is connected.
- Consult the dealer or an experienced radio/TV technician for help.

This device complies with part 15 of the FCC Rules. Operation is subject to the following

two conditions: (1) This device may not cause harmful interference, and

(2) this device must accept any interference received, including interference that may cause undesired operation.

## RF Exposure Statement

To maintain compliance with FCC's RF Exposure guidelines, This equipment should be installed and operated with minimum distance of 20cm the radiator your body. This device and its antenna(s) must not be co-located or operation in conjunction with any other antenna or transmitter.



# Warrenty

G5 trolley and charger are covered by a 12 month warrenty from the date of purchase. The warrenty covers manufacturing defects that occur during normal use and only applies to new G5 trolley. Any brakeage caused by accidental damage, or as a result of abuse or misuse, are not covered by the warranty. The warrenty is not transferable. Used trolley is not subject to any warranty unless specifically stated by ourselves.

Trolley battery is covered by a 12 month warrenty. If the battery fails in the first 12 months, it will be replaced free of charge. All accessories are covered for 12 months from the date of purchase.

If you required services covered by the warrenty, please contact us. Please retain your sales receipt or packing slip for proof of purchase. The aftersale department will diagnose the problem and sen the replacement part to customer. Any parts replaced under the warrenty, at no charge, do not carry a new warranty.

In the event, the customer is unable to replace the part themselves, please retain all the original packaging material to return your trolley to repair. All trolleys must be returned in the original packaging. In the event, a replacement part is needed, but not covered by the warrenty. The customer will be responsible for all costs.

## **WARNING:**

G5 is water-resistant and safe to use under a light rain condition. However, trolley is not waterproof. The battery and circle board will die if it goes into a water hazard such as a pond or lake. This is not covered under the warranty plan.

## **Precautions for use:**

1. Hanging heavy items on handle is not allowed while using trolley;
2. If encounter insurmountable obstacles while using, please move the trolley away;
3. When walking on a steep slope, manual assistance is needed to push and pull at the necessary moment.
4. If you do not use the trolley in winter, please remove the battery and store it in an environment above 10°C to increase battery life.