

Wrist Blood Pressure Monitor

Instruction Manual

Model FF2100



Instruction Manual

Friendly Reminder

Dear users, thank you for purchasing our wrist blood pressure monitor. In order to use this product safely and avoid injury or loss caused by improper use :

- Please read the instruction manual carefully and use the product correctly before use.
- Please keep it properly after reading, so that you can consult and refer to it at any time.
- The warranty card is attached, please don't lose it.
- The illustrations in this guide are schematic diagrams.

[Name of registrant]FITOLOGY Medical Technology (Hunan) Co.; Ltd.

[Registered address]Room 017, Building 3, Medical and Health Industry Incubation Park, Nanxian Economic Development Zone, Nanzhou Town, Yiyang City, Hunan Province

[Address]No.301, Floor 3, Building 3, Xinxing Industrial Park Phase II, Nanxian Economic Development Zone, Yiyang City, Hunan Province

[Service Life]

2 years

0 Safe use

This device is a household product and is suitable for wrist blood pressure monitor for adults aged 18 and above.

This instruction manual provides you with important information about the Wrist Blood Pressure Monitor FF2100. To ensure the safe and proper use of your monitor, READ and UNDERSTAND all of the safety and operating instructions. For specific information about your own blood pressure, contact your physician.

0.1 Warning

- Do not diagnose or treat yourself based on the measurement results. Please follow your doctor's advice, because self-diagnosis may worsen the condition. Send your measurement results to your physician or medical staff who is familiar with your physical condition.
- Consult with your physician before using this product if you have common arrhythmia, such as atrial or ventricular premature beats or atrial fibrillation; arterial sclerosis; poor perfusion; diabetes; pregnancy; preeclampsia or renal disease. NOTE that any of these conditions in addition to moving, trembling, or shivering may affect the results.
- Results may be inaccurate for patients suffering from blood circulation disorders or blood diseases.
- Do not use this monitor on infants, toddlers, children or persons who

cannot express themselves.

- This product has not been validated for use on pregnant patients.
- Consult with your physician before using this product if you have had a mastectomy or lymphectomy surgery.
- The following should use this product for blood pressure measurement under the guidance of a doctor:
 - Patients with limb shaking syndrome or people who cannot bend their arms by themselves.
 - People who have wounds or inflammation in their arms or wrists.
 - People whose arms or wrists are receiving infusion, blood transfusion, or catheter inserted.
 - Patients who are using monitoring medical equipment.
 - Patients who may have large differences in wrist blood pressure from upper arm blood pressure.
- The parts of product do not support repair and maintenance when it is in use.
- User must be an intended operator.
- Keep the charging cradle(with the power cable) away from infants, toddlers or children to avoid risk of strangulation.
- DO NOT disassemble or attempt to repair this product by yourself.

AC Adapter / Charging Cable Handling and Usage

- DO NOT use the AC adapter if product or charging cable is damaged. Please turn off the power and the unplug AC adapter immediately.
- Plug the AC adapter into appropriate voltage outlet. DO NOT use in a multi-outlet plug.
- NEVER plug in or unplug the AC adapter from electric outlet with wet hands or wet fingers.
- DO NOT disassemble or attempt to repair the AC adapter by yourself.
- DO NOT touch (with wet hands or wet fingers) or wet charging port of band, terminal of the charging clip and plugs of cables.
- To help avoid strangulation, keep charging cable away from infants, toddlers or children.

Rechargeable Battery Handling and Usage

- The rechargeable battery has been specifically designed for this product.
- DO NOT use the rechargeable battery in any other devices.
- DO NOT recharge the rechargeable battery once it has been removed from this product.
- DO NOT dispose of the battery in a fire.
- DO NOT crush or puncture the battery because it may cause spontaneous flames.
- DO NOT disassemble or modify the battery.

- DO NOT connect the +and – poles using a piece of metal or other conductive objects.
- DO NOT carry battery or store battery together with items such as necklaces and hair pins.
- DO NOT leave the battery that has been removed within reach of infants, toddlers, children or pets. Doing so may result in an injury or an accident. If liquid comes in contact with the battery, a fire or an accident may occur.
- This product has a built-in rechargeable battery. To prevent the risk of overheating, fire or explosion, DO NOT throw into fire, apply heat, puncture or crush, use or leave in a high temperature environment.

0.2 Precaution & Safety information

Before using and operating product, please read and observe following precautions to ensure best performance of product and avoid dangerous or illegal situations.

Electronic equipment & Impact on medical equipment

- Do not use this product in places where it is forbidden to use wireless device, otherwise it will affect other electronic equipment or cause other dangers.
- DO NOT use this product in areas containing high frequency (HF) surgical equipment, magnetic resonance imaging (MRI) equipment, computerized

tomography (CT) scanners. This may result in incorrect operation of product and/or cause an inaccurate result.

- Portable and RF communication devices may affect this product. Do not place product near or on top of other devices. Otherwise, radiation may increase and anti-interference capability may decrease.
- Ensure that electromagnetic interference is no more than 3 V/m. Possible sources of interference include microwaves and X-rays.
- Please observe and obey regulations of medical and health care places where wireless devices are forbidden, and do not use this product.
- Radio waves generated by product may affect normal operation of implantable medical devices or personal medical devices, such as pacemakers, cochlear implants, hearing aids, etc. If you use these medical devices, please consult their manufacturers about restrictions on use of this product.
- When using this product, please keep a distance of at least 15 cm from implanted medical devices (such as pacemakers, cochlear implants, etc.).

Flammable & Explosive area

- Do not use this product at gas station (or maintenance station) or near any flammable and explosive areas such as flammable materials and chemicals, and follow all the instructions in graphics or words. Product may cause explosion or fire in or around fuel or chemical storage and

transportation areas or explosive places.

- Do not store or transport product and its accessories in the same box with flammable liquids, gases or explosives.

Traffic safety

- Remember that safe driving is your primary duty, and don't engage in activities that will distract you.
- Electronic equipment of car may malfunction due to radio interference of product. Please contact manufacturer for details.
- Do not place product above car airbag or in area that can be reached after airbag is deployed. Otherwise, when airbag expands, product will be pushed by a strong external force, which will cause serious injuries to people inside car.
- Product may interfere with flight system of aircraft. Please comply with relevant regulations of airlines. Do not use product in places where it is forbidden.

Operating safety

- This product supports a wrist circumference range of 13.5 cm to 19.5 cm for blood pressure measurement. If wrist circumference exceeds range, accuracy of blood pressure results may be affected.

- Observe your arm during measurement to ensure that this product is not affecting blood flow.
- If cuff is excessively inflated, it may cause discomfort to your wrist and cause blood stasis or paralysis. In this case, please remove product.
- Do not take blood pressure measurement too often as bruising may occur due to blood flow interference.
- This product may cause adverse events such as allergies. In this case, stop wearing it and consult your physician.
- Product may worsen conditions for people who have wounds or inflammations in their arms or wrists.
- Product may cause harm to people whose arms or wrists are receiving infusion, blood transfusion, or catheter inserted due to its temporary interference with flow of blood.
- If reading is abnormal, you can take a measurement again 5 minutes later or consult your physician.
- Do not use product in damp or close to magnetic field, so as to avoid internal circuit failure of product.
- Do not use this product in thunder storm weather. Thunder weather may cause measurement failure or electric shock danger.
- Please use this product in temperature range of - 5 °C to 45 °C. When ambient temperature is too high or too low, it may cause measurement

failure.

- Accuracy of pressure sensor has been strictly tested, so you do not need to check it. If you have any questions, please contact us.
- If you use a defibrillator while wearing product, blood pressure measurement may be affected. Please contact us if you have any questions about it.
- DO NOT use this product in places with high or low humidity nor high or low temperature.

Waterproof & Environment requirement

- Product has been tested and showed waterproof performance in a specific environment.
- Do not use blood pressure measurement function in a watery environment such as swimming and bathing, otherwise it may cause product damaged.
- Do not store product in a place with direct sunlight, moisture, high temperature, humidity, dust and corrosive gas.

Child health

- This product and its accessories may contain some small parts. Please keep product and its accessories out of the reach of children. This product is not a toy. Children may inadvertently damage this product and its

accessories, or swallow small parts, which may cause respiratory distress or other hazards.

Fitting requirement

- Use of unauthorized or incompatible power supply chargers or batteries may cause fire, explosion or other hazards.
- Only accessories approved by manufacturer can be used. If other types of accessories are used, it may violate the warranty terms of this product and relevant regulations of country where this product is located, and may lead to safety accidents. If you need approved accessories, please contact us.
- Do not use charger in wet places (such as washbasin, red bath or near shower room), and do not plug charger with wet hands or wet fingers.
- Do not use strong chemicals, cleaning agents or strong detergents to clean product or its accessories. Please wipe this product or its accessories with a clean and dry soft cloth.
- Do not touch magnetic stripe card (such as bank card, phone card, etc.) for a long time, or product may be damaged by the magnetic field.
- Do not disassemble or modify product and its accessories without authorization, otherwise product and its accessories will not be covered by the warranty of our company. Please contact us when product fails.

- If product collides with a hard object or product is strongly impacted by outside world and screen is partially broken, do not touch or try to remove the broken part. Please stop using it immediately and contact us in time.
- Please keep product and its accessories clean and dry. Do not wear it too loosely or too tightly during blood pressure measurement. Please clean your wrist and product after blood pressure measurement, and wear it after cleaning and drying.
- You can relax watchband a little when you wear it everyday, so as to ensure that the parts where the skin comes into contact with product are dry and breathable. If it is uncomfortable to wear continuously for a long time, please take off product and rest your wrist for a while or change hands. If you still feel uncomfortable, you are advised to stop wearing and consult your physician in time.
- Please observe precautions in the instruction manual and other correct methods of use. If you do not comply, we will not be responsible for the quality.

Environmental protection

- Please do not treat this product and its accessories as ordinary domestic garbage.
- Please comply with the local laws and regulations on disposal of this product and its accessories, and support recycling action.

- When product and its accessories and other wastes are discarded, please deal with them according to the relevant local environmental protection regulations.

1 Product information

1.1 Intended Use

The Wrist Blood Pressure Monitor FF2100 is a digital monitor intended for use in measuring blood pressure and pulse rate in adult population with wrist circumference ranging from 13.5 cm to 19.5 cm (5.31 - 7.68 inches).

1.2 Contraindications

Allergic reactions to this product.

1.3 Performance Indicators

General Specifications	
Name	Wrist Blood Pressure Monitor
Models	FF2100
FCC ID	2BC5WFF2100
Embedded Software Version	V.1.0.0
Running Mode	Continuous running
Display	LCD
Rating	DC 5V/1A
Power Supply	Internal power supply: Rechargeable Li-ion Polymer Battery (Battery voltage range: 3.0~4.4 V)

Durable period (Service life)	Monitor: 2 years Charging cradle: 2 years Cuff & watchband: 1 year Cuff sleeve (spare): 0.5 years
Operating conditions	Temperature: - 5°C to +45°C Humidity: 10% RH to 95% RH (excluding condensation) Atmospheric pressure: 80 kPa to 105 kPa
Storage conditions	Temperature: - 20°C to +55°C Humidity: 10% RH to 95% RH (excluding condensation) Atmospheric pressure: 80 kPa to 105 kPa
Weight	Approximately 3.1oz. (87.8g) (including battery)
Dimensions	Length: ~1.97 inches (50.0 mm) Width: ~1.54 inches (39.5 mm) Thickness: ~0.63 inches (16.0 mm) Band width: ~1.18 inches (30.0 mm)
IP classification	IP65

Blood Pressure Measurement

Measuring Method	Oscillometric
Measurement Range	Pressure: 0 – 300 mmHg (0 – 40 kPa)
Precision Error	Pressure: ± 3 mmHg (± 0.4 kPa)
Inflation Method	Automatic pressure pump
Deflation Method	Automatic fast deflation
Measurable Wrist Circumference	13.5 - 19.5 cm (5.31 - 7.68 inches)

1.4 Structure Diagram and Packing List

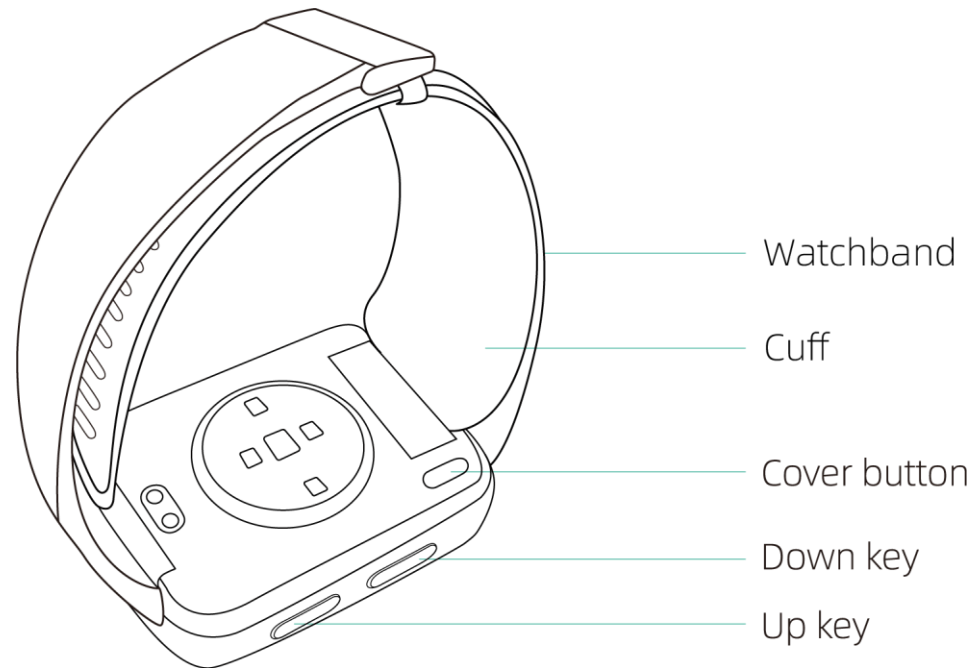

This product consists of a device body, a watchband, and a wireless charging cradle. For its materials, see the label on the package.

Packing list:

- 1.4.1 Device (with a watchband and a cuff) x 1
- 1.4.2 Wrist circumference ruler x 1
- 1.4.3 Instruction manual x 1
- 1.4.4 Charging cradle (with power cable) x 1

2 Preparation

2.1 Charging Battery

Step 1. Align charging cradle with power port on back of this product.

Step 2. Connect charger at the other end and turn on power until charging power indicator appears on screen.

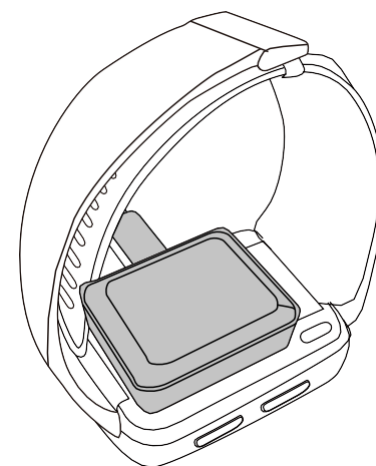

Note

- Please use the authorized charging cradle included in package to charge, and keep it dry when charging.
- In order to ensure the safety of charging, you can use charging head that meets the standard requirements.

2.2 Changing watchband and cuff

Step 1. Disassemble cuff.

- Open upper buckle and lower buckle of cuff.
- Press cover button and pull cuff upwards to make cuff sleeve plate separate from watch body.

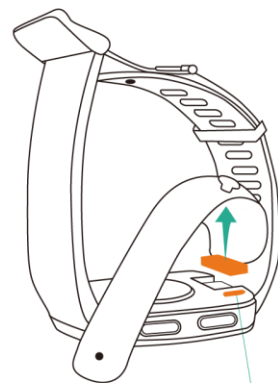
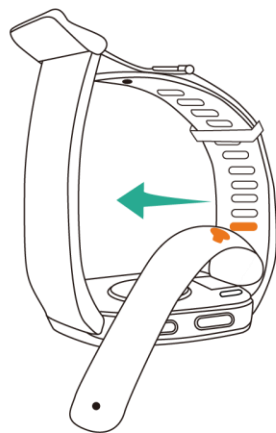
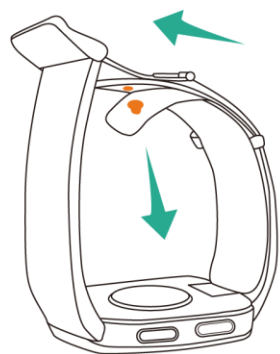

Press the cover button.
And pull the cuff upward.

Step 2. Disassemble watchband.

- Pull hook out and separate hook and watchband.
- Move level in direction of arrow to pull out watchband to outside.

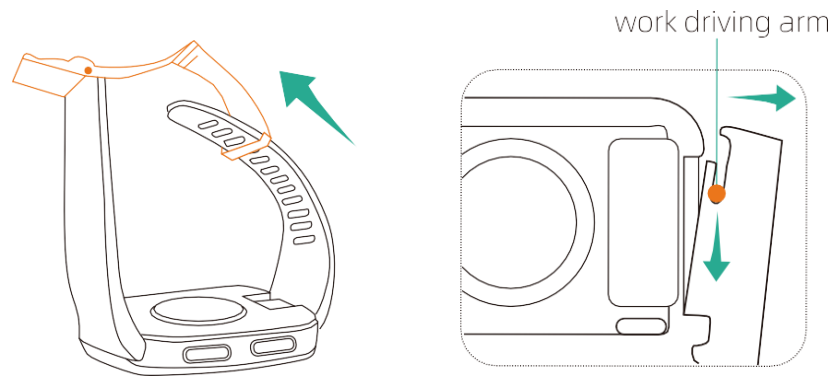

2.3 Replace cuff sleeve

Step 1. Disassemble cuff sleeve

- Pull cuff out of cuff sleeve from middle position.

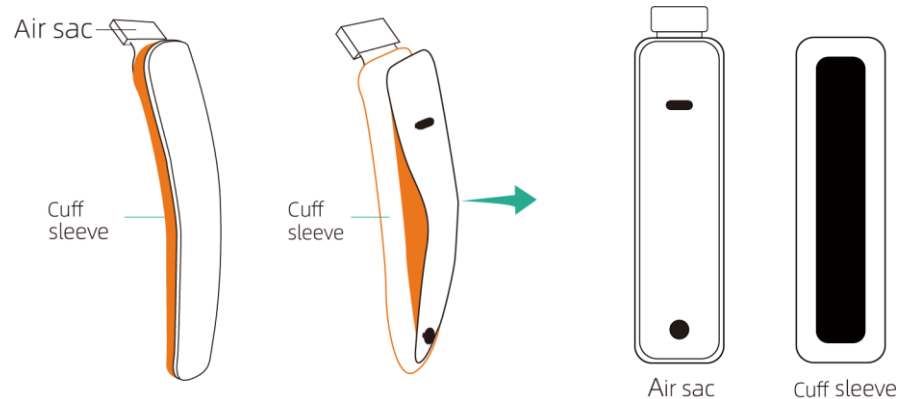

Step 2. Install cuff sleeve

- Insert cuff from middle of cuff cover and then pull it out from head.

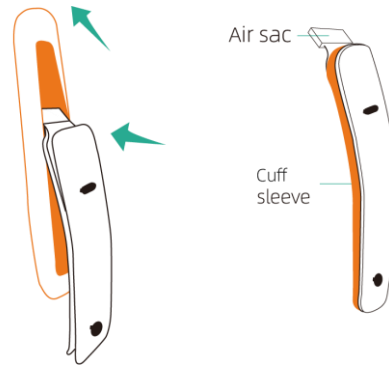

2.4 Installing watchband, cuff and hook

Step 1. Install watchband and cuff.

- Align one side of watchband with watch body, toggle level in direction of the arrow and buckle it.
- Aim at position of air sac and press cuff cover plate.

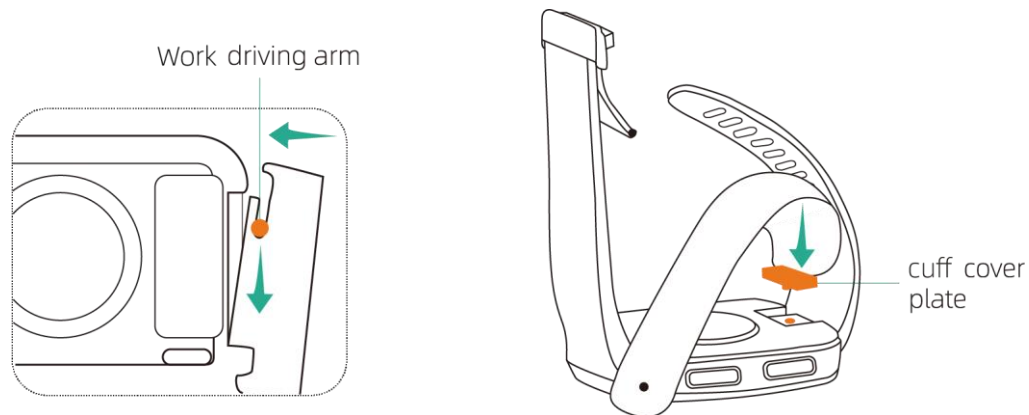

Step 2. Install hook.

- Align watchband tail with hook and thread it in.

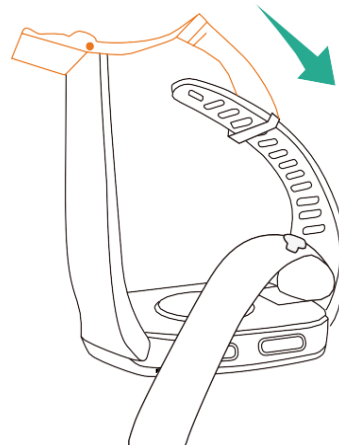

3 Blood Pressure Measurement

3.1 Principle

This product measures blood pressure by using the oscillometric method. As watchband(cuff) pressure increases, signal of pressure oscillations in the cuff is collected using pressure sensor, and high pressure (systolic pressure), low pressure (diastolic pressure), and pulse rate is calculated automatically.

3.2 Measure wrist circumference

Step 1. Measure below ulnar stem of wrist.

Step 2. Pass tail of ruler through buckle of ruler head, and pull tail of ruler to fit wrist to avoid being too tight; Record scale pointed by ruler arrow, select corresponding watchband and cuff.

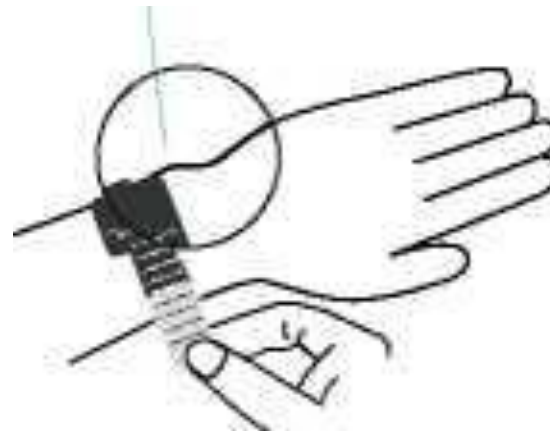

3.3 Positioning Band

3.3.1 Adjust watchband tightness

Step 1. Adjust tightness of watchband, and select watchband scale according to scale indicated in scale measurement.

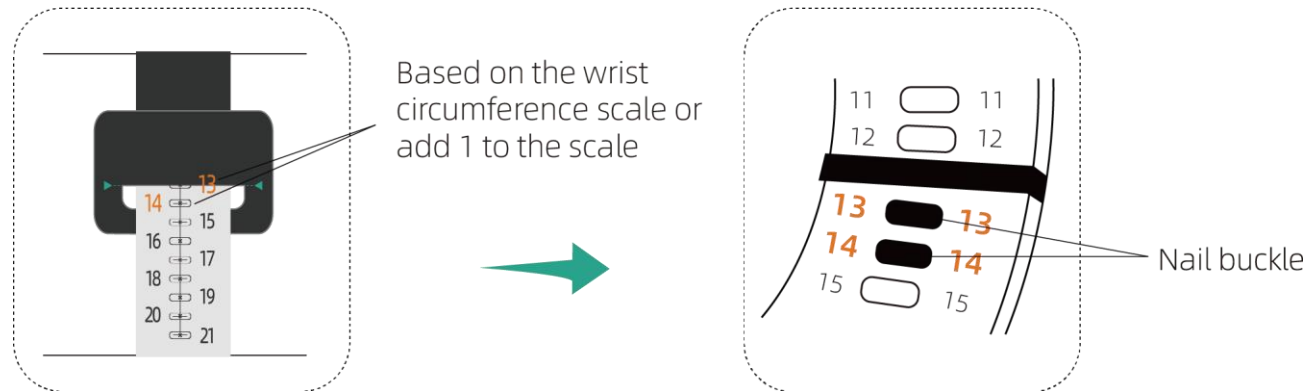

Step 2. Fasten cuff buckle.

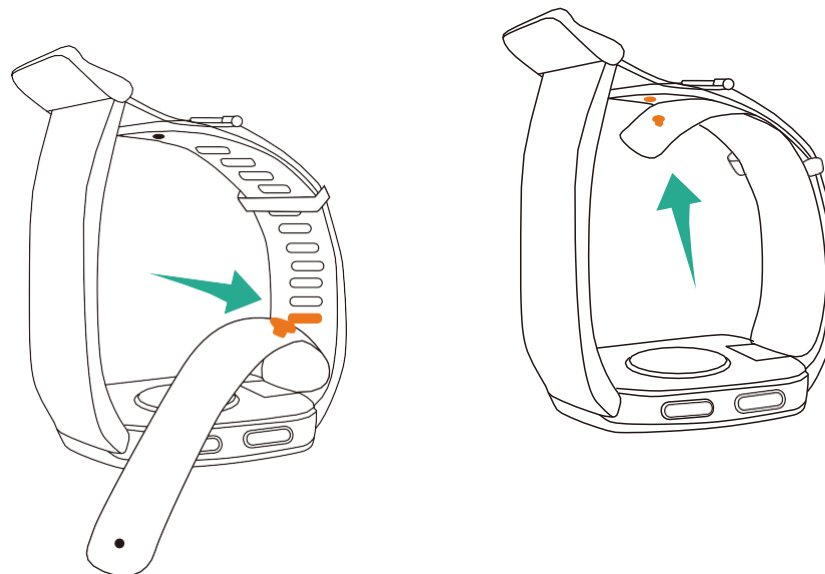

3.3.2 Wear equipment

Step 1. Wear product and Leave 3-5mm between band and bottom of palm.

Step 2. Use wrist circumference ruler as a guide.

Note

Your product must have a snug fit prior to measuring; not too tight, nor too Loose. Your index finger should NOT easily slide between band and wrist. Make sure wearing position is behind root of ulna styloid process.

Wear it behind the root of ulna styloid process.

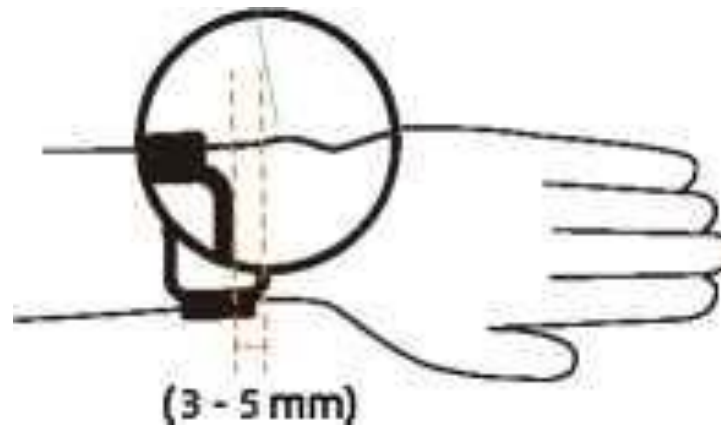

3.4 Measurement Requirement

Any blood pressure data may be influenced by the location of measurement, posture(standing, sitting, or lying down), movement, or physiological conditions.

To ensure accuracy of measurements, observe following requirements:

- Rest for 5 minutes before measurement and keep your body naturally relaxed until measurement is complete. Do not perform

measurement when you feel emotional or stressed.

- Perform measurement in a quiet environment. Do not speak, bend fingers, or move body or arms during measurement.
- Rest wrist for 2 to 3 minutes or longer before next measurement, to let arteries return to normal status.

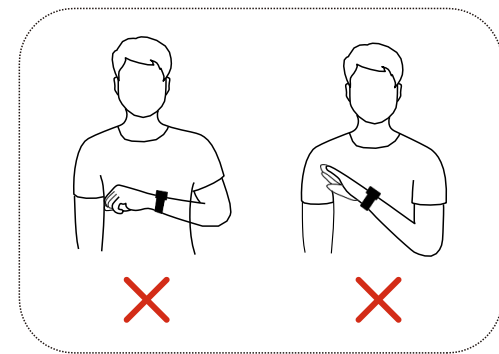
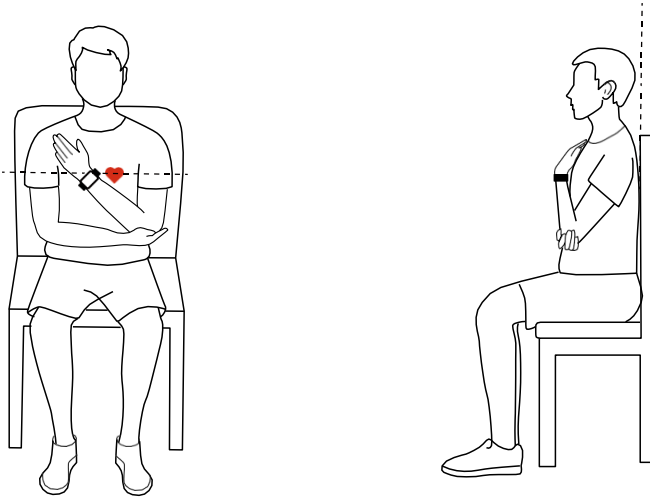

Note

Arms (especially elbows) must not feel tightened by clothing, and product must not be worn outside or pressed by clothing. When product is positioned below height of heart, result may be high; Above height of heart, result may be low. Do not hold watchband with the other hand, as this will cause false testing. Keep shoulders naturally level, don't shrug or collapse shoulders.

3.5 Measurement Steps

Step 1. Make sure product turned on, click down key to quickly enter measurement page before measuring. If you are measuring for first time, follow tips and adjust position of your wrist, then touch Next. Click "Start" or press down key on blood pressure function page to enter measurement page.

Step 2. Clicking measure, product starts to pressurize automatically, and pressure data is displayed on screen in real time. You can long press up key or click Cancel to end measurement immediately.

Step 3. After measurement, cuff automatically deflates, and high pressure, low pressure and pulse rate are displayed on measurement result interface(In this specification, high pressure means systolic pressure and low pressure means diastolic pressure).

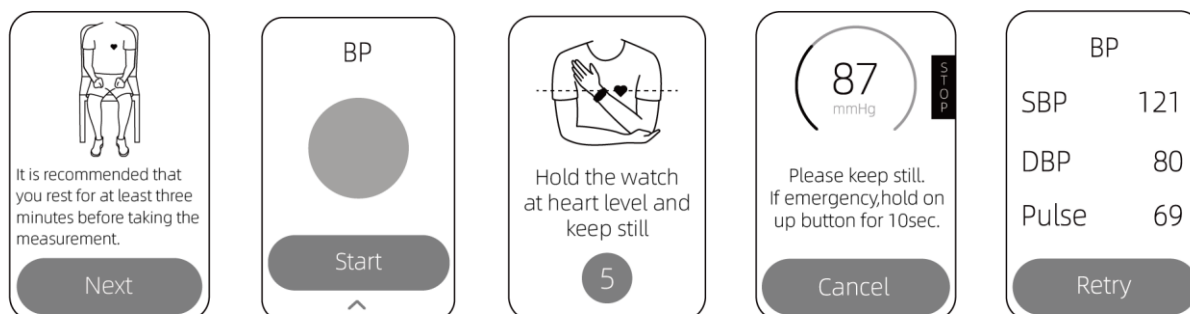

Note

- To stop a measurement, long press Up button (emergency stop button) for 10s.
- Wait 2-3 minutes before next measurement. Wait time allows arteries to decompress and return to pre-measurement state. You may need to increase wait time depending on your individual physiological characteristics.

3.6 Category of Blood Pressure

According to the ACC/AHA 2017 High Blood Pressure Clinical Practice Guideline, category of adult blood pressure shows below:

Category	High Pressure		Low Pressure
Normal	<120 mmHg	and	<80 mmHg
Elevated	120-129 mmHg	and	<80 mmHg
Hypertension			
Stage1	130-139 mmHg	or	80-89 mmHg
Stage2	≥140 mmHg	or	≥90 mmHg

Reference: ACC/AHA 2017 High Blood Pressure Clinical Practice Guideline

3.7 Precautions in Measurement

Matters needing attention in measurement:

- In process of measurement, if you feel uncomfortable due to persistent over-inflation of cuff or other reasons, measurement inflation can be canceled immediately or watchband can be untied directly to terminate measurement.
- If product is pressurized to more than 300 mmHg(40kPa), but there is no automatic exhaust, please untie watchband.
- In process of pressurization, it is a normal phenomenon that action sound and pressurization speed will change.
- In order to ensure accuracy of measurement results, please follow following requirements.
- The selection of cuff/watchband wearing tightness and position and standard measuring posture are keys to accurate measurement. Please refer to " Wearing guide" for detailed operation.
- Because blood pressure will change differently in different time , it is recommended to measure blood pressure at the same time every day.
- Please do not take measurement immediately after smoking, drinking, bathing or exercising, and wait at least 30 minutes before taking measurement.
- After urination and defecation please wait 10 minutes before taking measurement.

- Please don't take measurement within 1 hour after meal.
- Please don't measure in places where it is too cold, too hot or the environment changes drastically.
- Please don't take measurement while standing .
- Please don't take measurement when body parts are under pressure.
- Please don't make measurement in moving vehicles.
- Please do not stretch or bend watchband and cuff with force.
- Try to rest for 3 minutes before measurement, so that your body is in a state of natural relaxation, and avoid measuring when you are emotionally nervous.
- Please make measurement in a quiet environment. Do not talk, bend fingers or move body or arms during measurement.
- During continuous measurement, please take next measurement at intervals of 2~3 minutes.

Warning

The inflation limit of this product is 300mmHg/40 kPa. Please don't be inflated for a long time to avoid damage to wrist.

Tip: According to the ACC/AHA 2017 High Blood Pressure Clinical Practice Guideline, it is recommended that you observe the average value of two consecutive measurement records (2~3 minutes apart).

3.8 Memory function

Slide and click on blood pressure interface to view more measurement records and it can show details of last six results including high pressure, low pressure, pulse rate and specific time of measurement.

Note

Store up to 6 records, and automatically replace earliest data with latest data.

- Delete data function

All data are cleared after the product is restored to factory settings.

- Measurement unit conversion

Default unit is "mmHg" and slide to select unit set in settings on blood pressure application interface to change mmHg to kPa.

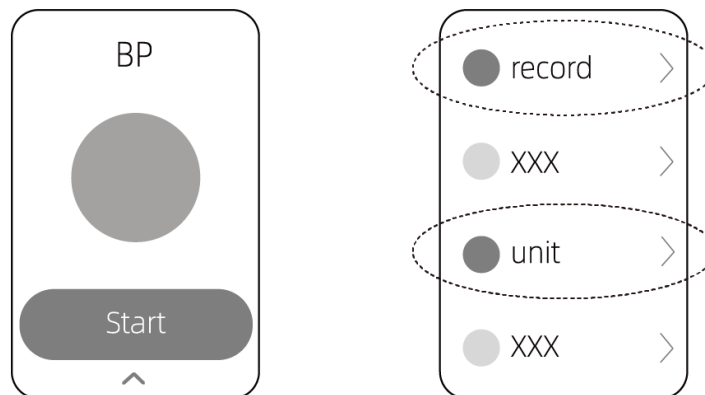

4 Storage and Maintenance

To protect this product from damage, please follow directions below:

4.1 Maintenance

In order to ensure normal operation and prolong service life of product, please pay attention to cleaning and maintaining product at ordinary times.

1. If there is dirt on watchband or cuff, please wipe it with a dry soft cotton cloth.

Note: Watchband and cuff can't be cleaned in washing machine or dishwasher.

2. Do not wash or wet cuff;

3. When cuff is disassembled and cleaned, please do not soak it in water directly; Please prevent moisture, cotton wool and other foreign substance from entering cuff body from air sac;

4. Cuff sleeve can be disassembled separately and cleaned. Please use cold water to clean. If it is not easy to remove, you can use mild soap to remove stubborn stains. After cleaning, wear after completely dry. Do not use hot water to clean or put in dryer;

5. Do not use volatile oil, diluent or gasoline to wipe watchband/cuff;

6. Daily inspection. If you find watchband or cuff damaged, please contact us;

7. Changes or modifications not approved by manufacturer will void the

user warranty.

4.2 Storage Requirements

Do not store product in following environments:

- Environments with water, high temperature, dampness, direct sunlight, dust, or salt.
- Environments that can generate tilts, vibrations, or impacts.
- Environments where chemicals are stored or corrosive gases are generated. It is recommended to put cuff in a box or storage bag when not using.
- Do not put product in places that are exposed to direct sunlight, such as on a car dashboard or on a window sill.
- Keep product away from heat sources or exposed fire sources, such as electric heaters, microwaves, ovens, water heaters, fireplaces, candles, and other places that may generate high temperature.
- To prevent injuries, malfunctions, or explosions, do not allow children or pets to swallow or bite product or its accessories.
- Do not use a wet cloth on terminal of charging cradle, or charging cable.

4.3 Transportation Conditions

Avoid strong impacts, direct collisions, and exposure to sunlight or rain during transportation.



4.4 Accessory Replacement

- Replacing original parts with third-party parts may cause measurement errors.
- Replace cuff when it becomes dirty. It is recommended to replace after six months of use. For details, please contact us.
- Do not perform any maintenance by yourself. If product has quality issues or you have any questions about how to use properly, please contact us.

4.5 Disposal

Dispose of product and other components according to applicable local regulations. Unlawful disposal may cause environmental pollution.

5 Explanations of Symbols and Figures

Figures and Symbols	Description
	Type BF Applied Part
	Federal Communications commission certification mark
	Indicates that the product is capable of being recycled.

6 Error Messages and Trouble shooting

6.1 Error Messages

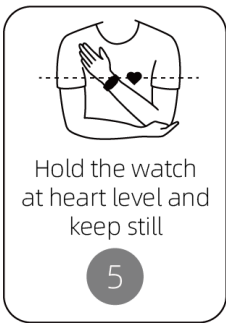
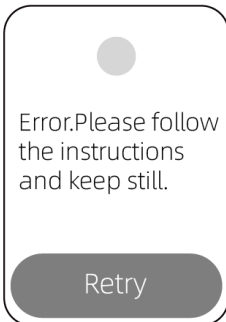
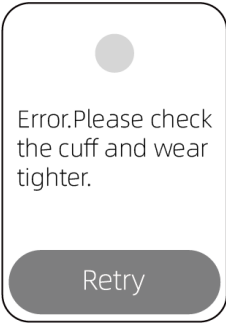
No.	Display	Cause	Solution
01	 <p>Hold the watch at heart level and keep still</p> <p>5</p>	Measurement page is stuck	Try up button or swipe right, and if it doesn't work, press and hold Up button for more than 10 seconds to restart.
02	 <p>Error.Please follow the instructions and keep still.</p> <p>Retry</p>	Measurement failed, for body moved during a measurement.	Please remain in a sitting position,avoid talking, moving arms, or moving fingers,and retry.
03	 <p>Error.Please check the cuff and wear tighter.</p> <p>Retry</p>	Measurement failed, for wearing too loose.	Please check cuff and wear tighter then take another measurement.

6.2 Trouble shooting

No.	Problem	Cause and Solution
01	Nothing appears on display of monitor.	Charge battery. Press and hold Up button for more than 2 seconds to turn on.
02	Readings appear too high or too low.	Blood pressure varies constantly. Many factors including stress, time of day, and/or how you apply band, may affect blood pressure.Review sub-section 3.4.
03	Results may not be accurate.	Due to slight movement or incorrect posture.
04	Product shuts off in mid-measurement or only after few measurements.	Maybe battery is in low power and you should recharge battery.
05	Cannot charging.	Check if adapter output connector insert into charging cradle firmly.
06	Product can not be operated.	Turn off and restart. If product still does not work, contact us.

07	Product or AC adapter is abnormally hot when charging.	Product or AC adapter may be damaged. Unplug AC adapter from outlet immediately and contact us.
08	Operating time is short, or product does not work,even when battery is fully charged.	This may be due to damaged rechargeable battery. Since battery cannot be replaced, please contact us.

7. Limited Warranty

This product is guaranteed nationwide, and enjoys three guarantees service. The warranty period is 1 year.

The following situations do not belong to scope of free replacement and repair: Any modification, disassembly and maintenance without authorization of us.

Accidental factors or human actions lead to product damage. Such as liquid (subject to test results of service shop), loss, inappropriate voltage put,

excessive extrusion, deformation of main board, etc. For power adapter, if there are obvious hard object damage, cracks, broken legs, severe deformation, damaged power cord, broken wires and bare cores, etc. Failure or damage of products caused by failure to install, use, maintain and keep according to the requirements of instruction manual. The warranty certificate is inconsistent with the product model or the warranty certificate is altered. The name plate, SN bar code, and tamper proof label of the product are torn off or damaged, and they are indistinct and unrecognizable. Failure or damage caused by force majeure (such as fire, earthquake, flood, etc.). Other non-guaranteed scenarios detected by customer service center.

Security information

The products described in this manual may contain the copyrighted software of our company and its possible licensors. No one can copy, distribute, modify, extract, decompile, disassemble, decrypt, reverse engineer, rent, transfer, or sub-license the aforementioned software in any form unless the applicable law prohibits such restrictions.

Some features and functions of the product and its accessories described in this manual depend on design and performance of local network and software installed. Some features and functions may not be realized due to lack of support from local network operators or network service providers, or setting of local networks, or lack of support from installed software. Therefore, descriptions in this manual may not correspond exactly to product or its accessories you purchased. Our company reserves the right to modify any information in this manual at any time without prior notice and without any responsibility.

Limitation of liability

All the contents in this manual are provided "as is" Unless required by applicable law, our company does not provide any express or implied guarantee for all the contents in this manual, including but not limited to the guarantee of merchantability or suitability for a particular purpose.

Within the scope permitted by applicable laws, under no circumstances will our company compensate for any special, incidental, indirect or secondary damages caused by use of relevant contents of this manual and product described in this manual, nor any loss of profits, data, goodwill or expected savings.

Within scope permitted by relevant laws, in any case, our company's maximum liability for losses suffered by you due to use of product described in this manual(except for damages stipulated by applicable laws in cases involving personal injury) is limited to the price paid by you for purchasing this product.

Data security

Using unauthorized third-party software to upgrade firmware and system of product may pose security risks such as product being unusable or revealing your personal information.

Import and export controls

If you need to export, re-export or import products described in this manual(including but not limited to the software and technical data in the product), you should abide by the applicable import and export control laws and regulations.

8. RF ,EMC and Safety

8.1 FCC statement

Any Changes or modifications not expressly approved by the party responsible for compliance could void the user's authority to operate the product.

Part 15 B:

This product has been tested and found to comply with the limits for a Class B digital device, pursuant to Part 15 of the FCC Rules. These limits are designed to provide reasonable protection against harmful interference in a residential installation. This product generates, uses and can radiate radio frequency energy and, if not installed and used in accordance with the instructions, may cause harmful interference to radio communications. However, there is no guarantee that interference will not occur in a particular installation. If this product does cause harmful interference to radio or television reception, which can be determined by turning the product off and on, the user is encouraged to try to correct the interference by one or more of the following measures: --Reorient or relocate the receiving antenna. --Increase the separation between the product and receiver. --Connect the product into an outlet on a circuit different from that to which the receiver is connected. --Consult the dealer or an experienced radio/TV technician for help. CAUTION: Any changes or modifications not

expressly approved by the grantee of this device could void the user's authority to operate the product.

Part 15C & 15E

This product complies with Part 15 of the FCC Rules. Operation is subject to the following two conditions: (1) this product may not cause harmful interference, and (2) this product must accept any interference received, including interference that may cause undesired operation.

RF exposure warning

The product complies with FCC RF exposure limits set forth for an uncontrolled environment. The product must not be co-located or operating in conjunction with any other antenna or transmitter.

8.2 Safety and EMC

This product is Class II equipment with type BF applied. It complies with Medical Electrical Safety Standards (IEC 60601-1).

This product also complies with Medical EMC Standard (IEC 60601-1-2).

The has been tested and found to comply with the electromagnetic compatibility (EMC) limits for medical devices to IEC 60601-1-2: 2014. These limits are designed to provide reasonable protection against harmful interference in a typical medical installation.

9. Service Policy

Dear

users, thank you for choosing our smart wearable products purchased through formal channels enjoy the three guarantees service stipulated by the state according to law. You can know the specific details through our official customer service hotline.

Customer service hotline:+86-0571-86526367

Service hotline will provide you with rich, convenient and fast quality service experience.

Three guarantees certificate

User name: .

User contact number: .

User address and zip code: .

Purchase date: .

Seller name: .

Seller's address and zip code: .

Seller phone number: .

Host information

MAC/SN number: .

Attachment information

Attachment information

Charging cradle

Note:

- This three-guarantee certificate is only applicable to the three-guarantee service of product and its accessories with serial numbers listed above.
- Please keep this three-guarantee certificate properly. Please show this certificate and related invoices when enjoying the three-guarantee service.
- This voucher can only take effect after being stamped by the sales unit. Man-made damage is not covered by warranty. Please refer to our hotline for specific warranty. Products can only enjoy maintenance service in country or region where they are purchased. Due to different models, product may not include all the above accessories.

