

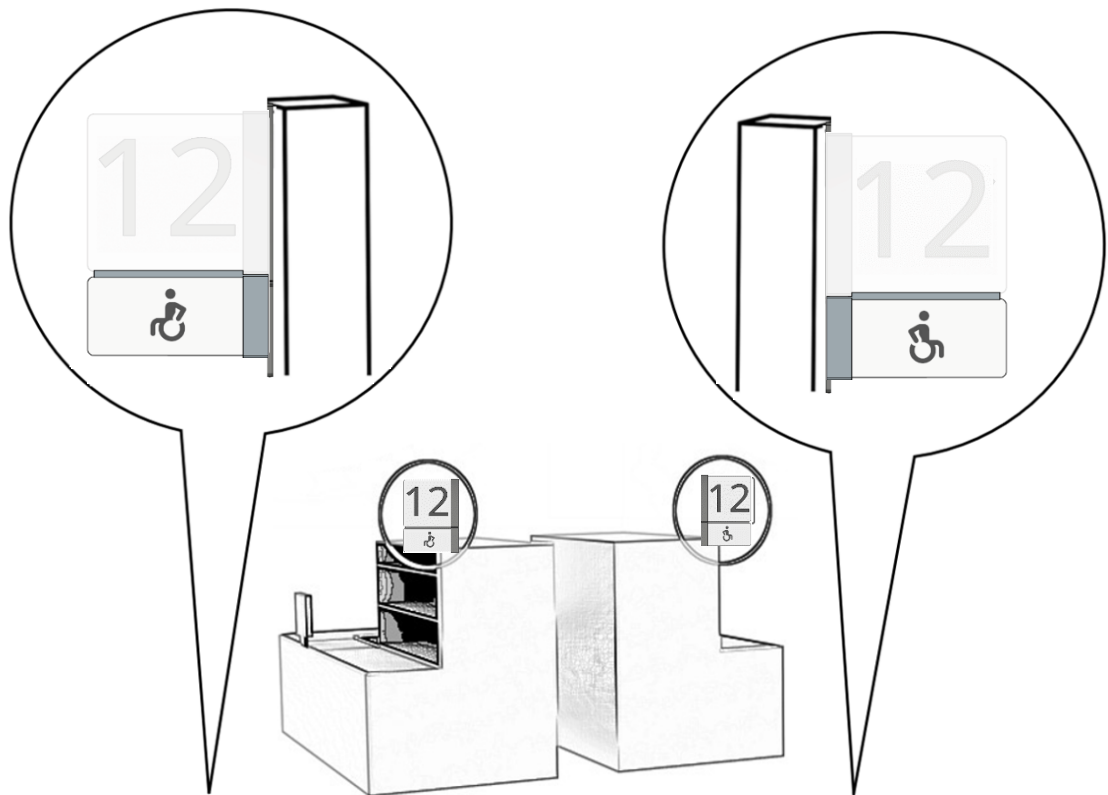

i- this document online

Installation Guide: Targa LED Cashier Addon Display Sign



TARGA TKD-SBES-AOD-SET-R-H	TARGA TKD-SBES-AOD-SET-L-H
LED CASHIER ADDON DISPLAY SIGN with attachment right, PRINT Handicap	LED CASHIER ADDON DISPLAY SIGN with attachment left, PRINT Handicap

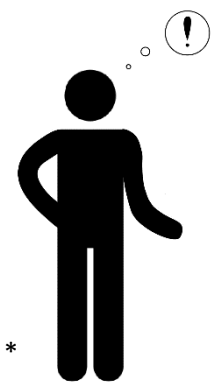

*

Credits/Reference:* Image: Flaticon.com'. This cover was created using resources from Flaticon.com.

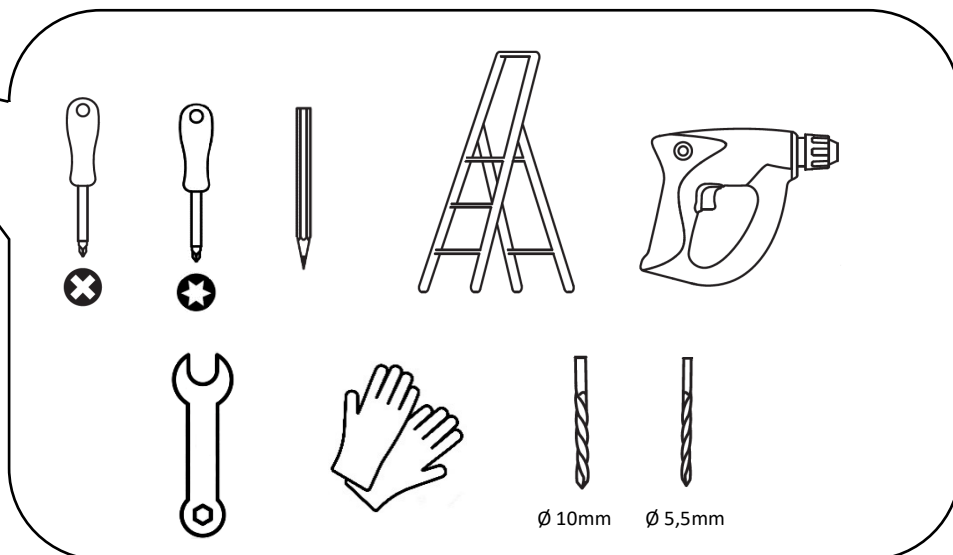

1 X

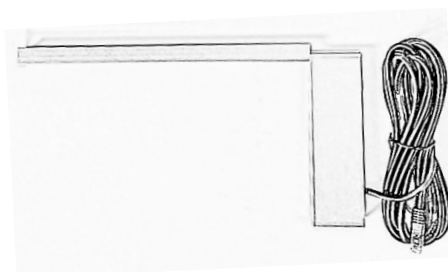

1 X



1 X

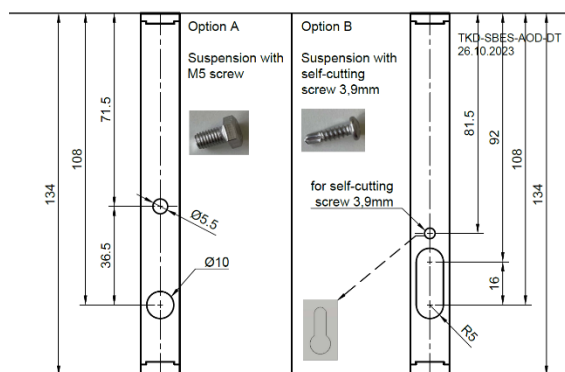

1 X

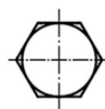

M5x8

1 X



3,9x13

1 X

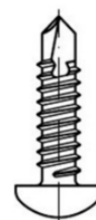

10 (Form A)

2 X

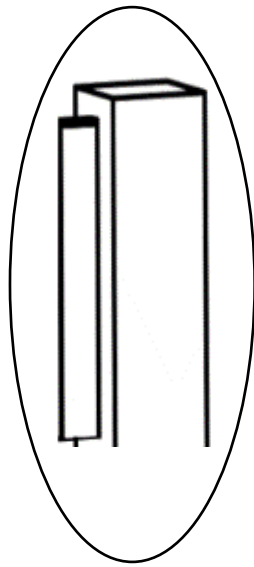

right

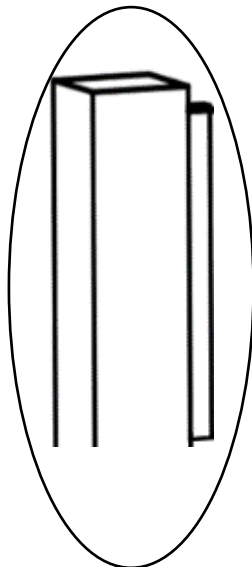

left

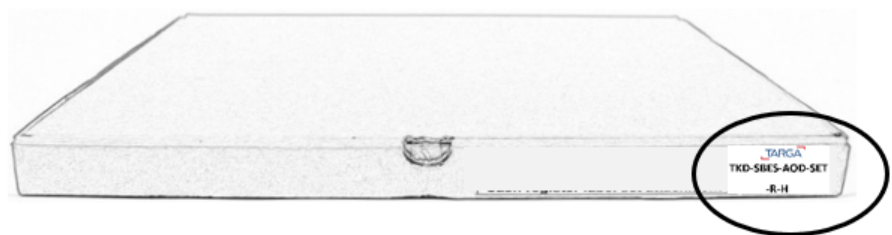
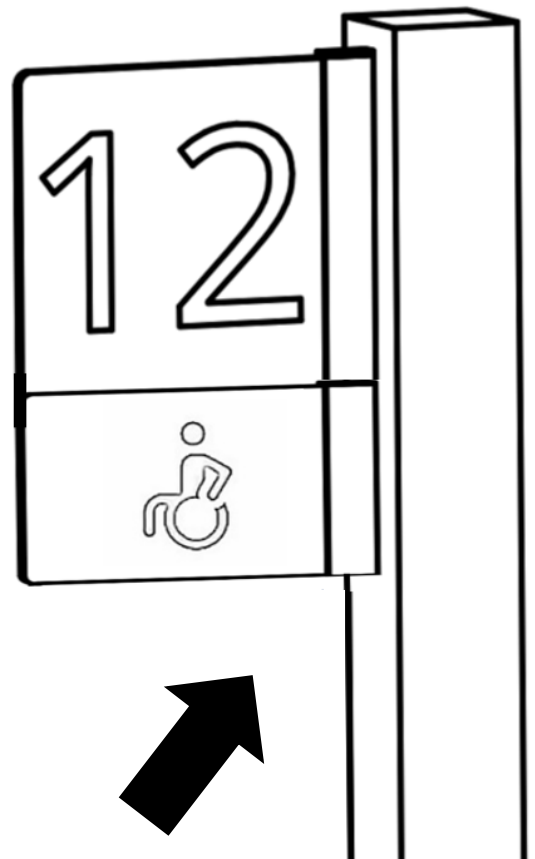

Credits/Reference:* Image:
Flaticon.com'. This cover was
created using resources from
Flaticon.com.

1

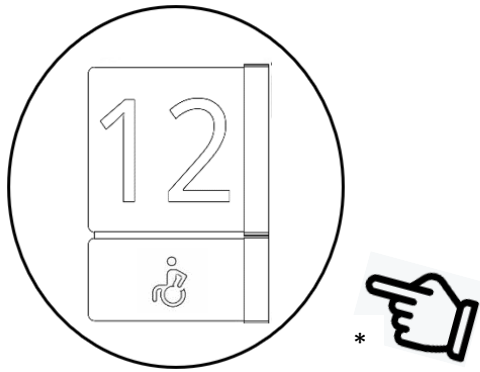

Credits/Reference:* Image: Flaticon.com. This cover was created using resources from Flaticon.com.

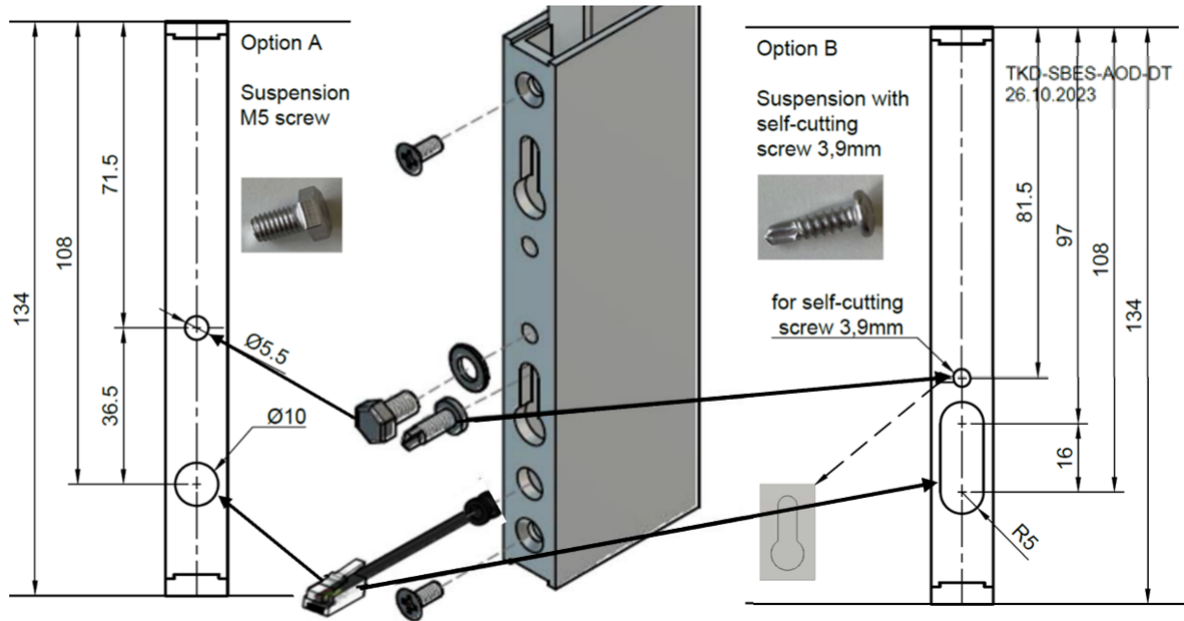

2

Option A

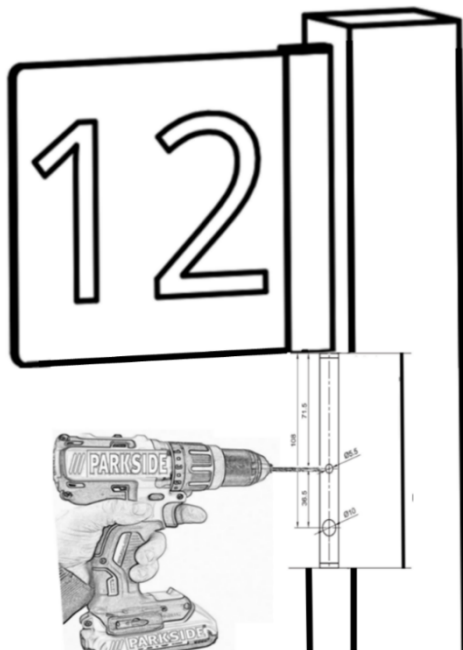

Option B

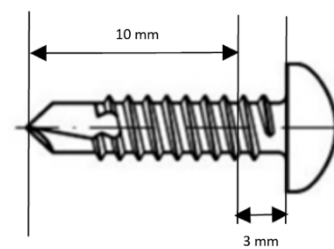

3.9 x 13 mm Self-tapping screw

screw in 10mm

3 mm distance +- 0,05 mm manual fine adjustment

3

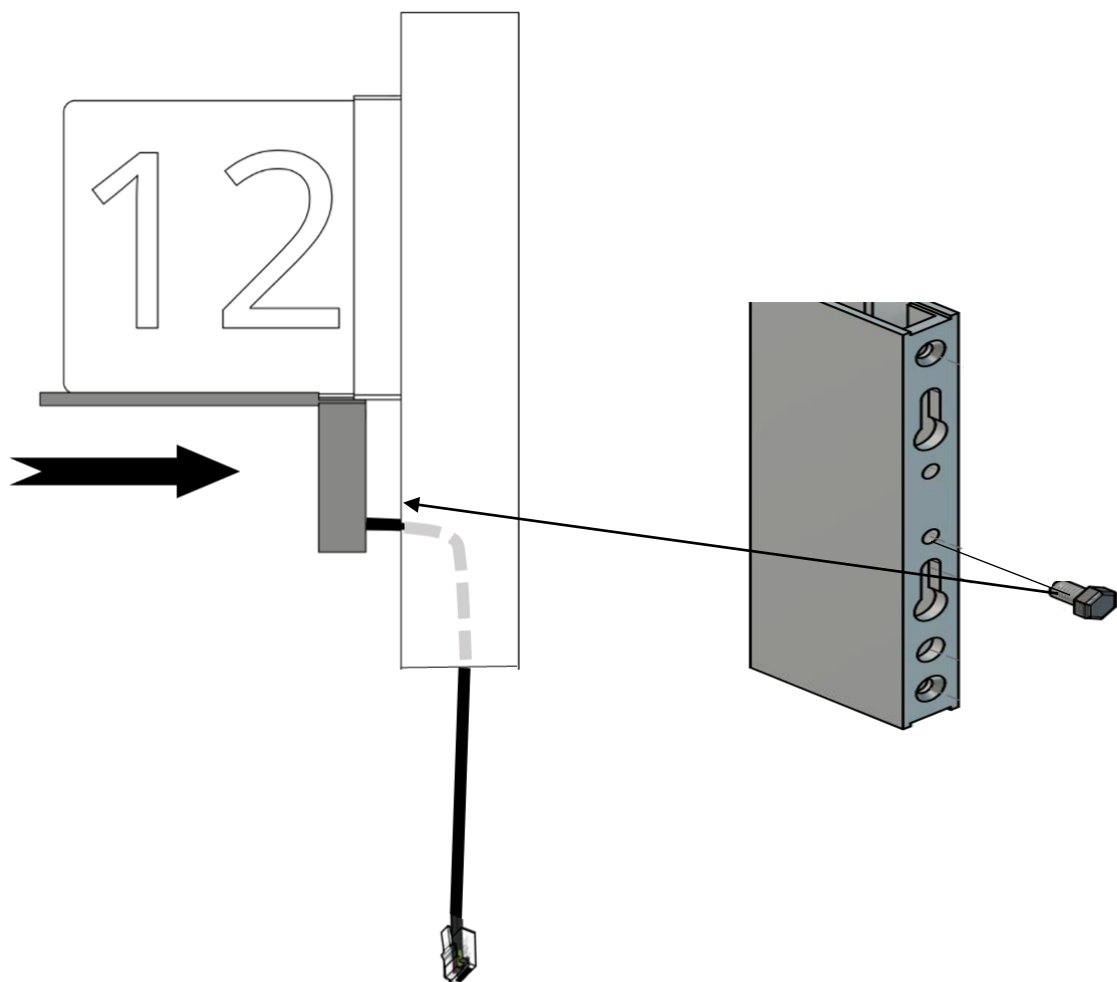

4

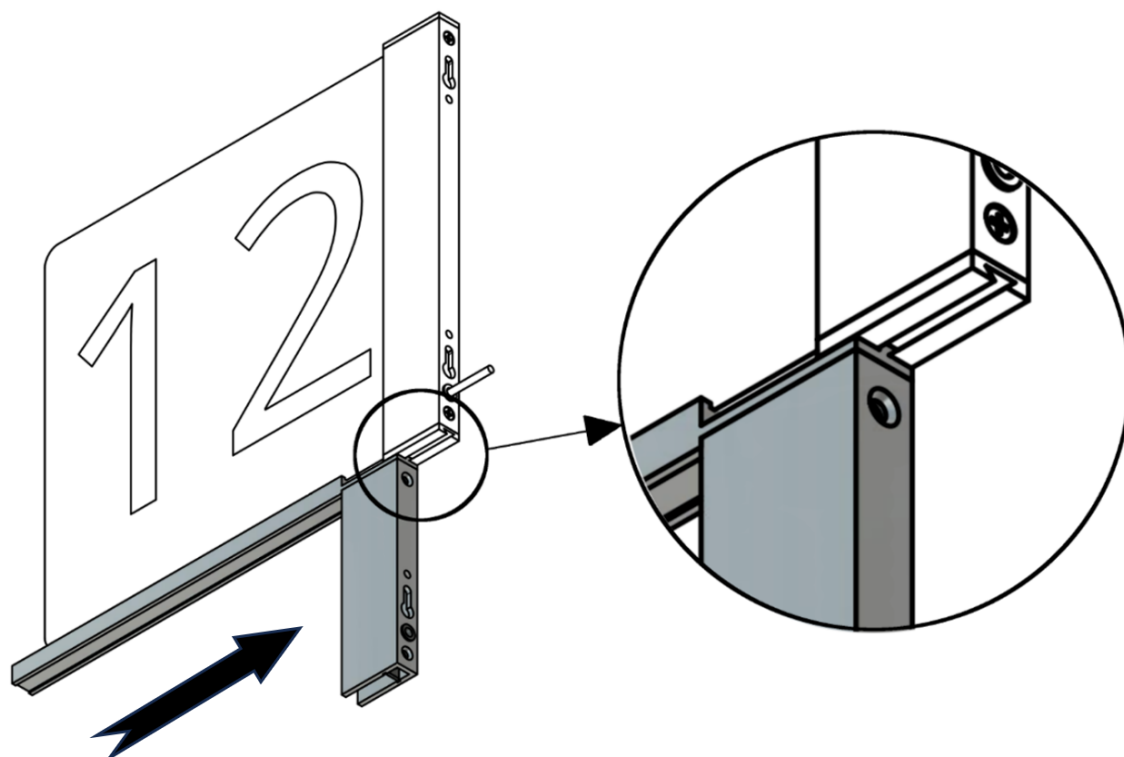

5

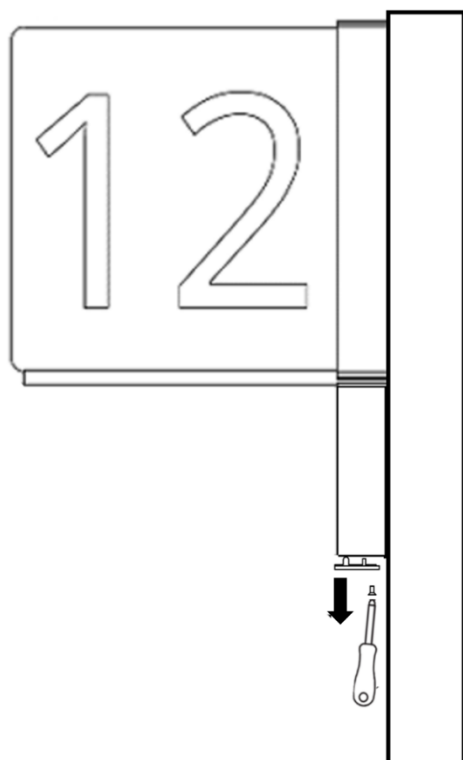

6

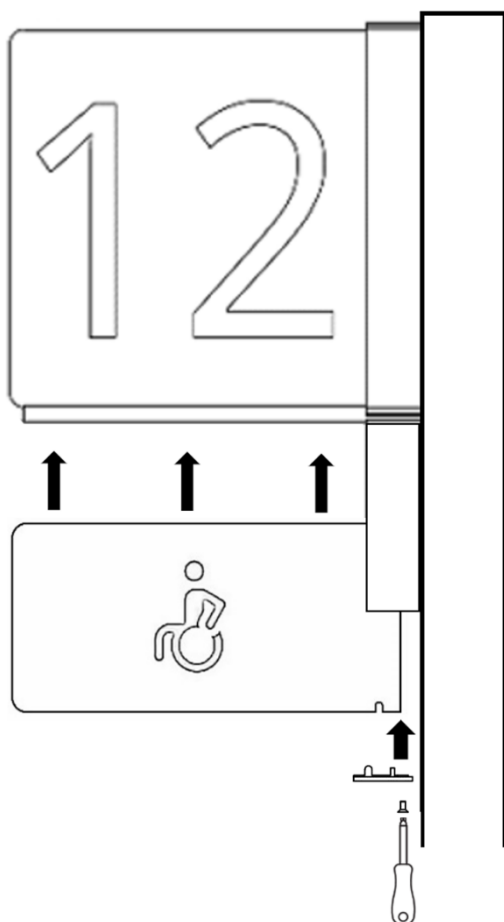

7

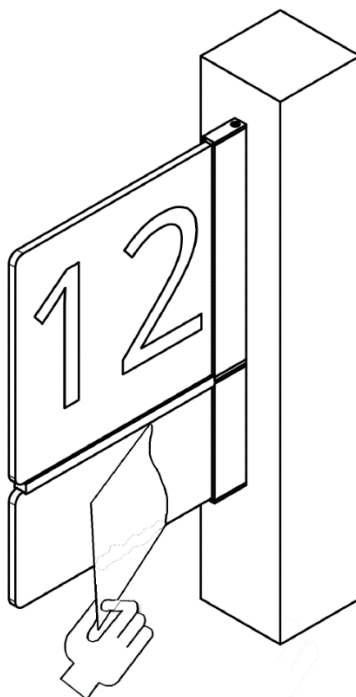

Optional: Reinigung Acryl - Glas / Cleaning Acryl - Glas

8

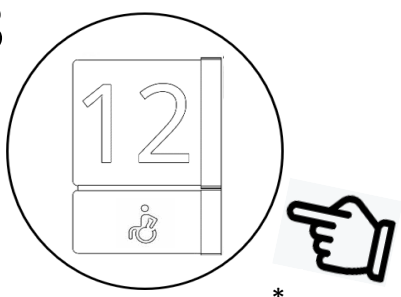

*

Credits/Reference: * Image: Flaticon.com'. This cover was created using resources from Flaticon.com.

Handlungsanweisung Acryl – Glas / General Handling Instruction Acryl Glas

Deutsch	English
Acrylglas sollten Sie niemals trocken abwischen. Dadurch können Kratzer an der Oberfläche entstehen. Außerdem lädt sich die Acryl - Platte elektrostatisch auf und zieht Staub an.	Acrylic glass should never be wiped dry. This may cause scratches on the surface. Also, the acrylic - sheet becomes electrostatically charged and attracts dust.
Das Mikrofasertuch sollte frei von jedweder Verschmutzung sein.	The microfiber cloth should be free of any dirt.

Die Reinigung der Fläche sollte immer mit einem nebelfeuchtem Mikrofasertuch erfolgen.	However, the surface should always be cleaned with a damp microfiber cloth.
Erst senkrecht wischen, dann waagerecht. Keine kreisenden Bewegungen.	First wipe vertically, then horizontally. No circular movements
Restfeuchte zwecks Antistatik-Filmbildung abtrocknen lassen. Nicht nachreiben!	Allow residual moisture to dry off to form an antistatic film. Do not rub!

Technical Specification

Description	Dimension /(Quantity)	Material	Weight [g]
Profile	142x40x14,5mm	Aluminum	260,3
Display	272x125x8mm	PMMA	325,0
Input	Power/ Amperage	Cable	Plug
24V $\overline{---}$ PS2 according to EN 62368-1	$\leq 1,5W/62mA$	AWM Style 20276/4m	RJ10 4P4C

Plug:

Description: 24V LED connector (RJ10 4P4C)

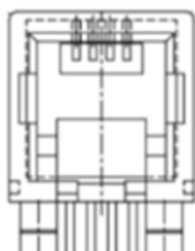

Pin Signal 4m cable wire color

- 1 LED_B blue and white
- 2 LED_R blue
- 3 LED_G orange-white
- 4 24 orange

Cash register sign:

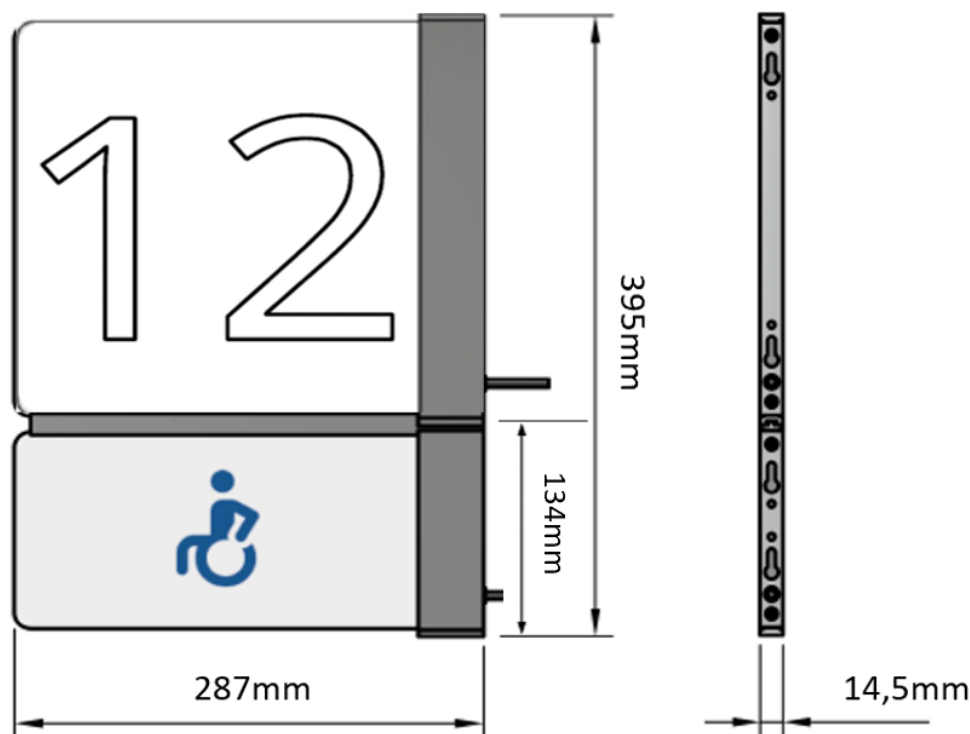

Product marking:

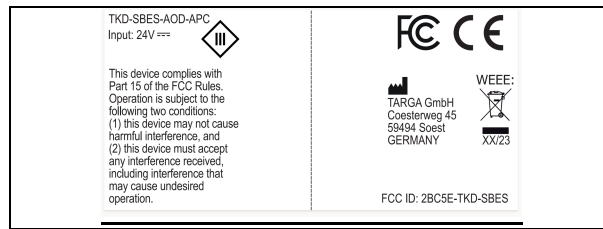

Attachment FCC HINTS

FCC hints

This device complies with Part 15 of the FCC Rules. Operation is subject to the following two conditions: (1) this device may not cause harmful interference, and (2) this device must accept any interference received, including interference that may cause undesired operation.

Changes or modifications to this unit not expressly approved by the party responsible for compliance could void the user's authority to operate the equipment.

This equipment has been tested and found to comply with the limits for a Class B digital device, pursuant to Part 15 of the FCC Rules. These limits are designed to provide reasonable protection against harmful interference in a residential installation. This equipment generates, uses and can radiate radio frequency energy and, if not installed and used in accordance with the instructions, may cause harmful interference to radio communications. However, there is no guarantee that interference will not occur in a particular installation. If this equipment does cause harmful interference to radio or television reception, which can be determined by turning the equipment off and on, the user is encouraged to try to correct the interference by one or more of the following measures:

- Reorient or relocate the receiving antenna.
- Increase the separation between the equipment and receiver.
- Connect the equipment into an outlet on a circuit different from that to which the receiver is connected.
- Consult the dealer or an experienced radio/ TV technician for help.



EU KONFORMITÄTSERKLÄRUNG EU-declaration of conformity

Nummer: 2010SBG-LAM_LED
Number:
Name des Ausstellers: Targa GmbH
Issuer's name:
Anschrift des Ausstellers: Coesterweg 45, 59494 Soest, Germany
Issuer's address:
Gegenstand der Erklärung: LED Kassendisplay / LED Display for cash register
Object of the declaration: TKD-SBES-MD-APC
TKD-SBES-AOD-APC

Das oben beschriebene Produkt erfüllt die einschlägigen Harmonisierungsvorschriften der Union:
The object of the declaration described above is in conformity with the relevant Union harmonisation legislation:

Richtlinien (Directives)	
Dokument-Nr. (Documents No.)	Titel (Title)
2014/30/EU	EMV Richtlinie / EMC Directive
2011/65/EU	RoHS-Richtlinie / RoHS-Directive
Normen (Standards)	
2014/30/EU	EN 61000-6-2:2005 EN 61000-6-3:2007+A1:2011+AC:2012
2011/65/EU	EN IEC 63000
Sonstiges others	IEC 62368-1:2014 (Second Edition) IEC TR 62778:2014 (Second Edition)
Verordnungen (Commission Regulations)	
Not applicable	

Mitgeliefertes Zubehör: Reinigungstuch, Schrauben
Supplied accessories: cleaning cloth, screws

(Ort und Datum der Ausstellung) Soest, 08.09.2023
(Place and date of issue)

Matthias Klauke, Managing Director

(Name, Funktion) (Unterschrift oder Äquivalent, autorisiert durch den Aussteller)
(Name, function) (Signature or equivalent authorized by the issuer)

Die alleinige Verantwortung für die Ausstellung dieser Konformitätserklärung trägt der Hersteller.
(This declaration of conformity is issued under the sole responsibility of the manufacturer.)



Declaration of conformity

Number: 2010SBG-LAM_LED
Issuer's name: Targa GmbH
Issuer's address: Coesterweg 45, 59494 Soest, Germany
Object of the declaration: LED Display for cash register
TKD-SBES-MD-APC
TKD-SBES-AOD-APC

The object of the declaration described above is in conformity with the relevant Union harmonisation legislation:

Directives	
Electromagnetic Compatibility Regulations 2016	
The Restriction of the Use of Certain Hazardous Substances in Electrical and Electronic Equipment Regulations 2012	
Standards	
EMC	EN 61000-6-2:2005 EN 61000-6-3:2007+A1:2011+AC:2012
RoHS	EN IEC 63000
Others	IEC 62368-1:2014 (Second Edition) IEC TR 62778:2014 (Second Edition)

Supplied accessories: cleaning cloth, screws

(Place and date of issue) Soest, 08.09.2023

Matthias Klauke, Managing Director

(Name, function) (Signature or equivalent authorized by the issuer)

(This declaration of conformity is issued under the sole responsibility of the manufacturer.)