

Jouncito Wireless Speaker

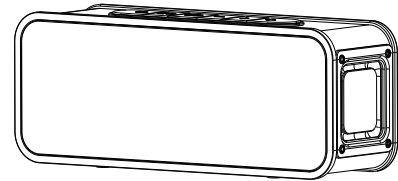

User Manual

What's in the box

1



Wireless Speaker 1pcs



User manual 1pcs



charging cable 1pcs

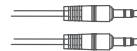

Audio cable 1pcs

Key functions

2

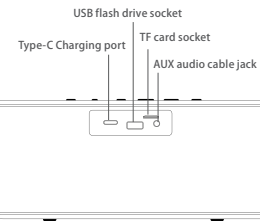
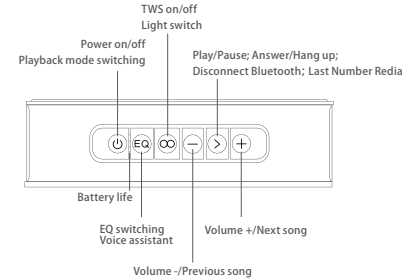

Functions Description

3

Button	Operating	Function Description
	Single press	Switch: BT, TF card, U disk, AUX playback mode
	Long press	a. Press and hold for 2 seconds to power on/off
	Single press	Toggles the EQ sound effects Noight:Pop Red light:Bass mold White light:Surround sound
	Hold 2s	Voice assistant(Siri for apple)
	Single press	Enable/Disable TWS
	Hold 2s	Light switch (4 molds)
	Single press	Volume--
	Long press	Previous song
	Single press	a. When the music is playing: single press the play/pause function; b. When the call is incoming: single press to connect the call; c. When a call has been answered: single press to hang up the call;
	Long press	Press and hold for 2 seconds to disconnect the Bluetooth connection
	Double-click	In Bluetooth, double-tap the end number to redial it
	Single press	Volume +
	Long press	Next song

Bluetooth Connection

4

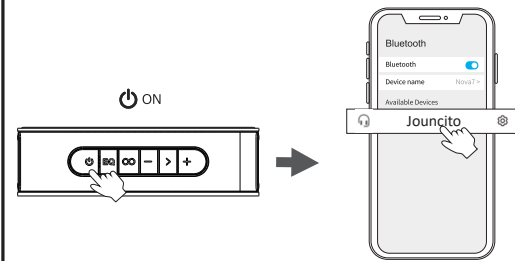

1. Turn on the speaker,
you will hear the prompt tone

2. After open the phone
Bluetooth, Click the "Jouncito"
to pairing

Notes:

1.If it is not paired for 30 minutes after booting, it will shut down.
When low battery,you can hear the prompt tone then the speaker will power off automatically

2.If Apple users feel that the volume is low, you can turn off this setting on the phone(Settings-Sounds & Haptics-Headphone Safety-Reduce Loud Sounds)

Specifications

5

Specifications

Speaker Type	wireless speaker
Speaker system	Stereo
Dimensions	260*75*100mm
Weight	1.4kg
Driver	φ66mm 15W*2
Audio Playtime	Approx 13 hours(@50-60% Volume)
BT Version	V5.3
Rated Power	30 Watts
Battery	7.2V 2600mAh
Charging Time	Approx 3 hours(USB C)
Frequency Response	100-20KHZ
Range	up to 10m
Input power:	DC 5V/2.5A
Built-in Microphone	

KIND REMINDER

- When the machine has not been used for more than 3 months, the machine needs to be charged before use;
- When not in use for a long time, it is recommended to charge the machine once every 3 months, which can more effectively protect the battery;
- It is recommended to use the machine after it is fully charged.

Safety Instructions

6

- Keep the product away from extremely hot and cold environments, it will damage the battery and circuit.
- Avoid liquid immersion into the product.
- Do not disassemble the product.
- Do not use concentrated chemical products or detergents to clean the product.
- Use only 5V/**2.5** A power supply. Connecting the power supply voltage too high may cause serious damage.
- Do not randomly discard or place the product near fire or high temperature to avoid the danger of explosion.

FCC statement

7

This device complies with part 15 of the FCC Rules. Operation is subject to the following two conditions: (1) this device may not cause harmful interference, and (2) this device must accept any interference received, including interference that may cause undesired operation.

Any changes or modifications not expressly approved by the party responsible for compliance could void the user's authority to operate the equipment.

NOTE: This equipment has been tested and found to comply with the limits for a Class B digital device, pursuant to Part 15 of the FCC Rules. These limits are designed to provide reasonable protection against harmful interference in a residential installation. This equipment generates, uses and can radiate radio frequency energy and, if not installed and used in accordance with the instructions, may cause harmful interference to radio communications. However, there is no guarantee that interference will not occur in a particular installation. If this equipment does cause harmful interference to radio or television reception, which can be determined by turning the equipment off and on, the user is encouraged to try to correct the interference by one or more of the following measures:

- Reorient or relocate the receiving antenna.
 - Increase the separation between the equipment and receiver.
 - Connect the equipment into an outlet on a circuit different from that to which the receiver is connected.
 - Consult the dealer or an experienced radio/TV technician for help.
- The device has been evaluated to meet general RF exposure requirement. The device can be used in portable exposure condition without restriction