

双面印刷

120mm

80mm

Magnetic Wireless Charger Manual

Specifications

Wireless Charger With Inner 5000mAh Battery
FCC-ID: 2BBZC-CX-M001
Battery Capacity: 5000mAh 3.8V/19.0 Wh
Wireless Output: 5W/7.5W 10W
Input: AC100-240V 50/60Hz 13.1W Max
Rated Battery Capacity: 3250mAh

Instruction

1.Place the phone that needs to be charged on the side of the magnetic wireless charger with a circle and lightning sign, press the switch button located on the side to start charging the phone.

2.When the battery level is below 50%, the blue light near the red light remains on. When the battery level is above 50%, the blue light away from the red light remains on. When charging the phone, the red light remains on. When charging the battery, the blue lights flash.

Product Component Introduction

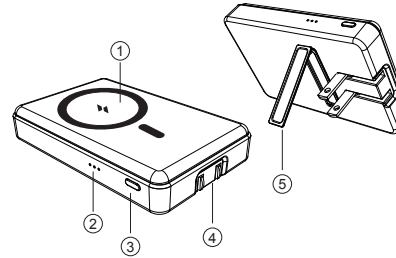

- ① Magnetic Wireless Charging Output
- ② Power Indicator
- ③ Power Button
- ④ Plug
- ⑤ Foldable Kickstand

FCC statement:

This device complies with Part 15 of the FCC rules. Operation is subject to the following two conditions: 1) this device may not cause harmful interference, and 2) this device must accept any interference received, including interference that may cause undesired operation.

Note: This equipment has been tested and found to comply with the limits for a Class B digital device, pursuant to part 15 of the FCC Rules. These limits are designed to provide reasonable protection against harmful interference in a residential installation.

This equipment generates uses and can radiate radio frequency energy and, if not installed and used in accordance with the instructions, may cause harmful interference to radio communications. However, there is no guarantee that interference will not occur in particular installation. If this equipment does cause harmful interference to radio or television reception, which can be determined by turning the equipment off and on, the user is encouraged to try to correct the interference by one or more of the following measures:

--Reorient or relocate the receiving antenna.
--Increase the separation between the equipment and receiver.

--Connect the equipment into an outlet on a circuit different from that to which the receiver is connected.
--Consult the dealer or an experienced radio/TV technician for help.

Changes or modifications not expressly approved by the party responsible for compliance could void the user's authority to operate the equipment.

Radiation Exposure Statement

This device complies with FCC RF radiation exposure limits set forth for an uncontrolled environment. This transmitter must not be co-located or operating in conjunction with any other antenna or transmitter. During the operation of device a distance of 15 cm surrounding the device and 20 cm above the top surface of the device must be respected.