

**SMART WIRELESS  
MEAT THERMOMETER**

**USER MANUAL**



# FIRST TIME SETUP

1. Open the App Store search and download the "Meat S" app, and you can also find the instructions in the top left corner of the App.



2. Place the probe on the charger, insert a new AAA battery, and click the button to activate the booster. Charge for at least 4 hours before the first use.

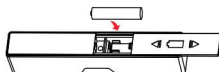

### 3. Use the Meat S app:

First, activate the probe and press the charger button.

Second, Activate the relay, take out the probe, and press and hold the relay for 3 seconds to match. After success, the top of the APP interface will display "connected", and the green light of the relay will flash.

Third, choose the type of barbecue and cooking method or manually set the target temperature.

Fourth, the app monitors the internal temperature of the meat in real time and sends a notification to your smart device.

Fifth, enjoy the delicious food.

**After the device is dormant, the relay must be activated before each use.**

4. You can now remove the probe from the booster, insert it fully into the meat, and place the meat in the oven.



When the probe is fully charged, the indicator light goes off.

5. After enjoying the roast, let the probe cool down and wash the probe, and then put it back in the booster, which automatically closes when it is not in use.

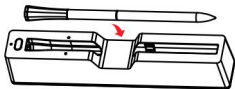

6. The probe placed in the booster will automatically charge to prepare for the next use.

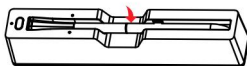



## CAUTION



Stainless steel probes can withstand up to 185°F/85°C temperature, while the ceramic handle can withstands temperatures up to 527°F/275°C.



**Above these temperatures may damage this probe.**

The probe automatically shuts off after 30 minutes if not in a heat source.



Insert the probe fully into the meat, this allows the probe to withstand the heat.



Do not use probe when cooking over high heat or over hot coals/flame.



Do not use the probe in a microwave or pressure cooker.



The probe can become very hot during and after use. Wear heat-resistant gloves when handling the probe.



Probes can be put into the dishwasher. During cooking, fry in a deep fat fryer without damage.

**Do not soak it in water when unused.**

# PROBE & BOOSTER

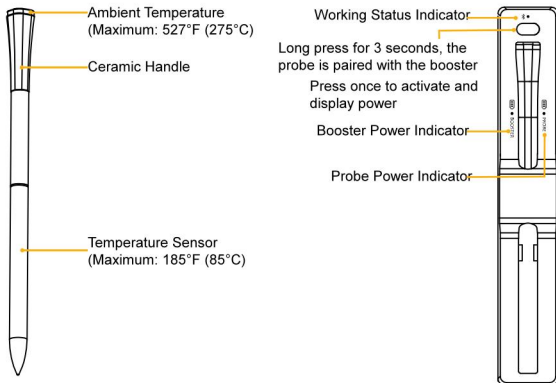

The probe can be used for more than 24 hours after full charge.

# INDICATOR LIGHT

Device Status	Status Meaning
Working Status Indicator	<p>The green light flashes, indicating that the device is connected.</p> <p>The red light flashes, indicating that the probe is disconnected from the booster.</p> <p>Alternately flashing red and blue lights indicate it is pairing and connecting.</p> <p>he connection status red light flashes, indicating that the probe is being searched.</p> <p>A flashing blue light indicates that the probe is connected.</p> <p>When the light is off, the device is in sleep mode or the battery is low.</p>
Booster Power Indicator	<p>Green light flashes, indicating sufficient power.</p> <p>Flashing red light indicates low battery.</p>
Probe Power Indicator	<p>Green light flashes, indicating sufficient power.</p> <p>Flashing red light indicates low battery.</p>
hibernation/shutdown state	<p>In shutdown state, press the relay button to activate the relay and probe</p> <p>Connected state, put the probe into the relay to charge, the relay sleeps and shuts down</p> <p>In working state, keep the temperature below 50°C, the relay and probe will sleep and shut down within 30 minutes</p> <p>Disconnected state, the probe and relay are disconnected, sleep and shut down within 5 minutes</p>



This device complies with part 15 of the FCC Rules. Operation is subject to the following two conditions: (1) this device may not cause harmful interference, and (2) this device must accept any interference received, including interference that may cause undesired operation.

Any changes or modifications not expressly approved by the party responsible for compliance could void the user's authority to operate the equipment.

NOTE: This equipment has been tested and found to comply with the limits for a Class B digital device, pursuant to Part 15 of the FCC Rules. These limits are designed to provide reasonable protection against harmful interference in a residential installation. This equipment generates, uses and can radiate radio frequency energy and, if not installed and used in accordance with the instructions, may cause harmful interference to radio communications. However, there is no guarantee that interference will not occur in a particular installation.

If this equipment does cause harmful interference to radio or television reception,

which can be determined by turning the equipment off and on, the user is encouraged to try to correct the interference by one or more of the following measures:

- Reorient or relocate the receiving antenna.
- Increase the separation between the equipment and receiver.
- Connect the equipment into an outlet on a circuit different from that to which the receiver is connected.
- Consult the dealer or an experienced radio/TV technician for help.

The device has been evaluated to meet general RF exposure requirement. The device can be used in portable exposure condition without restriction