

Wireless Microphone

User Manual



Made in China

Introduction

Thanks for choosing our product.  
This product is a smart wireless microphone that provides professional-grade recording output.Plug and play, no app required.  
Multiple uses: It can be used in online live broadcast video Vlog shooting, program interview, recording, video teaching and other occasions.  
The wireless Microphone consists of two parts, one is Microphone Transmitter,the other one is receiver. (See as below picture)  
\*Some mobile phone apps do not support external microphones, which will cause silent recording. In this case, please replace the app and continue to use the product.

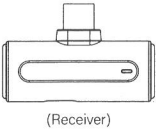
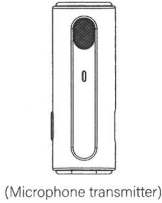

ID Diagram

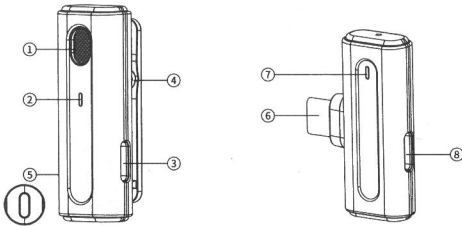

- ① Windproof net
- ② Microphone indicator
- ③ Microphone charging port
- ④ Microphone clip
- ⑤ Switch key
- ⑥ Mobile interface
- ⑦ Receiver indicator
- ⑧ The port of receiver

\*The microphone is equipped with a built-in battery, which can be used only after being charged.  
The power of the receiver is supplied by phone (⑧)The port is for phone charging )

How to use

Step 1: Connect the receiver to the phone interface.  
Step 2: Press switch key of microphone, the indicator light turns green, and then power is turned on.  
Step 3: After successful automatic pairing, the green light at the receiving end is always on and the green light at the transmitting end is always on. Then open the phone camera,live App or other Apps,and then to use the microphone to receive sound.

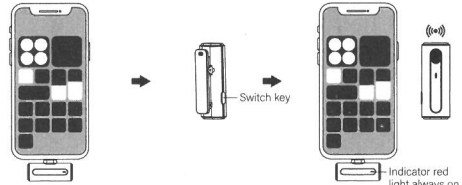

\*Connect receiver to phone  
\*Press microphone switch key  
\*Use microphone  
Note: oppo / vivo / iqoo / realm brand mobile phones can be used normally only when they go to the settings (search "OTG" - turn on OTG power supply)

About UI

Microphone Transmitter		
Function	Button	LED
Power on	Button 3S startup	blinking alternately red and green
Power off	Press 3S shutdown	All the lights went out
Unconnected		blinking alternately red and green
Connected		Green light always on
Switch the noise reduction level	Press the key to switch cycle up to 3levels,yclic in turn.	Level1 the green light blinks once Level2 the green light blinks twice Level3 the green light blinks 3 times Note: Each time you switch to the next level, it gradually increases the noise reduction level before the next switch off
Reverberation	Press the button three times to turn on or off the reverb function	The green and red lights blink once then the green light is always on
Silent mode	Press the twice to turn on or off the mute function	The green light blinks
Charging		Red light is always on
Fully charged		All the lights went out
Low battery		The light blinks every 10se

Receiver		
Function		LED
Power on	Automatically power on after plugging in the mobile phone port	The light blinks
Power off	Automatic shutdown after unplugging	
Unconnected		The light blinks
Connected		light is always on

Packing List

- Content of packing
- (1) Microphone transmitter
  - (2) Receiver
  - (3) Charging line
  - (4) User manual
  - (5) Storage box

**FCC Warning:**

This equipment has been tested and found to comply with the limits for a Class B digital device, pursuant to part 15 of the FCC Rules. These limits are designed to provide reasonable protection against harmful interference in a residential installation. This equipment generates, uses and can radiate radio frequency energy and, if not installed and used in accordance with the instructions, may cause harmful interference to radio communications. However, there is no guarantee that interference will not occur in a particular installation. If this equipment does cause harmful interference to radio or television reception, which can be determined by turning the equipment off and on, the user is encouraged to try to correct the interference by one or more of the following measures:

- Reorient or relocate the receiving antenna.
- Increase the separation between the equipment and receiver.
- Connect the equipment into an outlet on a circuit different from that to which the receiver is connected.
- Consult the dealer or an experienced radio/TV technician for help.

**Caution:** Any changes or modifications to this device not explicitly approved by manufacturer could void your authority to operate this equipment.

This device complies with part 15 of the FCC Rules. Operation is subject to the following two conditions:

(1) This device may not cause harmful interference, and (2) this device must accept any interference received, including interference that may cause undesired operation.

This equipment complies with FCC radiation exposure limits set forth for an uncontrolled environment. This equipment should be installed and operated with minimum distance 0cm between the radiator and your body.