



Intelligent car display screen
CL797

1. Safety Guidelines

1.1 Warnings

- Do not operate this product while driving.
- Do not install or operate this product with wet hands.
- Do not install this product in a place with high temperature, humidity, flammable, explosive gas or liquid.
- Do not install this product in an area that interferes with the driver's sight or driving safety.
- Do not install this product on the airbag cover or within the working range of the airbag.
- Do not leave this product in a closed vehicle with high temperature for a long time.
- Do not operate this product over rated voltage.
- Do not use non-original cables and accessories.
- Do not use sharp objects such as awls or scissors to cut this product and its accessories.
- Do not disassemble, repair or modify this product and accessories by yourself.
- Do not install, use or place this product within the reach of children under 16 years of age.

1.2 Precautions

- Do not press the lens too hard to avoid damage or dislocation of the lens.
- Do not directly touch the lens surface, so as not to affect the recording effect.
- Do not remove the memory card during the shutdown process to avoid file damage.
- When using the memory card for the first time, please format it on this product to ensure stable reading and writing.
- When not using the product for a long time, please pull out the memory card to ensure the performance of the memory card.

Scan the QR code, select the corresponding model, and view the User Manual.

<https://spedal.cc/html/support/download/navicam.html>

For any questions please contact support@spedaltech.com



2. User Guide

2.1 Package List

◆ Device



◆ Suction Bracket



◆ Power Cable



◆ Audio Cable



◆ Dashboard Pad Mounting Disk



◆ Quick Guide



◆ Camera(Optional)



◆ Camera Cable(Optional)



◆ USB Type-C Cable(Optional)



◆ TF Card(Optional)



Note

Do not use cables and components that are not original. Gifts and accessories are not covered under warranty. The package contents of this product may change without prior notice, and the actual contents of the package shall prevail.

2.2 Product Introduction

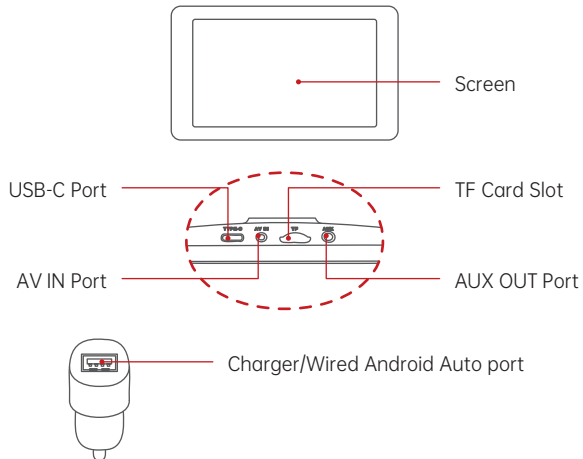

2.3 Suction Bracket Installation

1. Align the suction bracket clips with the holes on the back of the device and push them up to secure the bracket.
2. Thoroughly clean and dry the car dashboard surface, remove dust or debris, and make sure the surface is flat.
3. Remove the 3M adhesive release paper from the dashboard pad mounting disk and adhere it to a clean instrument panel surface.
4. Allow to sit for 3 hours or more to ensure a strong bond. Then remove the protective film from the dashboard pad.
5. Tear off the protective film from the suction bracket, place the suction cups firmly in the center of the dashboard pad mounting disk, and press the lock button.
6. Adjust the angle of the device screen.

Note

The installation position of equipment and brackets should not block the driver's sight and affect driving safety.

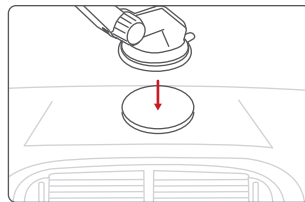
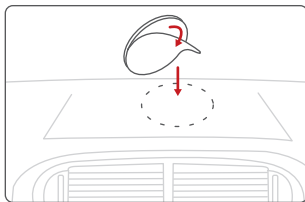

2.4 TF Card Installation(Optional)

- Insert the TF card into the TF card slot.
- The self-provided TF card should meet the following requirements: Class 10 or above, the capacity does not exceed 128GB.

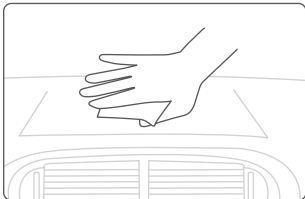
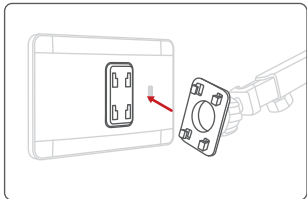
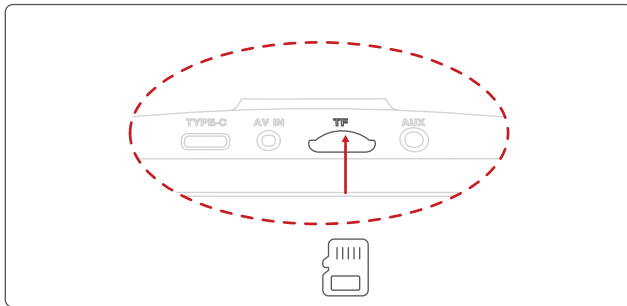

2.5 Device Installation

Insert the power cable into the car cigarette lighter, and connect the other end to the power interface of the device.

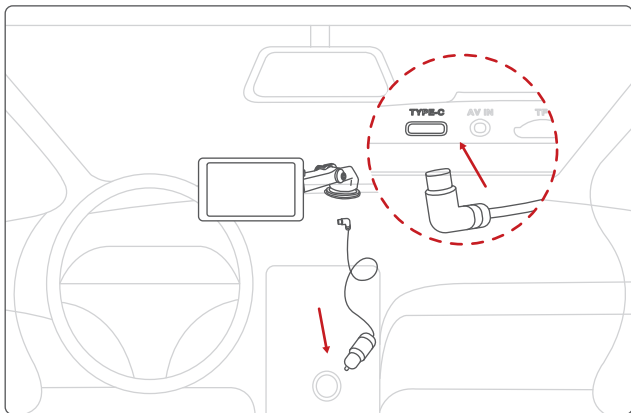

Note

Depending on the vehicle, the cigarette lighter socket may be located in a different position. The figure provided is for reference only.

2.6 Camera Installation(Optional)

2.6.1 Windshield

1. Thread the camera's wire through the hole on the adhesive bracket, and secure the camera tightly to the bracket.
2. Peel off the protective film from the adhesive bracket, and attach the bracket to the vehicle's front windshield. Press firmly to ensure it adheres securely.
3. Use the camera extension cable to connect the camera to the device.
4. Adjust the angle of the lens.

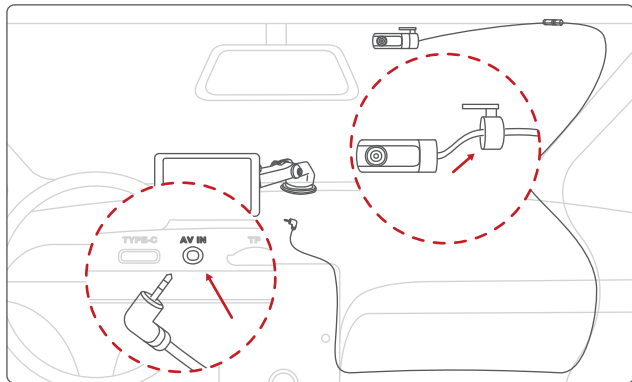

2.6.2 Rear Windshield

1. Thread the camera's wire through the hole on the adhesive bracket, and following the direction of the arrow, tighten and rotate the bracket with the camera, ensuring they are securely fastened together.
2. Peel off the protective film from the adhesive bracket, and attach the bracket to the vehicle's rear windshield. Press firmly to ensure it adheres securely.
3. Use the camera extension cable to connect the camera to the device.
4. Adjust the angle of the lens.

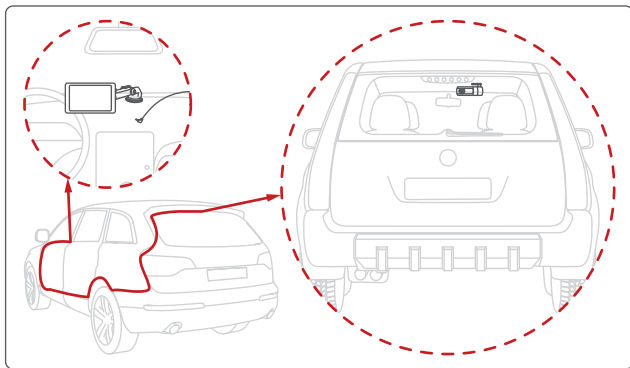

2.6.3 Headrest Support Rod

1. Thread the camera's wire through the two wire holes on the support pole bracket.
2. Following the direction of the arrow, tighten and rotate the bracket with the camera, ensuring they are securely fastened together.
3. Attach the bracket to the headrest support pole.
4. Secure the bracket using the screws provided in the accessories.
5. Use the camera extension cable to connect the camera to the device.
6. Adjust the angle of the lens.

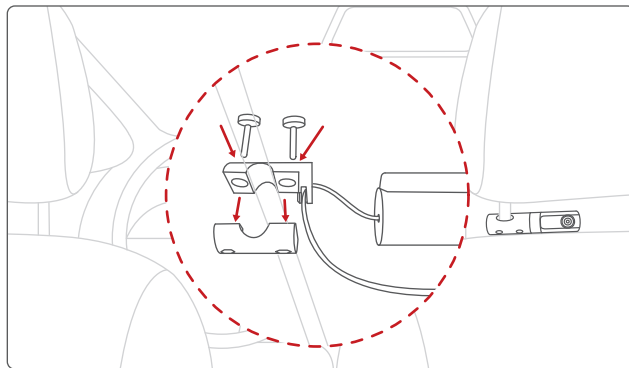

3. Features And Settings

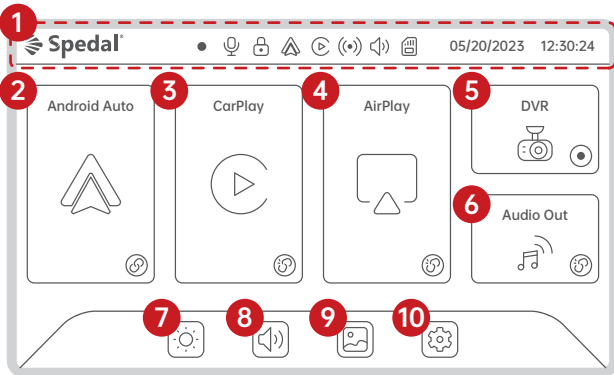

3.1 Home Screen



●	Recording Status	● Red Flash: Recording On
🎤	Video Sound Status	🎤 Recording 🎤 Mute
🔒	Video Lock Status	🔒 Lock 🔒 Unlock
📶	Android Auto Status	📶 Green: Connected
📶	CarPlay Status	📶 Green: Connected
📶	FM Status	📶 Green: Connected
🔊	Speaker Status	🔊 On 🔊 Off
💾	TF Card Status	💾 Normal 💾 Not Inserted
05/20/2023	System date	
12:30:24	System time	



2

**Android Auto**

-  Android Auto not connected.
-  Android Auto connected to the device.

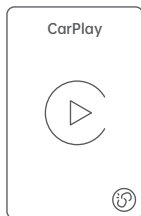

3

**Apple CarPlay**

-  Apple CarPlay not connected.
-  Apple CarPlay connected to the device.

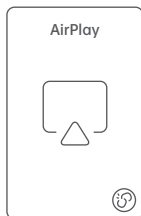

4

**Apple AirPlay**

-  Apple AirPlay not connected.
-  Apple AirPlay connected to the device.

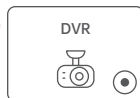



5

**DVR**

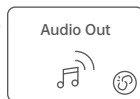
-  Recording On.
-  Recording Off.

6

**Audio Out**

-  Sound plays from the device built-in speaker.
-  Sound plays from the car via Bluetooth connection.
-  Sound plays from the car via AUX connection.
-  Sound plays from the car via FM Transmitter.

7

**Brightness adjustment**

Adjust the screen brightness.

8

**Volume adjustment**

Adjust the system volume.

9

**Playback**

View photos and videos.

10

**Settings**

System settings and Video settings.

3.2 Apple CarPlay

3.2.1 Apple CarPlay Wireless Connection

Note

The iPhone version that supports wireless CarPlay requires the following:

- iPhone is running iOS 9 or higher. (such as iPhone XR and above; iPhone 11 and above; iPhone SE (second generation) and above, etc.)
- It also requires the CarPlay system and the iPhone's voice system to be turned on. Please check if Siri is enabled.
- When using wireless CarPlay for the first time, the connection time may take around 30 seconds, please be patient.

For more details visit: <http://www.apple.com/ios/carplay>

Click "  " on the home screen to enter the CarPlay.

- 1 Go to Settings on your iPhone, turn on "Wi-Fi" and "Bluetooth".
- 2 Enter the "Bluetooth" menu and select the Bluetooth device starting with "Spedal-*****" from the list of "OTHER DEVICES" Bluetooth devices.
- 3 Wait for about 20-30 seconds, and a prompt "Bluetooth Pairing Request" will pop up on your phone. Select "Pair" to successfully pair your phone with the device.

- 4 Then, a prompt "Use CarPlay with "NaviCam"?" will pop up on your phone. Select "Use CarPlay".
- 5 Please wait for a moment and you will enter the CarPlay mode.

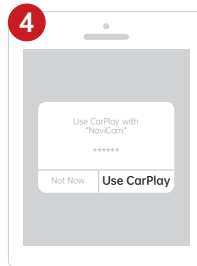
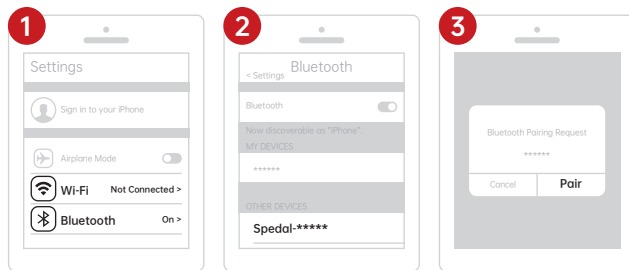

Note

- Different versions of iOS may display differently, please refer to the actual situation.
- The first connection may take a longer time, please be patient.
- If you want to switch to Android Auto or AirPlay, you need to turn off Bluetooth and Wi-Fi on your phone to disconnect the Apple CarPlay connection mode.

3.2.2 Apple CarPlay Audio Out

Click "🎵" on the home screen to enter the Audio Out.



1. Built-in Speaker

The sound is played from the speaker of the device.



2. Bluetooth

In CarPlay mode, the phone is directly connected to the car's Bluetooth (if the phone has been paired with the car's Bluetooth before, there is no need to repeat the connection operation).

- 1** Go to Settings on your iPhone > Bluetooth, turn on the "Bluetooth".
- 2** In the "Other Devices" Bluetooth device list, select the Bluetooth name of your car.
- 3** A prompt will pop up on the phone, choose "Pair", and the phone will pair successfully with the car's Bluetooth.

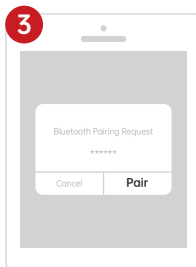
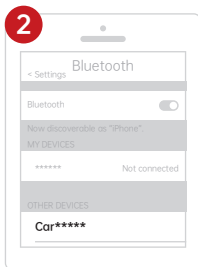
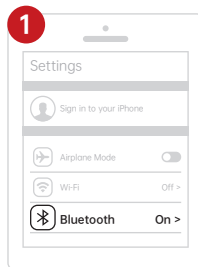

3. AUX Connection

Connect to the car through an AUX cable, and the sound will play from the car's speakers.

- 3.1. Insert the audio cable into the car AUX port, and connect the other end to the AUX OUT port of the device.
- 3.2. Set the car's audio input mode to AUX audio input. After the connection is successful, you can play music, navigation, calls and more through your car's audio system.

Note

Please confirm if your car supports AUX IN and note that the location of the AUX may vary depending on the car model. Please consult your manufacturer for more details.

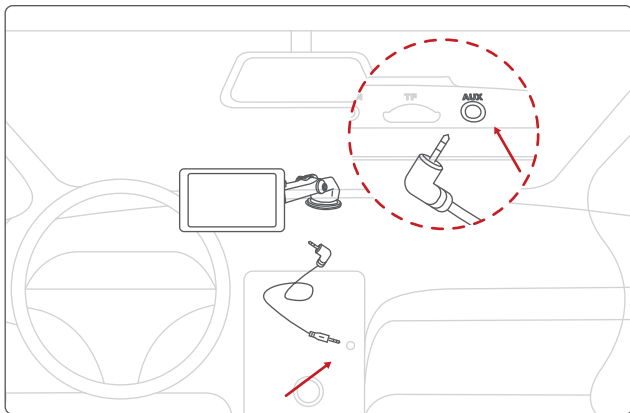

4. FM Transmitter

Connect through FM to play sound through your car's audio system.

4.1. Tune the car radio to an unoccupied FM frequency and set the device to the same frequency, such as 89.2MHz (if unoccupied). Turn on the FM function to transmit sound from the device to the car speakers. After successful connection, audio from the device will play through the car speakers.

4.2. While in FM mode, use the button or slider to adjust the frequency.

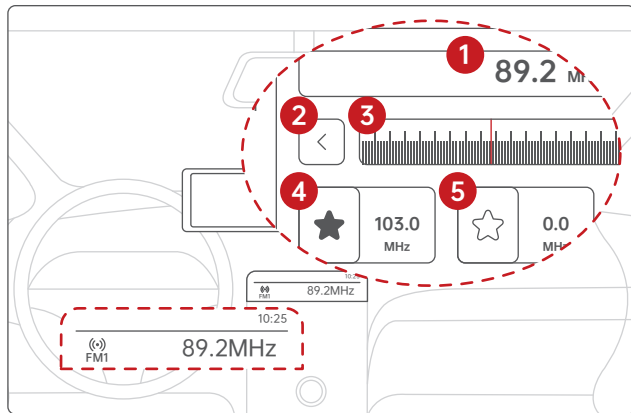

1 89.2 MHz

FM Frequency

2 < >

TUNING +/- 0.1

3 [Frequency Scale]

Scale&Pointer

4 ★ 103.0 MHz

Save Current Frequency Status

Saved

5 ☆ 0.0 MHz

Save Current Frequency Status

To Be Saved

3.3 Android Auto

3.3.1 Android Auto Connect With USB Type-C Cable (Optional)

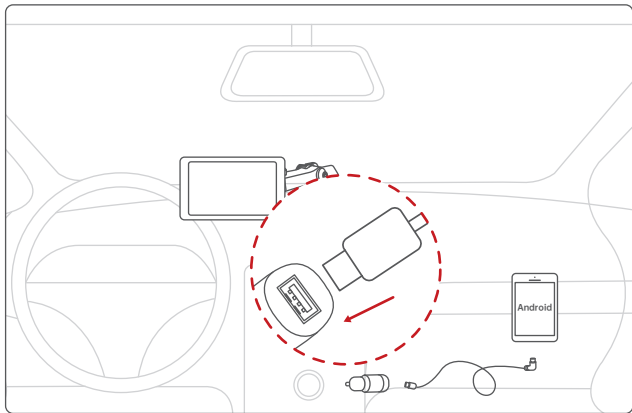

Note

What you need:

1. An Android phone with Android 8.0 (Oreo) and up, an active data plan, and the latest version of the Android Auto app.
2. An original USB cable.

Before you connect your phone for the first time, turn on your car. Make sure your car is in park (P) and allow time to set up Android Auto before you start your drive.

1. Plug a USB cable into the USB port on cigarette charger, plug the other end of the cable into your mobile phone.
2. Your phone might ask you to download the Android Auto app or update to the newest version of the app.
3. Follow the on-screen instructions to complete setup.

For more details visit: <https://www.android.com/auto>

3.3.2 Android Auto Wireless Connect

Note

What you need:

1. A compatible Android phone with an active data plan.
2. 5GHz Wi-Fi support.
3. The latest version of the Android Auto app.

Wireless projection is compatible with these Android versions:

1. Any phone with Android 11.0.
2. A Google or Samsung phone with Android 10.0.
3. A Samsung Galaxy S8, Galaxy S8+, or Note 8, with Android 9.0.

Click "  " on the home screen to enter the Android Auto.

- 1 Go to Settings on your phone, turn on "Bluetooth" and "Wi-Fi".
- 2 Click on "Bluetooth" to enter the Bluetooth search page.
- 3 After entering the "Bluetooth" menu, click "Pair new devices" to search for new Bluetooth devices.
- 4 Select the Bluetooth device starting with "Spedal-*****" from the list of "Available devices" Bluetooth devices.
- 5 Wait for about 20 seconds, a prompt box will pop up on the phone with "Pair with Spedal-*****", click "Pair", and wait for the Bluetooth pairing to complete. After the Android Auto connection is completed, it will automatically enter the Android Auto mode.

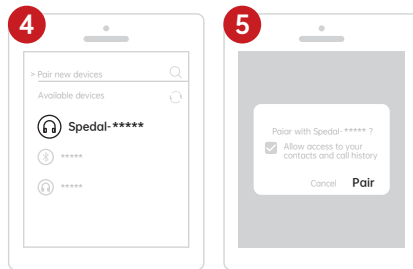
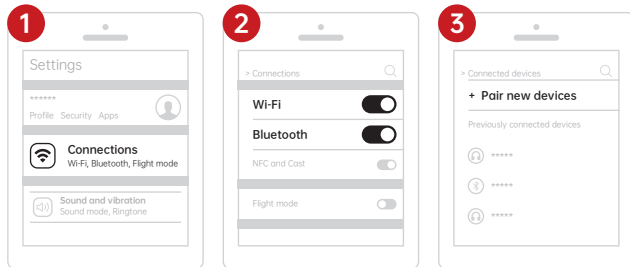

Note

Different models of Android phones may display differently, please refer to the actual situation.

The first connection takes a longer time, please be patient.

If you want to switch to CarPlay or AirPlay, you need to turn off Bluetooth and WIFI on your phone and disconnect from Android Auto connection mode.

3.3.3 Android Auto Audio Out

Click "  " on the home screen to enter the Audio Out.



1. Built-in Speaker

The sound is played from the speaker of the device.



2. Bluetooth

The same as the page 09--3.2.2--2.Bluetooth.



3. AUX Connection

The same as the page 09--3.2.2--3.Aux Connection.



4. FM Transmitter

The same as the page 10--3.2.2--4.FM Transmitter.

3.4 Apple AirPlay

3.4.1 Apple AirPlay Wireless Connect

Click "  " on the home screen to enter the AirPlay.

- 1 Go to Settings on your iPhone > Wi-Fi.
- 2 Select the WiFi network with the name starting with "Spedal-*****" and connect to it. Enter the password, the default password is **12345678**.
- 3 Swipe down from the top of the iPhone screen to access the Control Center menu, then tap "Screen Mirroring".
- 4 Click on NaviCam to complete Screen Mirroring.

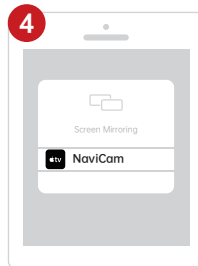
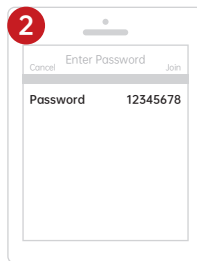
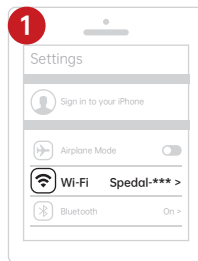

Note

When using AirPlay, please do not turn off the screen of your phone to avoid disconnection.

If you want to switch to CarPlay or Android Auto, please turn off Wi-Fi and disconnect Apple AirPlay on your phone.

3.4.2 Apple AirPlay Audio Out

Click "  " on the home screen to enter the Audio Out.



1. Built-in Speaker

The sound is played from the speaker of the device.



2. AUX Connection

The same as the page 09--3.2.2--3.Aux Connection.



3. FM Transmitter

The same as the page 10--3.2.2--4.FM Transmitter.

3.5 DVR

Click "  " on the home screen to enter the DVR.

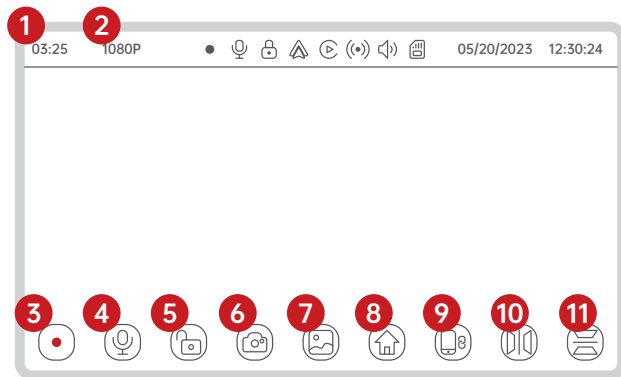

1

03:25

Video Length

2

1080P

Resolution

3



Start / Stop Recording



Start



Stop

4



Start / Stop Sound Recording



Start



Stop

5



Lock / Unlock Current Video



Unlock



Lock

6



Take Picture

7



Playback

8



Back To Home Screen

9



White: CarPlay mode or Android Auto mode
Gray: Device not connected to phone

10



Image horizontal flip

11



Image vertical flip

3.6 Playback

Click "  " on the home screen to enter the playback mode, where you can play, lock, unlock, delete videos or pictures.

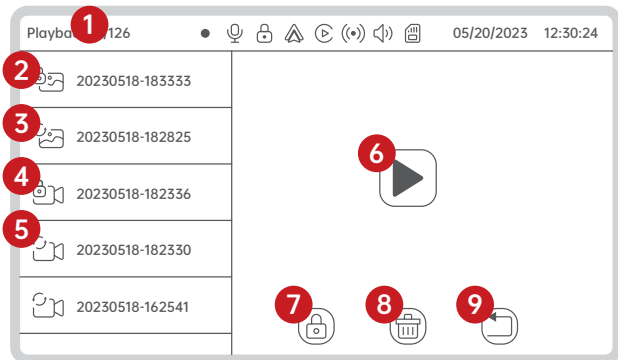

1 1/126 Current Page Nr. / Total Page Nr.

2  Locked Picture File

3  Unlocked Picture File

4  Locked Video File

5  Unlocked Video File

6  Play Current File

7  Lock / Unlock Current File

8  Delete Current File

9  Back To The Previous Level

3.7 Settings

Click "  " on the home screen to enter the Settings mode.

3.7.1 System Settings



Screen saver

Set the time for the screen to automatically turn off. 10 seconds, 30 seconds, 1 minute or off can be selected.



Language

Set the language displayed by the system. 简体中文, 繁體中文, English, русский язык, Español, Français, Deutsch, 日本語, 한국어, العربية, Italiano or Português can be selected.



Date & Time

Set date, time and date format.



Factory reset

Restore all settings to the factory default values.



Firmware version

View the current firmware version information of the host.

3.7.2 Video Settings



Record resolution

Set the resolution of the video, 720P, 1080P, 2K can be selected.



Spit time

Set the time of each recording. 1 minute, 2 minute, 3 minute can be selected.



Time Watermark

Set whether to mark the time at the same time when recording. Close or open can be selected.



Voice control

Turn voice control off or on.



Format

Delete all data on the TF card. This operation is irreversible, please back up the images or photos before performing this operation.

FCC Statement

This device complies with part 15 of the FCC rules. Operation is subject to the following two conditions: (1) this device may not cause harmful interference, and (2) this device must accept any interference received, including interference that may cause undesired operation.

Caution: Changes or modifications not expressly approved by the party responsible for Compliance could void the user's authority to operate the equipment.

NOTE: This equipment has been tested and found to comply with the limits for a Class B digital device, pursuant to part 15 of the FCC Rules. These limits are designed to provide reasonable protection against harmful interference in a residential installation. This equipment generates uses and can radiate radio frequency energy and, if not installed and used in accordance with the instructions, may cause harmful interference to radio communications. However, there is no guarantee that interference will not occur in a particular installation. If this equipment does cause harmful interference to radio or television reception, which can be determined by turning the equipment off and on, the user is encouraged to try to correct the interference by one or more of the following measures:

- Reorient or relocate the receiving antenna.
- Increase the separation between the equipment and receiver.
- Connect the equipment into an outlet on a circuit different from that to which the receiver is connected.
- Consult the dealer or an experienced radio/TV technician for help important announcement .

Radiation Exposure Statement

To comply with FCC RF exposure compliance requirements, this grant is applicable to only mobile configurations. The antennas used for this transmitter must be installed to provide a separation distance of at least 20 cm from all persons and must not be co-located or operating in conjunction with any other antenna or transmitter.

ISED Statement

- English: This device contains licence-exempt transmitter(s)/receiver(s) that comply with Innovation, Science and Economic Development Canada's licence-exempt RSS(s). Operation is subject to the following two conditions:

(1) This device may not cause interference.

(2) This device must accept any interference, including interference that may cause undesired operation of the device.

The digital apparatus complies with Canadian CAN ICES-3 (B)/NMB-3(B).

French: Cet appareil contient des émetteurs/récepteurs exempts de licence qui sont conformes aux RSS exemptés de licence d'Innovation, Sciences et Développement économique Canada.

L'exploitation est soumise aux deux conditions suivantes :

(1) Cet appareil ne doit pas provoquer d'interférences.

(2) Cet appareil doit accepter toute interférence, y compris les interférences susceptibles de provoquer un fonctionnement indésirable de l'appareil.

l'appareil numérique du ciem conforme canadien peut - 3 (b) / nmb - 3 (b).

This device meets the exemption from the routine evaluation limits in section 2.5 of RSS 102 and compliance with RSS 102 RF exposure, users can obtain Canadian information on RF exposure and compliance.

cet appareil est conforme à l'exemption des limites d'évaluation courante dans la section 2.5 du cnr - 102 et conformité avec rss 102 de l'exposition aux rf, les utilisateurs peuvent obtenir des données canadiennes sur l'exposition aux champs rf et la conformité.

This equipment complies with Canada radiation exposure limits set forth for an uncontrolled environment. Cet équipement est conforme aux limites d'exposition aux rayonnements du Canada établies pour un environnement non contrôlé.

RF Exposure Statement

This equipment should be installed and operated with minimum distance 20cm between the radiator & your body.

Cet équipement doit être installé et utilisé à une distance minimale de 20 cm entre le radiateur et votre corps.

The device for operation in the band 5150–5250 MHz is only for indoor use to reduce the potential for harmful interference to co-channel mobile satellite systems.

L'appareil destiné à fonctionner dans la bande 5150-5250 MHz est uniquement destiné à une utilisation en intérieur afin de réduire le potentiel d'interférences nuisibles aux systèmes mobiles par satellite cocanaux.