

ionix\*

SKU# 715209, Model MFV-70/24  
Compact 5,000mAh  
Power Bank With  
LCD Display



## INSTRUCTION MANUAL

PLEASE READ ALL INSTRUCTIONS CAREFULLY

AND RETAIN FOR FUTURE USE

1

### Getting Started

- Remove the product from the box.
- Please retain all packaging after you have checked and counted all the parts and the contents against the list.

### Package Contents

- 5,000mAh Power Bank with LCD Display
- Type-C to Type-C Charging Cable
- Bonus Magnetic Ring included for Android phones (compatible to wireless charging)
- Instruction Manual

### Key Features

- 5,000mAh Power Bank with LCD Display
- Rapid charging up to 22.5W
- LCD battery level display
- Mag-Safe compatible, it allows phone use while charging
- Type-C 1 input: DC 5V/2A, 9V/2A, 12V/1.5A
- Type-C 2 input: DC 5V/2.8A, 9V/2A, 12V/1.5A
- Type-C 2 output: DC 5V/3A, 9V/2.22A, 12V/1.67A (Max 20W)
- USB-A output: DC 5V/3A, 9V/2A, 10V/2.25A, 12V/1.5A (Max 22.5W)
- Wireless output: 5W/7.5W/10W/15W
- Magnetic ring included for Android phones, enabling magnetic wireless charging
- Slim and portable for travel

### Safety Instructions

- Do not immerse in water or any other liquids.
- Do not operate the unit if it has been wet or moist to prevent against electric shock, explosion and/or injury to yourself and damage to the unit.
- Do not use the unit if it has been dropped or damaged in any way.
- Repairs to electrical equipment should only be performed by a qualified electrician. Improper repairs may place the user at serious risk.
- Do not use the unit with wet hands.
- Keep the unit free from dust, lint etc.
- Do not use this unit for anything other than its intended use.
- Keep the unit out of reach of children.
- This unit is not a toy.

2

### IMPORTANT SAFETY INSTRUCTIONS AND WARNINGS

**Never charge batteries unattended.** When charging batteries, you should always remain in constant observation to monitor the charging process and react to potential problems that may occur.

**If at any time you witness a battery starting to balloon, swell up, smoke or hot, discontinue charging process immediately, disconnect the battery and observe it in a safe place for approximately 15 minutes.** This may cause the battery to leak, and the reaction with air may cause the chemicals to ignite, resulting in fire.

- Do not let the device fall down the floor. The internal circuit might get damaged.
- We suggest you put the battery in an enclosure to protect it from damages by liquid or dropping from height accidentally.
- Never store or charge battery pack in extreme temperatures, since extreme temperature could ignite fire.
- Store battery at room temperature between 40- and 80-degrees F for best results.
- Do not expose battery pack to direct sunlight (heat) for extended periods.
- Storing batteries at temperatures greater than 170 degrees F for extended periods of time (more than 2 hours) may cause damage to battery and possible fire.**
- Must keep battery pack away from children.
- Do not attempt to disassemble the device as it may cause damage.

3

### Description of Parts

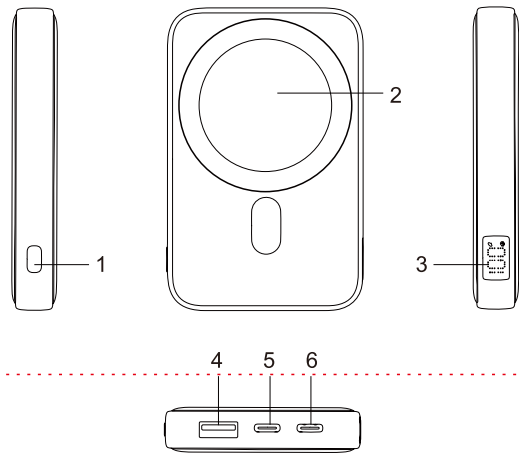

| No | Function                        | Operation  |
|----|---------------------------------|--|
| 1  | On/Off Button (Multifunctional) | <ul style="list-style-type: none"><li>Short press to begin charging your devices (connect the cable), if necessary.</li><li>Short press to see the remaining capacity.</li></ul> |
| 2  | Wireless Charging Area          | Wireless output: 5W/7.5W/10W/15W   |
| 3  | LCD Display                     | Shows Power Bank battery capacity. (If fast charging/ discharging is activated, green indicator is on.)  |
| 4  | USB-A Output Port               | Output 5V/3A, 9V/2A, 10V/2.25A, 12V/1.5A   |
| 5  | Type-C 2 Input/Output Port      | Input 5V/2.8A, 9V/2A, 12V/1.5A, output 5V/3A, 9V/2.22A, 12V/1.67A  |
| 6  | Type-C 1 Input Port             | Input 5V/2A, 9V/2A, 12V/1.5A   |

(Remarks: If USB-A and Type-C 2 outputs are used at the same time, the total output is 5V/3A max.)

4

### INSTRUCTIONS FOR USE

#### Charging your Power Bank

- Please use the Type-C to Type-C Charging Cable that is included in your pack. Connect one end of the cable to the Type-C 1 or Type-C 2 input port. The other end should be connected to your USB power source with output 5V/2A, 9V/2A, 12V/1.5A using Type-C 1 input port or with output 5V/2.8A, 9V/2A, 12V/1.5A using Type-C 2 input port accordingly.
- While charging the Power Bank, the LCD display will show the battery capacity. Once it is fully charged, 100% will stay on.
- Note: Before using the product for the first time, please charge the Power Bank for about 3-4 hours (\*depending on the rated input) or until 100% will stay on.

#### Charging your iPhone, Smart Phones or any other USB Rechargeable Devices with Type-C 2 or USB-A output –

- Please ensure that the Power Bank is fully charged and then unplugged.
- Please use the Type-C to Type-C charging cable to charge your device with Type-C input charging port. Or use your device's USB charging cable that is applicable to charge your device (not included), connect one end to the Type-C output or USB-A output and the other end to your device.
- It would start charging your device.

#### Wireless charging

- Please ensure that the Power Bank is fully charged.
- Short press the ON/OFF button to start Wireless Charging function of the Power Bank.
- Place your iPhone (new generation that is MagSafe compatible) or other smartphone (Qi compatible with magnetic back) onto the Wireless Charging Area of the unit.
- If you are using Android phone which has wireless charging function, you can affix the bonus magnetic ring on your phone and use magnetic wireless charging.
- It would start charging your phone.

#### REMARK:

- If your phone model is compatible with wireless charging and you are unable to charge it wirelessly, please remove your phone case and retry.
- Placement of some smart phones on the magnetic surface for wireless charging might need to be adjusted, for their internal components to make contact appropriately and begin wireless charging.

5

### Care and maintenance

Read the following recommendations before using the Power Bank.

- Do not immerse in water or any other liquids. This may affect product's internal circuit.
- Do not use abrasive cleaning solvents to clean the device.
- Do not expose the device to extremely high or low temperature as it may cause the battery or distort certain plastic parts.
- Do not dispose of the device in fire as it may result in an explosion.
- Do not expose the device to contact with sharp objects as this will cause scratches and damage.
- Do not drop the device on the floor. The internal circuit might get damaged, or the battery may become damaged.
- Do not attempt to disassemble the device as it may cause damage.

### Product Specifications:

Power Bank with built-in rechargeable battery  
Dimensions: 3.91" L x 2.53" W x 0.61" H  
Weight: ~4.6 oz

### TROUBLESHOOTING

| Problem   | Solution   |
|---|--|
| Battery capacity indicator does not light up when charging the Power Bank | Please ensure that Type-C to Type-C Charging Cable and power source is connected properly. Please ensure that your power source is On. |
| Power Bank does not charge device once connected                          | Please ensure that the included Type-C to Type-C charging cable or your device's USB charging cable is well-connected.                 |

### FCC Instructions

**Caution:** Changes or modifications not expressly approved by the party responsible for compliance could void the user's authority to operate the product.

**NOTE:** This product has been tested and found to comply with the limits for a Class B digital device, pursuant to Part 15 of the FCC Rules. These limits are designed to provide reasonable protection against harmful interference in a residential installation. This product generates, uses and can radiate radio frequency energy and, if not installed and used in accordance with the instructions, may cause

6

harmful interference to radio communications. However, there is no guarantee that interference will not occur in a particular installation. If the product does cause harmful interference to radio or television reception, which can be determined by turning the equipment off and on, the user is encouraged to try to correct the interference by one or more of the following measures:

- Reorient or relocate the receiving antenna.
- Increase the separation between the product and receiver.
- Connect the product into an outlet on a circuit different from that to which the receiver is connected.
- Consult the dealer or an experienced radio/TV technician for help.

This device complies with Part 15 of the FCC Rules. Operation is subject to the following two conditions: (1) this device may not cause harmful interference, and (2) this device must accept any interference received, including interference that may cause undesired operation.

### FCC RF exposure statement:

The device has been evaluated to meet general RF exposure requirement. The device can be used in portable exposure condition without restriction.

### Limited Warranty

This manufacturer's product warranty extends to the original consumer purchaser of the product. Neither the retailer nor any other company involved in the sale or promotion of this product is a co-warrantor of this manufacturer warranty.

**WARRANTY DURATION:** All materials and workmanship are warranted to the original consumer purchaser for a period of ninety (90) days from the original purchase date.

**WARRANTY COVERAGE:** This product is warranted against defective materials or workmanship. This warranty is void if the product has been damaged by accident, in shipment, unreasonable use, misuse, neglect, improper service, commercial use, repairs by unauthorized personnel or other causes not arising out of defects in materials or workmanship. This warranty doesn't cover the following which may be supplied with this product, including but not limited to; LCD Screens, glass parts, lenses, bulbs etc. This warranty is effective only if the product is purchased and

7

operated in USA and Canada, and does not extend to any units which have been used in violation of written instructions furnished by manufacturer or to units which have been altered or modified or, to damaged products or parts thereof which have had the serial number removed, altered, defaced or rendered illegible.

**WARRANTY DISCLAIMERS:** This warranty is in lieu of all warranties expressed or implied and no representative or person is authorized to assume for manufacturer any other liability in connection with the sale of our products. There shall be no claims for defects or failure under any theory of tort, contractor commercial law including but not limited to, negligence, gross negligence, strict liability, breach of warranty and breach of contract. Under no circumstances will Manufacturer's / Distributor's maximum liability exceed the retail value of the product.

**WARRANTY PERFORMANCE:** During the above 90 day warranty period, a product with a defect will be either repaired or replaced with a reconditioned comparable model (at manufacturer's option). The repaired or replacement product will be in warranty for the balance of the 90 day warranty period and an additional one-month period. No charge will be applicable for such repair or replacement.

**SERVICE AND REPAIR:** If service is required for this product, you should first contact Inspired Brands Customer Service at [Support@inspired-brands.com](mailto:Support@inspired-brands.com) or by calling 1 (800) 246-0972, Monday to Friday 10am to 6pm EST.

### NOTE:

Manufacturer cannot assume responsibility for loss or damage during incoming shipment. As a precautionary measure, carefully package the product for shipment, and insure it with the carrier. Be sure to enclose the following details with the product: your full name, return address and daytime phone number, a note describing the problem you experienced, a copy of your sales receipt or other proof of purchase to determine warranty status. C.O.D. shipments cannot be accepted.

Distributed by (Responsible party): Inspired Brands, LLC  
Address: 2311 W Howard Street, Chicago, IL 60645  
Telephone No.: 1 (800) 246-0972

8

型号：715209 (GC-52W) 材质：105g铜板纸 尺寸：388 (97) X141mm 工艺：双面印刷+四折页后再对折一次