

ASHLAND®

ASH 7.5' CHARLOTTE SPRUCE

SKU 10742904

APPROXIMATE SETUP TIME



45 minutes



TREE ASSEMBLY INSTRUCTION

Fig. A - Tree Stand Assembly

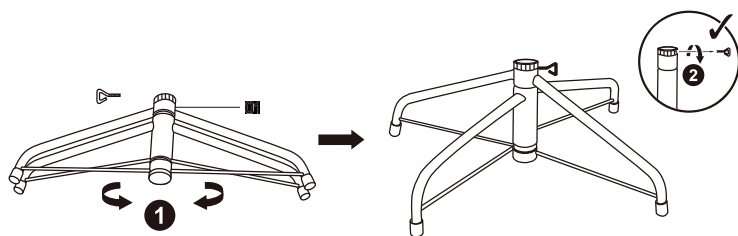
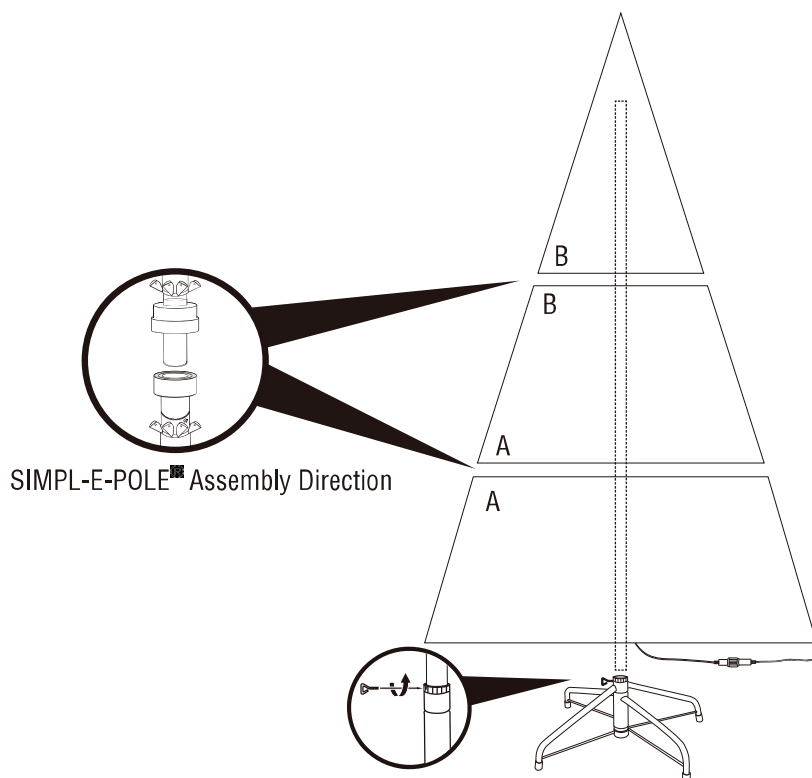

Fig. B - Tree and Light Assembly



SIMPL-E-POLE™ Assembly Direction

Electrical Rating For The Tree (For Indoor Use Only)

0.25A 120V 60Hz

29V 13W adapter included

Fig. C

Top view



Side view



Remote Control Included

Insert
Green Cabel Plug
Into Wall Outlet

BEFORE YOU BEGIN

Congratulations on purchasing your new tree from Winners Industry Co.,Ltd. Carefully follow the instructions below on how to quickly and easily set up your new tree.

1. When you are ready to start, make sure that you have plenty of space and a clean dry area for assembly. Always try to assemble the product as close as possible to the intended location.
2. Remove all plastic bags and dispose of safely.
3. Remove the product from the packing, take care not to damage or twist the wires.
4. Ensure that the cables are fully unwound before use.
5. Check the set before use for loose or damaged wiring and that all the bulbs are secured. If you are in doubt do not use the set.

INSTRUCTIONS

Every carton should contain a top section and middle and bottom sections. Also included a metal base.

Remove all Packaging(i.e. cardboard or plastic)before beginning.

1. Choose a location where the tree is to be displayed. Take out the tree stand. Unfold the legs and lay the stand in a flat area. When inserting the bottom section of the tree into the assembled stand, thread the wing bolt into the stand and tighten until the pole is firmly secured. See fig. A.
2. Insert the pole with tapered end of the tree bottom into the tree stand.
3. Insert the middle section into the bottom tree section and push down into position.
4. Insert tree top into middle section and push down into position.
5. This product has a quick set function, no need to use the male and female connectors to light up the chains, easily to assemble. See fig. B.
6. Gently lower all main branches on tree sections. Take care not to place unnecessary pressure on the brackets when assembling. The branches on your tree can be adjusted to give tree the desired amount of fullness. For best results, straighten and separate all branch tips, then bend them slightly upward. See fig. C.
7. Plug tree lights into a power outlet and add holiday decorations to enhance the beauty of this tree.
8. This product contains a foot pedal switch and a remote control to cycle through 9 different light functions. This foot pedal also has a memory function, the feature automatically recalls the lighting effect before the power failure. So that you do not need to repeat the light function adjustment steps. It can save you a lot of time, really a thoughtful design.

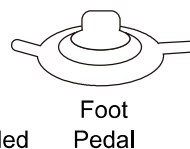
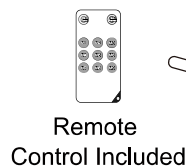

- 9 Different Light Functions:
1. Combination
 2. Steady On WW
 3. Shimmering WW
 4. Steady On MLT
 5. Shimmering MLT
 6. Slo-Glo
 7. C1 CYCLE FADE
 8. C2 CYCLE FADE
 9. In Waves

STORAGE INSTRUCTIONS

1. Remove all ornaments and decorations. For pre-lit trees, first unplug extension cord from the wall outlet and then disconnect light extension cord between each section of the tree.
2. Disassemble the tree from the top to the bottom. Start with the tree top and gently lift straight up to remove from section below and fold all branches toward the pole.
3. In case of difficulty separating the tree pole (trunk), apply a small amount of lubricant at the joint and rotate the upper pole in both directions. Lift up the upper pole again.
4. Continue by gently lifting straight up each section(s) from the section below and fold all branches toward the pole until the bottom section is removed from the tree stand.
5. Carefully place all tree sections into shipping box and tape it shut.
6. When not in use, please store your tree in a cool, dry place away from sunlight. Exposing your tree to excessive heat or humidity may damage your tree.

TIPS & TRICKS

If the set fails to light, please check the following:

- Disconnect the set from the mains.
- Rotate the power pole of each section of the tree to check whether it has good connection.
- The light source of this luminaire is not replaceable: when the light source reaches its end of life the whole luminaire shall be replaced. DO NOT attempt to replace any of the bulbs in the light set. If part of light set or cable is damaged the light set MUST be destroyed.
- Do not connect this chain electrically to another chain.
- Do not connect this chain to the supply while it is in the packaging.
- If for some reason your branch is detached from the tree, follow these steps:

- 1) Place the branch in the proper location.
- 2) Slide the rivet through the rivet hole on the trunk, then through the branch loop, then slide the rivet hole on the trunk.
- 3) Use a pair of pliers to pinch the end of the rivet. Flattening the rivet will keep the branch in place.

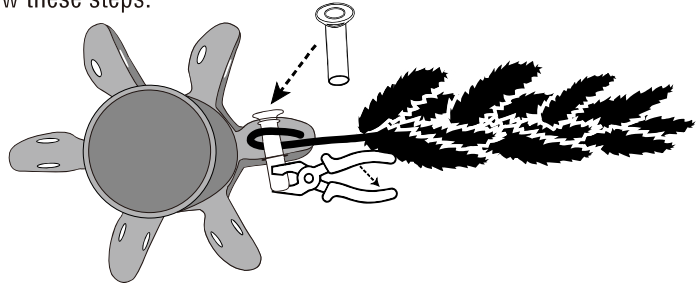

⚠ WARNING

1. This tree is intended for indoor use only.
2. Always position your tree, cables and extension leads so that they will not be a hazard to the elderly, children and pets.
3. Do not overload power sockets or extension leads.
4. This is an electric product-not a toy! To avoid risk of fire, burns, personal injury and electric shock it should not be played with or placed where small children and pets can reach it.
5. Do not put any part of the tree in the mouth.
6. Do not overload with heavy decorations.
7. Do not expose the tree to water.
8. Artificial tree are made from small fibres and have small parts. which may pose a choking hazard if detached from the branches.

WARNING - This is not a toy and is not intended for use by children.

- Remove and immediately recycle or dispose of used batteries according to local regulations and keep away from children. Do NOT dispose of batteries in household trash or incinerate.
- Even used batteries may cause severe injury or death.
- Call a local poison control center for treatment information.
- Battery type: CR2025.
- Nominal voltage: 3.0 V.
- Non-rechargeable batteries are not to be recharged.
- Do not force discharge, recharge, disassemble, heat above (manufacturer's specified temperature rating) or incinerate. Doing so may result in injury due to venting, leakage or explosion resulting in chemical burns.
- Ensure the batteries are installed correctly according to polarity (+ and -).
- Do not mix old and new batteries, different brands or types of batteries, such as alkaline, carbon-zinc or rechargeable batteries.
- Remove and immediately recycle or dispose of batteries from equipment not used for an extended period of time according to local regulations.
- Always completely secure the battery compartment. If the battery compartment does not close securely, stop using the product, remove the batteries, and keep them away from children.



WARNING

- **INGESTION HAZARD:** This product contains a button cell or coin battery.
- **DEATH** or serious injury can occur if ingested.
- A swallowed button cell or coin battery can cause **Internal Chemical Burns** in as little as **2 hours**.
- **KEEP** new and used batteries **OUT OF REACH OF CHILDREN**.
- **Seek immediate medical attention** if a battery is suspected to be swallowed or inserted inside any part of the body.



SUPPORT CONTACT

CUSTOMER SERVICE FOR CHRISTMAS TREES

For any questions, assistance, or missing parts, Do Not Return To Place Of Purchase. Please contact us at +1-844 946 8733 or email us at customerservice@winnersarts.com. One of our customer service representatives will be happy to assist you.

Tree ID#: _____

Customer Name: _____

Tree UPC#: _____

Address (No P.O. Boxes): _____

Store Purchased: _____

City & State: _____

Specify Problem: _____

Zip Code: _____

Day Phone: _____

Date Purchased: _____

TREE ID# IS LOCATED ON END PANEL OF BOX. TREE ID# IS REQUIRED WHEN REQUESTING REPLACEMENT PARTS.

This Christmas Tree is subject to the following warranty, with warranty service provided by Winners Industry Co.,Ltd. (hereinafter "Winners").

LIMITED WARRANTY

Winners is pleased to offer warranty for the repair or replacement of products for three (3) years against manufacturer defects on parts from the date of purchase. The provisions of this Limited Warranty only apply to the original purchaser and who purchased from an authorized Winners seller. Please keep your original store sales receipt. This proof of purchase will be required and must accompany warranty claims to Winners or its designated agents. This Limited Warranty will not apply to modified or repaired products, unless authorized by Winners in writing; use for commercial purposes; use the product in contravention of the instructions with regards to set-up and use; or to products in which non-Winners parts or accessories were substituted; or use of the product in contravention of the product's instructions; or when improper voltage was used; or if the product was abused, or harmed through accident or negligence. This Limited Warranty does not cover consequential damages, including, but not limited to, labor time or costs, normal wear-and-tear; nor to acts of God, nor to damage to any other products or property.

In no event shall Winners, its authorized agents, related entities, or employees be liable to the buyer or any other party for direct or consequential damages. This limitation, in part or in full, may not apply to you, if the jurisdiction in which the claim arose does not allow this limitation.

This Limited Warranty is not extended to close-outs, factory seconds, or resold products, such as garage sales or auctions, or purchases from non-authorized sellers of Winners products. This Warranty also does not apply to online vendors or any other sellers who did not purchase the products from a Winners company, whether the product has been used or not prior to being sold to you. Any issues with items purchased from these types of vendors/sellers will need to be addressed directly with them.

RETAIN THIS CERTIFICATE FOR YOUR RECORDS

For answers to frequently asked questions,
Customer Service Hotline: +1-844 946 8733
customerservice@winnersarts.com