

# MRS INSTALLATION INSTRUCTION

## MORTISE LOCK

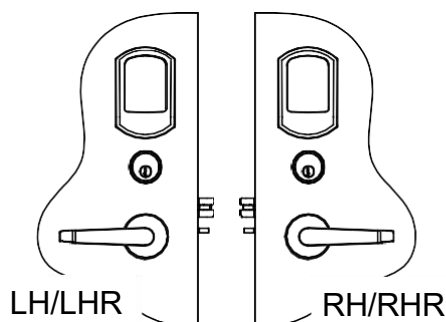

### 1. CHECK HANDING OF LOCK BODY

- If handing of lock body is not correct for opening, consult factory for handing instruction.

### 2. INSTALL CHASSIS, TRIM, TURNPIECE & CYLINDER

- Prepare door according to included template.
- Install mortise chassis while feeding chassis wire into hole on **inside** of door.
- Gently pull wire through hole as chassis is inserted.
- Install trim using included instruction.

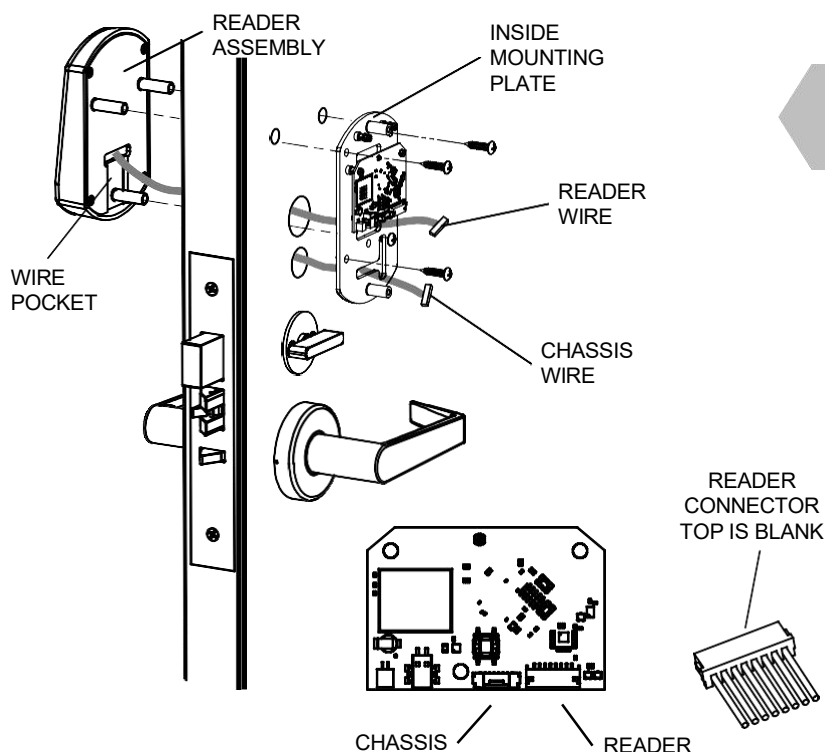
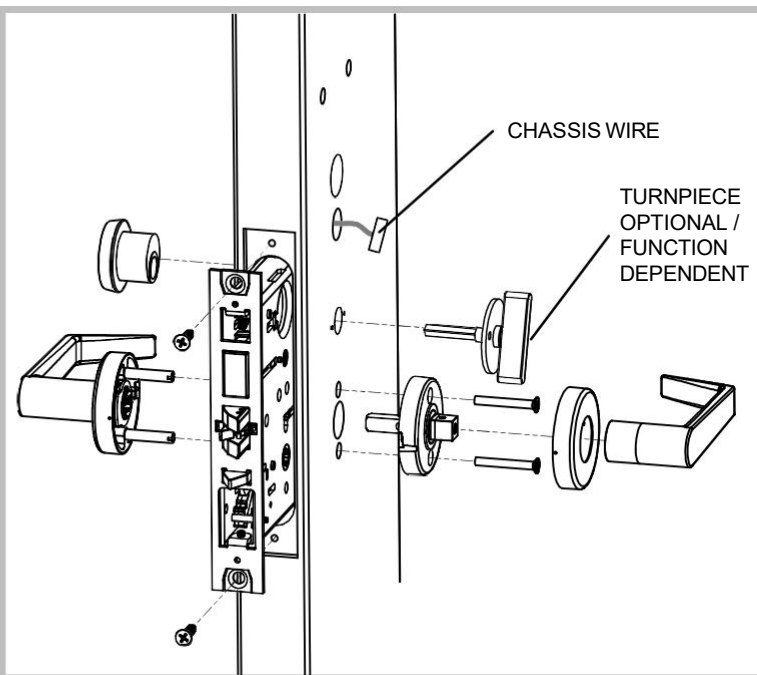

### 3. INSTALL READER AND INSIDE MOUNTING PLATE

- Install reader assembly and inside mounting plate – feed reader wire through hole in door and through slot under circuit board.
  - *Wire harness will land into wire pocket*
- Feed chassis wire through T slot in mounting plate.
- Secure with (3) M5 x 50 pan head screws (thru bolts).
- Make both wire connections after reader is secure. Push extra wire into door cavity.

# MRS INSTALLATION INSTRUCTION

## MORTISE LOCK



### 4. INSTALL BATTERY PACK

- Plug in battery wire to control board.
- Install battery pack over two studs on mounting plate.
- Snap battery pack onto retainers on mounting plate.
- Caution: wire pinch point – Verify no pinched wires

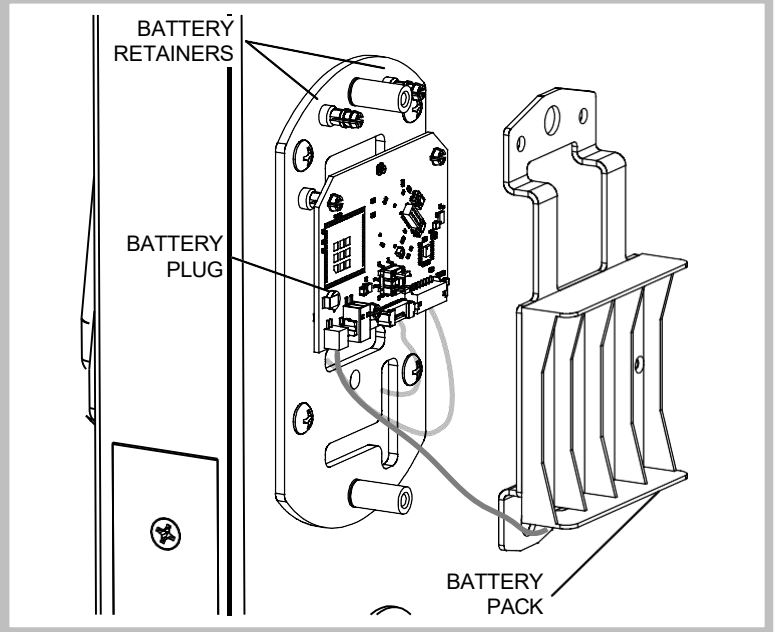

### 5. INSTALL BATTERIES AND BATTERY COVER

- Install batteries and battery cover with (2) pan head screws.

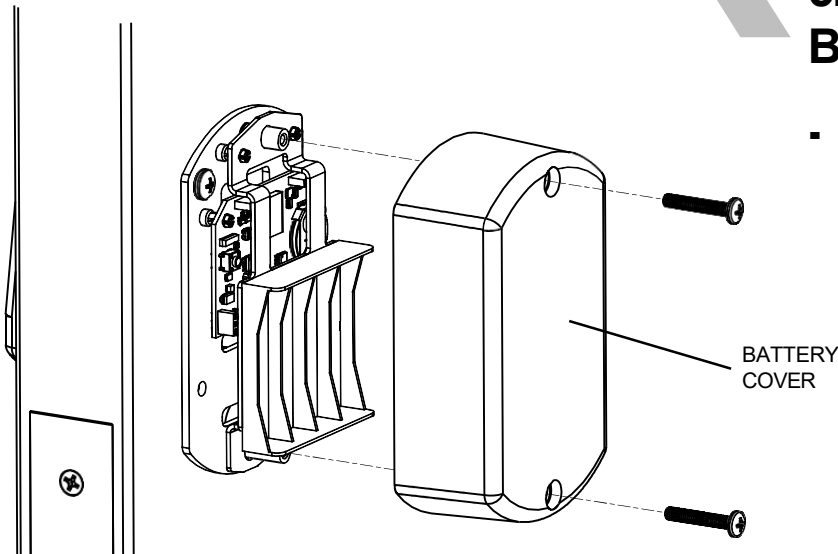

# MRS INSTALLATION INSTRUCTION

## MORTISE LOCK



Caution Statement:

**FCC ID: 2BBNS-KLCP1**

**Contains FCC ID: 2AV6C-CRCM1101B1**

NOTE: This equipment has been tested and found to comply with the limits for a Class A digital device, pursuant to part 15 of the FCC Rules. These limits are designed to provide reasonable protection against harmful interference when the equipment is operated in a commercial environment. This equipment generates, uses, and can radiate radio frequency energy and, if not installed and used in accordance with the instruction manual, may cause harmful interference to radio communications. Operation of this equipment in a residential area is likely to cause harmful interference in which case the user will be required to correct the interference at his own expense.

NOTE: This equipment has been tested and found to comply with the limits for a Class B digital device, pursuant to part 15 of the FCC Rules. These limits are designed to provide reasonable protection against harmful interference in a residential installation. This equipment generates, uses and can radiate radio frequency energy and, if not installed and used in accordance with the instructions, may cause harmful interference to radio communications. However, there is no guarantee that interference will not occur in a particular installation. If this equipment does cause harmful interference to radio or television reception, which can be determined by turning the equipment off and on, the user is encouraged to try to correct the interference by one or more of the following measures:

- Reorient or relocate the receiving antenna.
- Increase the separation between the equipment and receiver.
- Connect the equipment into an outlet on a circuit different from that to which the receiver is connected.
- Consult the dealer or an experienced radio/TV technician for help.

This device complies with Part 15 of the FCC Rules. Operation is subject to the following two conditions: (1) This device may not cause harmful interference, and (2) This device must accept any interference received, including, an interference that may cause undesired operation. Any changes or modifications not expressly approved by the party responsible for compliance could void the user's authority to operate this equipment. This equipment should be installed and operated with a minimum distance of 15 cm between the radiator and your body.