

S7

PRODUCT MANUAL



3 in 1 Magnetic Wireless Charger

Product Description

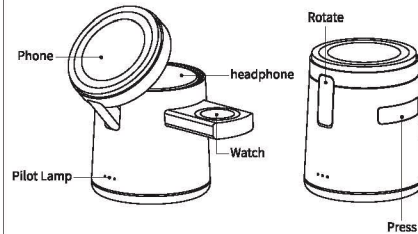

Packaging List

Wireless charger	x1
Data Line	x1
Instructions	x1

- 1 -

Product Specifications

Name	Wireless Charger	Model	S7
Product size	71.5x71.5x84mm	Input	9V ---2A
Output	Phone:15w/10w/7.5w/5w		
	AirPods:3w		
	Watch:2.5w		

Compatibility Sheet:

1.Smartphone

For iPhone 12 mini, iPhone 12, iPhone 12 Pro, iPhone 12 Pro Max, iPhone 13 mini, iPhone 13, iPhone 13 Pro, iPhone 13 Pro Max, iPhone 14, iPhone14 Pro, iPhone 14 Pro Max, iPhone 14 Plus, iPhone 15, iPhone15 Pro, iPhone 15 Pro Max, iPhone 15 Plus

2.SmartWatch

For Apple Watch 3/4/5/6/SE/7/8/9/Ultra 1/Ultra 2

3.Headphones

For AirPods 2/3/Pro 1/Pro 2

- 2 -

Connecting

1.Insert the data cable type-c into the product interface.

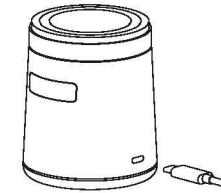

2.Insert the USB-A head of the data cable into the power adapter and connect the adapter to a power outlet.

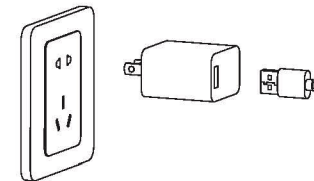

- 3 -

3.Rotate the top cover to display, and freely choose the angle of rotation.

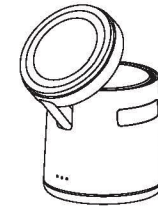

4.Press inward to pop out the charging module of the watch.

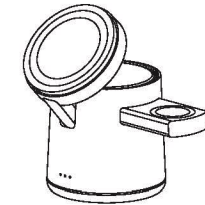

- 4 -

Attention

- ※ Do not put anything else between your smartphone and the wireless charger such as credit cards, door keys, coins, metal, NFC cards, etc.
- ※ Make sure to place the device in the center of the charging pad. Improper placement may result in heat generation or non-charging.
- ※ Compatible only with iPhones with MagSafe.
- ※ Please use a MagSafe compatible case, or no case. Cases that are not MagSafe compatible will not provide enough magnetism for positioning.

Charging with Cases

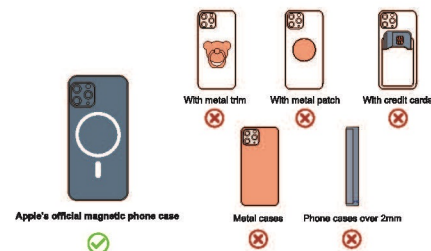

Tips: The charging speed is related to the ambient temperature. For fast charging, please place the wireless charger in a cool and ventilated place. For example, a cool room, or near a fan or air conditioner. Do not expose it to direct sunlight, or place it near hot objects. Such as electrical appliances, heating, fireplaces, etc.

- 5 -

LED Indicator

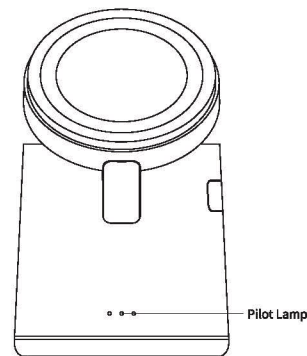

Power on	Blue light on for 3 seconds
charging	Blue light on for 5 seconds
Standby mode	No lights on
Fully charged	No lights on
foreign body	The blue light flashes 500MS per cycle for 1 second
Overvoltage	The blue light flashes 500MS per cycle for 1 second

- 6 -

Charge the phone separately



Charge headphones separately



- 7 -

Three in one charging

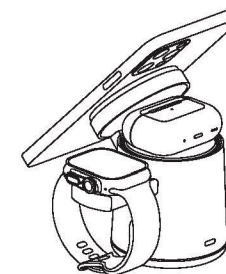

Important Safety Instructions

- Avoid dropping.
- Do not disassemble.
- Do not expose to liquids.
- Only use the original power adapter.
- This product is suitable for moderate climates only.
- The maximum ambient temperature during use of this product must not exceed 40°C.
- Open flame sources, such as candles, must not be placed on this product.
- Only use a dry cloth or brush to clean this product.

- 8 -

FCC WARNING STATEMENT

Warning: Changes or modifications not expressly approved by the party responsible for compliance could void the user's authority to operate the equipment.

NOTE: This equipment has been tested and found to comply with the limits for a Class B digital device, pursuant to Part 15 of the FCC Rules. These limits are designed to provide reasonable protection against harmful interference in a residential installation. This equipment generates, uses and can radiate radio frequency energy and, if not installed and used in accordance with the instructions may cause harmful interference to radio communications.

However, there is no guarantee that interference will not occur in a particular installation. If this equipment does cause harmful interference to radio or television reception, which can be determined by turning the equipment off and on, the user is encouraged to try to correct the interference by one or more of the following measures:

- Reorient or relocate the receiving antenna.
- Increase the separation between the equipment and receiver.
- Connect the equipment into an outlet on a circuit different from that to which the receiver is connected.
- Consult the dealer or an experienced radio/TV technician for help.

This equipment complies with FCC radiation exposure limits set forth for an uncontrolled environment. This equipment should be installed and operated with minimum distance 20cm between the radiator & your body.

Made in China CE FCC RoHS