

## Temp Control



## Product Instruction Manual

Please read carefully prior to use.

Make sure to fully charge your new mug prior to first use. AC power adapter and charging coaster included.

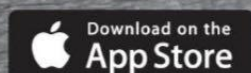

## Specifications:

Bluetooth v4.2  
Capacity: 14FL OZ  
Battery: 7.4V / 2900 mAh  
Heating Range: 120°F-160°F (48°C-71°C)  
Coaster Input: USB-C 19V / 2.4A  
Power Adapter Input/Output:  
110VAC / 19V - 2.4A  
Mug Liner: 304 Stainless Steel  
IPX7 Water-Resistant  
Hand Wash Only



**Touch Button/LED Ring (Backside)**

### Touch Button Sequence

Tap to Wake Up or  
Select Temp Setting

Press and Hold for  
3 Seconds to turn  
Heating On/Off

### Touch Button LED Ring

Light ring pulses while heating,  
green - 120 to 129, orange -  
130 to 144, red - 145 to 160

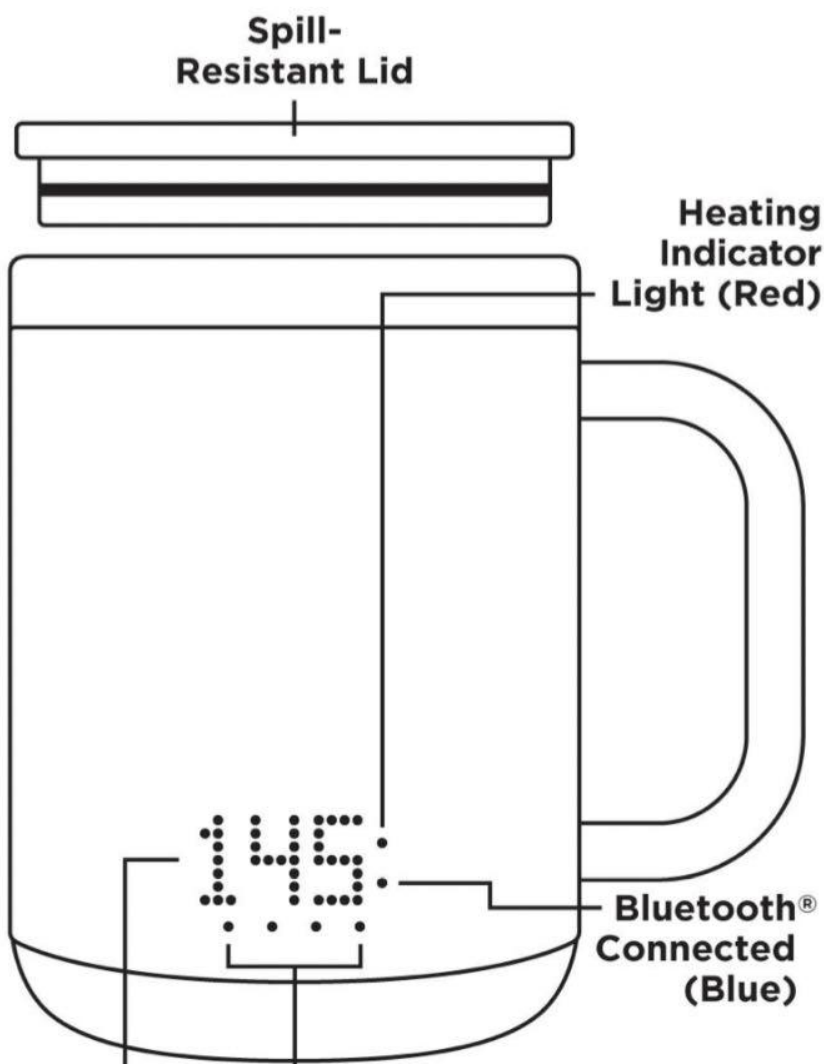

### LED Matrix Display

**AC Power Adapter**

### Charging Terminals

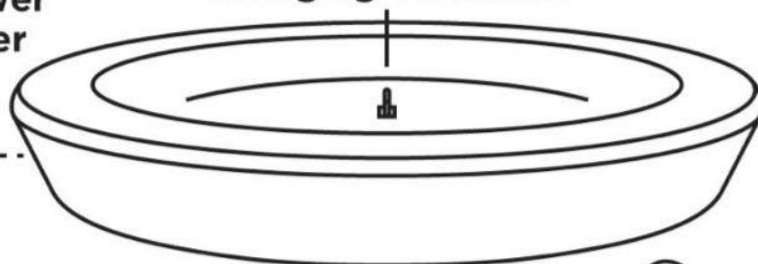

### Charging Coaster

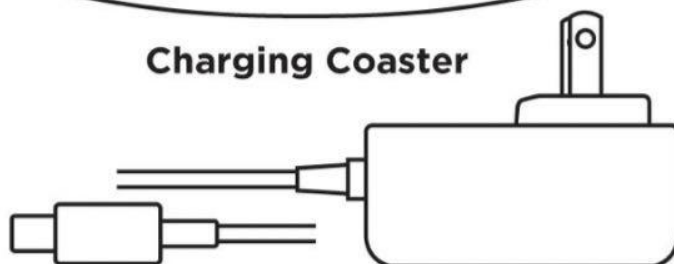

### USB-C Power Adapter



### LED Display Readout

Hi~ - On / Bye - Off

🔥 - Heating / OFF - Heat Off

Ht - Temp Over 160°F

## Setup and Charging

Choose dry level surface near an AC power outlet for coaster that's convenient for charging day or night. Popular locations include kitchen, work desk, and side table for a favorite seating area.

1. Connect AC power adapter to USB-C port on charging coaster and plug into outlet.
2. Place mug on charging coaster for 4 hours or overnight. Power indicator lights will display charging progress. 4 solid lights is fully charged.

Note: Charging times may vary. Charging overnight between uses recommended.

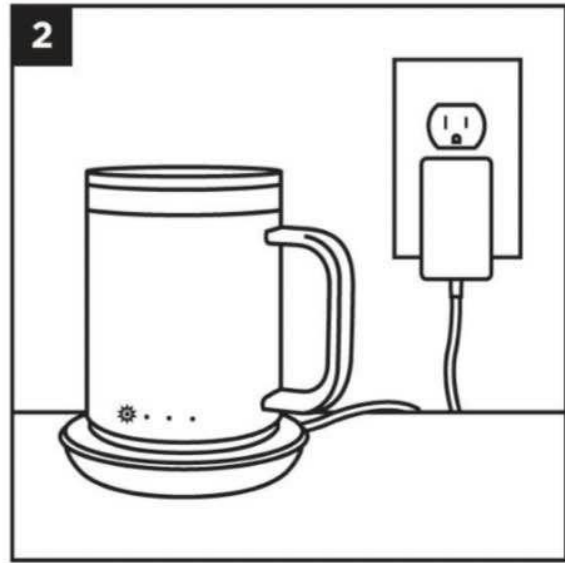
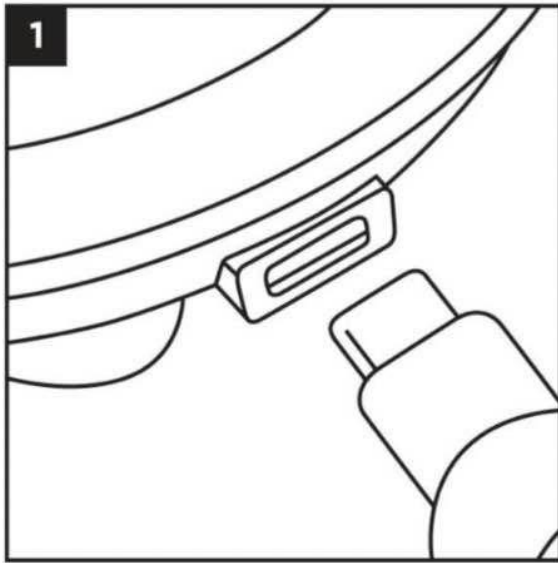

## Powering Mug On/Off

1. Press and hold power button on bottom of mug for 3 seconds to power on/off. LED display will flash "Hi" for on and "Bye" for off.
2. Short press power button to change between Fahrenheit and Celsius scales while in use.

Note: Power button on bottom of mug ONLY turns mug on/off. Heating function is controlled using touch button on side of mug or App Power mug off using button on bottom after each use.

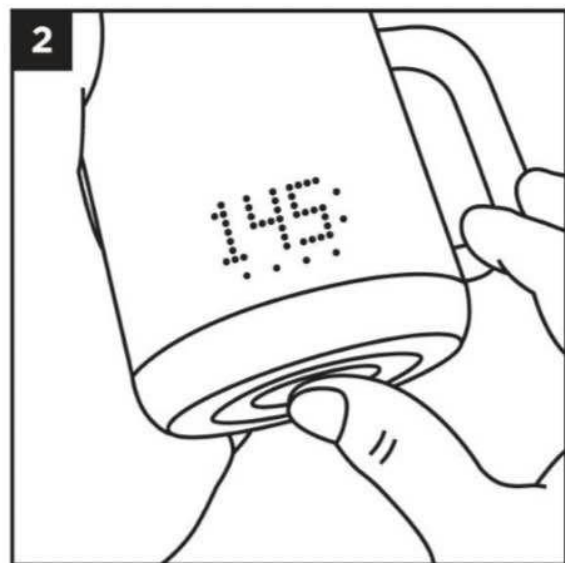
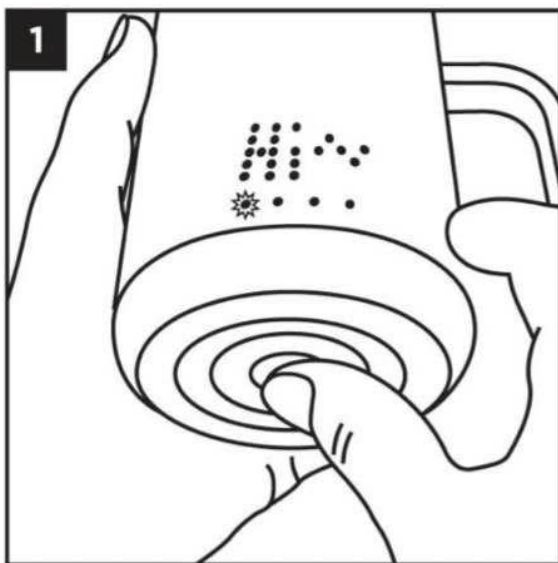

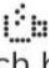

## Heating with Touch Button

1. Press and hold power button on bottom of mug for 3 seconds to power on. LED display will flash "Hi" and temperature will be displayed.
2. Tap touch button on backside of mug with center of finger tip to wake up display. Touch button has vibration response.
3. Tap again to select temperatures 120°F through 160°F in 5 degree increments. Starting with 135°F or 140°F is recommended.
4. Press and hold touch button for 3 seconds to turn heating function on.  will flash on display and red heating light will illuminate. Press and hold touch button for 3 seconds to turn heating function off. OFF will flash on display and heat will turn off. Please note that mug is still powered on.

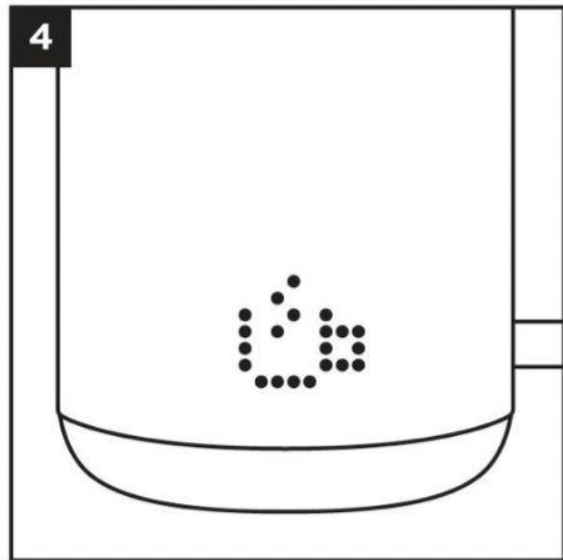
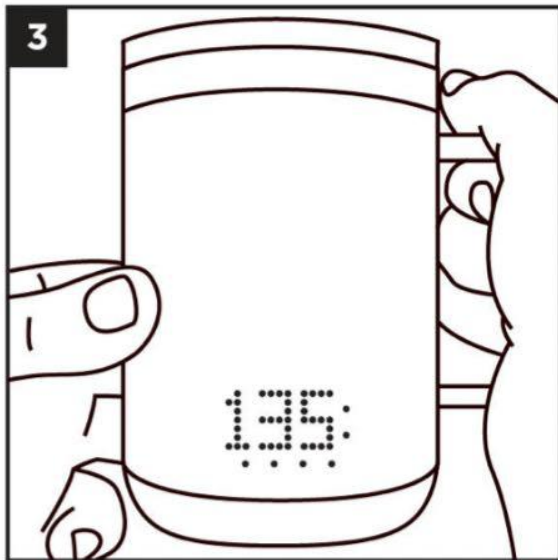
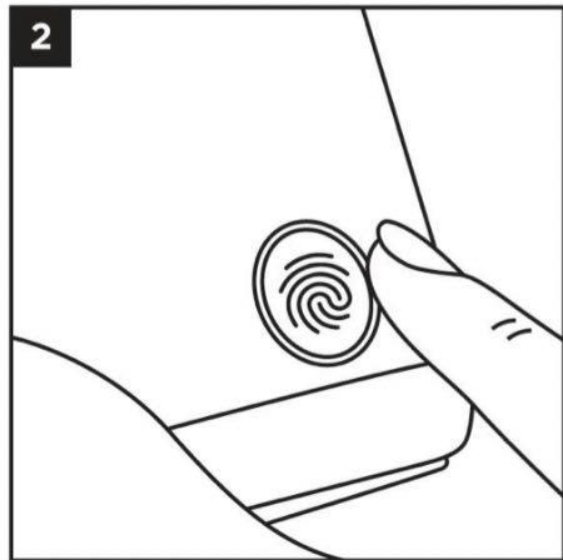
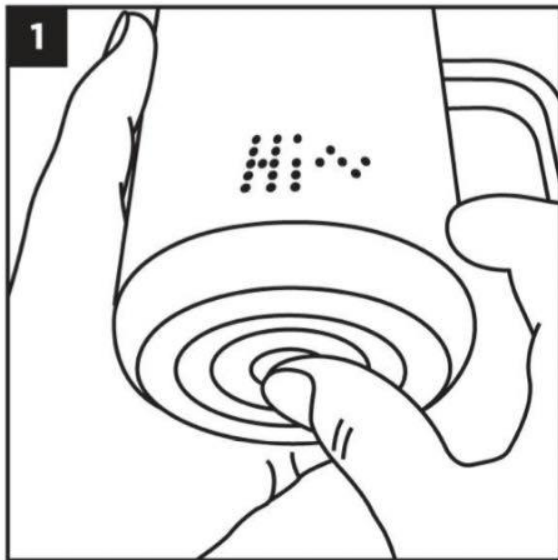

Remember to press and hold power button on bottom of mug for 3 seconds to power off after each use. LED display will flash "Bye" and mug will shut off.

**Note:** Mug will remember your last setting. Red heating indicator light flashes while heating and turns solid while maintaining temperature. LED light ring around touch button illuminates green to indicate current liquid temperature 129°F or below, orange 130°F - 144°F and red 145°F or above. LED light ring will pulse while heating and will be solid while maintaining temp.

## App Setup

Download free **SG MUG** App from App Store® or Google Play™ to your smartphone or tablet.

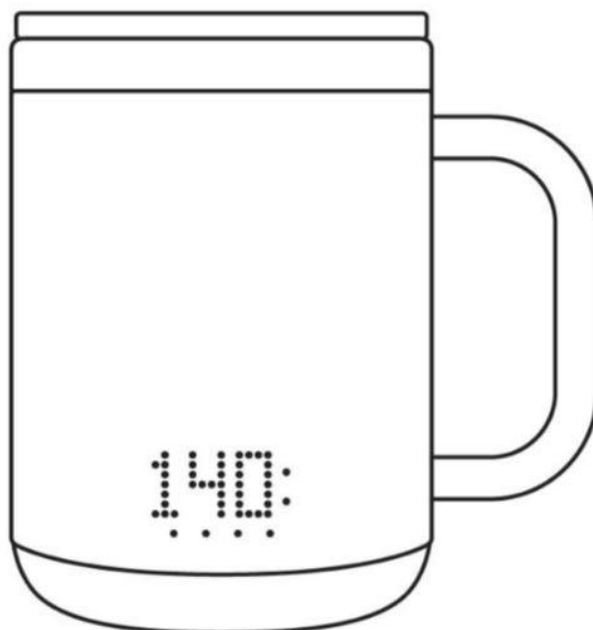

- Make sure Bluetooth® is enabled on your device.
- Open the App with mug nearby and powered on using button on bottom.
- Allow access to Bluetooth® and notifications if prompted.
- Tap + in upper right of screen to add device.
- Tap mug tile following screen to connect.
- App will continue to home screen for temperature control.
- Blue indicator light on mug will illuminate while connected.

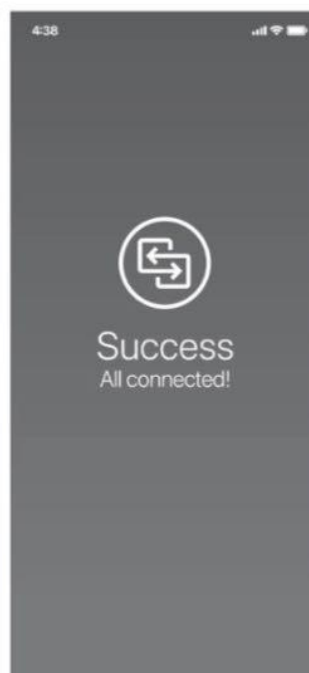
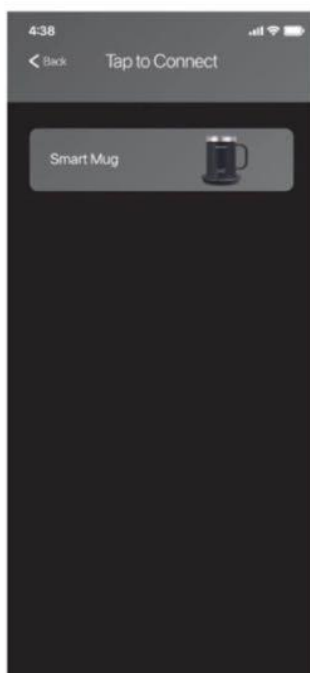

## App Screen



### Tap Preset or Slider and Press Play to Start Heating

Note: Mug will remember your last setting. Background color in App changes depending on current temperature. Background is green to indicate current liquid temperature 129°F or below, orange 130°F - 144°F and red 145°F or above. Background will turn grey while heating is off.



Care Tip: Wipe and clean with a soft cloth. Never use any abrasive cleaning agents or get wet.



## Heating with App

1. Press and hold power button on bottom of mug for 3 seconds to power on. LED display will flash "Hi" and temperature will be displayed.
2. Open App and connect to mug.
3. Set temperature by tapping temp slider or preset tiles. Target temperature will be displayed above.
4. Tap play to turn on heating function.
5. Tap pause to turn heating off. Please note that mug is still powered on.
6. Remember to press and hold power button on bottom of mug for 3 seconds to power off after each use. LED display will flash "Bye" and mug will shut off.

## Settings and Presets

- Tap  to enter settings menu to adjust temperature scale, notifications, alarms, shutoff time and presets.
- Tap name of preset temp or timer to enter name and confirm.
- Tap temperature or time to set and confirm.
- Exit menu by tapping  in upper right corner of screen.

## Additional Settings

- Select Celsius or Fahrenheit temperature modes by pressing power button on bottom of mug or in App.
- This mug shuts off automatically after 3 hours. Time can be adjusted in App.
- This mug is equipped with a sensor that detects when no liquid is present. Mug will shut off automatically if liquid is not present.
- To personalize your mug, tap mug name in add device screen and enter.

## Troubleshooting

- **Mug does not respond to power button or touch control?** Place mug on coaster and charge completely. Charging times may vary.
- **Is the mug on?** Press and hold power button on bottom of mug for 3 seconds to power on. LED display will flash "Hi".
- **Mug is powered on but not heating?** Press and hold touch button for 3 seconds to turn heating function on. Or with App, tap play to turn on heating function.
- **Difficulty using touch button?** Tap center of depression on side of mug with center of your pointer or middle finger to make complete contact with touch control surface.
- **Difficulty pairing App?** Make sure mug is powered on and SG MUG App is downloaded. Check to make sure Bluetooth® is enabled on your smartphone or tablet.
- **Heating function turns off occasionally?** This mug is equipped with technology that detects when no liquid is present and shuts off heating function. Temperature layers in column of liquid inside mug during heating can occasionally mimic a no liquid scenario, shutting off heating function. Reset heating function as needed.
- **Heating function turns off?** Check to make sure there is liquid in mug. Check App settings to make sure auto shutoff time is set properly. Reset heating function as needed.
- **Too many notifications?** Turn off notifications in the App and use only as desired.
- **Popping sound from lid during use?** Remove slider and beverage residue during each cleaning. Clean slider channel in lid.
- **LED display reads Ht?** Liquid inside mug is above 160°F and is extremely hot. Recommend allowing liquid to cool before consuming.
- **Want to set exact temperature?** Download App to set temperature by degree. Touch button is limited to setting in increments of 5 degrees Fahrenheit

## Mug Care Instructions

- Power off completely with button on bottom of mug. Display will flash "Bye" and mug will shutoff completely.
- Hand wash mug only with mild soap and water.
- Wipe dry or allow to air dry.
- Remove lid and lid slider to clean separately.
- Remove slider on lid by closing and using finger to push upwards from the under side until it releases. Use handle end of spoon to push if difficult.
- Do not place mug on charging coaster until completely dry.
- Do not place on charging coaster wet.
- Do not put in the dishwasher.
- Do not microwave.

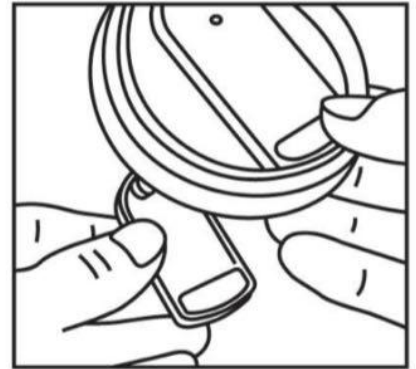
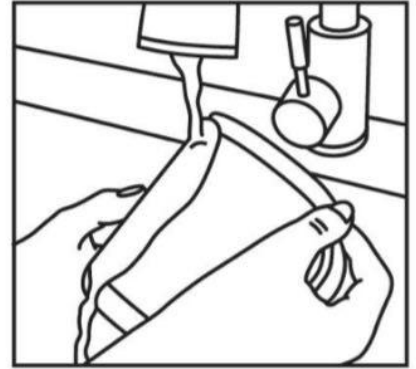

## Coaster Care Instructions

- Unplug coaster to wipe clean or when not in use for long periods.
- Wipe with a soft cloth to remove dust. You may use damp cloth to remove any residue only while unplugged.
- Never use abrasive cleaning agents.
- Do not get coaster wet. In the event of a spill, unplug coaster immediately and dry completely.
- Heating time is based on maintaining temperature of liquid that is already hot while using the lid. Heating times may vary.

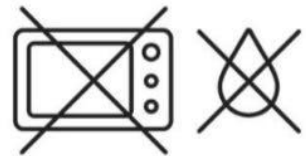

## **WARNING! IMPORTANT CARE AND SAFEGUARDS**

Failure to follow the safety instructions can lead to fire, electrical shock, personal injury or property damage and damage to this product. Risk of Electric Shock - exposed charging terminals. Do not place any foreign object or debris (FOD) on top of charging surface.

- Do not operate without liquid in the mug
- This mug is not intended to heat cold liquid or boil water
- Mug will continue to heat until powered off or unplugged
- Always unplug and power off completely prior to cleaning
- Do not submerge mug in water. Hand wash only. Not dishwasher safe
- Mug exterior is splash resistant, avoid getting exterior excessively wet while cleaning
- Do not use the mug if dropped or damaged in any way
- Never place mug in a microwave. Mug is not microwave safe
- Always use the specified power source
- Do not use a voltage converter / travel adapter
- Do not use the mug for anything other than it's intended use
- Keep away from extreme heat sources
- Always unplug power cord once beverage is consumed or when not in use

iPhone is a trademark of Apple Inc., registered in the U.S. and other countries. App Store is a service mark of Apple Inc., registered in the U.S. and other countries. Android, Google Play and the Google Play logo are trademarks of Google Inc. The Bluetooth® word mark and logos are registered trademarks owned by Bluetooth SIG, Inc.

### FCC Disclaimer:

This device complies with part 15 of the FCC Rules. Operation is subject to the following two conditions: (1) This device may not cause harmful interference, and (2) this device must accept any interference received, including interference that may cause undesired operation.

Any Changes or modifications not expressly approved by the party responsible for compliance could void the user's authority to operate the equipment.

Note: This equipment has been tested and found to comply with the limits for a Class B digital device, pursuant to part 15 of the FCC Rules. These limits are designed to provide reasonable protection against harmful interference in a residential installation.



This equipment generates uses and can radiate radio frequency energy and, if not installed and used in accordance with the instructions, may cause harmful interference to radio communications. However, there is no guarantee that interference will not occur in a particular installation. If this equipment does cause harmful interference to radio or television reception, which can be determined by turning the equipment off and on, the user is encouraged to try to correct the interference by one or more of the following measures:

- Reorient or relocate the receiving antenna.
- Increase the separation between the equipment and receiver.
- Connect the equipment into an outlet on a circuit different from that to which the receiver is connected.
- Consult the dealer or an experienced radio/TV technician for help.

**\*RF warning for Portable device:**

The device has been evaluated to meet general RF exposure requirement. The device can be used in portable exposure condition without restriction.