

User manual

Ceiling fan remote control kit

M/N:PJ-2206

INSTALLATION&ATTENTION

1. Make sure the circuit breaker has been turned off prior to installation.
2. Electrical installation should be performed by a qualified and licensed electrician.
3. The spliced conductor should be flipped up and carefully pushed into the outlet box.

SPECIFICATION.

Input Voltage	Max Fan Power	Max Light Power	FAN Timing Speed
100V/60Hz~240V/50Hz	145W	LED/150W Incandescent/500W	1H/2H/4H/8H H/M/L/STOP
Wireless Transmission: RF 433MHz			

Wiring schematic diagram for receiver and remote function

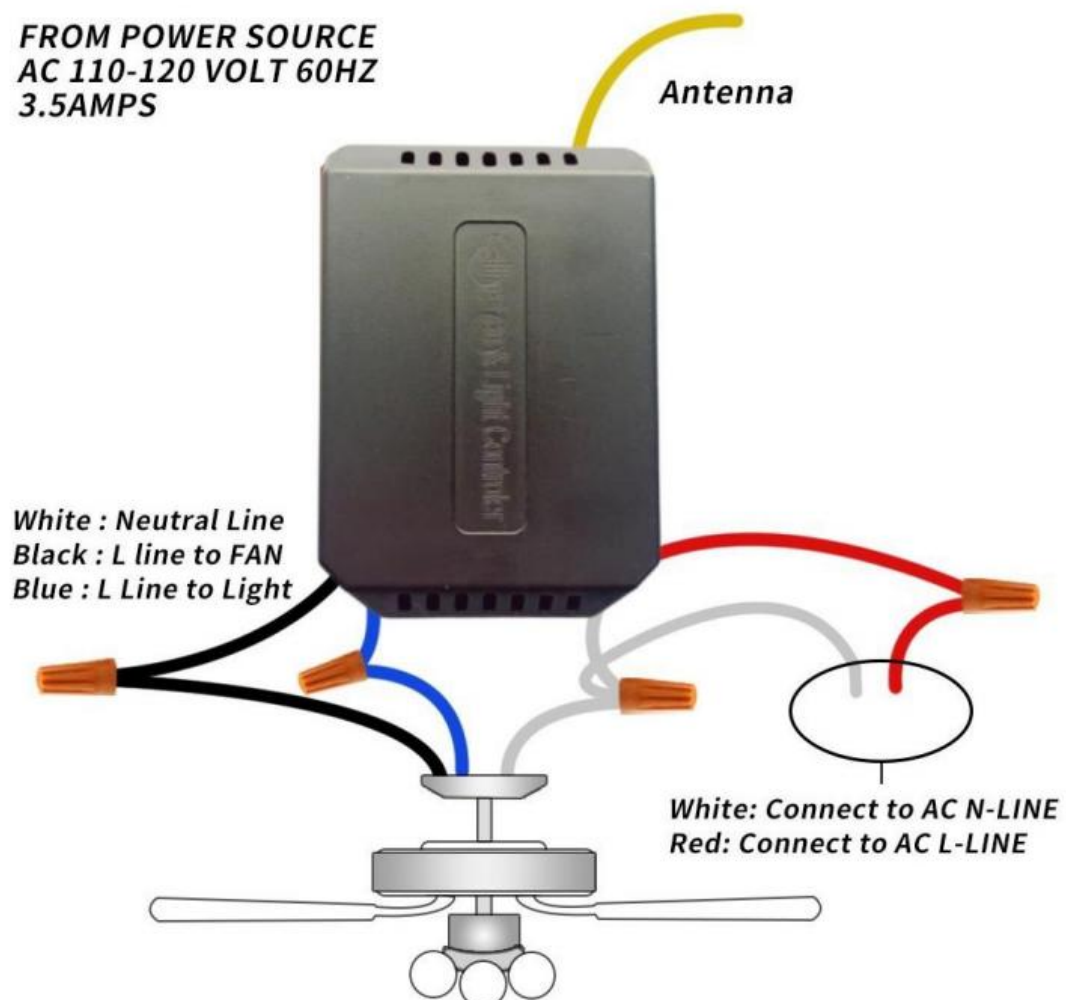

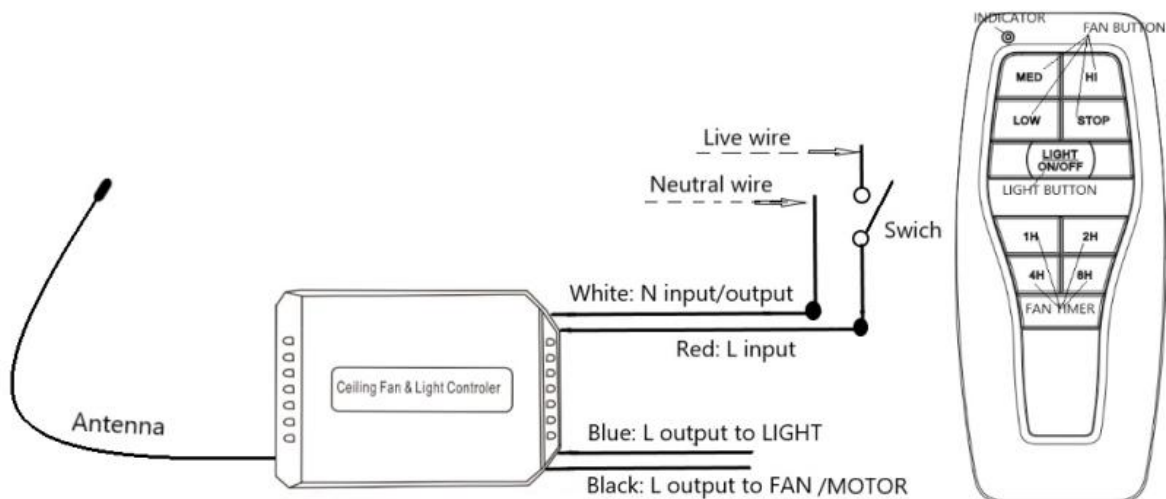

Install the mobile APP



Scan the code with your smartphone and download and install SMARTLIFE APP, Then register your user account, create and name your smart home, such as "My Home", "My Office", etc.

SETTING

Turn on the ceiling fan power, then press and hold '8H' on the remote control for 3 seconds, when you hear a short beep of 'B-----', it means the receiver enters the distribution network status.

Quick configuration

Turn on your smartphone. Open **SMARTLIFE APP** for just a moment to find the device and pop up the pop-up window shown in 'Figure 1'

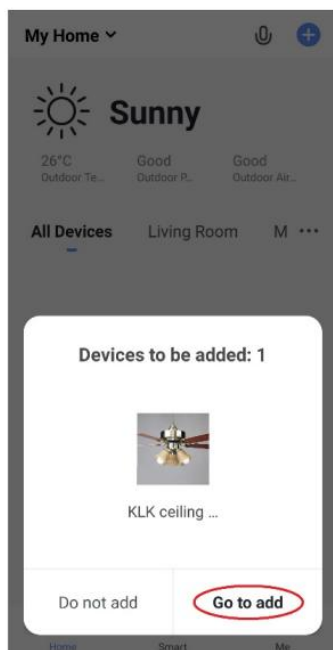

Figure 1

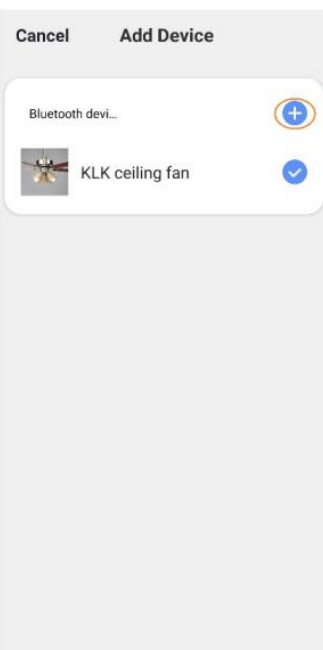

Figure 2

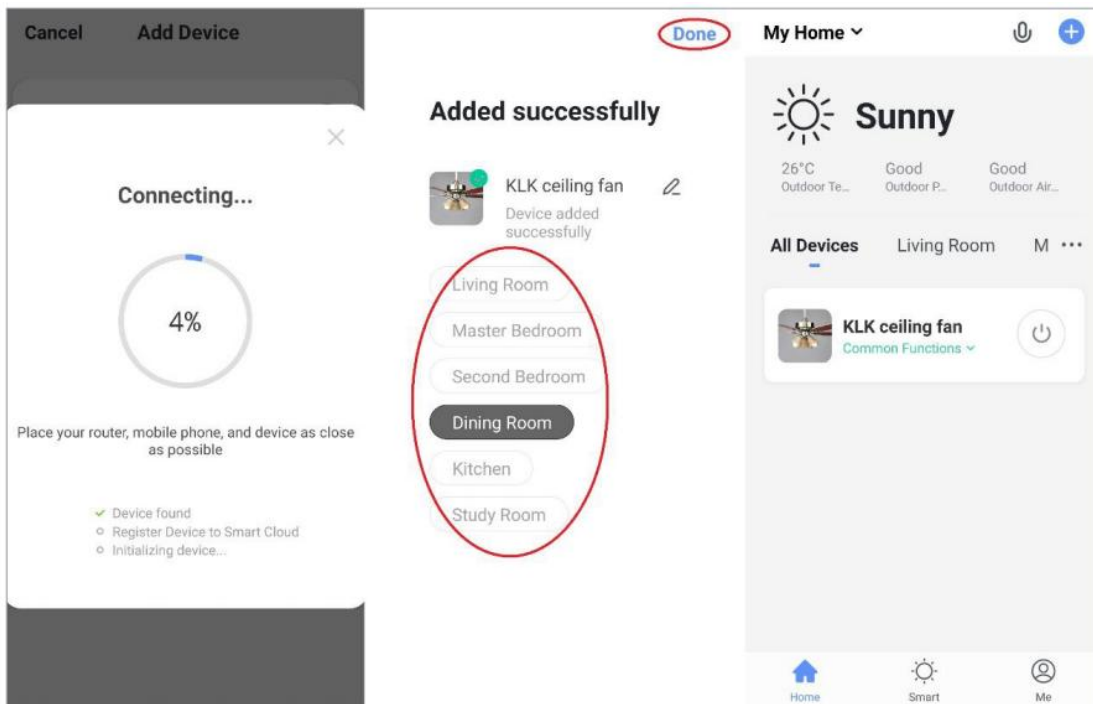



Figure 3

Figure 4

Figure 5

Congratulations, you can now control ceiling fans and lights remotely with your mobile device. The various smart devices in your home should be named for ease of device management.

TIPS: 1.  **Beep ON or OFF:** ①Take your remote, press and hold down the **STOP** button 6S ; ②Follow **SMARTLIFE** app turn on or off the beep.

2. If you have multiple smart devices in the same house, such as lights or fans or others. Name each device separately in the **SMARTLIFE** app so that the voice assistant can recognize it.

Enable and supported voice assistant

- **ALEXA**
- **GOOGLE**
- **TMALL GENIE**

Buy and install voice assistant system and devices like Amazon speakers and discover smart devices, then all the smart devices will appear in the voice assistant system. Now you can use Voice Assistant to control your ceiling fans and lights.



FCC Statement

This device complies with Part 15 of the FCC rules. Operation is subject to the following two conditions: 1) this device may not cause harmful interference, and 2) this device must accept any interference received, including interference that may cause undesired operation.

Note: This equipment has been tested and found to comply with the limits for a Class B digital device, pursuant to part 15 of the FCC Rules. These limits are designed to provide reasonable protection against harmful interference in a residential installation.

This equipment generates uses and can radiate radio frequency energy and, if not installed and used in accordance with the instructions, may cause harmful interference to radio communications. However, there is no guarantee that interference will not occur in particular installation. If this equipment does cause harmful interference to radio or television reception, which can be determined by turning the equipment off and on, the user is encouraged to try to correct the interference by one or more of the following measures:

- Reorient or relocate the receiving antenna.
- Increase the separation between the equipment and receiver.
- Connect the equipment into an outlet on a circuit different from that to which the receiver is connected.
- Consult the dealer or an experienced radio/TV technician for help.

Changes or modifications not expressly approved by the party responsible for compliance could void the user's authority to operate the equipment.

FCC RF Radiation Exposure Statement

The device has been evaluated to meet general RF exposure requirement. The device can be used in portable exposure condition without restriction.