



LYNKSYS TECHNOLOGIES CO., LTD.

● **Note**

- Before using the product, please read the Quick Guide to fully benefit from it.
- This product involves constant upgrading and/or improvement, our company reserves the right to change the specifications of software and/or hardware mentioned in this operating guide without any prior notice. The product specifications and information mentioned in the operating guide are for reference only.

Check list

- Please check the following accessories before you discard the packing material. Please contact your local dealer
- immediately if there is any missing or damage parts.

Accessories	Quantity
LM500	1
Power cable	1
Bracket	1
Quick Start Guide	1
Antenna	1
Palm Mic	1

1. Overview of LM500



● LED indicator light

Operating state	Indication
Standby	Green(Blinking)
Searching Network	Green(Fast Blinking)
Power On	Green(Blinking)
PTT Transmitting	Green(Steady)
PTT Receiving	Green(Steady)
Offline	Red(Steady)

2. Installation of SIM card

1. Uncover the SIM slot at the back of the LM500
2. Insert the SIM card as shown in the picture
3. Insert the SD card into the slot as show in the picture
4. Cover the slot

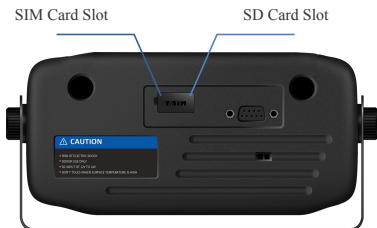

3. Power the LM500

Connect the power cable to the rear of the LM500

Risk of electric shock

Dry location use only DC output of 16 volts



WARNING: MAKE SURE YOUR LM500 IS POWERED OFF WHEN IT'S NOT IN USE.

Important:

Use only the approved wire.

Do not connect to the wrong wire.

4. Basic operations

● Start up

Long press the power button until the LM500 starts up.

● Shut Down

Long press the power button, select the “power off” when the option shows on screen to shut down the UE.

● Button/Antenna Interaction

- P1: Substitute PTT button when your Palm Microphone is not able to properly used.
- P2: Return key - press and return to the last menu
- P3: Home key - press and return to home screen directly
- P4: Menu key - press and show the current pages.
- Antenna: Make sure the antenna will not affect the vision of your driving and set it up properly.

● WiFi Connection

Go to the Settings > WiFi interface. Enable the WIFI option (single click to revert the status), switch to find the right access point you want to connect to, single click the right access point then input the password in (Single click to input uppercase, double click to input lowercase). Switch to select

inputting characters. Click “√” to confirm / exit the password inputting.

● **GPS Location**

Go to the Settings > Location interface, single click to enable or disable GPS location.

● **Date & Time Configuration**

Go to the Settings > Date&Time interface, single click to configure time display format.

● **Bluetooth Connection**

Go to the Settings > Bluetooth interface, Switch to choose “PTT Button”, single click to enable Bluetooth connection, after Scanning for a while, switch and find the right device name, single click to confirm bonding to the Bluetooth button, others Bluetooth device please choose “Headset” with the same operation.

● **Cellular Data Connection**

Go to the Settings > Cellular data interface, single click to revert enable or disable cellular data connection.

● **Language**

Go to the Settings > Language interface, switch and single click to choose the right language.

● **Factory Reset**

Go to the Settings > Reset interface, under the interface “Are you sure about recovery?”, switch the options, choose “Yes” to reset and “No” to exit.

● System Information

Go to the Settings > About interface, find the device and SIM card information including Operation System Version, IMEI Code, Battery Percent, SIM Name, SIM Level, SIM Type.

● System Update

Go to Settings > System Update interface, single click to check updates.

● 5. Basic Installation

This section describes how to install LM500 in the vehicle

● Overview

Below is the overview of the LM500 with buttons and ports



Figure 5-1



Figure 5-2

● 5. Basic Installation

This section describes how to install LM500 in the vehicle

● Procedure

1. Install the bracket to the vehicle. See Figure 5-3
2. Secure the LM500 to the U-shape bracket. See Figure 5-4
3. Connect the RSM to the LM500. See Figure 5-5
4. Connect the power cable. See Figure 5-6



Figure 5-3 Installing the Bracket

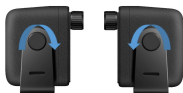

Figure 5-4 Secure LM500 to the U-shape bracket

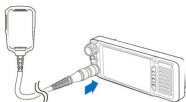

Figure 5-5 Connect the RSM to LM500



Figure 5-6 Connect the power cable to LM500

● Precautions for Installing a Bracket

A bracket must be installed to fix a vehicle-mounted terminal. When installing the bracket on the top of the center console or the inner side of the co-pilot's seat, pay attention to the following issues:

- If the surface of the place on which the bracket is installed is hard, ensure that all screws are securely fastened. Harden the installation surface if necessary.
- If the bracket is installed on a surface with a certain bending angle, bend the bracket slightly so that its bending angle is consistent with that of the installation surface.
- Ensure that the cables routing beneath the installation surface are not damaged during the drilling.

● Precautions for Routing Cables

Power cables, LTE antenna cables must be routed properly inside the vehicle. Do not bend a cable to form a sharp corner to avoid damages or electrical performance changes to the cable.

When routing cables, minimize:

- Coupling between cables and the electronic control system in the vehicle
- Coupling between an electrical system in the vehicle (for example, an alternator) and the LM500

● Check Items

All components and cables must be installed in compliance with the following requirements:

- The LM500 and the bracket are unshakable.
- All cables on the LM500 are correctly connected and secured.
- All cables are properly routed and fixed inside the vehicle, and exposed cables do not hinder operations in the vehicle.
- The LTE antenna is installed securely and unshakable, meeting the cabling requirements.
- All components and antennas are securely installed and do not shake during the ride.



LYNKSYS TECHNOLOGIES CO., LTD.

FCC Caution.

This device complies with part 15 of the FCC Rules.

Operation is subject to the following two conditions:

- (1) This device may not cause harmful interference, and
 - (2) this device must accept any interference received, including interference that may cause undesired operation.
- Any Changes or modifications not expressly approved by the party responsible for compliance could void the user's authority to operate the equipment.

Note: This equipment has been tested and found to comply with the limits for a Class B digital device, pursuant to part 15 of the FCC Rules. These limits are designed to provide reasonable protection against harmful interference in a residential installation. This equipment generates uses and can radiate radio frequency energy and, if not installed and used in accordance with the instructions, may cause harmful interference to radio communications. However, there is no guarantee that interference will not occur in a particular installation. If this equipment does cause harmful interference to radio or television reception, which can be determined by turning the equipment off and on, the user is encouraged to try to correct the interference by one or more of the following measures:

- Reorient or relocate the receiving antenna.
- Increase the separation between the equipment and receiver.
- Connect the equipment into an outlet on a circuit different from that to which the receiver is connected.
- Consult the dealer or an experienced radio/TV technician for help.

This equipment complies with FCC radiation exposure limits set forth for an uncontrolled environment. This equipment should be installed and operated with minimum distance 20cm between the radiator & your body.