

## SAFETY NOTE

1. This appliance can be used by children aged from 8 years and above and persons with reduced physical, sensory or mental capabilities or lack of experience and knowledge if they have been given supervision or instruction concerning use of the appliance in a safe way and understand the hazards involved.
2. Children shall not play with the appliance.
3. Cleaning and user maintenance shall not be made by children without supervision.
4. If the supply cord is damaged, it must be replaced by the manufacturer, its service agent or similarly qualified persons in order to avoid a hazard.
5. **WARNING:** the drive shall be disconnected from its power source during cleaning, maintenance and when replacing parts.
6. The instructions shall state that the A-weighted emission sound pressure level of the drive is equal to or less than 70 dB(A), e.g. by writing  $L_{pA} \leq 70 \text{ dB(A)}$ .
7. The mass and the dimension of the driven part shall be compatible with the rated torque and rated operating time.
8. The type of driven part the drive is intended for.
9. **WARNING:** Important safety instructions. It is important for the safety of persons to follow these instructions. Save these instructions.
10. Do not allow children to play with fixed controls. Keep remote controls away from children.
11. Frequently examine the installation for imbalance and signs of wear or damage to cables and springs. Do not use if repair or adjustment is necessary.
12. Watch the moving shutter and keep people away until the shutter is completely closed.
13. **WARNING:** Important safety instructions. Follow all instructions, since incorrect installation can lead to severe injury.
14. Before installing the drive, remove any unnecessary cords and disable any equipment not needed for powered operation.



Li-ion



Do not dispose of in general waste.  
Please recycle batteries and damaged electrical products appropriately.

## Features

- Built-in Receiver
- Jog & Tilt
- Built-in Lithium Battery
- Scan and Program
- Status Feedback
- Switch Direction
- Stall Protection
- Program Button
- Reset to Factory Mode
- Memorized Setting
- Electronic Limit
- Preferred Stop Position
- Speed Regulation
- Scene Control

## Fields of Application



The motor is suitable for motorization of roller blinds.

## Specifications

Working temperature: -10°C ~ +55°C	Radio Frequency: 433.92MHz Max-
Input Voltage: USB 5V 1A / USB 5V 2A	imum Running Time: 6 minutes

\* For more motor models and specific torque, please refer to the nameplate.

## Attention

Never drop, knock, drill or submerge the motor. Keep the power cable in right position as following.  
Important safety instructions to be read before installation.  
Incorrect installation can lead to serious injury and will void manufacturer's liability and warranty.

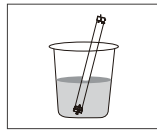

×

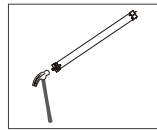

×

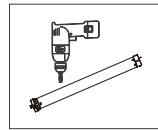

×

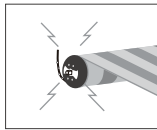

×

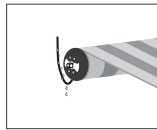

✓

## Rechargeable Battery



Blinking red  
during operation;  
Charge the battery



Blinking green;  
battery is charging



Continuously green;  
battery is fully charged

## Charging Instructions

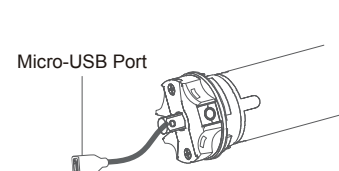

Micro-USB Port

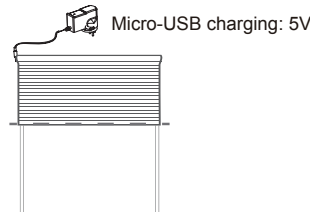

Micro-USB charging: 5V

This motor has a 12V built in Li-ion battery pack with integrated charge management.

Max power input for recharging: 5V 2A.

Before first use please charge motor for 6 hours. Using 5V charger (most phones charger is 5V).

During operation, motor will stop running when the voltage is lower than 8.0V and it will resume again when the voltage is greater than 8.5V.

During operation, motor will stop buzzer sounds when the voltage is lower than 7.0V and it will resume again when the voltage is greater than 7.5V.

When the motor is running continuously when the voltage is lower than 10.5V, the buzzer sounds 10 times and the red light will flash for 10 times for low pressure alarm.

## Motor Installation

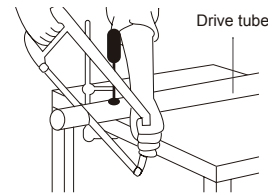

Step 1 Cut drive tube to required length.

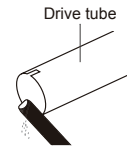

Step 2 Ensure tube edge is clean and burr-free.

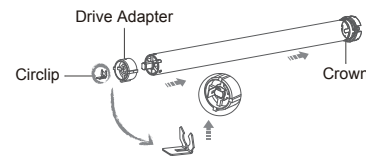

Step 3 Mount correct crown & drive adapter on the motor. Make sure drive adapter fits firmly and crown rotates freely.

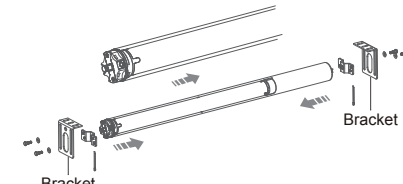

Step 4 Align the notches on the crown and drive adapter with the drive tube, slide and fit the motor into drive tube. Mount idler and bracket on both ends.

## Caution

1. Do not expose motor to humid or extreme temperature conditions.
2. Do not drill into motor.
3. Do not cut the antenna and keep it clear from metal objects.
4. Do not allow children to play with this device.
5. If power cable or connector is damaged, do not use.
6. Ensure correct crown and drive adaptor are used.
7. Ensure power cable and aerial are clear and protected from moving parts.
8. Cable routed through walls shall be properly isolated.
9. Motor is to be mounted in horizontal position only.
10. Before installation, remove unnecessary cords and disable equipment not needed for powered operation.
11. Installation and programming to be performed by a qualified professional, use or modification outside the scope of this instruction may void warranty.
- 12.This device complies with Part 15 of the FCC. Operation is subject to the following two conditions:

(1) this device may not cause harmful interference, and (2) this device must accept any interference received, including interference that may cause undesired operation.

Any changes or modifications not expressly approved by the party responsible for compliance could void the user's authority to operate the equipment.

This equipment has been tested and found to comply with the limits for a Class B digital device, pursuant to part 15 of the FCC Rules. These limits are designed to provide reasonable protection against harmful interference in a residential installation. This equipment generates uses and can radiate radio frequency energy and, if not installed and used in accordance with the instructions, may cause harmful interference to radio communications. However, there is no guarantee that interference will not occur in a particular installation. If this equipment does cause harmful interference to radio or television reception, which can be determined by turning the equipment off and on, the user is encouraged to try to correct the interference by one or more of the following measures:

—Reorient or relocate the receiving antenna.

—Increase the separation between the equipment and receiver.

—Connect the equipment into an outlet on a circuit different from that to which the receiver is connected.

—Consult the dealer or an experienced radio/TV technician for help.

To satisfy FCC /IC RF exposure requirements, a separation distance of 20 cm or more should be maintained between the antenna of this device and persons during device operation.



Important Safety Instructions To Be Read Prior To Operation.

## Setting Notice

Please read following points of attention carefully before setting.

1. Don't operate motors when low voltage alarm.
2. Operating:
  - ①The valid interval of the emitter button is 10S, the emitter will quit the set after 10S.
  - ②The motor will jog or beep for hint, please do the next step after the hint.
3. Set the limit position:
  - ①After the upper / lower limit setting, and the upper / lower limit position can't at the same position.
  - ②After the limit setting, with power off and memory function.
  - ③Limit delete will clear all limit memory.
  - ④It will exit limit setting when program there is no operation for 2 minutes.
4. If the emitter lost, please set up again with the new emitter.
5. One motor can store maximum 10 channels; after fully stored, if pair new channels, only the last one will be covered circularly.

## Button Instructions

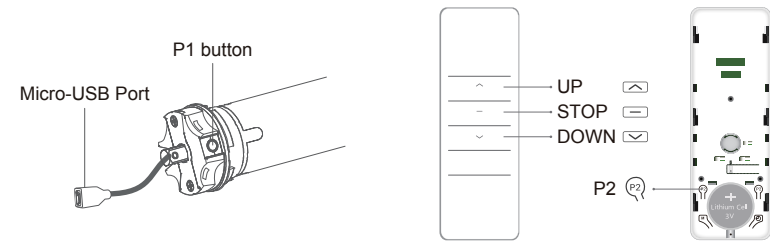

\*The P1 button is the charging indicator light.

Functions of P1 button

1. Cycle Operation: Press P1 button once and every press the motor will run upward→stop→downward, cycle in turn.
2. Pairing or Pair/unpair Additional Emitter: Press P1 button for 2S, motor jog once, release button and make a long noise, motor is ready for pairing or pair/unpair additional emitter.
3. Radio Lock: Press and hold P1 button for 6S, the motor will jog twice, release button and beep twice, the motor enters radio lock status, the motor won't receive any signal; press P1 button once to disable Radio Lock.
4. Switch Direction: Press and hold P1 button for 10S, the motor will jog 3 times, release button and beep 3 times, the running direction of the motor has been changed.
5. Reset to Factory Mode: Press and hold P1 button for 14S, the motor will jog 4 times, release button and beep 4 times, the motor has been reset to factory mode.At this point the motor will go into deep sleep. Short press P1 button, the red LED flashes 2 times, indicating that the motor is in deep sleep state and cannot control the motor operation. At this time, you need to press P1 button for 2S and then the motor turns to prompt to exit deep sleep.



## Essential Settings

The steps in factory mode must be completed to ensure proper operation.

## Factory mode

### 1 Pairing

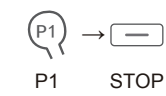

Press P1 button for 2S (1 jog), release button and make a long noise, within 10S, press STOP for 2S (2 jogs and 3 beeps), the motor has been paired successfully.

\* If within 10S, the motor doesn't receive STOP signal from the any emitter, it will exit the pairing mode automatically. Re-power on after power off, if the motor has saved the emitter, there is no rotation and beep prompt, and the code matching status is not automatically entered at this time.

## 2 Switch Rotating Direction (Optional)

If press UP, the motor runs downward, try below to switch direction



Press and hold UP and DOWN buttons simultaneously for 2S (1 jog and 1 beep) , the direction has been switched successfully.

\* The operation is only valid when there is no limits. If the motor has already set the upper and lower limit, then you can only switch direction by P1 button.

## 3 Upper and Lower Limits Setting

### 1 Set upper limit



Press UP for 2S, operate the motor to desired upper position, press and hold UP and STOP buttons simultaneously for 2S (2 jogs and 3 beeps), upper limit is set.

### 2 Set lower limit



Press DOWN for 2S, operate the motor to desired lower position, press and hold DOWN and STOP buttons simultaneously for 2S (2 jogs and 3 beeps), lower limit is set.

\* If exit the limits setting status before you finish the limit setting, then the motor will take the previous limits if has; After the limits have been set successfully, the motor will enter the user mode.

## User mode

### 1 Add A Preferred Position

#### 1 Set preferred position

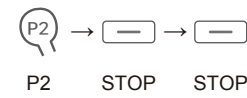

Check both upper and lower limits are set. Operate the product to desired preferred position. Press P2 (1 jog and 1 beep), press STOP(1 jog and 1 beep), STOP again (2 jogs and 3 beeps), the preferred position is set.

#### 2 Remove preferred position

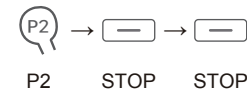

Press P2 (1 jog and 1 beep), press STOP (1 jog and 1 beep), STOP again (1 jog and make a long noise), the preferred position is deleted.

\* In the normal running mode, if the motor is not at the preferred position, press STOP button longly, then the motor will run directly from the current position to the preferred position ( apply for roller systems); In the jog mode, press STOP button longly, firstly, the motor runs from the current position to the lower limit then to the preferred position (apply for cord-lifting system)

## 2 Jog Mode & Running Mode Switch



Press and hold UP and DOWN buttons simultaneously for 5S, motor jog once, press STOP (1 jog ),switch to jog mode, if motor jog twice, switch to running mode.

\* When in jog mode, press UP or DOWN once, the motor will be jog running, if press more than 2 second, the motor will be continuously running.

## 3 Adjust Limits

### 1 Adjusting the upper limit



Press and hold UP and STOP buttons for 5S (1 jog and make a long noise), operate the product to desired new upper limit position, press and hold UP and STOP buttons for 2S (2 jogs and 3 beeps), the new upper limit is programmed successfully.

### 2 Adjusting the lower limit



Press and hold DOWN and STOP buttons for 5S (1 jog and make a long noise), operate the product to desired new lower limit position, press and hold DOWN and STOP buttons for 2S (2 jogs and 3 beeps), the new lower limit is programmed successfully.

## 4 Pair / Unpair Additional Emitter

### Method one

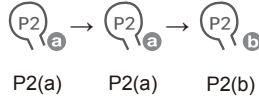

Press P2 (1 jog and 1 beep) and P2 (1 jog and 1 beep) on existing emitter, press P2 on new emitter to add (2 jogs and 3 beeps), new emitter is paired to the motor.

• Repeat same procedure will unpair additional emitter.

### Method two

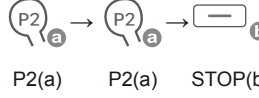

Press P2 (1 jog and 1 beep) and P2 (1 jog and 1 beep) on existing emitter, press STOP on new emitter for 2S to add (2 jogs and 3 beeps), new emitter is paired to the motor.

### Method three

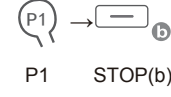

Press P1 button for 2S (1 jog), release button and make a long noise, press STOP on new emitter for 2S to add (2 jogs and 3 beeps), new emitter is paired to the motor.

• Repeat same procedure will unpair additional emitter.

\* (a) as existing emitter,(b) as new emitter to pair/unpair; All the setting of the motor will be kept after adding the new emitter.

## 5 Speed Regulation / Setting Motor Slow Stop Operation Mode

### 1 Acceleration setting / Activate the motor slow stop operation mode



Press P2 (1 jog and 1 beep), UP (1 jog and 1 beep), UP again (2 jogsand 1 beep), the motor running speed is accelerated. When the motor is at the Max. speed, the motor no response after the last operation, and the motor slow stop operation mode is activated.

### 2 Deceleration setting / Deactivate the motor slow stop operation mode



Press P2 (1 jog and 1 beep), DOWN (1 jog and 1 beep), DOWN again (2 jogs and 1 beep), the motor running speed is decelerated. When the motor is at the Min. speed, the motor no response after the last operation, and the motor slow stop operation mode is deactivated.

Model	Max. speed (rpm)	Med. speed (rpm)	Min. speed (rpm)
DM35(45)LEU/S-3/28	28	24	20
DM35LEU/S-13/13	13	10	7
DM35(45)LEU/S-6/24	24	20	16
DM45LEU/S-10/9	9	7	5

\* The factory default is the Max. speed. The slow stop mode is activated by default for 6N and 13N motors, and slow stop mode is deactivated by default for 3N and 10N motors.

## 6 Turn On / Off Charging Indicator Lamp



DOWN

At the lower limit, press and hold DOWN for 5S and the red indicator light flashes 3 times to indicate that the indicator light is turned on.

• Repeat same procedure will turn off the lamp.

\*When the indicator is set to off, the motor will still have 3 green LEDs when it is plugged into the USB. When the indicator is set to ON, the motor will not have 3 green LEDs when it is plugged into the USB.

## Quick Index

	Settings	Steps
1	Pairing	P1(hold down 2s) → Stop (hold down 2s)
2	Switch Rotating Direction	Up + Down (hold down 2s)
3	Upper and Lower Limits Setting	1 Set upper limit Up (hold down 2s) → Up + Stop (hold down 2s)
		2 Set lower limit Down (hold down 2s) → Down + Stop (hold down 2s)
4	Add / Remove Preferred Position	P2 → Stop → Stop
5	Jog Mode & Running Mode Switch	Up + Down (hold down 5s) → Stop
6	Adjust Limits	1 Adjusting the upper limit Up + Stop (hold down 5s) → Up or Down → Up + Stop (hold down 2s)
		2 Adjusting the lower limit Down + Stop (hold down 5s) → Up or Down → Down + Stop (hold down 2s)
7	Pair / Unpair Additional Emitter	P2(a) → P2 (a) → P2(b)
		P2(a) → P2 (a) → Stop (b) (hold down 2s)
		P1(hold down 2s) → Stop (b) (hold down 2s)
8	Speed Regulation / Setting Motor Slow Stop Operation Mode	1 Acceleration setting / activate the motor slow stop operation mode P2 → Up → Up
		2 Deceleration setting / deactivate the motor slow stop operation mode P2 → Down → Down
9	Turn On / Off Charging Indicator Lamp	Down (hold down 5s)

## Troubleshooting

Issues	Possible causes	Solution
The motor has no response	Power Failure Or Incorrect Connection	Double check power and cable connections, follow wiring instructions.
	emitter battery is low capacity	Replace battery
	Radio interference / shielding	Check antenna on motor is intact and exposed. Check for possible source of radio interference.
	Out of radio control range	Try control within closer range
The emitter can't control single motor	Multiple motors are paired to the same channel.	Always reserve an individual correctly (refer to motor functions)
		Try to use multi-channel emitters to control multi-motor projects, ensure each channel to control one single motor
The motor doesn't run or starts too slowly or make loud noise	Connections are incorrect.	Check connections
	Incorrect installation or overload	Check installation or overload
The motor stops during the going up or going down.	The motor has reached the lower limit	Adjust the new lower limit
	Running time exceeds 5 min	Let the motor cool down for about 20 minutes



# DM35LEU/S

## Instruction | A-00

