



User

4K dash cam
touch screen

Manual

Model: J6

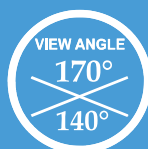



EXPERIENCING PROBLEMS?

- ▶ Problems of intallation/operation
- ▶ Product is not as described
- ▶ Item is defective/damaged
- ▶ Missing items?

**Please contact us before returning the item,
WE WILL HELP YOU RESOLVE ANY ISSUES ASAP.**

CUSTOMER SERVICE

E-mail



jomise-US@jomise-cam.com

EMAIL



WhatsApp



Just Scan the QR Code with your iPhone or Android's
Camera to get in touch with us.

jomise-US@jomise-cam.com

INDEX

Package Contents	1
Appearance	2
About TF Card	3
Installation	4
Home Screen	8
Power On/Off	9
About Time Setting	10
Button Function	11
About the Camera Settings	12
Playback Mode	14
GPS Information	15
About Wifi and App	17
FAQ	20
Product Specifications	22

PACKAGE CONTENTS



1* J6 4K Dash Cam



1* 1080P IP68 Rear Camera



1* Power Supply Cable



1* Rear Camera Cable



1* 32GB TF Card



2* Electrostatic Sticker



1* User Manual



1* 3M Adhesive



1* Clean Cloth

Appearance

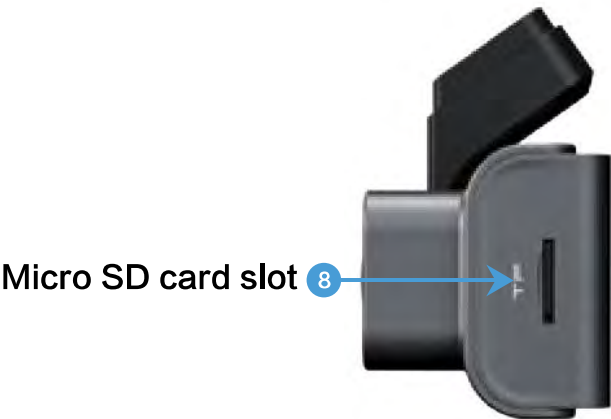
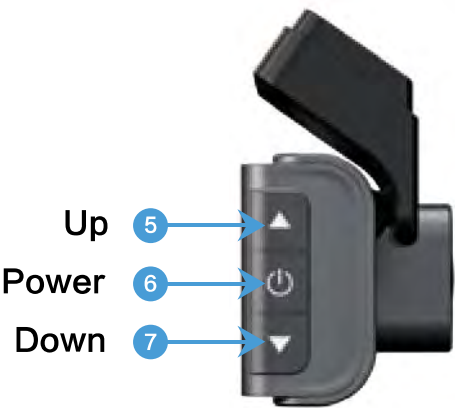
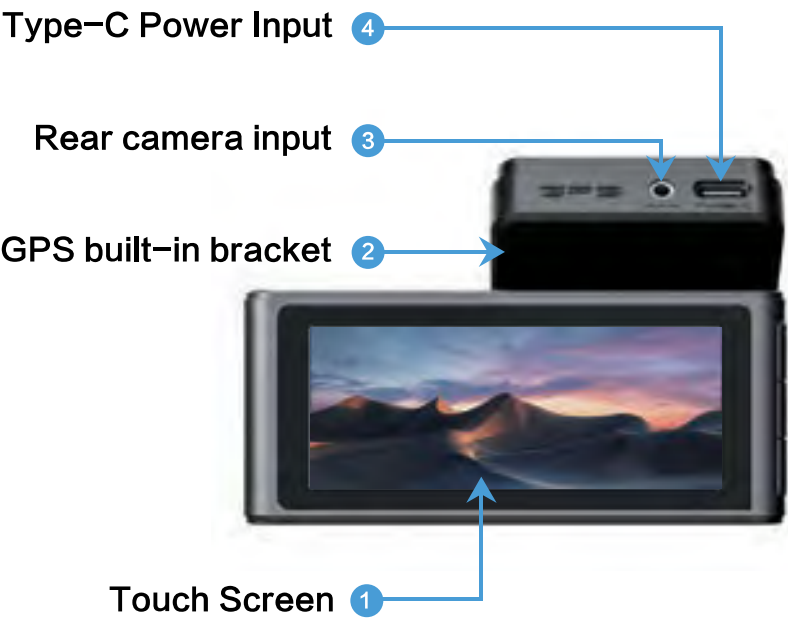

About TF Card

- ① Do not remove or insert a Micro SD card while the power is on.
- ② Use a Micro SD card with Class 10 or higher(8GB–256GB). We Recommend 64GB SAMSUNG Class 10, U3 Speed Micro–SD Card.
- ③ For stable use, it is recommended to format the micro SD card regularly.
Recommend: Once a month.



① To Install

Make sure the camera is turned OFF First. Then facing towards the front of the camera (Lens Side). Then insert the memory card half way in. Then use the finger nail or a paper clip to push the card all the way inward until it clicks and locks in place.

② To Remove

To remove the Micro SD card, gently push its edge inward until it clicks, and then pops out, then simply pull it out of the slot

If you experience camera FREEZING or LAGGING or STOPS Recording after few seconds. Then It is the issue of the MEMORY CARD. (NOT THE CAMERA ISSUE) – Please Contact US.

Installation

The camera comes with the default settings which allows you to start using your camera right out of the box without changing any settings. Make sure to format the memory card before first time use.

How to install the main body

- 1 Installation Position-Most people will install J6 next to the rear view mirror and opposite side from the drive. First, Stop the engine where there is some light and in a safe place.



- 2 Make sure to clean your windshield from the dust particles and attach the electrostatic sticker to the windshield.

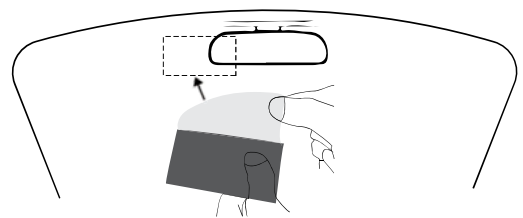

- 3 Peel off the 3M tape attached to the GPS built-in bracket and attach it on the electrostatic sticker on the windshield.

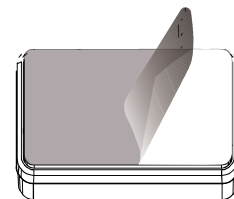

About electrostatic Sticker

- Since the adhesive strength is strong on both sides and it is difficult to peel off once it is pasted, it will be troublesome if the pasting position is incorrect. Therefore, we design the electrostatic sticker to attached to the windshield first, then stick the bracket with 3M Adhesive on the electrostatic sticker. You can easily readjust location by sticking the 3M Adhesive on electrostatic sticker and peel it off.
- To strengthen the fixing force, do not attach the main body and leave it for 24 hours or more.
- Re-sticking may weaken the adhesive strength of the tape and cause it to fall off. If you need more accessories, please CONTACT US.

- 4 Use the power cord to connect the micro USB Port of the product to car's cigarette lighter socket.

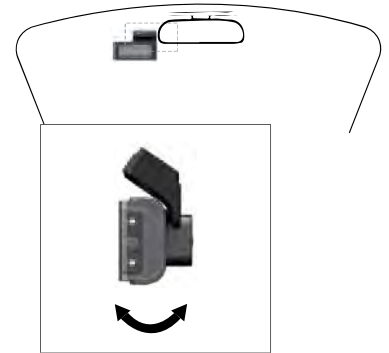

CAUTION

- ▶ Connect the cigar plug cord connector in the correct orientation. Connecting in the wrong direction may cause malfunction or damage. If you cannot connect successfully, check the connection part carefully before connecting.
- ▶ Only use JOMISE's Car Charger, otherwise the camera may frequently reboot or flicker LCD due to insufficient power.

How to install the rear camera

We recommend install the rear camera above the license plate.

- 1 Fix camera with 3M adhesive Find a best location, tear off the 3M adhesive on the rear camera, fix the rear camera near by the car license plate lamp. (if you need to adjust the angle, please attach the rear camera bracket to the rear camera and tighten it with screws first).



- 2 Remove the Panel
Remove your trunk's interior panel to expose the cars rear wiring chambers. Pop open your trunk and look for a solid interior panel covering the opposite side of your license plate mounting area. Then, insert a trim removal tool or other thin device behind the panel and pry it off.



- 3 Snake the cable
Use a trim removal tool to pop out tailgate trim, then run the cable from outside of the car into the trunk of your car.



- 4 Connect the rear cameras power cable to the extension cable.
After snaking your rear camera's extension cable, connect the power cable to your rear camera's extension cord.



*The red wire on the rear camera cable does not need to be connected. (Designed for another model of our products)

- 5 Route your rear camera's power cable to the front of the car.

If you'd like, use a trim removal tool to pop out the headlining panel directly above your windshield. Then, run your cable through the exposed chamber.



- 6 Power on the dash cam with box included car charger, don't charge it with your own chargers.



NOTE

- Make sure to remove the Plastic Lens Screen Protector from the lens before recording videos. Otherwise your videos will look blurry and blocked.
- Do not remove the Micro-SD card while the camera is turned ON. Otherwise it may cause memory card to be write protected and possible loss of data or damage your memory card.
- Always remove/insert memory card while camera is turned OFF.
- Do not use Socket distributor.
- Do not connect or disconnect the rear camera cable while the power is on. It will be the cause of the failure.
- The rear camera has 180° Flip Function, you can flip the rear camera according to your needs.

HOME SCREEN



Home Screen Status Icons

ICONS	WHAT DOES IT MEAN?
	The Red Light is Recording The Yellow Light is the Video Locked
	Loop Recording Timer
	Display Recording Resolution
	WIFI Information
	Current Date & Current Time
	Emergency Video Lock

ICONS	WHAT DOES IT MEAN?
	Turn ON/OFF Audio Recording
	Play/Pause Recording
	Photo Mode
	Playback Mode
	Enter the Settings
	Display GPS Status



CAUTION

- To prevent missing recording, after 30 seconds of inactivity, it will automatically return to the recording interface and start recording.

Power ON/OFF

<Power ON>

- If you turn on the engine (ACC on) while the cigar power adapter is connected, the power will be turned on automatically and the opening screen will be displayed.
- Press and hold the power button to turn off the power during startup, and then briefly press the power button again to turn on the power of the unit and display the opening screen.



Micro SD card check function

This product will check the Micro SD card at startup and will announce if it is not inserted or damaged, that can prevent missed shots.

<Power off>

- When the engine is turned off the power is automatically turned off.
- If you press and hold the power button while the power is on, the power of this unit will be turned off.



About time setting

The dash cam has the built-in GPS function, it will automatically update the time according to your location and time zone, so you do not need to manually change the time.

Please CONTACT US if you need help.

Video mode

When the engine is turned on, the power is automatically turn on.



Button Function

Button	Function
▲	Short Press to Enter the Settings; Long Press to Lock the Videos.
⏻	Short Press to Start/Pause Recording; Long Press to Turn ON/OFF the Camera.
▼	Short Press to Enter Playback; Long Press to Snapshot.

There are three resolutions:

Front 4K + Rear 1080P

Front 2.5K + Rear 1080P

Front 1080P + Rear 1080P



CAUTION

- ▶ Unlike other machines in the market, the J6 still maintains its 4k ultra-high resolution for simultaneous front and rear recording without the need to degrade the image quality to accommodate the proper operation of the chip.

Quick switch Front/Rear camera

You can switch between Front/Rear/Front+Rear Split-screen by swiping left/right on any area of the screen.



About the Camera Settings

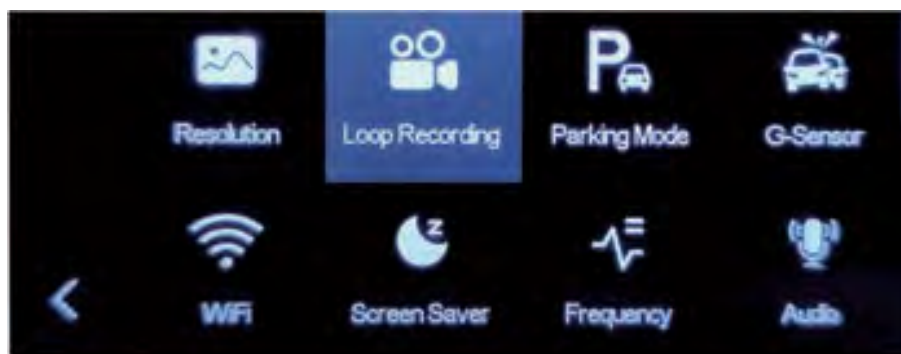

■**[Resolution]**: 3 modes resolution settings, You can choose the video resolution you like. Higher resolution videos will take more storage space.

■**[Loop Recording]**: 1/2/3 mins

This feature allows camera to continuously record loop by loop so it can delete the oldest video files automatically when the memory card becomes full so you don't have to manually delete them. This feature will split each video files to appropriate length based on your selection.

■**[Parking Mode]** : Requires hardwire kit(sold separately), not work without hardwire kit.

■**[G-Sensor]**: Off / low / medium / high

G-Sensor is a 3-axis impact gravitational accelerometer which is designed to detect physical and gravitational forces on the camera. The video will be locked-In the event when G-Sensor is triggered due to physical or gravitational impact force on the camera, the current loop cycle length of video file will be locked so it will NOT be deleted by loop cycle function.

■**[WiFi]**: WiFi on / off

■**[Screen Saver]**: OFF-This will keep the video ON all the time.

10S/30S/1Min-The screen will turn off, but the recording will remain.

■**[Frequency]**: Here you should choose the frequency accordingly to your power supply specification used in your country based on your geographical location.

60 Hz (USA - North America)

50 Hz (Europe - Most Asian Countries)

■**[Audio]**: Sound recording on/ off

J6 has built-in microphone to record audio with video.

You can choose to record mute video by choosing OFF. You can also press and hold DOWN button for 3 seconds to mute/ un-mute while video is being recorded.

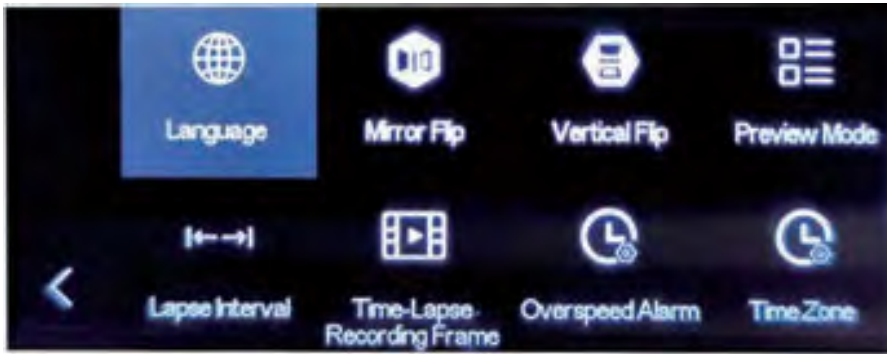

■**[Language]**: This setting allows you to choose your language setting for camera's firmware.

■**[Mirror Flip]**: You can Mirror image left and right.

■**[Vertical Flip]**: You can flip image up and down.

■**[Preview Mode]**: You can select Front/Rear/Front&Rear view.

■**[Time-Lapse Recording Frame Rate]**: 0.5S/1S/5S

■**[Time-Lapse Recording]**: Off/12H/24H

■**[Speeding Alert]**: You can set it by your favour.

■**[Time Zone]**: Here you can choose your desired or local time zone setting based on GMT value.



■**[GPS Info]**: This feature allow you to see your current geographical location in Latitude & Longitude.

■**[Date/Time]**: You do not need to manually adjust the time because GPS will automatically update the time based on your location.

■**[Time Format]**: Tap to select '24H' or '12H' to change time format to 12-Hours systems or 24-Hours systems

■**[Summer Time]**: Turn on/off daylight saving time

■**[Volume]:** - Off

- Low
- Middle
- High

■**[Format]:**This feature will allow you to format inserted memory card, all the data will be deleted.

■**[Default Setting]:**Here you can restore all the settings to factory default settings.

■**[Version]:**Here you can check the current firmware version installed on your camera. We will notify you via Amazon if there is a new software version.

Playback Mode

Playback mode lets you play your Video file or photos. It can even let you delete or lock any videos while viewing it.

Playback menu

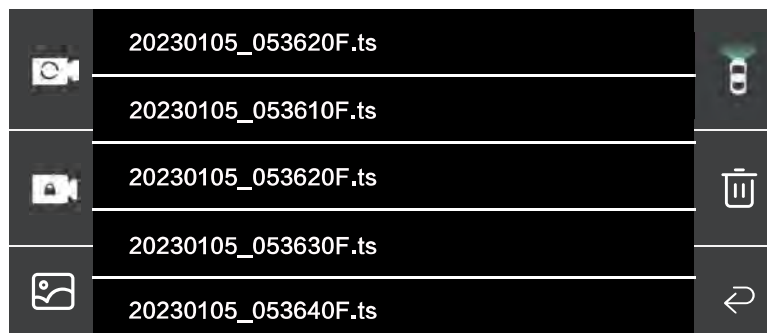

	Nomal files (F / R represents the Front, and Rear files)
	Locked files
	Photos
	Switch front and rear lens
	Delete document
	Return

GPS INFORMATION

View GPS Data with Software [GXPlayer]

If you need to track GPS information, please download the dedicated player, the download link(Compatible with Windows) is as follows:

<http://www.sunningsoft.com/en/pcgps.html>

For Mac, please search "GXPlayer" in App Store.

By using the file playback software [GXPlayer], you can check all drive information such as Time, Location, Speed, and so on



Scan the code
to download

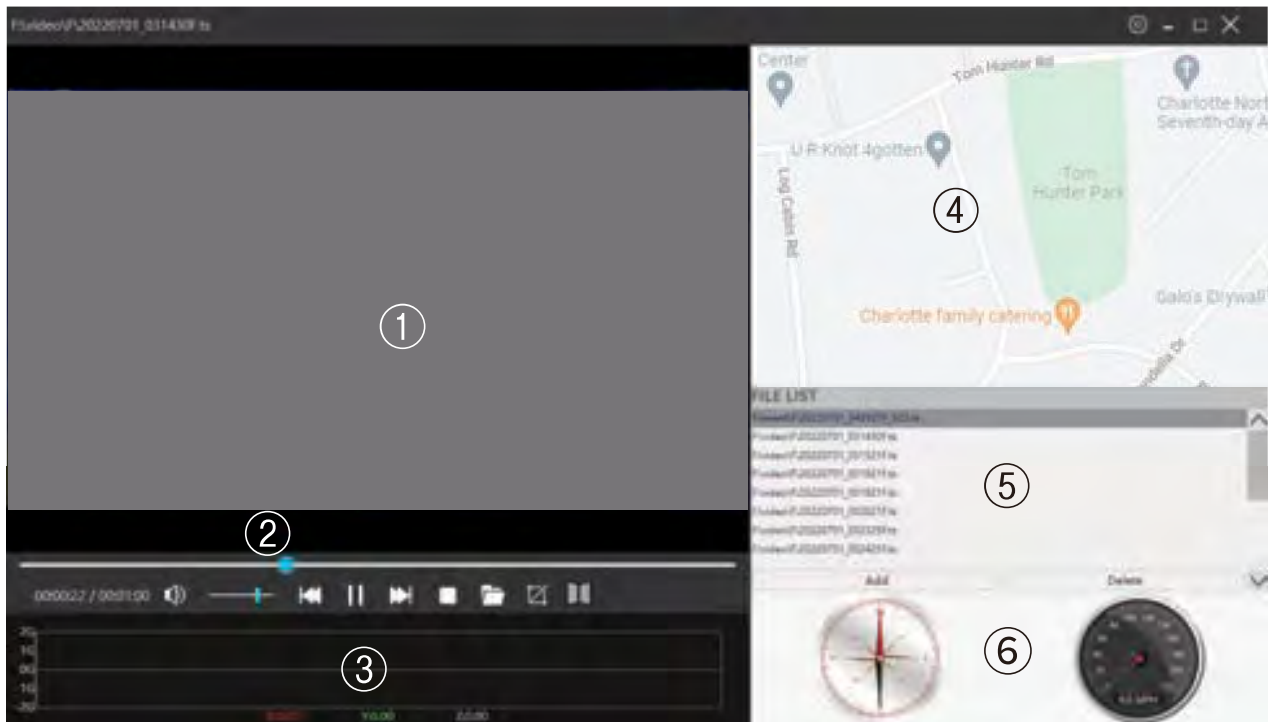

- ① Playback Screen: Playback screen display
- ② Scroll Bar: Click, can speed forward or back
- ③ G-sensor Data
- ④ Map Display: Show the location of the car on the map
- ⑤ Playlist: The data list for playback
- ⑥ GPS Information: Direction and Speed

About WiFi & APP

Wifi Connection

1. Download the DASH CAM WiFi APP

① Scan the below QR code to download the mobile APP [Topcam].



② On your Smartphone search Topcam. For iPhones search the APP Store or for Android devices via Google Play.

2. In the boot mode, turn on the mobile phone's WIFI.

WIFI name: CVR_*****

Password: 123456789

3. Open the mobile APP then you can use it.

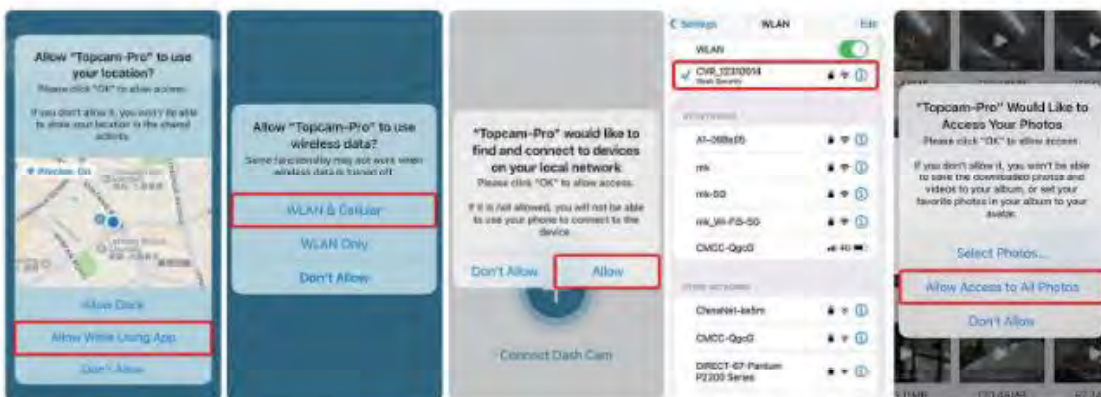

CAUTION

- ▶ When connecting to the app for the first time, please make sure the app has authorization to access: location, photo album, network, otherwise it will not work.

About WiFi & APP

Home

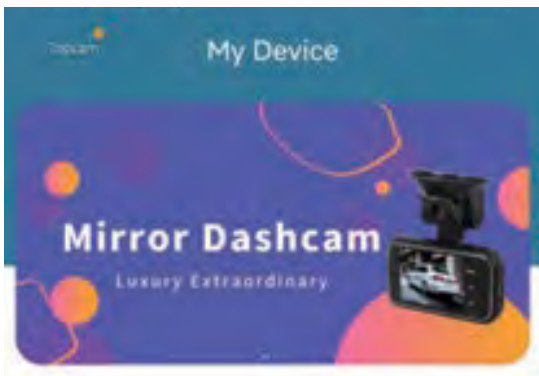

Local Album: You can download the files of video or photo, and save them in the local album.

Discover: You can view Installation Guide and FAQ.

Mine: You can enter your email address to login APP, set the App Language and submit the Feedback.



Dash Cam Interface



Video: You can view the files of Normal/Emergency videos, and download/delete them after selecting the files.

(All videos can be edited and shared, the edited videos will be saved in the Local Album of Wonderful.)



Photo: You can view the files of photos, and download/delete them after selecting the files.

Switch shoots: Switch the front/rear camera.

Snapshot: You can view the snapshot images.



Settings

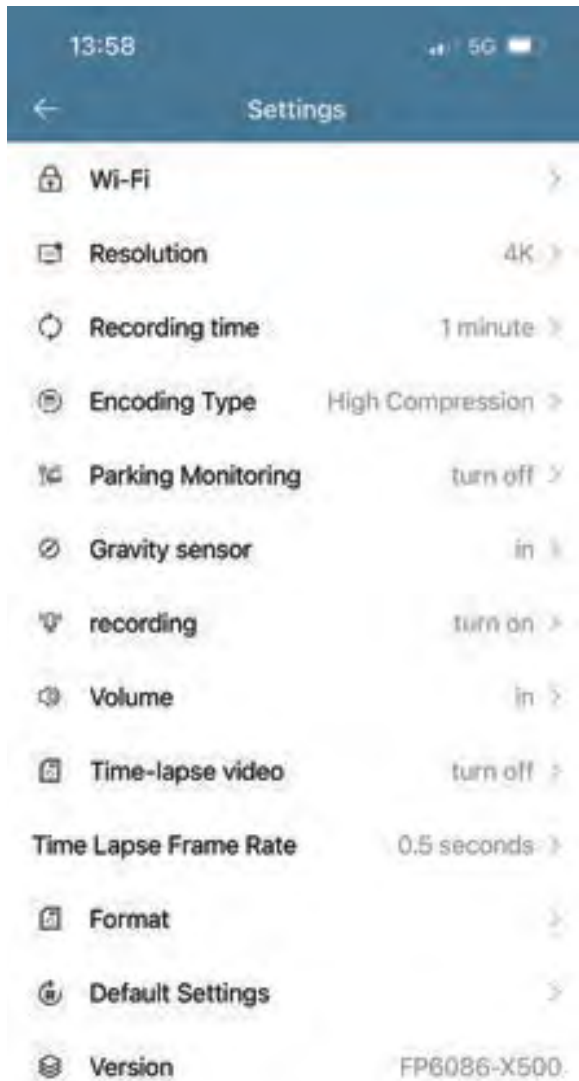

Wi-Fi: Modify the WIFI password.

Resolution: Select the resolution of camera.

Recording time: Set the loop time.

Encoding Type: Set the video encoding type.

Parking Monitoring: Turn On/Off 24H Parking Monitor. (This feature requires the connection of hardwire kit.)

Gravity sensor: Set the sensitivity of camera gravity sensing.

Recording: Turn On/Off audio recording.

Volume: Set the volume of camera.

Time-lapse video: Set the time of time-lapse recording.

Time Lapse Frame Rate: Set the frame rate of time-lapse recording.

Format: Format the TF card, and all the data will be erased. (It is recommended to format the card regularly every month)

Version: View the version of the camera.

FAQ

Under normal operating conditions, if there are problems with the device, please refer to the following methods to resolve.

Cannot take pictures or record video?

Please check whether there is enough space on the micro SD card or internal storage.

Stopping automatically while recording?

Due to the high amount of HD video data being recorded, please use a highspeed micro SD card. To tell if you have the required high speed card, check if it has the 'Micro SDHC' logo on the SD card and 8GB class 10 or above is recommended. Make sure that your card is labelled Micro SDHC and not Micro SDXC as SDXC cards will not work with this DASH CAM.

Fuzzy/dirty image?

Please check if the lens is filled with dirt or fingerprints and clean carefully. Please clean lens with cloth before shooting.

The videos are sometimes good and bad?

The camera effect has a lot to do with the light environment of the shooting, such as the backlight, front light, and the strength of the light, as a result, the video effect is different.

There are flashing stripes in the videos?

This is because the external artificial light source has different frequencies. At a specific frequency, the recorder display may have a flickering phenomenon, such as no flicker in natural light is normal.

Why is the DASH CAM not turning on in the car?

Please check and make sure that there is power in the cigarette lighter socket of your car.

Micro SD card not recognised by DASH CAM?

Format card in the APP's menu setting's before use.

A coloured tinge showing up in the video?

Make sure to peel off the transparent protective sticker on the front of the DASH CAM's lens.

Product Specifications

Model	J6
Display	3.16 inch IPS
Power	12V/24V
Aperture	1.8
Battery	Super capacitor
Video Format	Video:TS Still image:JPG
Loop recording	1/2/3mins
Recording method	Nomal recording / Emergency recording
Screen View	Front + Rear view / Front view / Rear view
Resolution	Front 4K + Rear 1080P / Front 2.5K + Rear 1080P Front 1080P + Rear 1080P
GPS	Yes
G-sensor	3 Axis G-sensor
Audio	Support sound recording and playback
Micro SD card	micro SD 8GB-256GB
Record photo oduction method	Main body display / Computer / Smartphone
Temperature	-20°C~70°C
Warranty period	1 Year

FCC Statement

This device complies with part 15 of the FCC Rules. Operation is subject to the following two conditions: (1) This device may not cause harmful interference, and (2) this device must accept any interference received, including interference that may cause undesired operation.

Note: This equipment has been tested and found to comply with the limits for a Class B digital device, pursuant to part 15 of the FCC Rules. These limits are designed to provide reasonable protection against harmful interference in a residential installation. This equipment generates, uses and can radiate radio frequency energy and, if not installed and used in accordance with the instructions, may cause harmful interference to radio communications. However, there is no guarantee that interference will not occur in a particular installation. If this equipment does cause harmful interference to radio or television reception, which can be determined by turning the equipment off and on, the user is encouraged to try to correct the interference by one or more of the following measures:

- Reorient or relocate the receiving antenna.
- Increase the separation between the equipment and receiver.
- Connect the equipment into an outlet on a circuit different from that to which the receiver is connected.
- Consult the dealer or an experienced radio/TV technician for help.

Note: The Grantee is not responsible for any changes or modifications not expressly approved by the party responsible for compliance. Such modifications could void the user's authority to operate the equipment.

The device has been evaluated to meet general RF exposure requirement.

To maintain compliance with FCC's RF exposure guidelines, the distance must be at least 20 cm between the radiator and your body, and fully supported by the operating and installation configurations of the transmitter and its antenna(s).



EXPERIENCING PROBLEMS?

- ▶ Problems of intallation/operation
- ▶ Product is not as described
- ▶ Item is defective/damaged
- ▶ Missing items?

**Please contact us before returning the item,
WE WILL HELP YOU RESOLVE ANY ISSUES ASAP.**

CUSTOMER SERVICE

E-mail



jomise-US@jomise-cam.com



MADE IN CHINA

jomise-US@jomise-cam.com