

### Package Includes:

- 1\* S98 Speaker
- 1\* Headset Mic
- 1\* Strap
- 1\* AUX Cable
- 1\* Type-C Charging Cable
- 1\* Manual



### After-sale service

WinBridge provide one year warranty and lifetime technical support.

Toll Free Hotline: +1 (833) 996-2881

info@winbridge.com

http:www.winbridgestore.com

Please be confident that seller support is just a mail away from you in case you find any difficulty, kindly do not hesitate to write back to us if you need any clarification or any kind of support.



9

harmful interference to radio communications.

However, there is no guarantee that interference will not occur in a particular installation. If this equipment does cause harmful interference to radio or television reception, which can be determined by turning the equipment off and on, the user is encouraged to try to correct the interference by one or more of the following measures:

- Reorient or relocate the receiving antenna.
- Increase the separation between the equipment and receiver.
- Connect the equipment to an outlet on a circuit different from that to which the receiver is connected.
- Consult the dealer or an experienced radio/TV technician for help.

The device has been evaluated to meet general RF exposure requirements. The device can be used in portable exposure conditions without restriction.

8

### Feedback or howling:

A: Align the microphone's microphone head with the corner of the mouth and keep a distance of 2-3 meters from the speaker.

B: In a smaller space, reduce the volume appropriately to avoid feedback or howling.

### FCC Warning:

Any Changes or modifications not expressly approved by the party responsible for compliance could void the user's authority to operate the equipment.

This device complies with part 15 of the FCC Rules. Operation is subject to the following two conditions:

- (1) This device may not cause harmful interference.
- (2) This device must accept any interference received, including interference that may cause undesired operation.

### Note:

This equipment has been tested and found to comply with the limits for a Class B digital device, pursuant to part 15 of the FCC Rules. These limits are designed to provide reasonable protection against harmful interference in a residential installation. This equipment generates use and can radiate radio frequency energy and, if not installed and used in accordance with the instructions, may cause

7

### Frequently Asked Questions:

**Q: The switch is turned on, but there is no sound.**

**A1:** If the screen is not lighting up, the power is low. Please charge it.

**A2:** If the volume is set to the minimum, please adjust the volume appropriately.

**Q: The microphone is paired with the speaker, but why is there no sound output from the microphone?**

**A:** Please ensure that the MIC.VOL on the speaker is turned on.If it is not, please turn it clockwise to increase the microphone volume.

**Q: Why is the battery indicator stil showing one bar after charging the speaker for several hours? Is the speaker's battery faulty?**

**A:** Please use a charger with an output of 5V-3A for charging. Chargers with an output lower than 2A will charge the device very slowly.It is not an issue with the speaker's battery itself.

**Q: What should I do if the speaker is disconnected from the microphone?**

**A:** In this case, it may be due to environmental interference, the microphone built-in 20 frequency points, you can repeatedly press the microphone 'M' key to switch the frequency point.

6



WinBridge

## Portable Pa System User Manual

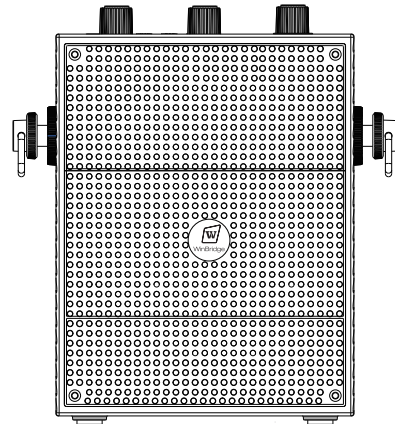

S98

### S98 Function Illustration:

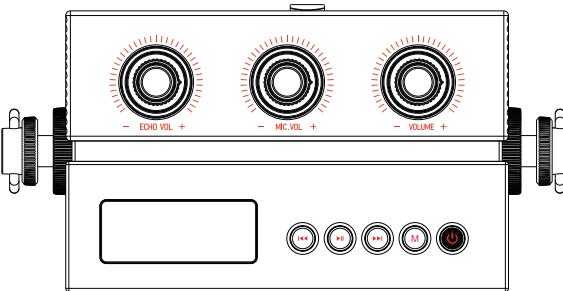

- Switch Key: Long press to power on and power off.
- Short press to switch modes.
- Short press for previous track/Long press for fast rewind.
- Short press for next track/Long press for fast forward.
- Short press to pause.

Control the reverb volume. Rotate clockwise to increase the volume and counterclockwise to decrease the volume.

Control the microphone volume. Rotate clockwise to increase the volume and counterclockwise to decrease the volume.

1

Control the Music volume. Rotate clockwise to increase the volume and counterclockwise to decrease the volume.

### Headset Microphone:

(The wireless microphone is detachable)

Two ways of use: As a normal headset microphone, or remove the bracket to become a handheld microphone.

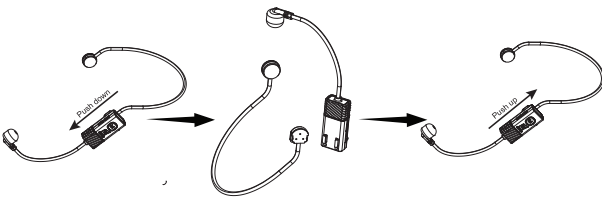

**M:** Long press to connect or disconnect

**+:** Short press to increase the volume

**-:** Short press to decrease the volume

### Microphone and Speaker Auto Pairing:

By default, the microphone and the speaker will automatically pair when powered on.

2

### Manual Pairing:

1. Turn on the speaker, short press the M key to switch to UHF mode.
2. Long press the M key again until the UHF blinks on the display.
3. Turn on the microphone and long press the M key on the microphone until the UHF on the speaker's display stops blinking.
4. Pairing is successful, and the microphone can output sound.

### Manual Disconnect (Two Methods):

1. Long press the M key on the microphone until the blue indicator light on the microphone's right side blinks.
2. Or long press the M key on the speaker until the UHF on the screen blinks.

### Speaker Charging Status:

It takes approximately 3 hours to fully charge with DC 5V/2A charger.

The battery indicator lights flash while charging, and the indicator lights stop flashing when fully charged.

3

### Microphone Charging Status:

It takes approximately 2.5 hours to fully charge with DC 5V/2A charger. The red light illuminates while charging and goes out when fully charged.

### Bluetooth Pairing:

Short press the M key on the speaker to switch to Bluetooth mode, the display screen will flash "BLUE." Open your Bluetooth device and search for "S98" in the list of available devices. Click to pair. When the pairing is successful, the "BLUE" stops flashing.

**Note:** In Bluetooth mode, short pressing the speaker's M key will switch to other modes, and the Bluetooth connection will be disconnected.

Short press for previous track, long press does not support fast rewind.

Short press for next track, long press does not support fast forward.

4

### TF Card Mode:

Insert a TF card to automatically play audio files. The display screen shows "TF MP3."

Short press for the previous track, long press for fast rewind.

Short press for the next track, long press for fast forward.

### USB Drive Mode:

Insert a USB drive to automatically play audio files. The display screen shows "USB MP3."

Short press for the previous track, long press for fast rewind.

Short press for the next track, long press for fast forward.

### Specifications:

Output Power:	40W	Frequency Range:	60Hz-18KHz
Battery Capacity:	2600mAh	Speaker Usage Time:	5-8 hours
Charging Voltage:	5V/2A	Microphone Usage Time:	5 hours
Bluetooth Transmission: Approximately 10 meters/32.8 feet.			

5