

User Manual  
RGBICW Floor Lamp



Scan QR Code  
Download APP

## Customer Service

We hope you never have the need, but if you do, our service is friendly. If you have any question, please contact us. We will response your inquiry within 24 hours.

Telephone:(725) 255-2966

Email:caledbulb@163.com

We will help you solve the problem!

## Troubleshooting

### 1. Cannot connect to "LotusLamp X" app.

- Check if the lamp is powered on, try disconnecting and re-powering.
- Check if Bluetooth on the smartphone is enabled, or try connecting with another smartphone.
- Make sure the app is the latest version.
- When connecting for the first time, ensure the smartphone is near the floor lamp.

### 2.Can multiple users control a single lamp atthe same time use APP?

- Each lamp can only be connected to one APP account at a time.
- If multiple accounts want to use the one lamp, user A must disconnect on LotusLamp X APP.Then user B can connect and use it on the APP.

### 3. The remote control does not work

- Check if the remote control battery has power
- Reset the remote control, then re-pair it.

#### Reset the remote:

Disconnect the power for 5-10 seconds, within 15 seconds after power-on,long press the "AUTO" button on the remote control until the light flashes 3 times,decoding is successful.

#### Re-pairing:

Disconnect the power for 5-10 seconds, within 15 seconds after power-on,long press the "AUTO" button on the remote control until the light flashes 3 times/Re-pairing is successful.

## 4. Why the app need permissions for location, bluetooth, microphone,storage, camera, etc?

- Location permissions: Android system requires location to scan for bluetooth devices and connect. It's not "LotusLamp X" app needs the buyer's location information, it's the Android system that needs it. IOS system does not require location permissions.
- Bluetooth permissions: Allow bluetooth to connect to use the app.
- The recording, storage, and camera permissions are optional (Optionally close). They are only required when using some functions.  
Storage: When using the music mode, need to read the music in the mobile phone.  
Microphone:When using the mic mode, you need to grab the surrounding sound.  
Camera: When uploading profile pictures.
- We do not record and save any buyer's location and other information. You can set all permissions to allow only while app in use.

## 5. Other issues.

Please call or email us, we will provide you with a satisfactory solution.

## Packing List

Lamp Pole	4
Lamp Base	1
Lamp Holder	1
Power Adapter	1
Remote Control	1
User Manual	1

## Check all parts are complete.

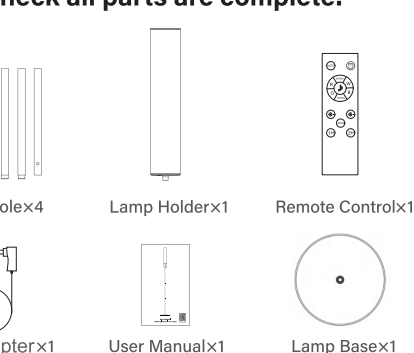

## Installation

### Step 1 :

- 1 and 2 connect to the lamp post and 3 connects to the lamp base. To pull the excess wire to the last lamp post with a hole in it.

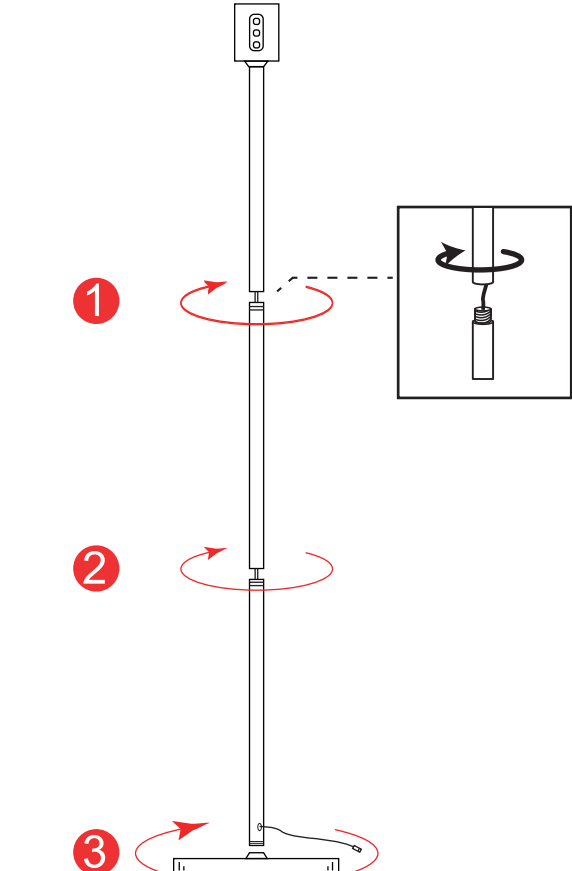

### Step 2 :

Connecting the Lamp Holder

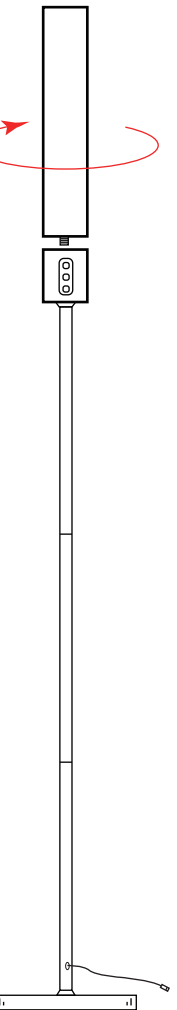

### Step 3 :

Connect the power adapter and check if the floor lamp is working properly

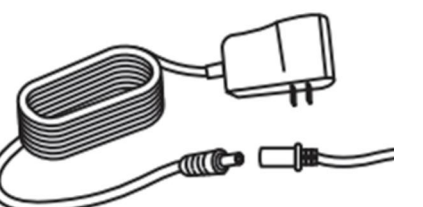

Connect the wires on the pole with the power adapter, Check to see if it works properly.

If the floor lamp does not light up when connected to the power supply, press the on/off button on the lamp post.

## Control Methods

### Control Button

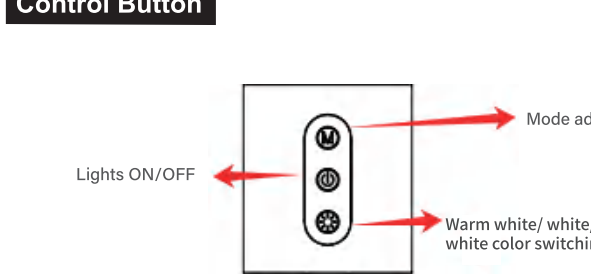

### APP control

#### LotusLamp X APP control

- Scan the QR code below or search "LotusLamp X" in Apple APP or Google play store to download and install it on your phone or tablet.

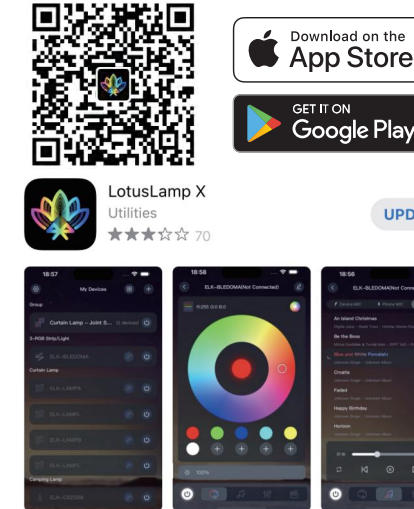

## Control Methods

### 1. Turn on Bluetooth on your phone.



Once Bluetooth is turned on, please open the LotusLamp X app directly and click on the list icon in the top right. (Normally the app will connect automatically,no need to do it manually)

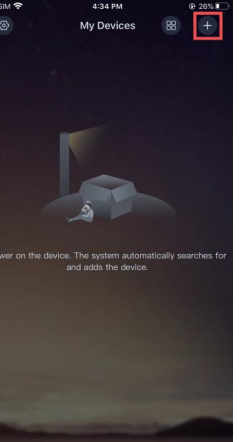

Once on the page, select your device and click Connect to successfully connect!

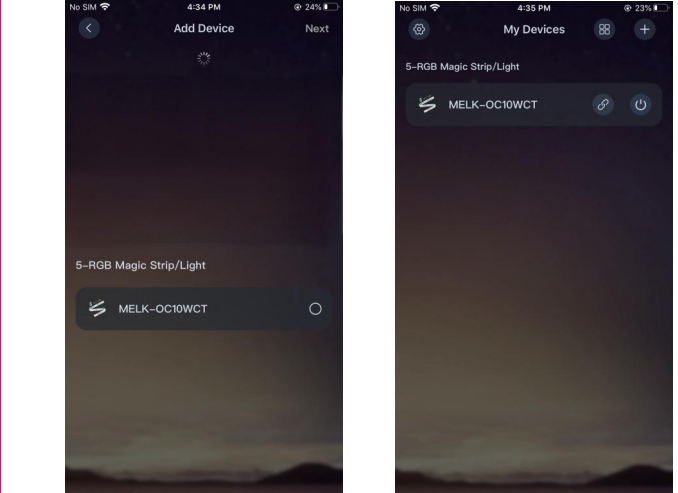

## 14 Keys RF Remote Control

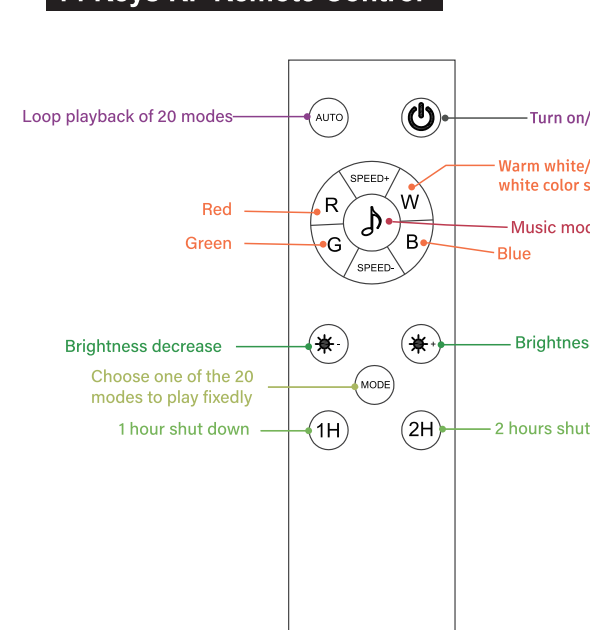

## Product Specification

Voltage	AC 100-240V,DC 12V
Wattage	20W
Colors	RGBICW
Control Method	APP/RF Remote/Button
Material	Metal
Weight(Pounds)	6.2 pounds

## WARNING:

- Indoor use only.It is non-waterproof.
- Please use the packaged adapter to meet the working power requirement.
- Power off before installation, cleaning and idle.
- Please do not use it in humid environments or at high temperatures
- Please do not plug or unplug the power cord with wet hands, keep it in a dry environment.
- Please stop using it if there are any defective issues found in the product.
- When assembling/disassembling the fixture, please disconnect the power, do not plug it in to avoid accidents.

## FCC Compliance

This device complies with Part 15 of the FCC Rules. Operation is subject to the following two conditions:

- This device may not cause harmful interference, and
- this device must accept any interference received, including interference that may cause undesired operation.



## 15.21 Information to user:

Any Changes or modifications not expressly approved by the party responsible for compliance could void the user's authority to operate the equipment.

## 15.105 Information to the user:

Note: This equipment has been tested and found to comply with the limits for a Class B digital device, pursuant to part 15 of the FCC Rules. These limits are designed to provide reasonable protection against harmful interference in a residential installation. This equipment generates uses and can radiate radio frequency energy and, if not installed and used in accordance with the instructions, may cause harmful interference to radio communications. However, there is no guarantee that interference will not occur in a particular installation. If this equipment does cause harmful interference to radio or television reception, which can be determined by turning the equipment off and on, the user is encouraged to try to correct the interference by one or more of the following measures:

- Reorient or relocate the receiving antenna.
- Increase the separation between the equipment and receiver.
- Connect the equipment into an outlet on a circuit different from that to which the receiver is connected.
- Consult the dealer or an experienced radio/TV technician for help.

## FCC RF Radiation Exposure Statement:

- This Transmitter must not be co-located or operating in conjunction with any other antenna or transmitter.
- This equipment complies with RF radiation exposure limits set forth for an uncontrolled environment. This equipment should be installed and operated with minimum distance 20cm between the radiator and your body.