

HEATED SOCKS

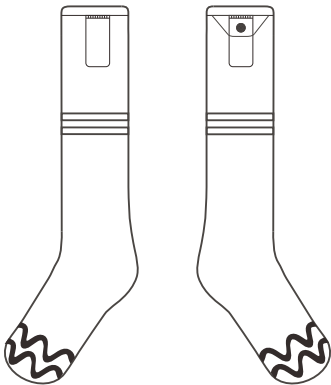

Make this winter warm and comfortable

Model: **AF-01**

Packing Including:



Heated socks
1pair



5000mAh battery
1pair



Double ended Type-C
charging cable



Washing bag



Manual

Battery
storage bag

Built in sole and
toe heating area



Type-C Cable

Surround
heating zone



PRODUCT PARAMETERS

Rated voltage:5V/2A

Rated power:5W

Charging time:5-6H

Service times full power:3-11H

Weight(g):600g

Single battery capacity:5000mAh

Socks material: 30% anti-pilling acrylic, 29% polyester, 20% nylon,
21% modal

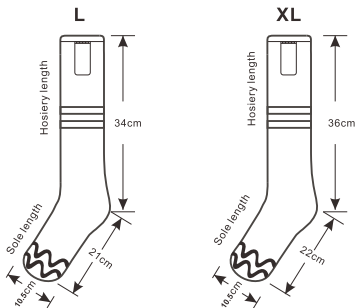

SIZE	Size of corresponding countries				Length of stockings(in)		
	USA	EU	UK	CHN	Length of stocking	Foot Length	Foot width
L	5-9	35-43	4-8	25-40	13-15	8-10	3-5
XL	9-14	43-53	8-13	40-53	14-16	9-11	3-5

Washing Instructions:

1. The water temperature should not exceed 122°F
2. The battery must be removed when cleaning, and the battery connecting wire must be sorted and put back into the battery bag.
(note that the battery cannot be washed with water)
3. Socks can be machine washed after being put into the laundry bag.
It is recommended to wash them by hand.
4. Turn the power cord out and dry it naturally. Please do not use a high-temperature iron or dry it at high temperatures.

Battery Control Instructions:

1. Check the battery power level before using it, and charge them to the full state.
2. Distinguish between left and right socks and wear them correctly, keep the battery pocket on the outside of the shins
3. When not using the product, please unplug the battery for storage.
4. Put on the socks first, then put the battery into the battery bag and insert the C plug into the battery.
5. The green indicator of the battery is the power indicator, which corresponds to four indicators; 100% power; three indicators: 75% power; two indicators: 50% power; one indicator: 25% power. The red indicator is the gear indication, which corresponds to three indicators: three gears (high-temperature gear); two indicators: two gears (medium-temperature gear); one indicator: one gear (low-temperature gear).
6. battery button: long press for 3 seconds to turn on and off. Short press the shell to switch gears, the default three gears (high-temperature gears) work at startup. Lightly press the button to switch between three gears and one gear.
7. After the battery is turned on if the sock type-C plug is not inserted within 30 seconds, the device will automatically shut down. If you want to continue to use it, you need to restart it.

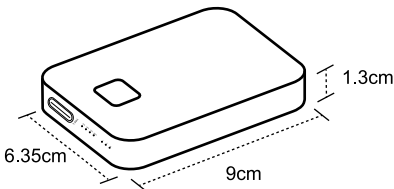

Temperature Guide:

- 1. There are three temperature levels available for you to choose from to adjust the temperature according to your needs.
- 2. Three gears (high-temperature gear) capable of providing a maximum temperature of 160 ℉ ; two indicators: two gears (medium-temperature gear) capable of providing a temperature of about 125 ℉ ; one indicator: one gear (low-temperature gear) capable of providing a temperature of about 105 ℉ .
- 3. Please note that do not use the third gear temperature for a long time to avoid burning the palms of the feet.
- 4. Each gear can last for a different length of time, the third gear can work for about four hours; the second gear can work for about five hours, and the third gear can last up to about 10 hours. When you use it before please check whether the battery is in a fully charged state.

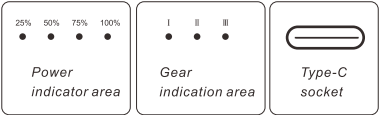

* The following data are laboratory test data at room temperature of 77°F.

Light Status	Current Mode	Reference Temperature(°F)	Reference Endurance(H)
● ● ● ○	3	149±3	3.5~4
● ● ○ ○	2	122±3	4~5
● ○ ○ ○	1	104±3	8~10

APP Temperature Control Instructions:

1. The battery must be turned on to use the app function. When it is turned off, the phone will not be able to search for the battery. After turning off the battery through the mobile app, you need to turn it on manually from the battery button.
2. Turn on the mobile phone positioning and Bluetooth functions for APP Bluetooth control.
3. If the mobile APP is not connected to the battery device after the battery device is powered on, please check whether other permissions of the mobile app are opened.
4. If you have more than two battery devices, it is recommended to turn off all devices and only turns on two battery devices for App connection to avoid confusion.
5. After turning on the battery, open the phone APP, and the phone APP will automatically connect to the battery device without binding and manual connection.

Precautions:

1. Batteries should not approach high-temperature, flammable, or explosive objects.
2. Do not hit the battery with force, and do not disassemble or reassemble it.
3. If the battery is not used frequently it is recommended to recharge and activate it every 60 days.
4. It is recommended not to set to a high temperature for a long time to avoid skin discomfort.
5. Keep the battery in good condition. The battery shall be stored in a dry and cool environment.
6. Prevent low-temperature burns (if the human body is in a low-temperature environment, the body feels dull. and there are differences in physical fitness). Please lower the temperature in time when the body feels slightly burning.

App main interface description

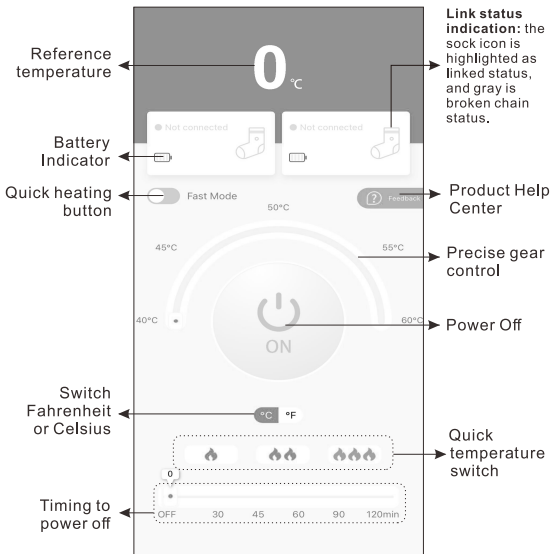

How to download APP?

1. Scan QR code below to download APP
2. Search "Keep Warm" on phone APP store

FCC COMPLIANCE STATEMENT:

This device complies with part 15 of the FCC Rules.

Operation is subject to the following two conditions:

- (1) This device may not cause harmful interference, and
- (2) this device must accept any interference received, including interference that may cause undesired operation.

Note: This equipment has been tested and found to comply with the limits for a Class B digital device, pursuant to Part 15 of the FCC Rules. These limits are designed to provide reasonable protection against harmful interference in a residential installation. This equipment generates, uses and can radiate radio frequency energy and, if not installed and used in accordance with the instructions, may cause harmful interference to radio communications.

However, there is no guarantee that interference will not occur in a particular installation. If this equipment does cause harmful interference to radio or television reception, which can be determined by turning the equipment off and on, the user is encouraged to try to correct the interference by one or more of the following measures: Reorient or relocate the receiving antenna.

Increase the separation between the equipment and receiver.

Connect the equipment into an outlet on a circuit different from that to which the receiver is connected.

Consult the dealer or an experienced radio/TV technician for help.

Warning: Changes or modifications to this unit not expressly approved by the part responsible for compliance could void the user's authority to operate the equipment.

FCC Radiation Exposure Statement

The device has been evaluated to meet general RF exposure requirement.

The device can be used in portable exposure condition without restriction.



GOOGLE PLAY



Keep Warm