

MeetSummer Wireless Smart Microphone X1 User Manual

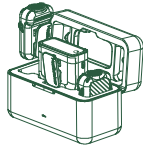

What's in the box

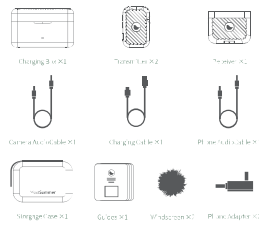

* The picture is only for reference, please make the object as the standard.

Transmitter

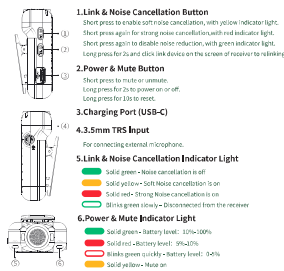

Receiver

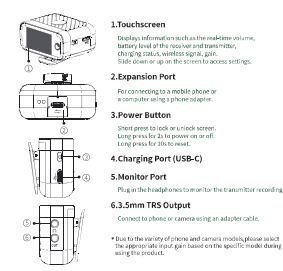

Charging Box

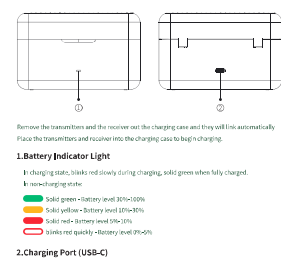

Operation

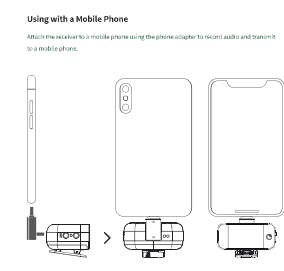

Operation

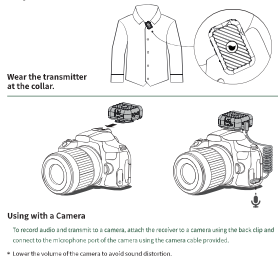

Using with a Camera
To record audio and transmit to a camera, attach the receiver to a camera using the camera cable provided.
* Lower the volume of the camera to avoid sound distortion.

Touchscreen Operations

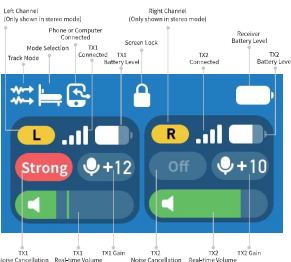

Touchscreen Operations

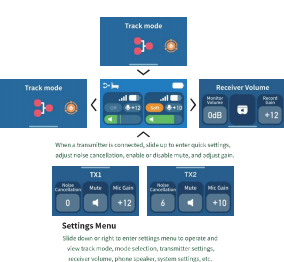

Specifications

Item	Device Name		
	Transmitter	Receiver	Charging Box
Model	X1T1	X1R1	X1CB1
Dimensions	40 x 32 x 25mm (excluding clip)	40 x 32 x 25mm (excluding clip)	108 x 52 x 30mm
Weight	21g	75g	110g
Battery Capacity	260mAh	600mAh	1000mAh
Operating Time	8 hours	8 hours	Full charge (no device connected) up to 12 hours
Charging Time	2 hours 30 minutes	2 hours 30 minutes	2 hours
RF Capsule	Frequency Response	Max SPL	Transmitting Range
9.7mm Gold-plated Omnidirectional	20Hz-20KHz	115dB SPL	250 meters
2.4 GHz	50dB	9° to 45° (31° to 117°)	-10° to 45° (31° to 117°)

* The above data is obtained from MeetSummer laboratory tests, there may be certain errors due to differences in the use environment.

Safety Precautions

1. Product contains magnets. Keep the product away from magnetic, IC cards, hard disks, RAM chips, implantable medical devices such as pacemakers, and other devices to avoid interference.
2. DO NOT listen at a high volume for an extended period using monitor earphones. Otherwise, you may experience possible hearing damage.
3. DO NOT allow the product to come into contact with any kind of liquid. DO NOT leave the product out in the rain or near a source of moisture. DO NOT drop the product into water. If the inside of the battery comes into contact with water, chemical decomposition may occur, potentially resulting in the battery catching on fire, and may even lead to an explosion.
4. Never disassemble or pierce the product. In any way on the battery may leak, catch fire, or explode.
5. The product should be used in temperatures from -10 to 45°C (14 to 113°F). Use of the product in environments above 45°C (113°F) can lead to a fire or explosion. Use of the product below -10°C (14°F) can lead to permanent damage.
6. DO NOT heat the product. DO NOT put the product in a microwave oven or in a pressure cooker. DO NOT leave the product near heat sources such as a furnace or heater. DO NOT expose the product to direct sunlight or hot days.
7. DO NOT place the battery under extremely low-pressure environments, as it may cause the battery to explode or leak flammable liquid and gas.
8. DO NOT drop or strike the product. DO NOT place heavy objects on the product.
9. If the battery overheats severely, do not continue to use it.
10. DO NOT dispose of the battery in household waste, please follow the relevant national regulations for safe disposal of used batteries.
11. Use only the original model of the charging box, charging cable, and battery. Using unmodified or non-branding models may cause electric shock, fire, explosion, or other danger.

Product Model :	
Product SN :	
Purchase Date :	
Customer Name :	
Customer Address :	
Customer Phone :	
Zip Code :	
Fault Phenomenon :	

Warranty Description:
The warranty period for this product is one year.
During the warranty period, if a fault occurs (not normal use according to the user manual, not damaged by fire or liquid), we will repair it free of charge. If any of the following situations occur, our company will charge a repair fee:
(1) Damage caused by improper use or misuse.
(2) Damage caused by transportation, handling, or improper use.
(3) Damage caused by fire or liquid.
(4) Damage caused by use of a power source or voltage other than the designated one.
(5) Damage caused by use of a power source or voltage other than the designated one.
* The appearance of the product and accessories are not covered by the warranty danger.

This device complies with Part 15 of the FCC Rules. Operation is subject to the following two conditions: (1) this device may not cause harmful interference, and (2) this device must accept any interference received, including interference that may cause undesired operation

NOTE: This equipment has been tested and found to comply with the limits for a Class B digital device, pursuant to Part 15 of the FCC Rules. These limits are designed to provide reasonable protection against harmful interference in a residential installation. This equipment generates, uses and can radiate radio frequency energy and, if not installed and used in accordance with the instructions, may cause harmful interference to radio communications. However, there is no guarantee that interference will not occur in a particular installation.

If this equipment does cause harmful interference to radio or television reception, which can be determined by turning the equipment off and on, the user is encouraged to try to correct the interference by one or more of the following measures:

- Reorient or relocate the receiving antenna.
- Increase the separation between the equipment and receiver.
- Connect the equipment into an outlet on a circuit different from that to which the receiver is connected.
- Consult the dealer or an experienced radio/TV technician for help.

Warning: changes or modifications not expressly approved by the party responsible for compliance could void the user's authority to operate the equipment

The device has been evaluated to meet general RF exposure requirement. The device can be used in portable exposure condition without restriction