



SMART LOCK

Installation & Operation Guide

A0AA-5203-D311

This guide contains important information about your lock. Please keep this guide V.480806

Diagram of Door Lock Installation

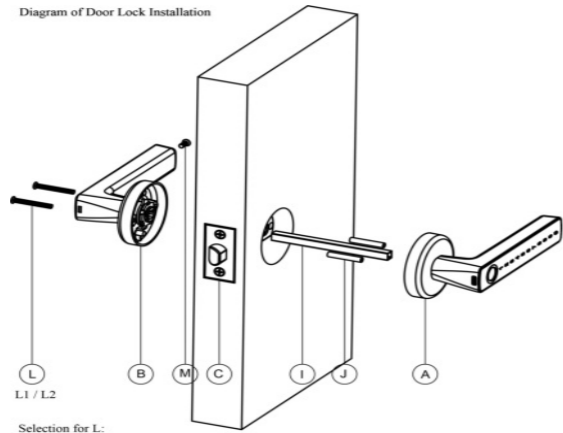

Selection for L:
L1 screw M4x35 for door thickness 1.18~1.58" (30~40mm)
L2 screw M4x45 for door thickness 1.58~2.00" (40~50mm)

PART 1.ACCESSORIES

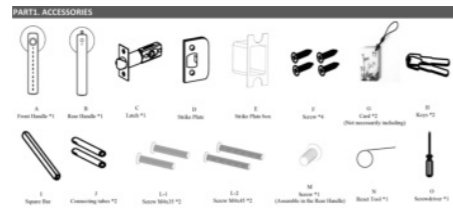

Remark: For card (G), if not found in the packing, which means the lock don't have the card unlock function, so accessories don't include the card.

PART 2. Product Parameters

- Unlock method: APP, Fingerprint, Password, key, Card (if have)
- User capacity: Total Max. 300 users including all below.
 - 100*Fingerprints
 - 250*Passwords
 - 250*Cards (if have)
- Fingerprint head type: Semiconductor
Sensor Pixel: 112*88 / Resolution: 508DPI
FAR: <0.001% / FRR: <1%
- Unlock time: <1.5 seconds
- Working temperature: -20~60℃
- Power supply: 4*AAA alkaline batteries
- Emergency power supply: USB Type C

TIPS:

- This lock is equipped with mechanical keys for manual unlocking. Remove mechanical keys from the package and keep them in a safe place and always have access to them.
- To power on the lock, four alkaline AAA batteries (not included) are required. Non-alkaline and rechargeable batteries are not recommended.
- This lock is not designed to be exposed to direct sunlight or rain. It is not water proof IP rated.
- Keep your fingers clean when using this lock.

PART 3. Door Lock Installation

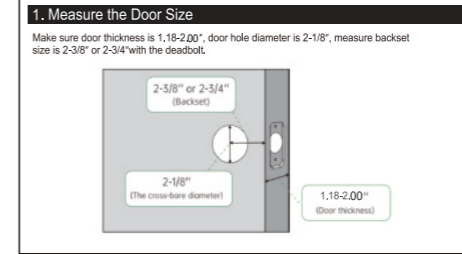

- Tips:
- Available door thickness is 1.18~2.00" (30~50mm).
 - Please select the correct accessories (L1 / L2) for assembly according to your door thickness.

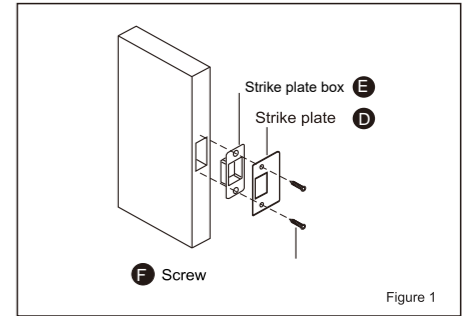
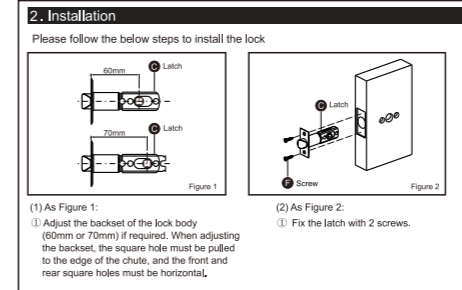

- (1) As Figure 1:
① Fix the strike plate with 2 screws on the door frame.

FCC Statement

This device complies with Part 15 of the FCC Rules. Operation is subject to the following two conditions:
(1) This device may not cause harmful interference.
(2) This device must accept any interference received, including interference that may cause undesired operation.
2. Changes or modifications not expressly approved by the party responsible for compliance could void the user's authority to operate the equipment.
Note: This equipment has been tested and found to comply with the limits for a class B digital device pursuant to Part 15 of the FCC Rules. These limits are designed to provide reasonable protection against harmful interference in a residential installation.
This equipment generates uses and can radiate radio frequency energy and, if not installed and used in accordance with the instructions, may cause harmful interference to radio communications. However, there is no guarantee that interference will not occur in a particular installation. If this equipment does cause harmful interference to radio or television reception, which can be determined by turning the equipment off and on, the user is encouraged to try to correct the interference by one or more of the following measures:
• Reorient or relocate the receiving antenna.
• Increase the separation between the equipment and receiver.
• Connect the equipment into an outlet on a circuit different from that to which the receiver is connected.
• Consult the dealer or an experienced radio/TV technician for help.
The device has been evaluated to meet general RF exposure requirement. The device can be used in portable exposure condition without restriction.

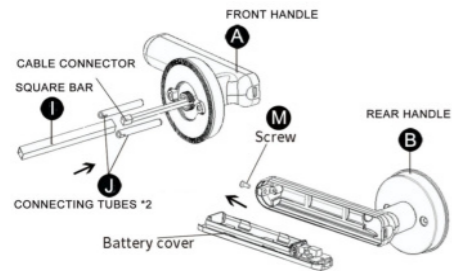

- Prepare Front Handle (A).
- Install Connecting tubes *2 (J) in the Front Handle (A).
- Thread the Cable Connector through the Square Bar (I).
- Thread the Square Bar (I) through the latch, connected with Front Handle (A) and Rear Handle (B).
- Pull out the Cable Connector from the Rear Handle (B).
- Install two Screws M4x35 or M4x45 (L1 or L2) through the Rear Handle (B), connect with Connecting Tubes (J), to fix the Front Handle (A) and Rear Handle (B) on the door.
- Insert the Cable Connector into the socket of the battery cover, and load with 4*AAA alkaline batteries.
- Install the Battery Cover, then install Screw (M) in the back end of Rear Handle (B).
- Installation finished, test the door lock.

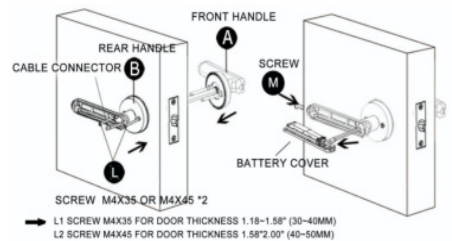

FAQs

Question 1: How to install the door lock?

Answer: Please follow our Installation & Operation Guide.

Question 2: Why other unregistered fingerprints can also unlock the lock?

Answer: Before the first fingerprint is registered successfully, it is the experience mode, any fingerprint can unlock the lock in experience mode. Please check if the first fingerprint is registered successfully.

Question 3: Why my fingerprints cannot be registered successfully?

Answer: One fingerprint needs to be collected 5 times that will be registered successfully. So you should enter the same fingerprint 5 times instead of entering 5 different fingerprints when registering a fingerprint.

Question 4: Why pressing the keypad without any reaction?

Answer: Check if the sound setting is turned off, if yes, turn it on and try again.

Function Demonstration

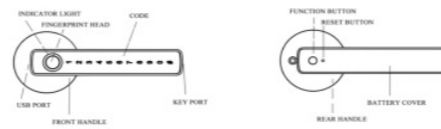

- Add a door lock (with APP)
1). Setting the Administrator password for lock (the Admin password need to be 6 digits)

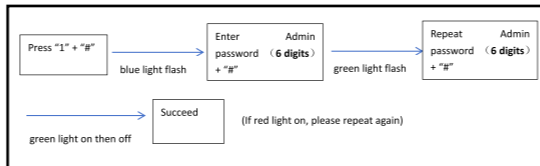

- Download the APP
Search "Tuya Smart" in the APP market, download and install Tuya APP.
- Registered users
Turn on the Bluetooth function of the mobile phone, then open the "Tuya Smart" APP on the mobile phone, and complete the user registration.
- Connect to APP operation:
While lock in the factory state, or reset to factory state, or after unbound of APP, before connect to APP, need to operate as follows first:
1). Didn't set Admin password: Press "1" + "#", the lock is in network connecting state, then open Tuya APP in your phone, click "Add Device" until add successfully.
2). Did set Admin password: Press "1" + "#", enter "Admin password" + "#", the lock is in network connecting state, then open Tuya APP in your phone, click "Add Device" until add successfully.
Remark: need to complete operation within 90s after the lock is in network connecting state, or repeat again

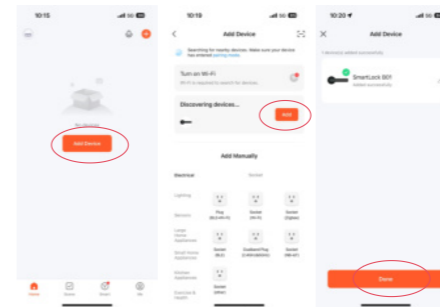

- Add users (fingerprint/ password / card)
1) . Add fingerprint
Click Member Management - Me - Fingerprint Add - Add (Input 5 times)

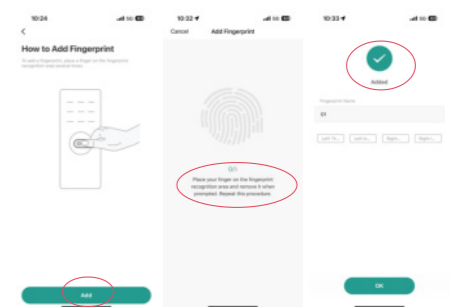
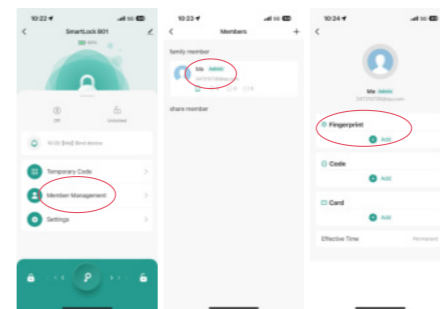

- . Add password
Click Member Management - Me - Code Add - Enter 6-8 digits password - Save.

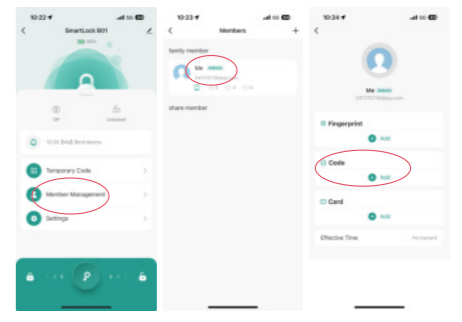

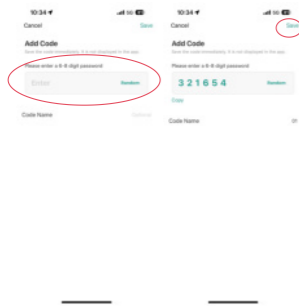

3) - Add card (if have)
Click Member Management - Me - Card Add - Keep the card close to the lock.

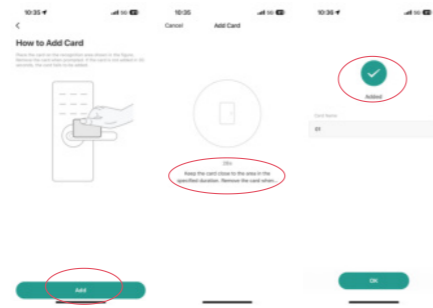
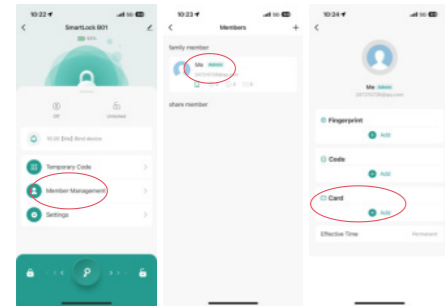

6. Delete Users (fingerprint/ password / card) - Delete
Click Member Management - Me - Click unwanted Fingerprint/ password/ card - Delete

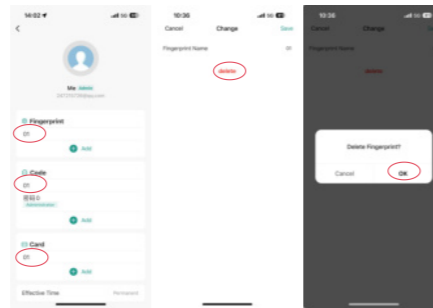

7. APP Unlock
Hold the key button and slide to the right to unlock

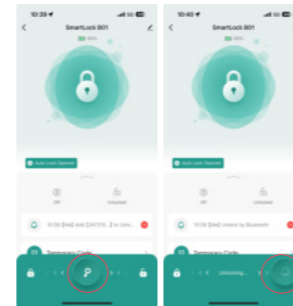

8. Temporary Password
Click Temporary Code, set temporary password, Time-Limited/ One-Time/ Dynamic / Clearing / Custom, Click Save.

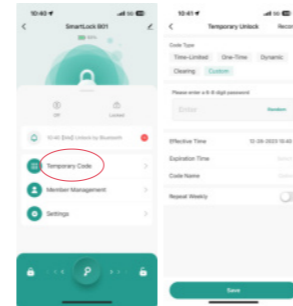

9. Power and record
After waking up the door lock, App can display the battery level, also you can view the unlocking records.

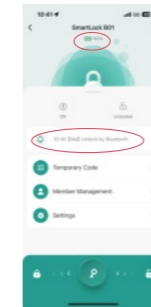

10. Other function settings
Remote Unlock: need to connect with a gateway.
Auto Lock: lock will be always keep unlock situation if closed.
Auto Lock Delay: you can set the delay time by yourself.
Lock Volume: you can select Mute or Normal.

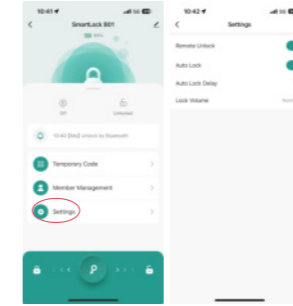

11. Restore factory setting
Click the button in the upper right, then click "Remove Device", to restore the factory successfully.

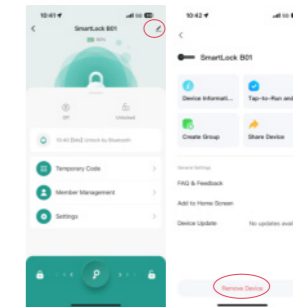

Function Demonstration

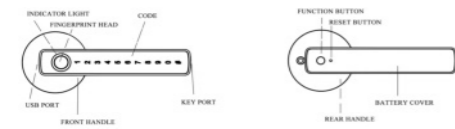

1. Add a door lock (without APP)
1). Setting the Administrator password for lock (the Admin password need to be 6 digits)

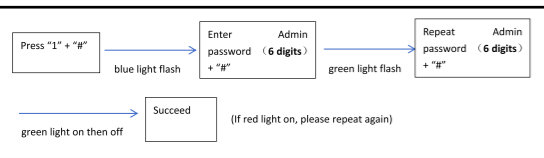

2). Add users (password / fingerprint / card)

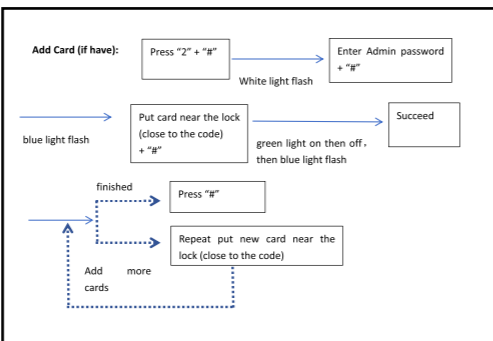
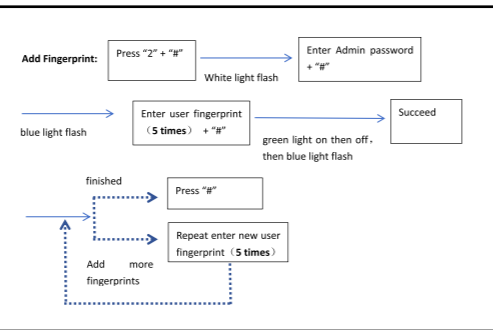
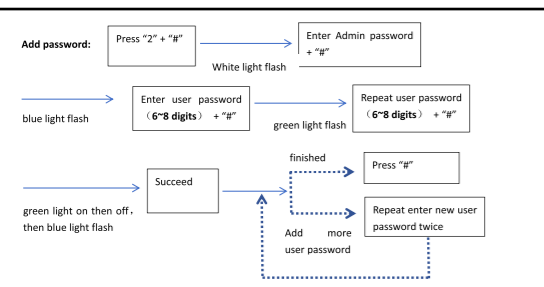

2. Sound setting
Default sound setting is on, you can turn off/on the sound by:



3. Connect to APP operation:
While lock in the factory state, or reset to factory state, or after unbound of APP, before connect to APP, need to operate as follows first:

- Didn't set Admin password: Press '1' + '#', the lock is in network connecting state, then open Tuya APP in your phone, click "Add Device" until add successfully.
- Did set Admin password: Press '1' + '#', enter "Admin password" + "#", the lock is in network connecting state, then open Tuya APP in your phone, click "Add Device" until add successfully.

Remark: need to complete operation within 90s after the lock is in network connecting state, or repeat again)

4. Passage Mode:
Default passage mode setting is off, while it on, you don't need any password to unlock. You can turn on/off the passage mode by:

- Passage mode on: press the function button (in rear handle) for 5 seconds (white light flash), until purple light on, release pressing, passage mode on.
- Passage mode off: press the physical button (in rear handle) for 5 seconds (white light flash), until blue light on, release pressing, passage mode off.

- Electronic locked in:
Default setting is off, while it on, only Admin password can unlock. You can turn on/off by:
1. Turn on Locked in: Press the function button shortly and release (in rear handle), the yellow light on, succeed, lock is in locked in state.
2. Turn off the locked in: Press the function button shortly and release (in rear handle), the green light on, enter "admin code" + "#", succeed, the locked in is off.

6. Restore to factory setting:
Use tool to press the reset button for 5 seconds (red light flash), until blue light on, lock restore to factory successfully.