

Stereo Bluetooth Headset KH109M

User Manual

Catalog

1.Product Overview-----	1
2.Basic Operation-----	2
3.Bluetooth Pairing and Connection-----	4
4.LED Indicator-----	5
5.Usage of Wired Headphone-----	6
6.Charging-----	7
7.Product Specification-----	8
8.Attentions and Q & A-----	9

1. Product Overview



Type-c Charging Pin / Volume+ / Multi-Function Button (MFB) / Volume- / Toggle Switch

Packing List :

- A. Bluetooth Headset KH109M x 1
- B. TYPE-C charge cable x 1
- C. User manual x 1
- D. 3.5AUX cable x 1



2. Basic Operation

Button	Function	Operation Instruction
Toggle Switch	Power On	Power off status, turn the switch to the middle to turn on the machine. The power on prompt sound is "Power on"
	Power Off	Power on state, turn the toggle switch to the power icon to shut down the device. The shutdown prompt will sound "Power off"
	Enter Pairing Mode	<p>a. No pairing record, toggle the switch to the middle to enter pairing mode;</p> <p>b. Turn on the headphone and move the button up for 1-2 seconds to enter pairing mode, prompting "Pairing";</p> <p>c. Manually disconnect the Bluetooth of the phone to enter pairing mode</p>
MFB	Voice Assistant	Double press MFB, with prompt "Du"
	Answer a call	When a call incoming, short press MFB to answer, with prompt "DuDu"
	Hang up a call	When during a call, short press MFB, with prompt "Du"

	Reject a call	When a call incoming, long press MFB for 1 second to reject, with prompt "DuDu"
	Play / Pause	Short press MFB when play music.
	Three-way calling function	<p>A.Call coming during a call, double press the MFB to answer the new call and keep the current call, with prompt "Du".</p> <p>B.Call coming during the call, short press the MFB to answer the new call and hang up the current cal, with prompt "Du".</p> <p>C.Call coming during the call, long press the MFB for 1 second to reject the new call, with prompt "Du"</p> <p>When you are on a three-party call,</p> <p>D.double press the MFB to switch audio between the current call and the keep call, with prompt "Du".</p>
Volume +	Volume Up	Short press, with prompt "Du"(MAX)
	Next Song	Long press for 2 seconds
Volume -	Volume Down	Short press, with prompt "Du"(MIN)
	Previous Song	Long press for 2 seconds
Mute Button	Microphone Mute	<p>During a call, turn the microphone lever up to mute the microphone,, with prompt "mute on" .</p> <p>And turn it down to cancel mute, with prompt "mute off"</p>
Combination	Delete pairing records	When the headphone is turned on and not in a call state, press the "MFB button" and "volume+ button" for 5 seconds to clear the pairing record. If it is cleared, the connection cannot be reconnected and needs to be paired again.
	Redial a call	Press the "Volume+" and "Volume-" buttons simultaneously for 1 second to redial a call,, with prompt "Du" .

3. Bluetooth Pairing and Connection

A. Turn the switch to the middle to enter pairing mode, with Blue & Red LED flash alternately.

B. Search and click to connect " KH109M" on your phone Bluetooth lists, then you can play music from phone to headphone.

C. You can press MFB / Volume+ / Volume- to control the answer/hang up a call and play/pause of the music, next and previous song, volume up and down, etc.



Pairing: In off state, turn the switch to the middle to enter pairing mode, with Blue & Red LED flash alternately.



Connect: Search and click to connect " KH109M" on your phone Bluetooth lists, then you can play music from phone to headphone.

4.LED Indicator

Mode	LED Indicator
Power on	Blue LED lights up for 1 second
Power off	Red LED lights up for 1 second
Pairing mode	Red & Blue LED flash alternately
Connected standby mode	Blue LED flashes once every 5 seconds
Playing Music	Blue LED flashes once every 5 seconds
Calling	Solid Red LED (Red light breathing flashes when the call is muted)
Delete pairing record	Red & Blue LED flash once at the same time
Charging	Solid Red LED
Full charged	Solid Red LED change to Solid Blue LED
Low battery	Red LED flashes

5. Usage of Wired Headphone

Insert one end of the 3.5mm audio cable into the audio hole of a computer, phone, or tablet, and the other end into the audio hole of KH109M to listen to music through the headphone.



Charge with Computer

6.Charging

Please charge KH109M at once when the Red LED flashes. Charging time is about 2 hours. Solid Red LED change to Solid Blue LED when full charged.

Please connect to KH109M charging port through the TYPE-C end of TYPE-C charging cable, USB end to the charger(can be used as car charger, travel charger, computer USB, etc).

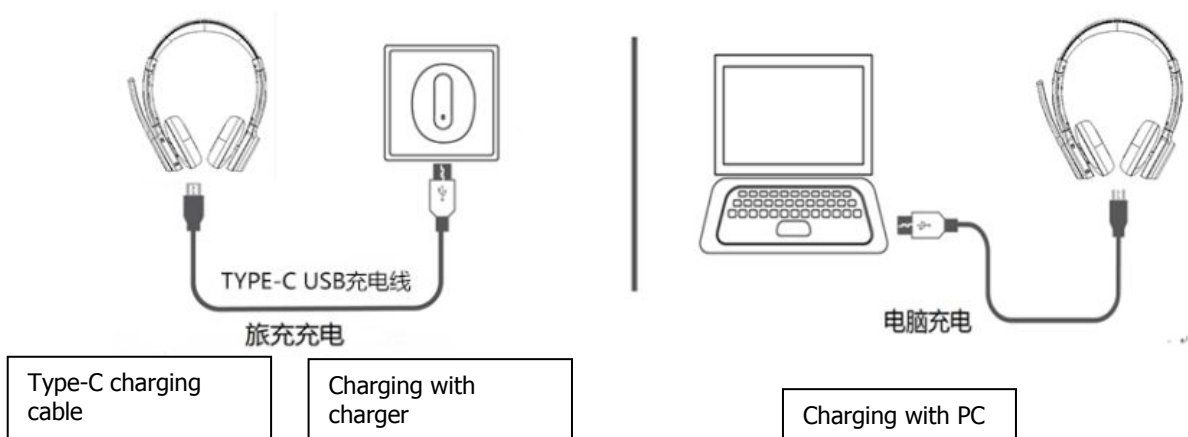

*Note :

1. Please charge KH109M at least one time every 2 months when don't use it.

7.Product Specification

Bluetooth specification	V5.1
Chip solution	QCC3024
Operation range	10 meters
Supported profile	HSP HFP A2DP AVRCP
Code	AAC SBC
Battery	500mAh/3.7V
Charge time	About 2 hours
Music time	About 30 hours (70% Volume)
Call time	About 22 hours (70% Volume)
Standby time	About 300 hours
Headset Net weight	About 162.5g
Headset Overall dimensions	180.74*163.41*65.62 mm

*The above data are all from SKY WING laboratory, and the actual use time, environment and music will be different.

8. Attentions and Q & A

A . How to reconnect and operation when failed to reconnect ?

When KH109M connected with your mobile phone successfully at the first time, it will search and reconnect the paired device automatically when power on, If failed, please pair and connect again.

B. How to delete paired records ?

When the headphone is turned on and not in a call state, press the "MFB button" and "volume+ button" for 5 seconds to clear the pairing record. If it is cleared, the connection cannot be reconnected and needs to be paired again.

C. What' s the password for pairing?

Some connection devices require password for pairing, please try 0000 or 8888 or 1111 or 1234.

D. What devices could charge for the headphone ?

Any car charger, power bank, PC etc. which meet DC 5V, charging current more than 500mA could be charge for KH109M.

IC Warning

This device complies with Industry Canada's licence-exempt RSSs. Operation is subject to the following two conditions:

- (1) This device may not cause interference;
- (2) This device must accept any interference, including interference that may cause undesired operation of the device.

Le présent appareil est conforme aux CNR d'Industrie Canada applicables aux appareils radio exempts de licence. L'exploitation est autorisée aux deux conditions suivantes:

- (1) L'appareil ne doit pas produire de brouillage, et
- (2) L'utilisateur de l'appareil doit accepter tout brouillage radioélectrique subi, même si le brouillage est susceptible d'en compromettre le fonctionnement.

The information listed above provides the user with information needed to make him or her aware of a RF exposure, and what to do to assure that this radio operates within the FCC exposure limits of this radio.

The device complies with RF specifications when the device used at 5mm from the body. Third-party belt-clips, holsters, and similar accessories used by this device should not contain any metallic components. Body-worn accessories that do not meet these requirements may not comply with RF exposure requirements and should be avoided. Use only the supplied or an approved antenna.

FCC Warning

15.19 Labeling requirements.

This device complies with part 15 of the FCC Rules. Operation is subject to the following two conditions: (1) This device may not cause harmful interference, and (2) this device must accept any interference received, including interference that may cause undesired operation.

15.21 Information to user.

Any Changes or modifications not expressly approved by the party responsible for compliance could void the user's authority to operate the equipment.

15.105 Information to the user.

Note: This equipment has been tested and found to comply with the limits for a Class B digital device, pursuant to part 15 of the FCC Rules. These limits are designed to provide reasonable protection against harmful interference in a residential installation. This equipment generates uses and can radiate radio frequency energy and, if not installed and used in accordance with the instructions, may cause harmful interference to radio communications. However, there is no guarantee that interference will not occur in a particular installation. If this equipment does cause harmful interference to radio or television reception, which can be determined by turning the equipment off and on, the user is encouraged to try to correct the interference by one or more of the following measures:

- Reorient or relocate the receiving antenna.
- Increase the separation between the equipment and receiver.
- Connect the equipment into an outlet on a circuit different from that to which the receiver is connected.
- Consult the dealer or an experienced radio/TV technician for help.

FCC RF Radiation Exposure Statement:

- 1.This Transmitter must not be co-located or operating in conjunction with any other antenna or transmitter.
- 2.This equipment complies with RF radiation exposure limits set forth for an uncontrolled environment.

This equipment should be installed and operated with minimum distance 5mm between the radiator and your body.