

MULTI-FUNCTION ELECTRIC SCOOTER



User Manual

English

Contents

1. Safety instructions
2. Quick guide
3. Contents of the package
4. Product overview
5. Command information / Control panel
6. Assembly and setup
7. Folding and carrying
8. Battery charging and activation
9. Road mode and ski mode change
10. Storage and cleaning
11. General warnings
12. Learning to ride the scooter
13. Battery and charger (Warnings)
14. Care and Maintenance
15. Technical data sheet
16. Troubleshooting

1. Safety instructions

Please read the following instructions carefully before using

- The company shall not accept liabilities resulting from product misuse or from noncompliance with traffic regulations or the instructions provided in this manual.
- This electric snow scooter is not a toy. Use it responsibly, with care and respect for others.
- Check local current regulations on the use of these products before riding it, and comply with local traffic regulations. Ride responsibly and pay attention to people and obstacles to avoid accidents.
- Always use the recommended clothing: non-slip gloves, knee and elbow pads and wear a helmet.
- When holding the handlebars at the correct height, the person riding this scooter must be able to place both feet on the ground easily.
- When stopping or parking your vehicle, be sure to do so on a flat and safe surface.
- The maximum load capacity for the scooter is 120 kg.
- This scooter may not be used by more than one person at a time.
- Misuse of the scooter or non-compliance with the instructions provided in this manual may cause serious injury.
- Should technical problems occur, contact the Technical Support Service at your dealer.
- Do not attempt to disassemble or repair the scooter yourself.
- Do not leave the battery near fire or heat sources.
- Avoid using used, defective and/or non-original batteries.
- Do not sit on the scooter both while riding it or when it is parked.
- If the user who is going to use the scooter is not familiar with this type of vehicle, they should be instructed on the basics of driving by an adult before using it for the first time.

Training should cover the following topics:

1. Acceleration
2. Deceleration
3. Braking
4. Basic riding principles
5. Parts Replacement

2. Quick guide

- Fully charge the scooter before using it for the first time.
 - Activate the electrical circuit, press the power button to start it.
 - Check the battery indicator: if the battery is dead, charge it before use. The electric snow scooter is a device that needs to be charged periodically to be able to work.
 - Check the tyre pressure (30 PSI); if the electric snow scooter does not reach at least 60% of the declared Km or does not reach the maximum speed within the first 3 months of use, it is likely that the wheels have deflated again. In this case, restore the pressure as indicated.
 - Place the electric snow scooter on a flat surface.
 - Place your hands on the handlebars. Step onto the footrest with one foot and use the other to give yourself a gentle push and accelerate.
-
- When the electric snow scooter begins to move, place both feet on the footrest and press the accelerator.
 - To steer the electric snow scooter, tilt your body in the direction of travel when turning and slowly turn the handlebar.
 - To stop the electric snow scooter, release the accelerator and press the electronic brake or lever on the left side of the handlebar.
 - Stop the electric snow scooter completely before getting off. Trying to get off the electric snow scooter while it is moving may result in injury.
 - When riding at night or in dark places, press the light button once to turn on the lights, wear a reflective vest.

For your own safety, wear a helmet and knee pads to protect yourself against falls and injuries while learning to ride the electric snow scooter.

The rider assumes all responsibility for any injury suffered when not wearing a helmet or other protective gear.

3. Contents of the package

Assembled electric snow scooter, the handlebar must be installed using the special screws.



- Electric scooter
- Accessories:
 - Front ski set
 - Rear caterpillar set
 - Tools
 - Using manual
- Battery charger



4. Product overview

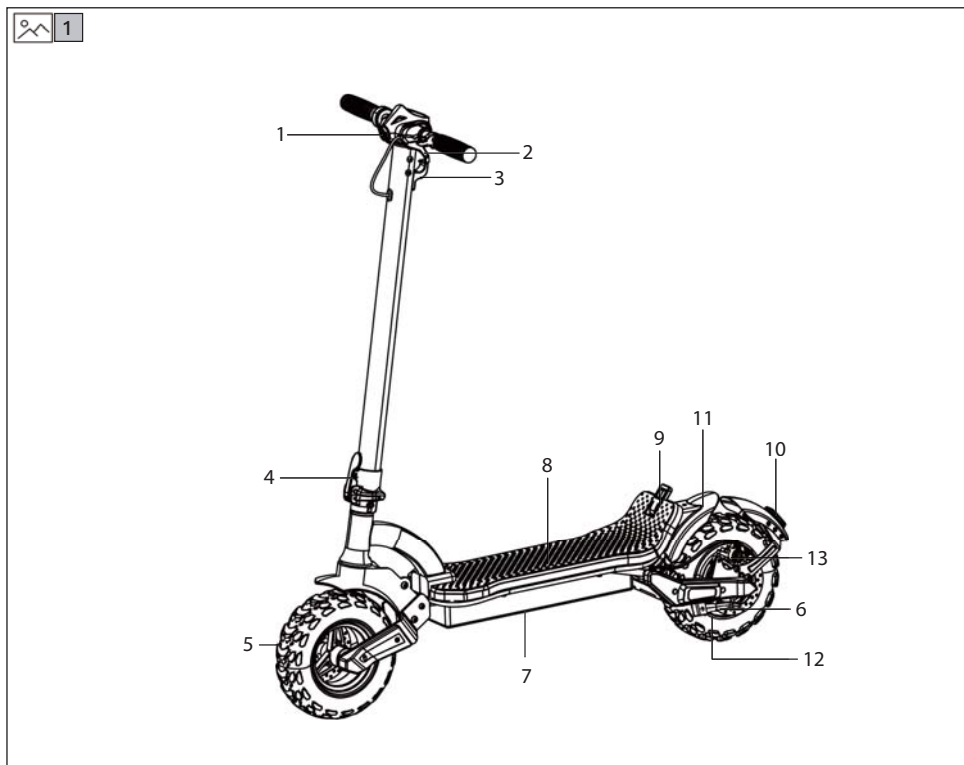

1. Front Light
2. Rear Brake Lever
3. Hook/Stem Fold Lock Catch
4. Stem Lock Lever
5. Front Wheel
6. Stand
7. Battery Location
8. Foot Pad
9. Handlebar Lock
10. Rear Light
11. Rear Fender
12. Electric Motor
13. Rear Brake
14. Bell
15. Throttle
16. Display

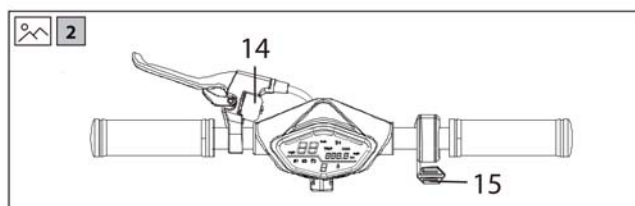

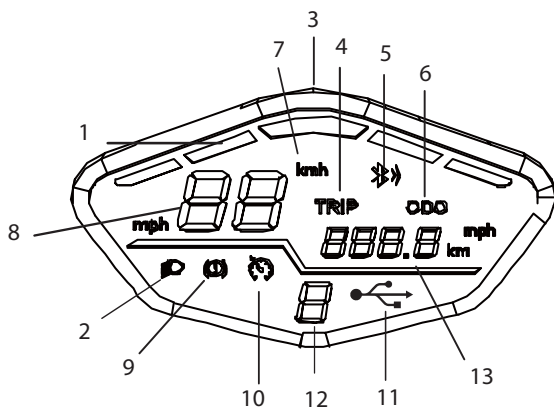

Refer to the pictures

1. Battery level
2. LED light
3. Hook/Stem Fold Lock Catch
4. single Range unit
5. Bluetooth mode (for use with app)
6. Total Range unit
7. Speed unit
8. Instant speed
9. Brake troubleshooting
10. Cruise control
11. USB Charging Socket
12. Gear mode
(Gear 1: road mode /Gear 2: Snow mode)
13. Total Range

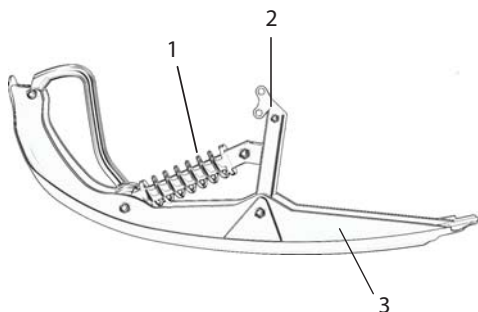

Refer to the pictures

1. Shock absorber
2. Fixed shaft and nut
3. Snowboard

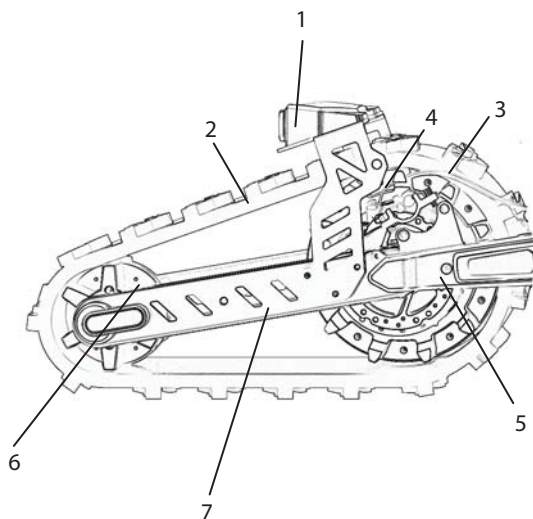

Refer to the pictures

1. Taillight
2. Crawler
3. Taillight Cable
4. Power Cable
5. Brushless Motor
6. Auxiliary wheels
7. Connect frame

5. Command information / Control panel

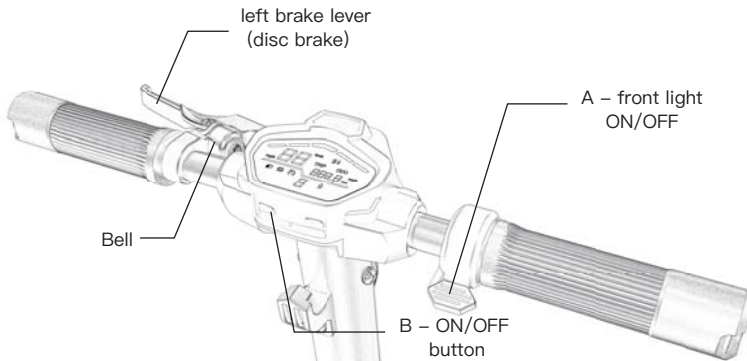

Power on (B): Press this button (B) to turn the electric snow scooter on and off.

Front light (A): Once the electric snow scooter has been turned on, press the button (A) for one second to turn on the lights. Press the button (A) again for one second to turn them off.

Cruise control: Cruise control is activated automatically when the same speed is maintained for 10 seconds, then the accelerator can be released. Press the brake command or press the accelerator to go back to manual mode.



IMPORTANT

Automatic power off: after a few minutes of inactivity, the electric snow scooter will turn off automatically.

6. Assembly and setup

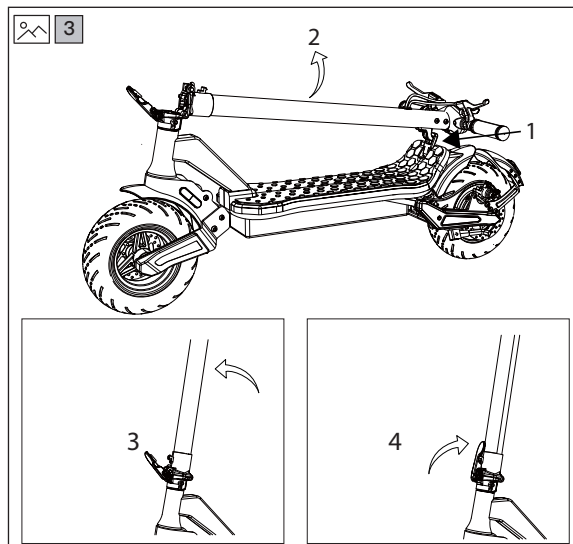

1. Open the kickstand
2. Loosen the knob of the folding mechanism by turning it counter-clockwise, lift the handlebar stem, then tighten the knob of the folding mechanism by turning it clockwise.
3. Install the handlebar on the stem, insert/screw in the four screws but do not tighten them.
4. Tighten the four screws.
5. Adjust the braking system if necessary
6. Check the tyre pressure (30 PSI) both before the first use and periodically (every 2–3 weeks).

After performing these operations, power up the electric scooter to make sure that

Assembling the Handlebars

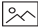
- With reference to pictures  4 and  5
- Assemble the handlebars with the supplied Allen key. This only has to be carried out when the product is un-boxed; the handlebars do not have to be removed after being attached.
- Insert the handlebars into the handlebar stem as shown in the pictures. The handlebars have to be orientated as shown. While assembling the handlebars, be careful not to bend or break any parts.
- Ensure that the screws are not overtightened and that the handlebars are secure and do not wobble after construction.

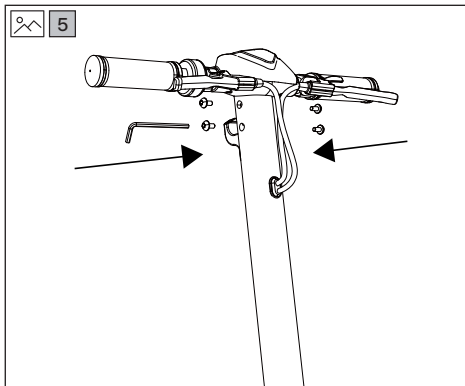
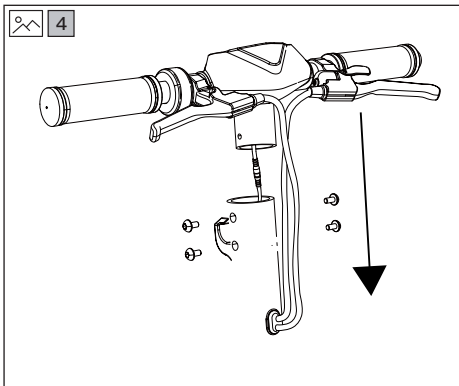

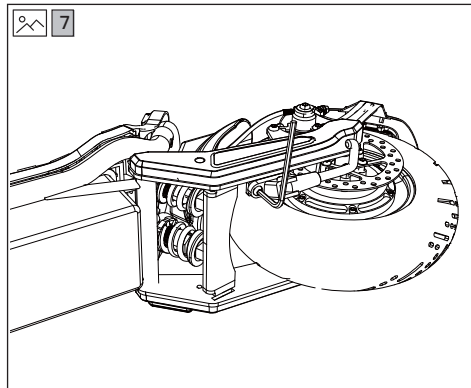
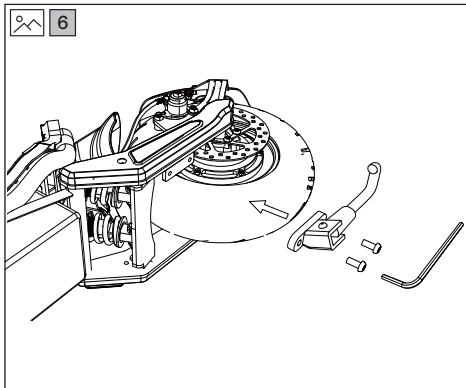

Assembling the Handlebars

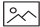
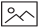
- With reference to pictures  6 and  7
- Assemble the stand stick with supplied Allen key. This only has to be carried out when the product is un-boxed.
- Place the stand stick to the rear fork as shown in the pictures, fix with supplied screws.
- Ensure the screws are tightly fastened and not wobble.

7. Folding

Turn off the device, open the locking system by turning the dedicated knob counter-clockwise, bend the handlebar stem towards the footrest and attach the hook to the locking clip on the side of the mudguard.

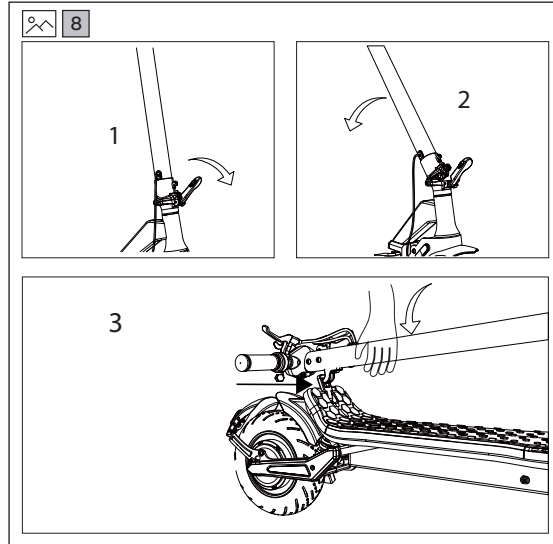

8. Battery charging and activation

1. Open the rubber cap.
2. Insert the battery charger plug.
3. When the battery is full, remove the batter charger and close the rubber cap.

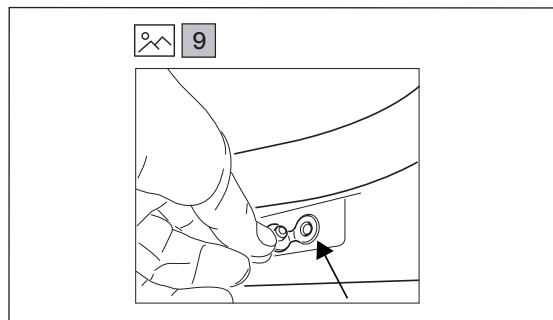

The red light on the feeder will become green when charging is complete.

9. Road mode and ski mode change

Front wheel and ski replacement

1. First, turn off the power, make the scooter in the off state.
2. Place the scooter on the holding device stably so that the front wheels and rear tracks are in the air.
3. Use the Allen wrench to remove the protective covers on both sides of the front fork.
4. After removing the frok cover, the screws of the center shaft of the front wheel will be exposed, loosen the screws with a wrench, and remove the front wheel.
5. Insert the center shaft of the sled into the hole of the front fork.
6. Put the screws on the left and right sides of the central shaft of ski board and tighten.
7. Install the front fork cover.



Warning :

- Please make sure the scooter is powered off before operation.
- Please make sure that the holding device is large enough to prevent the scooter from tilting backwards due to the weight reduction in the front after the front wheel is removed.
- Once the scooter is tilted backwards, please lift the board up slightly when installing the ski board
- Please keep the removed screws and nuts well to avoid loss.

Picture after replacement



Rear motor wheel and caterpillar replacement

1. First ,turn off the power, make the scooter in the off state
2. Place the scooter on the holding device stably so that the front wheels and rear caterpillar are in the air.
3. Twist the power cable and brake cable between the body and the rear wheels
4. Use the Allen wrench to remove the both protective covers between body abd rear wheels.
5. Removing the rear wheel fender.
6. Removing the Brake.
7. Loosen the fixing screws of the center shaft, and remove the rear motor wheel.
8. Insert the central shaft of the caterpillar into the hole, install the screws and tighten them.
9. Connect the power cord between the scooter body and the caterpillar.
10. Install brakes.
11. Install the protective cover between the scooter body and the caterpillar.



Warning :

- Please make sure the scooter is powered off before operation.
- Please make sure that the holding device is large enough to prevent the scooter from tilting frontwards due to the weight reduction in the rear after the rear wheel is removed.
- Once the scooter is tilted frontwards, please lift the caterpillar up slightly when installing the it.
- Please keep the removed screws and nuts well to avoid loss.

Picture after replacement



10. Storage and cleaning

Charge the snow scooter to 50% – 60% before storing it for extended periods of time. Recharge it to 50% – 60% every 2–3 months. If not used daily, the electric snow scooter should be stored at a temperature of 15–25°C. Do not expose the electric snow scooter to extreme temperatures (below 0°C or above 45°C). Avoid leaving it outdoors,

When the electric snow scooter gets dirty, clean it with a damp cloth. Before cleaning it, make sure that it is turned off and cover the charging port to prevent damage to the electronic components. Do not use alcohol, petrol, kerosene or other corrosive and volatile chemical solvents. This may damage both the appearance and the internal structure of the electric snow scooter. Do not use pressurized water jets or running water to clean the scooter.

Do not expose it to rain or water or immerse it in water to wash it.

11. General warnings

- Check the brakes, the pressure (30 PSI), the condition of the wheels and the accelerator before each use. If you notice any unusual noises or anomalies, do not use the scooter, and contact your dealer's Technical Support Service.
- It is forbidden to modify the electric scooter in any way; this could alter its efficiency. Make sure the scooter is off before parking it.
- Make sure the electrical components of the vehicle do not come into contact with water or other liquids.
- Avoid riding near rivers or lakes.
- Supervise children to make sure they do not play with the product. Strict supervision is required if the product is being used near children.
- For information, technical support and help, contact your dealer.

Instructions on riding behaviour

- Do not use the phone or listen to music while riding the electric scooter.
- Only ride if there is enough light to ride safely. When riding in unfavourable light conditions, remember to turn on the electric scooter lights and to wear a reflective jacket.
- Always hold the handlebar with both hands when riding.
- Always ride with both feet on the footrest in a safe and comfortable position.
- Do not get distracted while riding and always look ahead.
- Always ride at a speed that allows braking safely.
- Start braking early enough so as to avoid obstacles, handle bends on the road, and areas with uneven surfaces. Remember to release the accelerator before braking.
- Do not race with other riders.
- Keep a minimum safety distance of 5 m from other vehicles.

12. Learning to ride the scooter

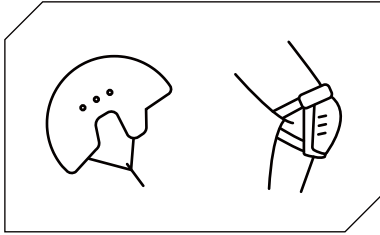

Read the safety instructions before riding the electric scooter.
Use approved equipment such as helmets and knee pads.

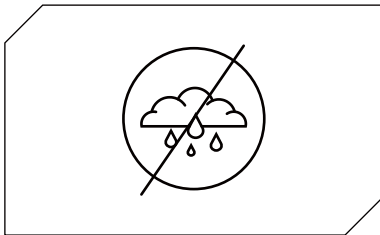

Do not use the electric scooter in the rain.

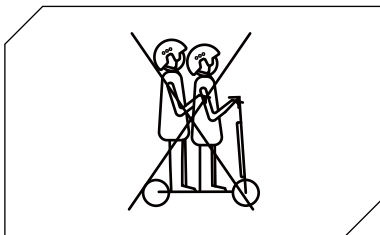

The electric scooter may not be used by more than one person at a time.

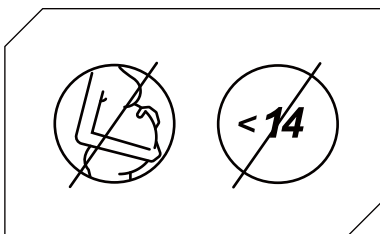

Children under the age of 14* and pregnant women should not use this electric scooter.

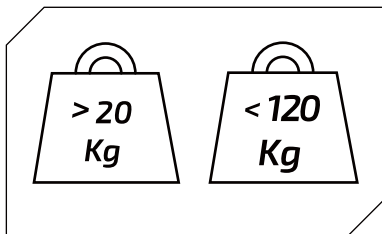

Minimum weight allowed on the Electric scooter: 20 kg.

Maximum weight allowed on the Electric scooter: 120 kg.

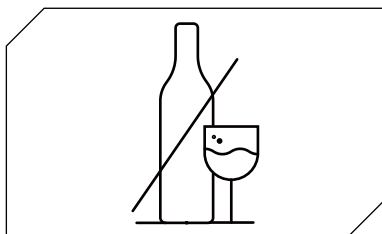

Do not ride the electric scooter if you have been drinking alcohol or if you are on medication.



Do not use the phone or listen to music while riding the electric scooter.

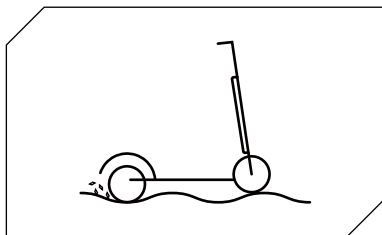

Take extra care if you are riding where there are bumps, sand, puddles, frost, snow, or steps, or in dark places, at night, or in wet conditions.

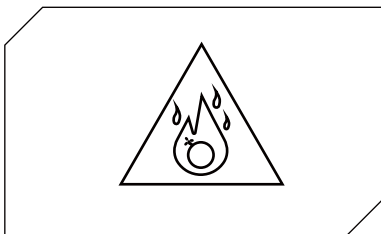

Do not use the electric scooter in dangerous areas, near flammable and/or explosive substances, liquids and/or dirt.

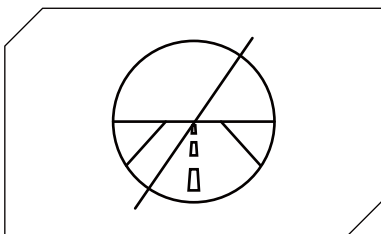

This electric scooter is not designed to be ridden on roads and motorways. Consult the laws in force in your municipality on where the use of electric scooters is permitted.

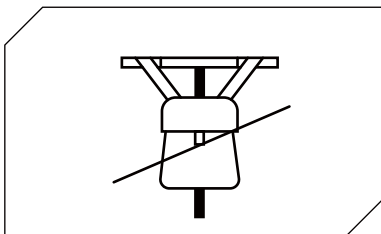

Do not hang heavy objects on the handlebar.

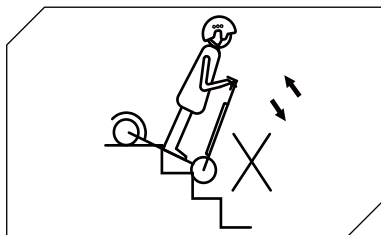

Do not use the electric scooter to go up or down steps or stairs.

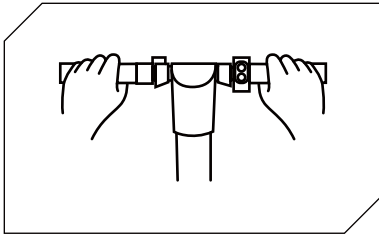

Always hold the handlebar with both hands.

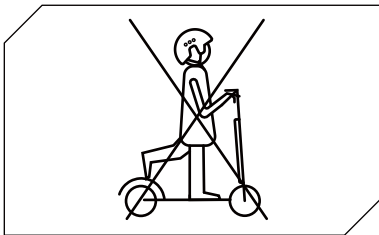

Do not ride the electric scooter with just one foot on the footrest.

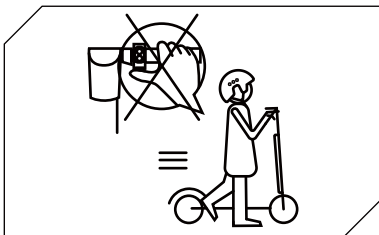

Do not press the accelerator when walking with the electric scooter.



Do not ride the electric scooter through puddles and over wet surfaces.

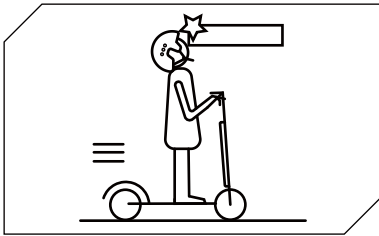

Mind your head when passing under canopies, through doorways or similar places.

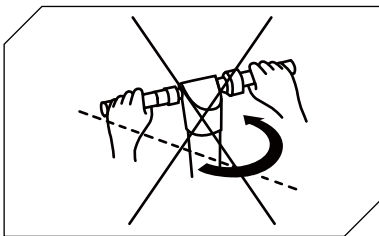

When riding at the highest permitted speed, do not turn the handlebar abruptly.

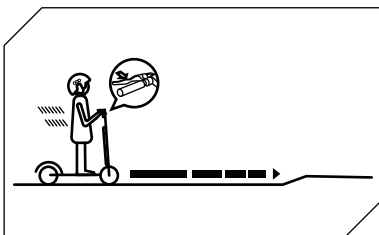

Start braking early enough so as to avoid obstacles, handle bends on the road, and areas with uneven surfaces. Remember to release the accelerator before braking.

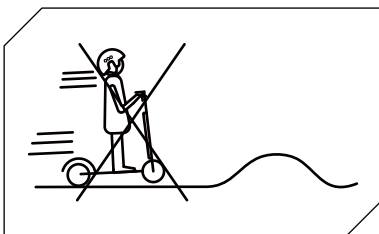

Do not travel at speed over obstacles such as steps, curbs, or bumps.

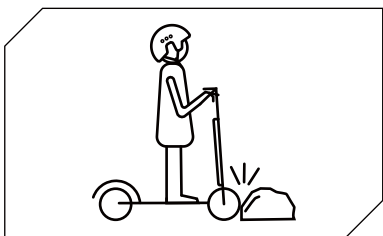

Do not hit obstacles with the wheels.

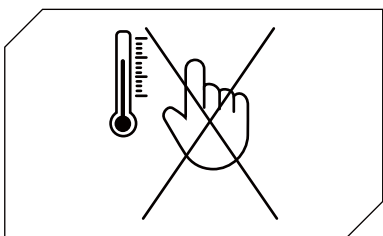

Do not touch the motor immediately after riding as it may be extremely hot.

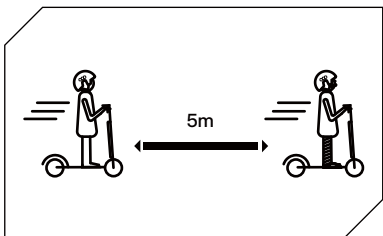

Keep a minimum safety distance of 5 m from other vehicles

13. Battery and charger (Warnings)

Make sure the electric scooter, charger, and charging port are dry.

When the electric scooter is fully charged, the LED light on the charger changes from red (charging) to green (charging completed).

Use only the original charger. Other chargers may damage your device and expose users to other potential risks.

The electric scooter should not be charged for extended periods. Overcharging reduces battery life and may cause other damages.

Charge the electric scooter in a dry environment, away from flammable materials (such as materials that could burst into flames), preferably at an indoor temperature of 15–25°C, but never below 0°C or above +45°C.

Do not charge in direct sunlight or near open flames.

Do not charge the electric scooter immediately after use. Let the electric scooter cool down for one hour before recharging.

Never leave the electric scooter unattended while charging. Risk of fire Never touch the charging socket with metal objects.

Read the charging and storage sections above to ensure that the battery is maintained and handled properly. Keep the electric scooter away from open flames or other heat sources to prevent the battery from overheating. Do not leave the electric scooter exposed to freezing temperatures. Both excessive heat and cold temperatures may cause the battery to lose their charge.

Avoid discharging the battery completely in order not to compromise the battery life, both in terms of autonomy and in terms of duration.

It is best to recharge the battery while there is still some charge left. This prolongs the life of the battery. When the charge is too low, it is not possible to ride normally. This may lead to the rider losing control or falling off.

Make sure the battery is charged at regular intervals, even if you do not use the electric scooter for an extended period of time. This prevents damage to the battery caused by low voltage over an extended period.

Battery precautions:

The battery is made of lithium-ion cells and chemical elements that are hazardous to health and the environment. Do not use the electric scooter if it begins to smell or leak, or becomes excessively hot. Do not dispose of the electric scooter or battery with household waste. The end user is responsible for the disposal of electrical and electronic equipment and batteries in compliance with all applicable regulations.

Do not:

Open the battery or take it apart. Do not strike, throw, or puncture the battery or stick objects in it. Touch anything leaking from the battery, as it contains hazardous substances. Let children or pets touch the battery.

Over-charge, over-discharge or short-circuit the battery. Immerse or expose the battery to water or other liquids. Expose the battery to excessive hot or cold weather conditions.

Expose the battery to an environment containing explosive gases or flames. Leave the battery in the rain or under direct sunlight or in a hot car in direct sunlight.

Reassemble or refit the battery.

Carry or store the battery together with metal objects such as hairpins, necklaces, etc.

Ride the electric scooter while it is charging.

Use any battery charger other than the original.

14. Care and Maintenance

- **WARNING !** As with any mechanical component, a scooter is subject to high stresses and wear. The various materials and components may react differently to wear or fatigue. If the expected service life for a component has been exceeded, it may break suddenly, therefore risking causing injuries to the user. Cracks, scratches and discoloration in the areas subject to high stresses indicate that the component has exceeded its service life and should be replaced.
- When not using the e-scooter, please store it in a dry environment to avoid damage to electronic components due to moisture.
- Do not store the e-scooter outside for an extended period of time. This will provide excessive exposure to sunlight, high temperature or low temperature may damage the e-scooter and accelerate the wear of tires and batteries.
- Do not touch the disc brake disc immediately after using the disc brake of the electric scooter, as there is a danger of high temperature burns!
- Disc brake adjustment: If the brake is too tight, use the provided hex wrench to slightly loosen the screw holding the brake cable on the disc brake to release the brake tension. Then slightly extend the position of the brake cable bolt compared to the last time. If the brake is too loose, perform the opposite operation and adjust the brake cable.
- The self-tightening nuts as well as the other self-tightening fastenings may lose their efficiency and that they may need to be retightened.
- Average value of 20N/m is given unless other value is provided by the manufacturer.
- Suggested minimum height of user is 150mm.
- Suggested maximum age of user is 60 years old, minimum age is 16 years old.
- Regularly check the tightening of the various bolted elements, in particular the wheel axles, the folding system, the steering system and the brake shaft.
- Eliminate any sharp edges caused by use.
- Do not modify or transform the vehicle, including the steering tube and sleeve, stem, folding mechanism and rear brake.
- Should you experience any issues with the care and maintenance of your e-scooter, contact your dealer.

Note: once fully charged it will last 120–180 days.

Damage caused by the battery being left uncharged for a long period is irreversible and is not covered by the limited warranty. Once the damage has occurred, the battery cannot be recharged (the battery must not be dismantled by unqualified personnel, as this could lead to electric shocks, short circuits or even major safety incidents).

15. Technical data sheet

Electric Scooter Data Sheet

Model	S15
Dimensions (W x H x L in mm)	1295*470*1340
Folded Size (W x H x L in mm)	1295*470*580
Weight (kg)	30
Maximum Load (kg)	120
Maximum Speed (km/hour)	30
Maximum Climbing Angle	35°
Motor Type	brushless energy-saving
Motor Power	motor 600 W
Wheel Size (inches)	11
Wheel Type	Air tyre
Tyre Pressure	/

Battery

Brake Type	Disc brake 18650
Battery Type	lithium battery
Battery Capacity (A/hour)	13
Battery Voltage	46.8
Battery Power (Wh)	608.4
Range (km)	35-45
Charging Time (Hours)	6 to 8
Working enviroment	
Temperature	-10 °C to +45 °C
Storage Temperature	-10 °C to +25 °C
Relative humidity	up to 75% RH
Battery Charger	
Input	100 - 240 V AC, 50/60 Hz, 1.8 A (Max)
Output	54.6 V DC, 2.0 A

AS PART OF A POLICY OF CONTINUOUS IMPROVEMENT, WE RESERVE THE RIGHT TO ALTER DESIGN AND SPECIFICATIONS WITHOUT NOTICE.

Caterpillar Data Sheet

Model	S15
Nominal voltage	48V
Rated power	1500W
Peak power	3000W
Maximum Load (kg)	120
Maximum Speed (km/hour)	45KM/H
Maximum Climbing Angle	35°
Motor Type	broadband brushless
Brakes	Rear electronic disc brakes
Riding snow depth	150mm

16. Troubleshooting

The e-scooter does not move after start-up.

Cause / Action

The brake has not restored completely, this will interrupt the operation of the power supply. / Manually reset the brake. This can be achieved by pushing the brake lever back to its normal position.

The e-scooter moves at low speed or does not move at all.

Cause / Action

Battery is low. / Battery requires replacement.

The motor starts and switches off a gain.

Cause / Action

Battery is low. / Battery requires replacement.

The controller is damaged. / Controller requires replacement.

The Battery connection is loose. / Battery connections need to be checked.

The battery cannot be charged or has charged slowly.

Cause / Action

Voltage is not correct. / Battery requires replacement.

The battery does not charge.

Cause / Action

The Battery life cycle has come to an end. / Battery requires replacement.

The Battery charger does not emit power. / Replace the battery charger.

The charging lead is damaged. / Replace the battery charger.

Error codes

It is possible that errors codes may be displayed. The e-scooter will stop operating under these conditions.

E0 – Communication error

E1 – Abnormal current

E2 – Throttle failure

E3 – Brake failure

E4 – MOS failure / Over current failure

E5 – Hall / Motor failure

E6 – Motor failure

E7 – Low voltage error

Should you experience any issues which cannot be resolved, contact your dealer.



Treatment of the electrical or electronic device at the end of its service life (applicable in all countries of the European Union and in other European systems with separate collection systems)

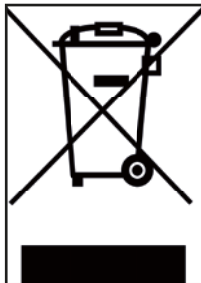

This symbol on the product or packaging indicates that the product should not be considered as normal household waste, but should be taken instead to a facility authorized to dispose of waste electrical and electronic equipment (WEEE).

By making sure that this product is disposed of correctly, you will help prevent potential negative consequences for the environment and for health, which could otherwise be caused by inappropriate disposal. Recycling materials will help to conserve natural resources.

For more detailed information about recycling this product, contact your municipal office, local waste disposal service or the shop where it was purchased.

More specifically, consumers shall not dispose of WEEE as municipal waste, but shall dispose of this type of waste separately, in one of two possible ways:

- 1) By taking it to municipal collection centres (also called eco-collection centres or recycling facilities), directly or through the collection services of municipal companies, where these are available.
- 2) By taking it to shops selling new electrical and electronic equipment. Here, very small items of the WEEE type (with the longest side less than 25 cm) can be left free of charge, while larger ones can be left on a 1-for-1 basis, i.e., you can leave the old item when you buy a new one having the same function.

In the event of illegal disposal of electrical or electronic equipment, the fines provided for by current legislation on environmental protection may be applied (Italian regulation; check the regulations in force in the country of use/disposal of the vehicle).

If the WEEE contains batteries or accumulators, they must be removed and subjected to specific separate collection.



Treatment of spent batteries (applicable in all countries of the European Union and in other European systems with separate collection systems)



This symbol on the product or packaging indicates that the battery pack should not be treated as normal household waste. On some types of batteries, this symbol may be used in combination with a chemical symbol.

The chemical symbols for mercury (Hg) or lead (Pb) are added if the battery contains more than 0.0005% mercury or 0.004% lead.

By ensuring that the batteries are disposed of correctly, you will help prevent potential negative consequences for the environment and human health, which may otherwise be caused by inappropriate disposal. Recycling materials will help to conserve natural resources. Where for safety, performance or data protection reasons, products require a fixed connection to an internal battery, this shall only be replaced by qualified service personnel.

Deliver the product at the end of its service life to collection centres suitable for the disposal of electrical and electronic equipment: this ensures that the battery inside it is also treated correctly.

For more detailed information about disposal of the dead battery, contact your municipal office, local waste disposal service or the shop where it was purchased.

This device complies with part 15 of the FCC Rules. Operation is subject to the following two conditions: (1) this device may not cause harmful interference, and (2) this device must accept any interference received, including interference that may cause undesired operation.

Any changes or modifications not expressly approved by the party responsible for compliance could void the user's authority to operate the equipment.

NOTE: This equipment has been tested and found to comply with the limits for a Class B digital device, pursuant to Part 15 of the FCC Rules. These limits are designed to provide reasonable protection against harmful interference in a residential installation. This equipment generates, uses and can radiate radio frequency energy and, if not installed and used in accordance with the instructions, may cause harmful interference to radio communications. However, there is no guarantee that interference will not occur in a particular installation.

If this equipment does cause harmful interference to radio or television reception, which can be determined by turning the equipment off and on, the user is encouraged to try to correct the interference by one or more of the following measures:

- Reorient or relocate the receiving antenna.
- Increase the separation between the equipment and receiver.
- Connect the equipment into an outlet on a circuit different from that to which the receiver is connected.
- Consult the dealer or an experienced radio/TV technician for help.

The device has been evaluated to meet general RF exposure requirement. The device can be used in portable exposure condition without restriction.