

# Intelligent Radon Monitor



## Instruction Manual

RN-PRO200

Thank you very much for using this product. In order to enjoy the service of this product, please keep and read the instruction carefully. If you have any problems for this product, please feel free to contact us ( [contact@lifebasis.com](mailto:contact@lifebasis.com)).

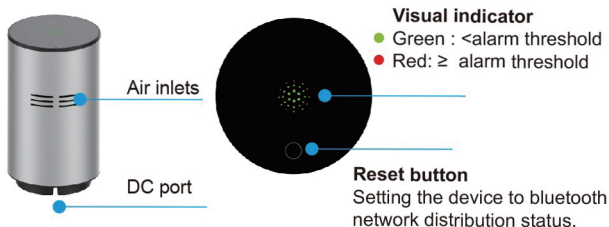

## Product Description

Our innovative radon monitor, which integrates the latest high-precision radon sensor, combined with a friendly and stable WIFI APP, provides a simple, fast, highly accurate and affordable solution for continuous radon monitoring.

## Product Placement Guidelines

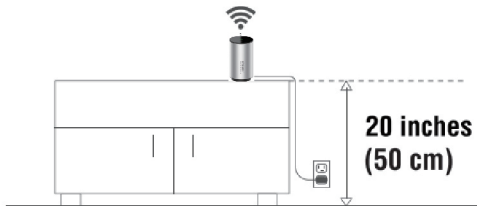

1. Make sure it's at the correct height. Place our radon monitor at least 20 inches (50cm) above the floor.
2. Don't place radon monitor close to open windows or vents, and keep it away from high heat and high humidity.
3. Find a place with good Wi-Fi signal. Our radon monitor use a Wi-Fi connection to the internet and send information to your smartphone APP.
4. Vibration can cause the unit to pause the test and produce a warning sound;
5. Re-pairing is required if the network is changed ;
6. A device can only be paired with one smartphone and one router at the same time; a smart phone can be paired with multiple devices (up to 200 devices) .

# Product Technical Specifications

Product Name	Intelligent radon monitor
Sensor Type	Pulsed ion chamber
First Radon Result	About 10 min
First Highly Reliable Radon Result	Within 1 hour
Radon Date Update Interval	10 min
Radon Count Sensitivity	30CPH (1hour / 1pCi/L)
Measurement Range	0.2 ~ 99.9 pCi/L (1~3700 Bq/m³)
Range of Measurement Errors	< 10% at 10 pCi/L (370 Bq/m³) after 10 hours
Connectivity	Wi-Fi
Radon Alarm	Audible alerts & Visual indicator
Radon Level Visual indicator	3-Color Led (red, orange, green)
Power Consumption	DC 12 + 0.1V; 65mA (12V DC adapter)
Working Environment	Temperature 32~104°F (0~ 40°C); Humidity < 80% RH
Product Size & Weight	80 mm X 140 mm , 380g
Package Size & Weight	100 mm X 100 mm X 190 mm, 450g

## How to Connect the Device and Use it ?



**Step 1.** Connect the power cable into the device and plug the power adapter into an AC power supply.

**Step 2.** Download and install the “Tuya” Smart App through the Google Play Store or Apple App Store. Or to scan QR code ( Picture 1) to download the “Tuya” APP.

**Step 3.** Then register an account with mobile phone number or email and login it.

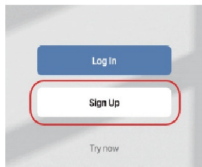
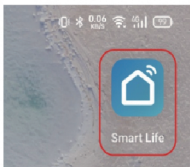

**Step 4.** Press and hold the “reset” button of the device for more than 5s, the led indicator of device flash quickly in red with a Audible “Di”, then device start bluetooth network distribution status.

### NOTE:

1. It is necessary to turn on the Bluetooth function on your mobile phone;
2. Not compatible with 5G WIFI;

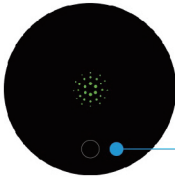

### Reset button

Setting the device to bluetooth network distribution status.

**Step 5.** Click on the “Add device” button or the upper right corner “+” icon, add the device.

**Step 6.** At this time, the connection box will pop up,click “Go to add” or “Add” to start pairing.

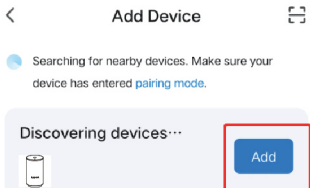

**Step 7.** Enter Wi-Fi name and password for your device to connect to Wi-Fi.

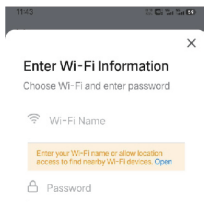

**Step 8.** Enter the device page (picture 1). Click the device icon, you can jump to the data graph (picture 2); Click the data graph, you can jump to the data logger (picture 3).

Picture 1

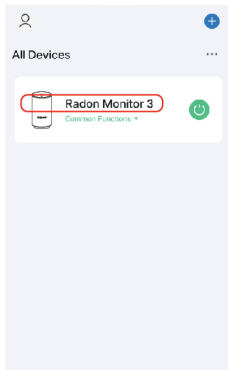

Picture 2

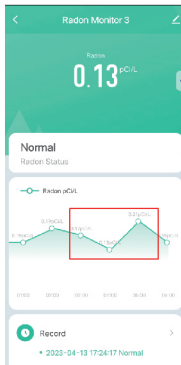

Picture 3

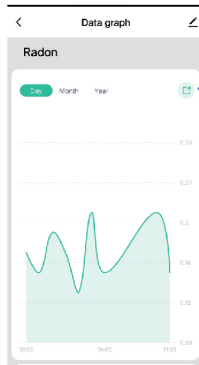

# Setting Alarm Level Threshold

You can set the alarm level threshold freely as following  
- 2 Ways of Setting Up.

## Setting 1:

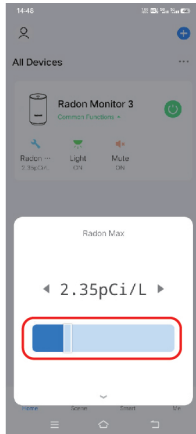
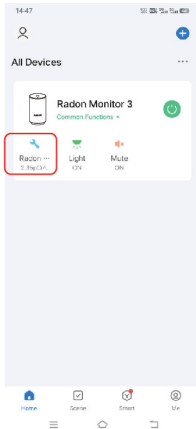



## Setting 2:

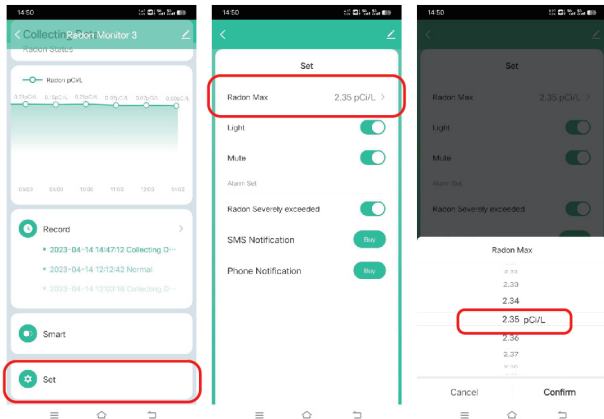

# Radon Data Log, And You Can Sharing With Others

Keep track of hourly radon level by time and date of measurement. Click on the “Sharing” icon of the upper right (Picture 1). Then enter the Email address (Picture 2), you will share the radon date log to this email (please download email attachment to see graph).

Picture 1

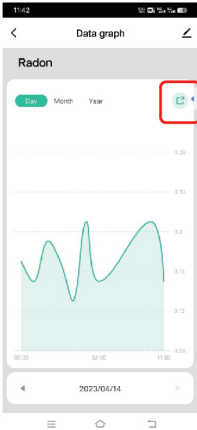

Picture 2

The screenshot shows the 'Radon' data graph interface with an email sharing dialog box open. The dialog box has a title 'Email address' and a text input field with the placeholder 'Please enter email address'. Below the input field are two buttons: 'Cancel' and 'Confirm'.

#	DateTime	Radon
1	2022/08/02 00:00	36
2	2022/08/02 01:00	29
3	2022/08/02 02:00	29
4	2022/08/02 03:00	36
5	2022/08/02 04:00	48
6	2022/08/02 05:00	37
7	2022/08/02 06:00	40
8	2022/08/02 07:00	76
9	2022/08/02 08:00	36
10	2022/08/02 09:00	24
11	2022/08/02 10:00	25
12	2022/08/02 11:00	19

# Maintenance

## 1. About the resetting WiFi.

Press and hold the picture icon to enter the management interface, select the device you need to reset WiFi, click “Remove Device”, and then re-enter the pairing the status after removing the device.

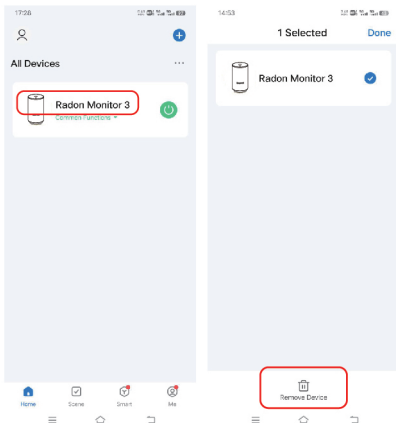

## 2. Reset existing data

-To erase all data on your account, you need to remove your device and add again.

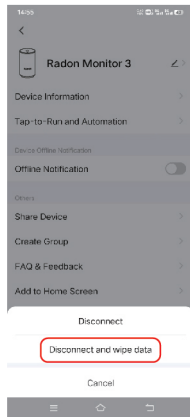
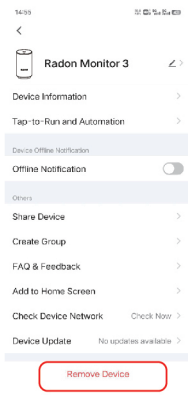
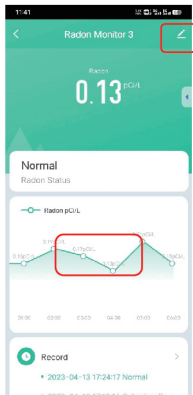

## 3. Power Off

To switch off the radon monitor, please remove the power cable from the back side.

# Led Light Color Guide

Led Status	Monitor Status
Flashing Green quickly	It's before the paring state and need to be pared with the smart phone and wireless router.
Flashing Red slowly	It is in the paring state and waiting for paring with smart phone and wireless router.
Always on Green	WIFI pairing connection succeeded Flashing green slowly WiFi connected and detected radon level is normal.
Flashing Orange	It has been paired with the smart phone once,but the current network is abnormal and network needs to be restored or paired again.
Flashing Red with audio alarm	Detected radon levels exceed thresholds.

# Package Including

- 1 x Radon Monitor
- 1 x Power Adapter
- 1 x Product Instruction

**FCC Warning:**

This equipment has been tested and found to comply with the limits for a Class B digital device, pursuant to part 15 of the FCC Rules. These limits are designed to provide reasonable protection against harmful interference in a residential installation. This equipment generates, uses and can radiate radio frequency energy and, if not installed and used in accordance with the instructions, may cause harmful interference to radio communications. However, there is no guarantee that interference will not occur in a particular installation. If this equipment does cause harmful interference to radio or television reception, which can be determined by turning the equipment off and on, the user is encouraged to try to correct the interference by one or more of the following measures:

- Reorient or relocate the receiving antenna.
- Increase the separation between the equipment and receiver.
- Connect the equipment into an outlet on a circuit different from that to which the receiver is connected.
- Consult the dealer or an experienced radio/TV technician for help.

Caution: Any changes or modifications to this device not explicitly approved by manufacturer could void your authority to operate this equipment.

This device complies with part 15 of the FCC Rules. Operation is subject to the following two conditions: (1) This device may not cause harmful interference, and (2) this device must accept any interference received, including interference that may cause undesired operation.

The device has been evaluated to meet general RF exposure requirement. The device can be used in portable exposure condition without restriction.

**Radiation Exposure Statement**

This equipment complies with FCC radiation exposure limits set forth for an uncontrolled environment. This equipment should be installed and operated with minimum distance 20cm between the radiator and your body.

This transmitter must not be co-located or operating in conjunction with any other antenna or transmitter.